

| FIELD EQUIPMENT NUMBERING SYSTEM | |
|----------------------------------|--|
| EXAMPLE : 006402.8W.11D | |
| 0064 | DESIGNATES HIGHWAY WHERE FIELD EQUIPMENT IS LOCATED. |
| 006402.8 | DESIGNATES MILE MARKER WHERE FIELD EQUIPMENT IS LOCATED. |
| 006402.8W | DESIGNATES DIRECTION VIDEO DETECTOR IS MONITORING TRAFFIC OR DIRECTION TRAFFIC IS TRAVELLING TO RECEIVE DMS MESSAGE. |
| 006402.8W.11 | NUMBER ASSIGNED TO THAT FIELD EQUIPMENT |
| 006402.8W.11D | A = ALL DIRECTIONS D = VEHICLE DETECTION C = CAMERA (P/T/Z SURVEILLANCE) H = HAR SIGNAGE WITH BEACON R = RADAR DETECTION S = DYNAMIC MESSAGE SIGN |

| ITS ELEMENTS SCHEDULE | | |
|-----------------------|-----------------|------------|
| RADAR DETECTION | STA. | ITS PLAN # |
| EX. 557015.9N.38R | 774+80 RT (NB) | 1A OF 12 |
| EX. 557017.0N.39R | 832+80 RT (NB) | 3 OF 12 |
| EX. 557017.6N.40R | 1375+00 LT (NB) | 4B OF 12 |
| EX. 557018.6N.92R | 1321+80 LT (NB) | 6B OF 12 |
| EX. 557019.1S.93R | 1294+50 RT (SB) | 7B OF 12 |
| EX. 005519.7N.94R | 1263+75 LT (NB) | 8B OF 12 |
| 005522.0S.99R | 1148+69 RT (SB) | 12A OF 12 |
| CAMERA | | |
| EX. 557015.9A.35C | 774+80 RT (NB) | 1A OF 12 |
| EX. 557017.0A.36C | 832+80 RT (NB) | 3 OF 12 |
| 557017.6A.37C | 1375+00 LT (NB) | 4B OF 12 |
| 557019.1A.38C | 1294+50 RT (SB) | 7B OF 12 |
| 005519.7A.39C | 1263+75 LT (NB) | 8B OF 12 |
| 005522.0A.60C | 1148+69 RT (SB) | 12A OF 12 |
| DMS | | |
| EX. 005522.0S.05S | 1148+69 RT (SB) | 12A OF 12 |

O.E.50'L.D.=ON EXISTING 50' STEEL POLE WITH CAMERA LOWERING DEVICE

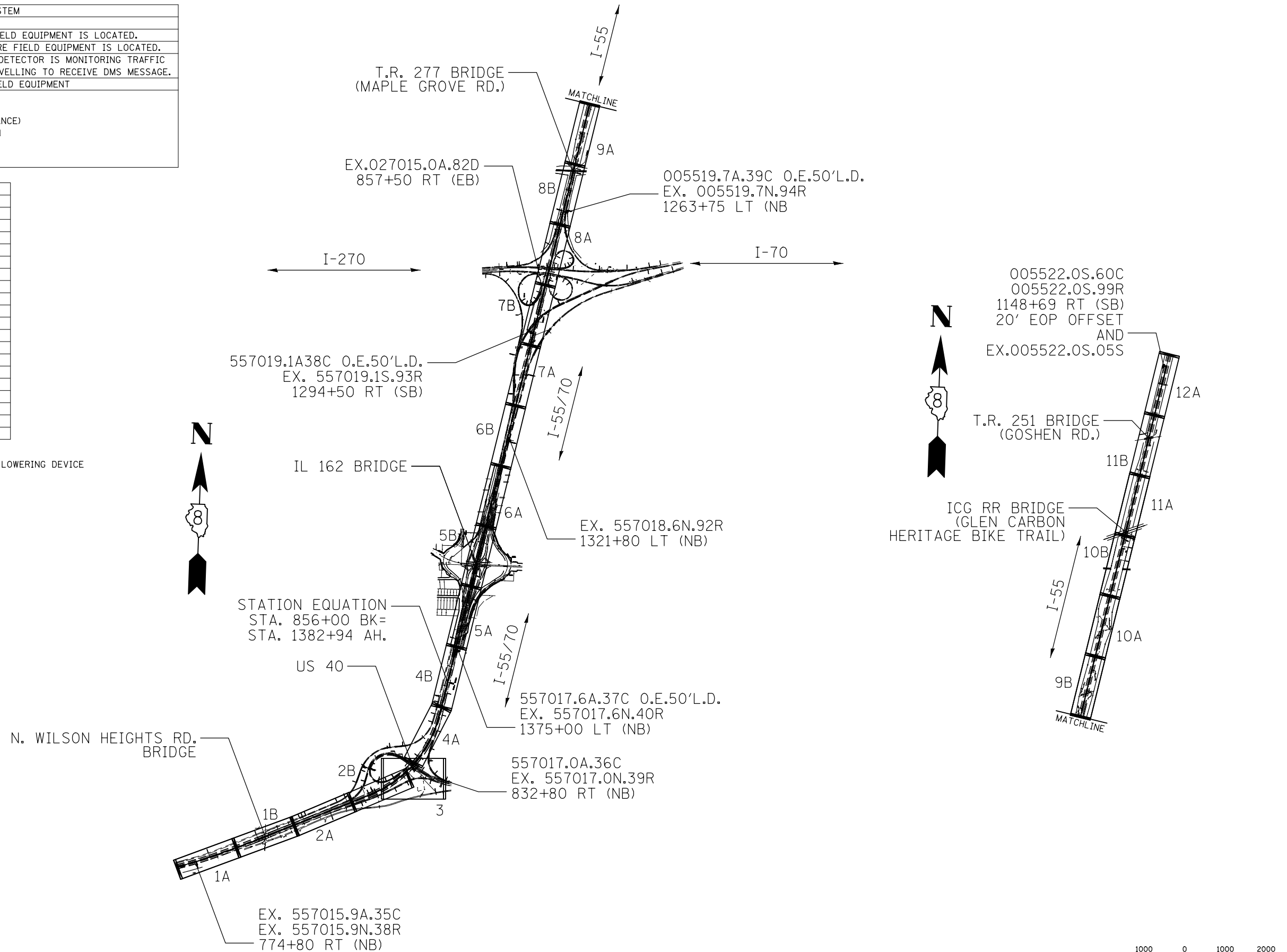

| | | | |
|---|------------------------------|------------|-----------|
| FILE NAME = | USER NAME = prestonm | DESIGNED - | REVISED - |
| et:\pw\work\p\midot\prestonm\d0320429\d076g08-shr-ITS.dgn | | DRAWN - | REVISED - |
| | PLOT SCALE = 100.0000' / in. | CHECKED - | REVISED - |
| | PLOT DATE = 11/25/2013 | DATE - | REVISED - |

**STATE OF ILLINOIS
DEPARTMENT OF TRANSPORTATION**

| ITS KEY MAP | | | |
|-------------|-----------|-----------|--------------|
| SCALE: | SHEET NO. | OF SHEETS | STA. TO STA. |
| | | | |

| F.A.I. RTE. | SECTION | COUNTY | TOTAL SHEETS | SHEET NO. |
|---|-------------------|---------|--------------|-----------|
| 55/70 | DIST 8 ITS 2014-1 | MADISON | 44 | 5 |
| CONTRACT NO.76G08 | | | | |
| FED. ROAD DIST. NO. ILLINOIS FED. AID PROJECT | | | | |