

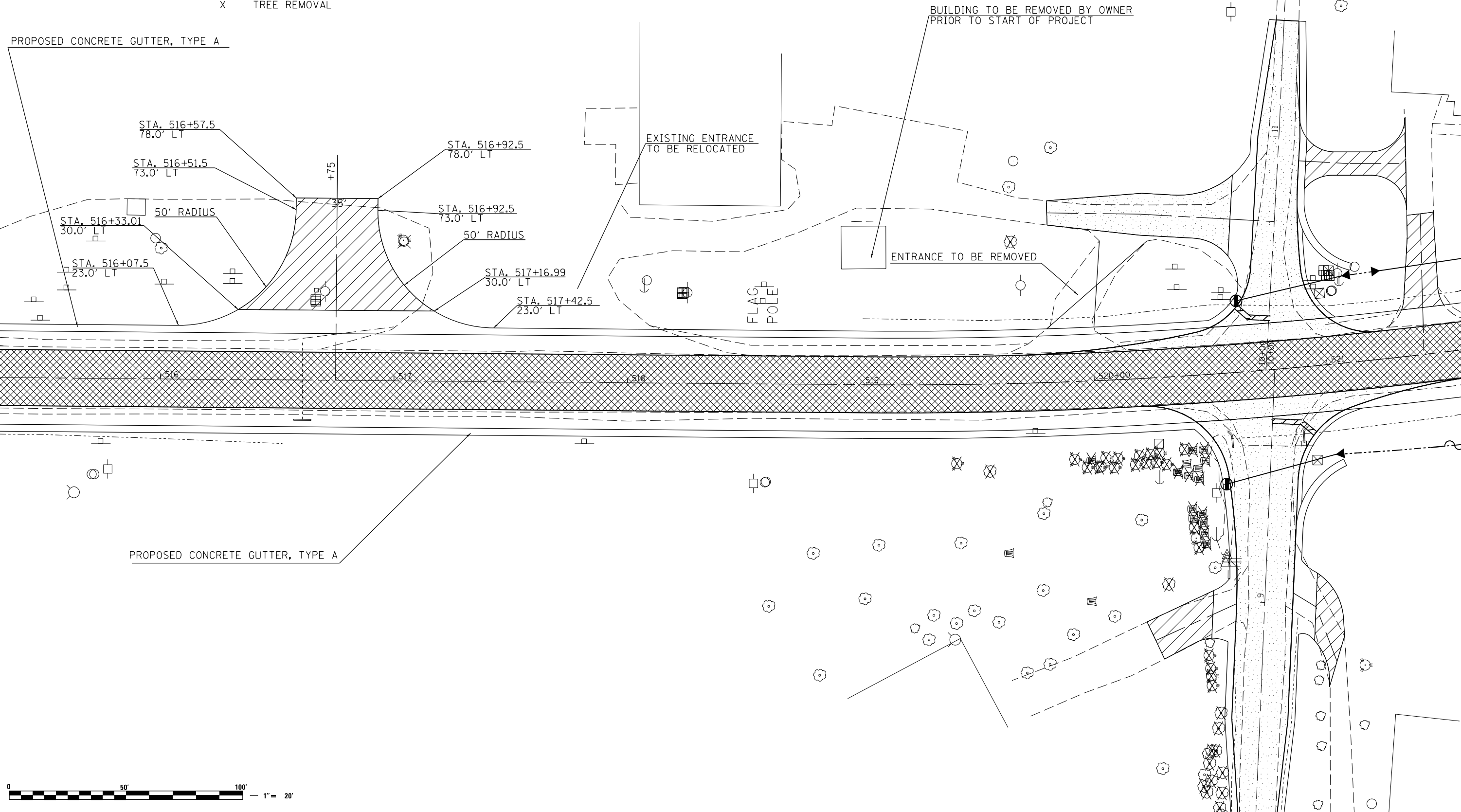

- HMA RESURFACING VARIABLE DEPTH
HMA SURFACE REMOVAL VARIABLE DEPTH
- HMA 11.5" PAVEMENT REMOVAL
- HMA 11.5", GRANULAR EMBANKMENT SPECIAL
- X TREE REMOVAL

- INCIDENTAL HMA SURFACING
- AGGREGATE SURFACE COURSE, TYPE A

PROPOSED CONCRETE GUTTER, TYPE A



FILE NAME =	USER NAME = \$USER\$	DESIGNED -	REVISED -
ei:\pw\work\p\dot\kranz\j\0308025\78320-shd-prop-rem.dgn		DRAWN -	REVISED -
	PLOT SCALE = 40.0000' / in.	CHECKED -	REVISED -
\$MODELNAME\$	PLOT DATE = 10/18/2013	DATE -	REVISED -

**STATE OF ILLINOIS
DEPARTMENT OF TRANSPORTATION**

**CONSTRUCTION/REMOVAL SHEETS
IL 37**

SCALE: SHEET OF SHEETS STA. TO STA.

F.A.P. RTE.	SECTION	COUNTY	TOTAL SHEETS	SHEET NO.
726	D9 SAFETY 2013-1	WILLIAMSON	112	35
CONTRACT NO. 78320				

ILLINOIS FED. AID PROJECT