

EXISTING CURVE DATA

EXIST. CURVE IL91EXCL1 PI STA. = 107+11.51 Δ = 1° 06' 55" (LT) D = 0° 06' 35" R = 52,241.93' T = 508.46' L = 1,016.89' E = 2.47' e = ----- T.R. = ----- S.E. RUN = ----- P.C. STA. = 102+03.05 P.T. STA. = 112+19.94	EXIST. CURVE IL91EXCL2 PI STA. = 132+12.40 Δ = 1° 18' 05" (RT) D = 0° 07' 19" R = 46,985.44' T = 533.67' L = 1,067.29' E = 3.03' e = ----- T.R. = ----- S.E. RUN = ----- P.C. STA. = 126+78.73 P.T. STA. = 137+46.02
--	--

PROPOSED CURVE DATA

PROP. CURVE PROLHRE1 PI STA. = 13+75.71 Δ = 1° 19' 38" (RT) D = 0° 42' 58" R = 8,000.00' T = 92.67' L = 185.33' E = 0.54' e = ----- T.R. = ----- S.E. RUN = ----- P.C. STA. = 12+83.04 P.T. STA. = 14+68.37

ALIGNMENT COORDINATE TABLE ROUTE 91

DESCRIPTION	STATION	NORTHING	EASTING
P.O.L. STA. 99+20.94	STA. 99+20.94	1,525,777.06	2,431,868.17
PI CURVE : IL91EXCL1	STA. 107+11.51	1,526,567.62	2,431,864.39
PI CURVE : IL91EXCL2	STA. 132+12.40	1,529,067.80	2,431,803.74
P.O.L. STA. 149+87.82	STA. 149+87.82	1,530,843.26	2,431,801.01

ALIGNMENT COORDINATE TABLE LEGION HALL RD.

DESCRIPTION	STATION	NORTHING	EASTING
P.O.L. STA. 99+20.94	STA. 99+20.94	1,525,777.06	2,431,868.17
PI CURVE : IL91EXCL1	STA. 107+11.51	1,526,567.62	2,431,864.39
PI CURVE : IL91EXCL2	STA. 132+12.40	1,529,067.80	2,431,803.74
P.O.L. STA. 149+87.82	STA. 149+87.82	1,530,843.26	2,431,801.01

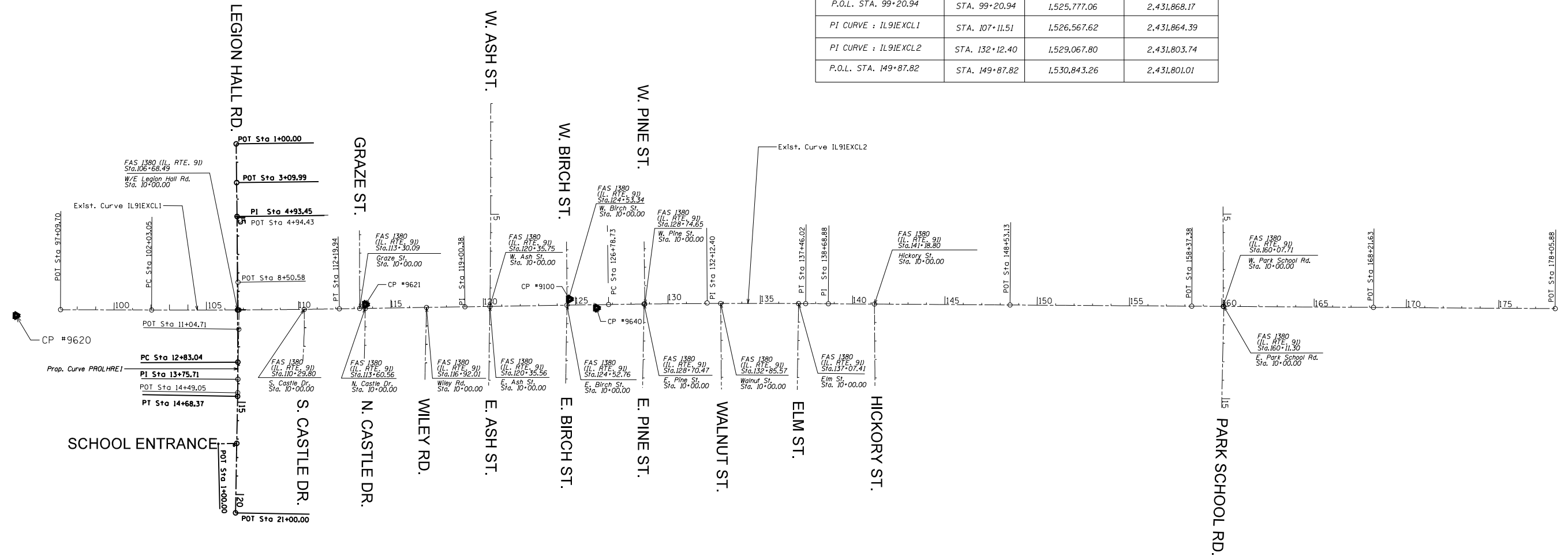
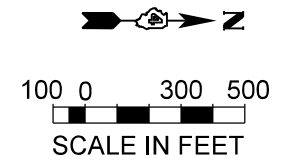

SIDEROAD INTERSECTION INFORMATION

