

**LEGEND FOR REMOVAL ITEMS**

- ① PAVEMENT REMOVAL [Grid Pattern]
- ② DRIVEWAY PAVEMENT REMOVAL [Diagonal Hatching]
- ③ H.M.A SURFACE REMOVAL (BUTT JOINT) [Dotted Pattern]
- ④ PAVED SHOULDER REMOVAL [Cross-hatch Pattern]
- ⑤ TREE REMOVAL, ACRE [Grid Pattern]
- ⑥ TREE REMOVAL [Circle with X]
- ⑦ PIPE CULVERT REMOVAL [Circle]
- ⑧ FENCE REMOVAL [X - - - X]
- ⑨ REMOVAL OF EXISTING STRUCTURE [Wavy Line]
- ⑩ GUARDRAIL REMOVAL [Dashed Line]
- ⑪ SIDEWALK REMOVAL [Cross-hatch Pattern]
- ⑫ C.C.&G. REMOVAL [XXXXXX Pattern]
- ⑬ H.M.A SURFACE REMOVAL 3/4" [Grid Pattern]

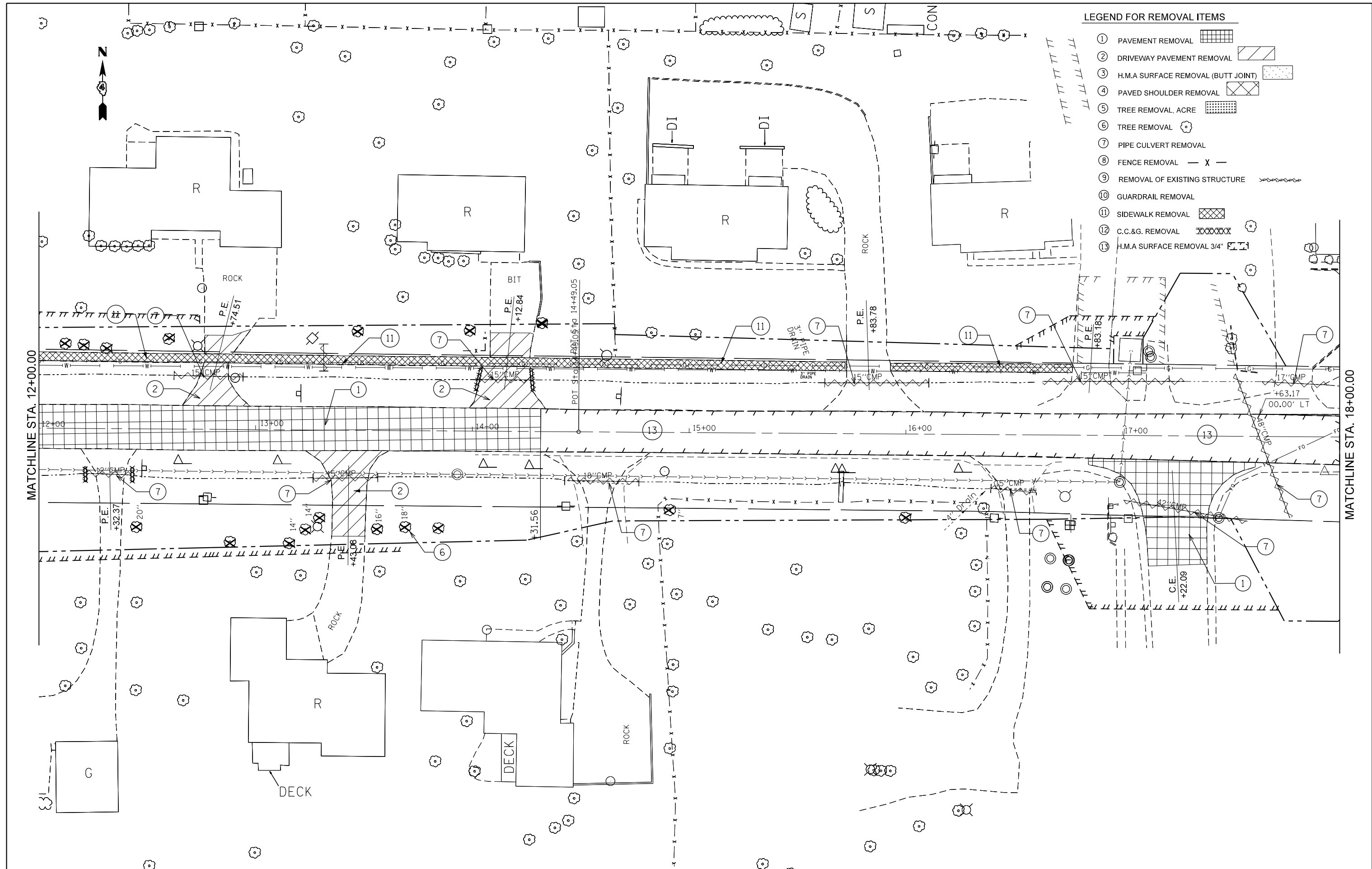

FILE NAME =	USER NAME = crespole	DESIGNED -	REVISED -
et:\pw_work\p\midot\crespole\d0330150\048792-LHR.REMOVALSHT1.DGN		DRAWN -	REVISED -
Default	PLOT SCALE = 40.0000' / in.	CHECKED -	REVISED -
	PLOT DATE = 8/15/2013	DATE -	REVISED -

**STATE OF ILLINOIS  
DEPARTMENT OF TRANSPORTATION**

**LEGION HALL ROAD  
REMOVAL PLANS**

SCALE:      SHEET      OF      SHEETS      STA.      TO      STA.

F.A.S. RTE.	SECTION	COUNTY	TOTAL SHEETS	SHEET NO.
1380	7W-1,RS-3	Peoria	617	79
CONTRACT NO. 88792			ILLINOIS FED. AID PROJECT	