

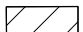

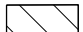

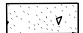

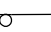

- LEGEND:**
-  Work Area
 -  Proposed Widening
 -  Temporary Pavement
 -  Drum with steady burning light, 25' c.c.
 -  Arrow Board
 -  Sign
 -  Open Traffic Lane
 -  Type III Barricade
 -  Class "C" Patch

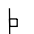

FILE NAME =	USER NAME = crespole	DESIGNED -	REVISED -
ei:\pw_work\pwidot\crespole\d0348685\048792-SHT-STAGE3.DGN		DRAWN -	REVISED -
Default	PLOT SCALE = 40.0000' / in.	CHECKED -	REVISED -
	PLOT DATE = 8/15/2013	DATE -	REVISED -

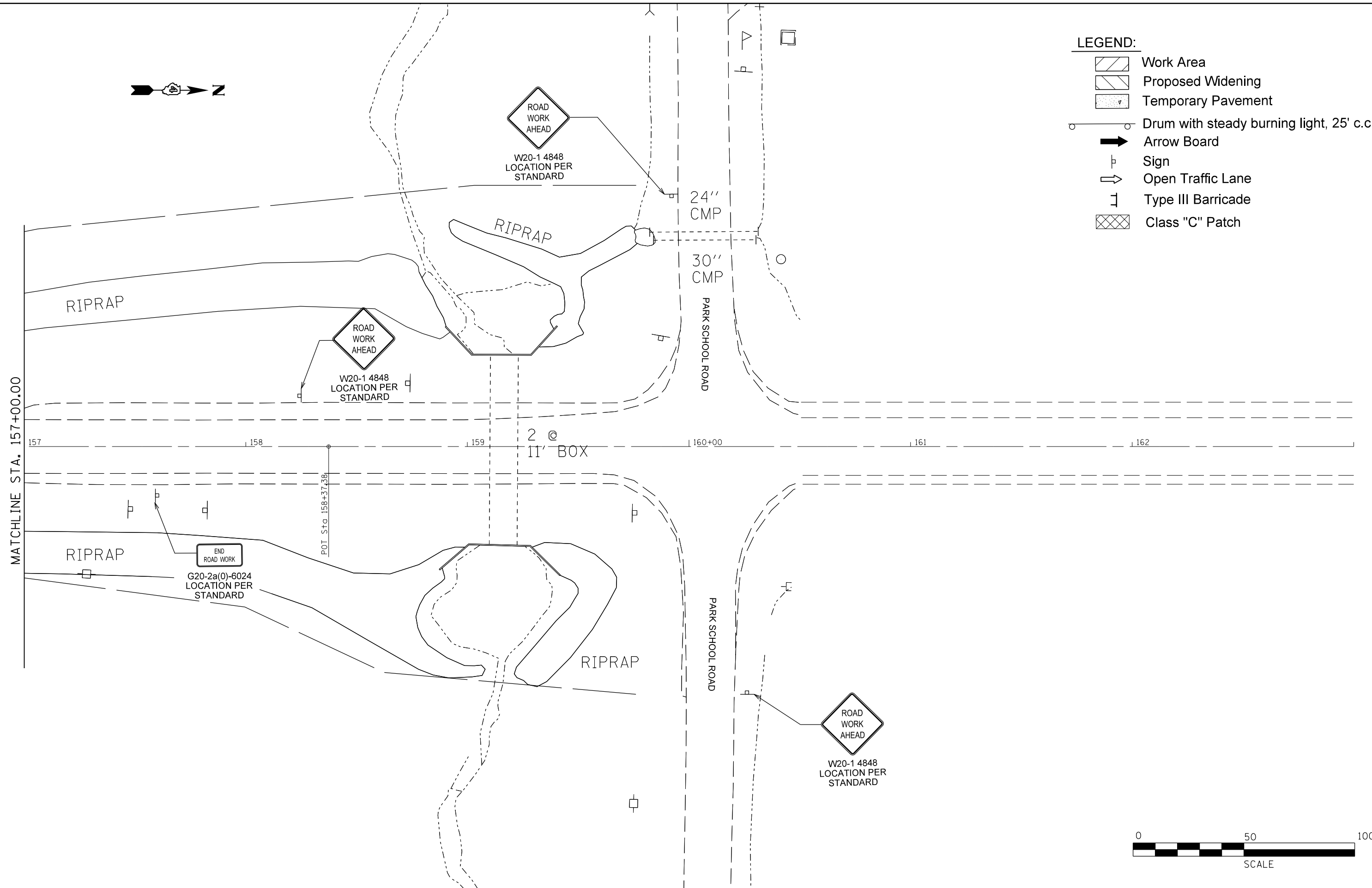
**STATE OF ILLINOIS
DEPARTMENT OF TRANSPORTATION**

**TRAFFIC CONTROL PLANS
STAGE 3**

SCALE: SHEET OF SHEETS STA. TO STA.

F.A.S. RTE.	SECTION	COUNTY	TOTAL SHEETS	SHEET NO.
1380	7W-1,RS-3	Peoria	617	172
CONTRACT NO. 88792			ILLINOIS FED. AID PROJECT	