





**LEGEND:**

-  Inlet and Pipe Protection
-  Temporary Ditch Check
-  Perimeter Erosion Barrier
-  Direction of the flow
-  Grading and Shaping Ditches

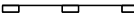

NOTE:  
All Erosion Control measures on the eastside of IL 91 were established during the previous stages.

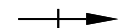
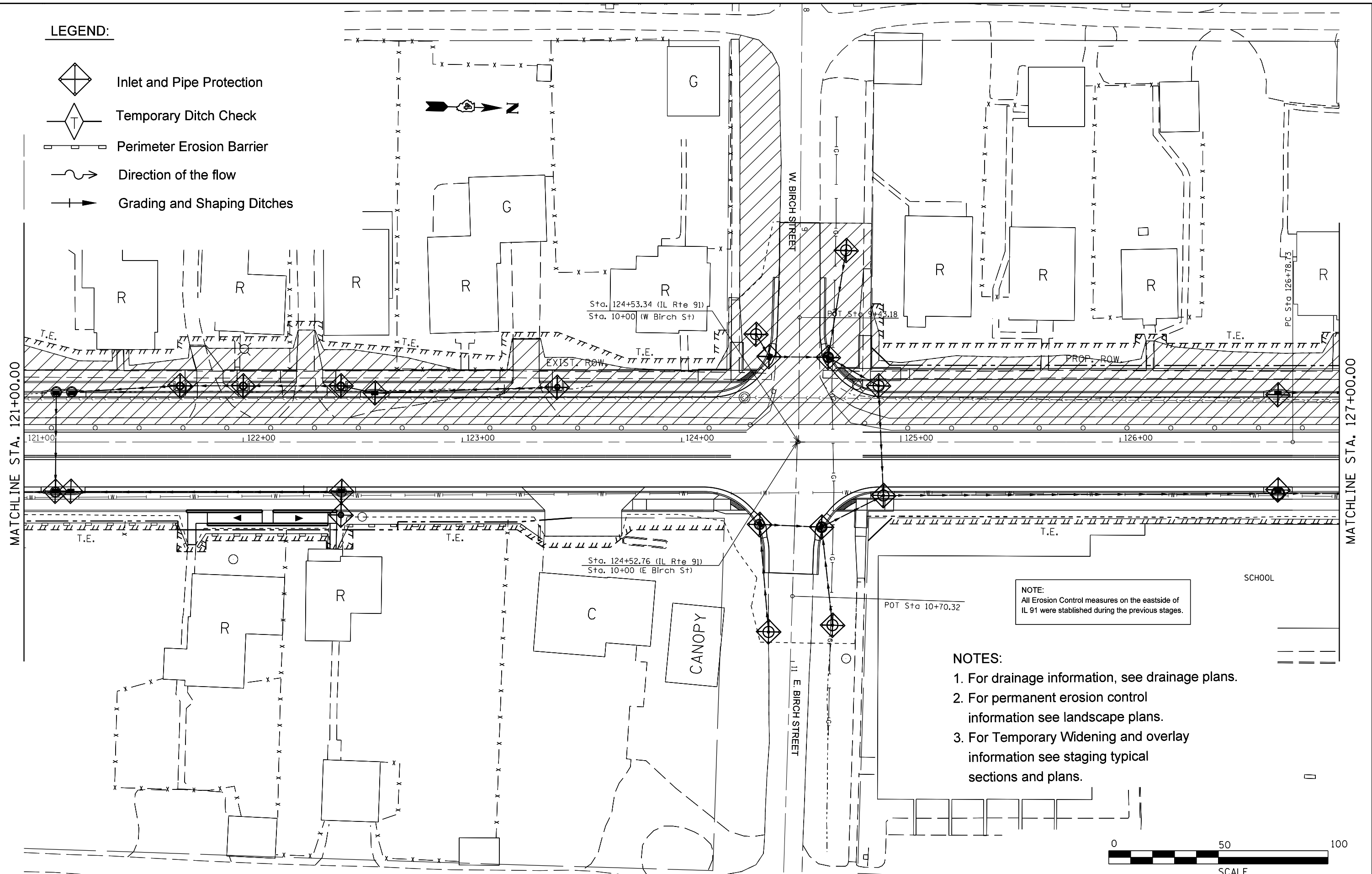
- NOTES:**
1. For drainage information, see drainage plans.
  2. For permanent erosion control information see landscape plans.
  3. For Temporary Widening and overlay information see staging typical sections and plans.



|             |                      |            |           |
|-------------|----------------------|------------|-----------|
| FILE NAME = | USER NAME = crespole | DESIGNED - | REVISED - |
| Default     | Default              | DRAWN -    | REVISED - |
|             |                      | CHECKED -  | REVISED - |
|             |                      | DATE -     | REVISED - |

**STATE OF ILLINOIS  
DEPARTMENT OF TRANSPORTATION**

**EROSION CONTROL PLANS  
STAGE 3**

SCALE: SHEET OF SHEETS STA. TO STA.

|                    |           |        |                           |           |
|--------------------|-----------|--------|---------------------------|-----------|
| F.A.S. RTE.        | SECTION   | COUNTY | TOTAL SHEETS              | SHEET NO. |
| 1380               | 7W-1,RS-3 | Peoria | 617                       | 214       |
| CONTRACT NO. 88792 |           |        | ILLINOIS FED. AID PROJECT |           |