

ALL EXISTING UTILITIES LOCATIONS AND DEPTHS TO BE VERIFIED PRIOR TO ALL DRILLING AND BORES.

WATER VALVES, 8"	
LOCATION	
LT. STA. 81+87±	1 EA.
SHEET TOTAL	1 EA.

WATER MAIN, 8"	
LOCATION	
LT. STA. 81+85± TO STA. 86+00	410 FT.
SHEET TOTAL	410 FT.

**PLAN VIEW**

SCALE: 1" = 20'

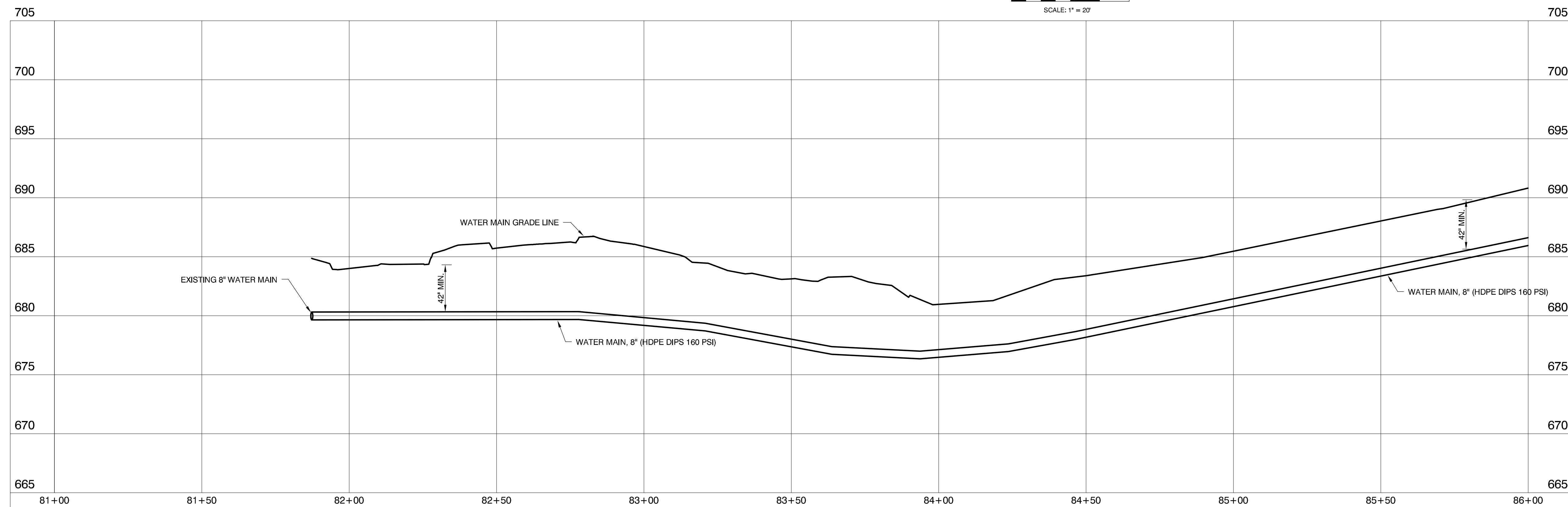
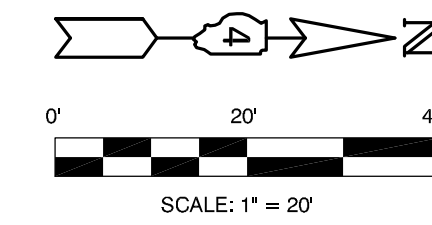

**PROFILE VIEW**

SCALE: 1" = 20' HOR  
1" = 5' VER

**M** MOHR & KERR ENGINEERING & LAND SURVEYING, P.C.  
7336 N. University Ave. Office: (309) 692-8500  
Peoria, Illinois 61614 Fax: (309) 692-8501  
www.mohrandkerr.com Professional Design Firm #184.005091

DESIGNED	WFS	REVISED
DRAWN	DEH	REVISED
CHECKED	WFS	REVISED
DATE	08-30-13	REVISED

STATE OF ILLINOIS  
DEPARTMENT OF TRANSPORTATION

IL RTE 91 WATER MAIN PLANS PLAN AND PROFILE SHEET	
SCALE: 1" = 20'	SHEET NO. 4 OF 17 SHEETS
STA. 81+50	TO STA. 86+00

F.A. ROUTE	SECTION	COUNTY	TOTAL SHEETS	SHEET NO.
1380	7W-1, RS-3	PEORIA	617	258
CONTRACT NO. 88792				
ILLINOIS FEDERAL ROAD DIST NO.				