

PLAN VIEW

SCALES: 1" = 20' HOR

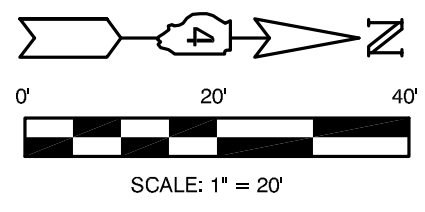

ALL EXISTING UTILITIES LOCATIONS AND DEPTHS TO BE VERIFIED PRIOR TO ALL DRILLING AND BORES.

FIRE HYDRANTS TO BE REMOVED

LOCATION	QUANTITY
RT. STA. 134+21	1 EA.
RT. STA. 136+76	1 EA.
SHEET TOTAL	2 EA.

WATER MAIN TEE 8"x6"

LOCATION	QUANTITY
RT. STA. 136+73	1 EA.
RT. STA. 139+63.5	1 EA.
SHEET TOTALS	2 EA.

WATER SERVICE CONNECTION

LOCATION	QUANTITY
RT. STA. 135+41 (2) (RELOCATE VAULT)	1 EA.
RT. STA. 136+52	1 EA.
LT. STA. 137+49	1 EA.
RT. STA. 137+89	1 EA.
RT. STA. 138+47	1 EA.
LT. STA. 138+84	1 EA.
RT. STA. 139+41	1 EA.
SHEET TOTALS	7 EA.

FIRE HYDRANT AND VALVE (SPECIAL)

LOCATION	QUANTITY
42 RT. STA. 136+73	1 EA.
48 RT. STA. 139+63.5	1 EA.
SHEET TOTALS	2 EA.

WATER VALVES, 8"

LOCATION	QUANTITY
RT. STA. 136+78	1 EA.
SHEET TOTALS	1 EA.

WATER MAIN, 8"

LOCATION	QUANTITY
RT. STA. 134+00 TO STA. 140+00	601 FT.
SHEET TOTAL	601 FT.

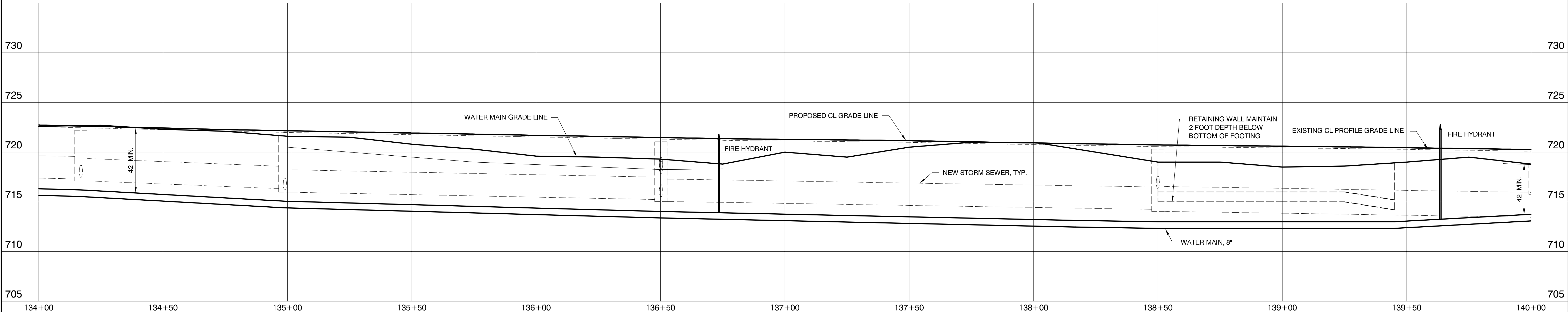

PROFILE VIEW

SCALES: 1" = 20' HOR, 1" = 5' VER

M MOHR & KERR ENGINEERING & LAND SURVEYING, P.C.
 7336 N. University Ave. Office: (309) 692-8500
 Peoria, Illinois 61614 Fax: (309) 692-9501
 www.mohrandkerr.com Professional Design Firm #184.005091

DESIGNED	WFS	REVISED
DRAWN	DEH	REVISED
CHECKED	WFS	REVISED
DATE	08-30-13	REVISED

STATE OF ILLINOIS
DEPARTMENT OF TRANSPORTATION

IL RTE 91
WATER MAIN PLANS
PLAN AND PROFILE SHEET

SCALE: 1" = 20' SHEET NO. 13 OF 17 SHEETS STA. 134+00 TO STA. 140+00

F.A. ROUTE	SECTION	COUNTY	TOTAL SHEETS	SHEET NO.
1380	7W-1, RS-3	PEORIA	617	267
CONTRACT NO. 88792				
ILLINOIS FEDERAL ROAD DIST NO.				