

**ELEVATION**

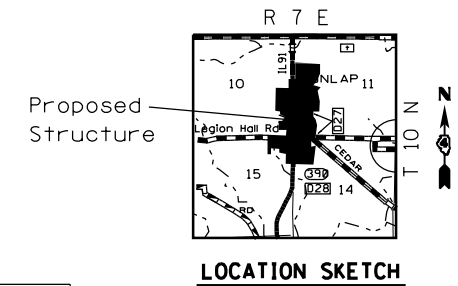

POINT	STATION	OFFSET
B1	120+54.94	31.75 Rt.
B2	121+74.17	31.75 Rt.
B3	121+78.66	37.42 Rt.
B4	122+38.66	37.42 Rt.
B5	122+42.66	31.75 Rt.
B6	123+37.62	31.75 Rt.

**WALL CONTROL POINTS**  
 Wall offsets are measured from  $\phi$  IL 91 to the front face of wall panels

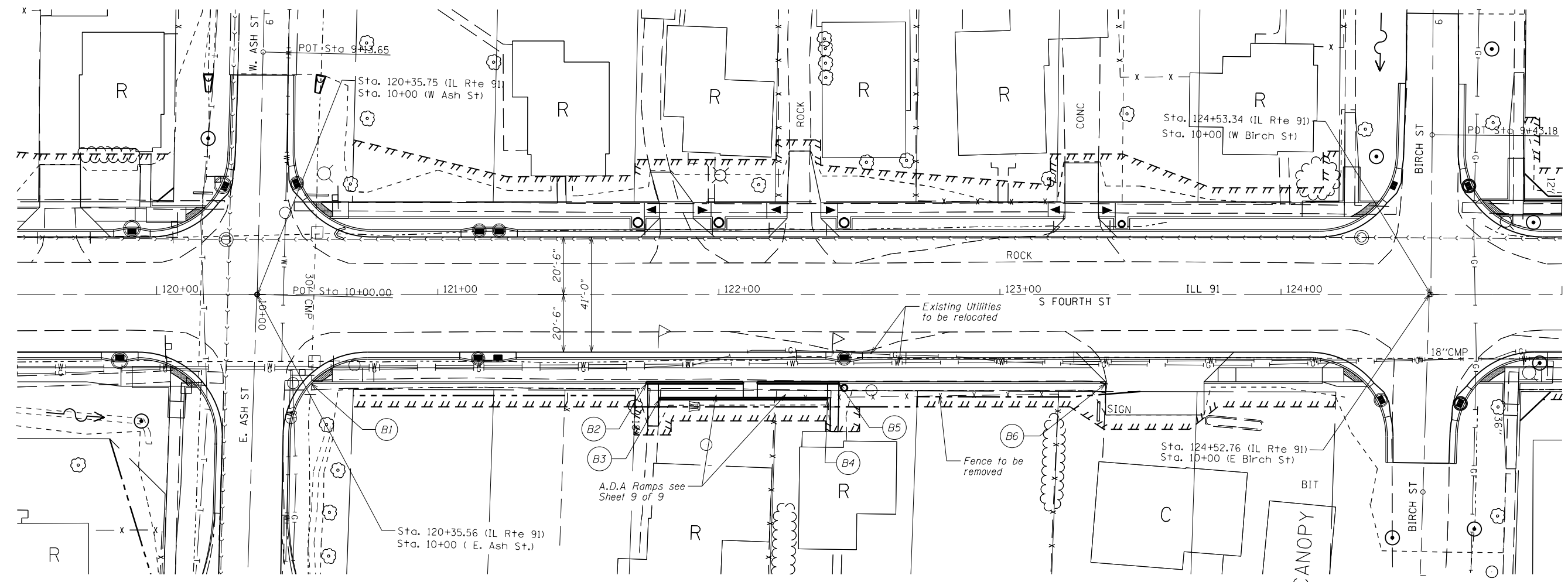

**PLAN**

**GENERAL PLAN & ELEVATION**  
**CONCRETE WALL & RAMP**  
**F.A.S 1380 - SEC 7W-1, RS-3**  
**PEORIA COUNTY**  
**RT STATION 120+54.94 TO 123+37.62**

**DESIGN STRESSES**  
**FIELD UNITS**  
 $f'_c = 3,500$  psi  
 $f_y = 60,000$  psi (Reinforcement)

FILE NAME =	USER NAME = crespole	DESIGNED -	REVISED -	<b>STATE OF ILLINOIS DEPARTMENT OF TRANSPORTATION</b>	<b>GENERAL PLAN AND ELEVATION CONCRETE WALL &amp; RAMP</b>		F.A.S. R.T.E.	SECTION	COUNTY	TOTAL SHEETS	SHEET NO.
Default	PLOT SCALE = 40.0000' / in.	DRAWN -	REVISED -				1380	7W-1,RS-3	Peoria	617	312
	PLOT DATE = 8/15/2013	CHECKED -	REVISED -		SCALE: SHEET 1 OF 9 SHEETS STA. TO STA.		CONTRACT NO. 88792				
		DATE -	REVISED -		ILLINOIS FED. AID PROJECT						