

DATE	
BY	
FINAL SURVEY NO.	
SURVEYED	
PLOTTED	
TEMPLATE	
AREAS CHECKED	

DATE	
BY	
ORIGINAL SURVEY NO.	
SURVEYED	
PLOTTED	
TEMPLATE	
AREAS CHECKED	

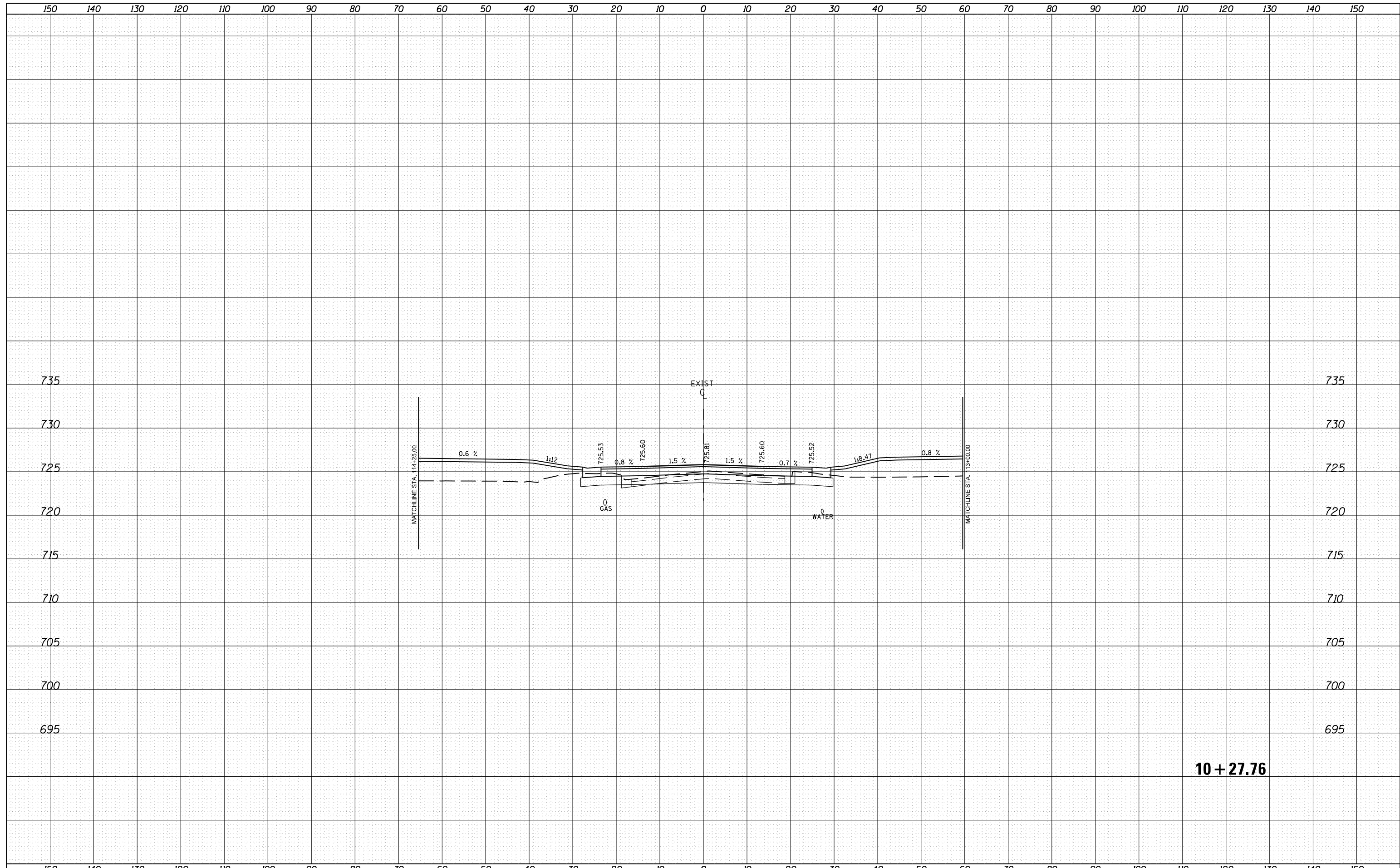

10+27.76

FILE NAME =	USER NAME = crespole	DESIGNED -	REVISED -	STATE OF ILLINOIS DEPARTMENT OF TRANSPORTATION	N. CASTLE DRIVE CROSS SECTIONS			F.A.S. RTE.	SECTION	COUNTY	TOTAL SHEETS	SHEET NO.
c:\pwork\pwork\crespole\10330150\10488792-sh	xssideroad.dgn	DRAWN -	REVISED -					1380	7W-1,RS-3	Peoria	617	562
Default	PLOT SCALE = 20.0000' / in.	CHECKED -	REVISED -		SCALE: SHEET OF SHEETS STA. 10+27.76 TO STA. 10+27.76			CONTRACT NO. 88792				
	PLOT DATE = 8/16/2013	DATE -	REVISED -		ILLINOIS FED. AID PROJECT							