

STATE OF ILLINOIS
DEPARTMENT OF TRANSPORTATION
DIVISION OF HIGHWAYS
PROPOSED
HIGHWAY PLANS

F.A.U. ROUTE 7573 (CH 4)
SECTION 13-00117-00-RS
PROJECT NO. RS-0045(051)
HMA INLAY RESURFACING
EDGAR COUNTY
FUNDING STR & STATE MATCH
JOB NO. C-95-303-14

ROUTE	SECTION	COUNTY	TOTAL SHEETS	SHEET NO.
FAU 7573 (CH 4)	13-00117-00-RS	EDGAR	17	1

CONTRACT NO. 91504

INDEX OF SHEETS

SHEET NO.	DESCRIPTION
1	COVER SHEET
2	GENERAL NOTES
3	SUMMARY OF QUANTITIES
4-6 (INCL)	SCHEDULES OF QUANTITIES
7-8	EXISTING TYPICAL CROSS SECTIONS
9-10	PROPOSED TYPICAL CROSS SECTIONS
11-14 (INCL)	PLAN SHEETS
15-17 (INCL)	PAVEMENT MARKING AND MARKER DETAILS

ILLINOIS HIGHWAY STANDARD DRAWINGS

000001-06	STANDARD SYMBOLS, ABBREVIATIONS & PATTERNS
701006-05	OFF-ROAD OPERATIONS, 2-LANE, 2-WAY, 15' TO 24" FROM PAVEMENT EDGE
701011-04	OFF-ROAD MOVING OPERATIONS, 2-LANE, 2-WAY, DAYTIME ONLY
701301-04	LANE CLOSURE, 2-LANE, 2-WAY, SHORT TIME OPERATIONS
701311-03	LANE CLOSURE, 2-LANE, 2-WAY, MOVING OPERATIONS, DAYTIME ONLY
701501-06	URBAN LANE CLOSURE, 2 LANE, 2 WAY, UNDIVIDED
701502-06	URBAN LANE CLOSURE, 2 LANE, 2 WAY, WITH BIDIRECTIONAL LEFT TURN LANE
701901-03	TRAFFIC CONTROL DEVICES
780001-04	TYPICAL PAVEMENT MARKINGS
781001-03	TYPICAL APPLICATION RAISED REFLECTIVE PAVEMENT MARKERS
886001-01	DETECTOR LOOP INSTALLATIONS
886006-01	TYPICAL LAYOUTS FOR DETECTOR LOOPS

STRUCTURAL DESIGN TRAFFIC	YEAR	2022
PV = 7,298 (97.3%)	SU = 165 (2.2%)	MU = 38 (0.5%)
ROAD/STREET CLASSIFICATION CLASS II		
PERCENT OF STRUCTURAL DESIGN TRAFFIC IN DESIGN LANE		
P = 55%	S = 55%	M = 55%
TRAFFIC FACTOR Actual TF = 0.447 AC Type = PG 64-22		
Minimum TF = 0.5		
PG GRADE: Surface = 64-22		

AARON M. LAWSON
PROFESSIONAL ENGINEER
 NO. 062-051230
 EXPIRES 11-30-2013

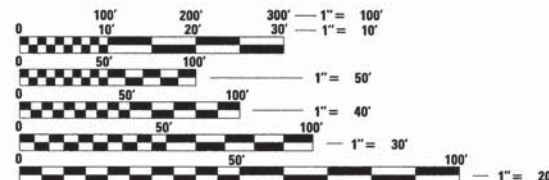

FULL SIZE PLANS HAVE BEEN PREPARED USING STANDARD ENGINEERING SCALES. REDUCED SIZED PLANS WILL NOT CONFORM TO STANDARD SCALES. IN MAKING MEASUREMENTS ON REDUCED PLANS, THE ABOVE SCALES MAY BE USED.

J.U.L.I.E.
 JOINT UTILITY LOCATION INFORMATION FOR EXCAVATION
 1-800-892-0123
 OR 811

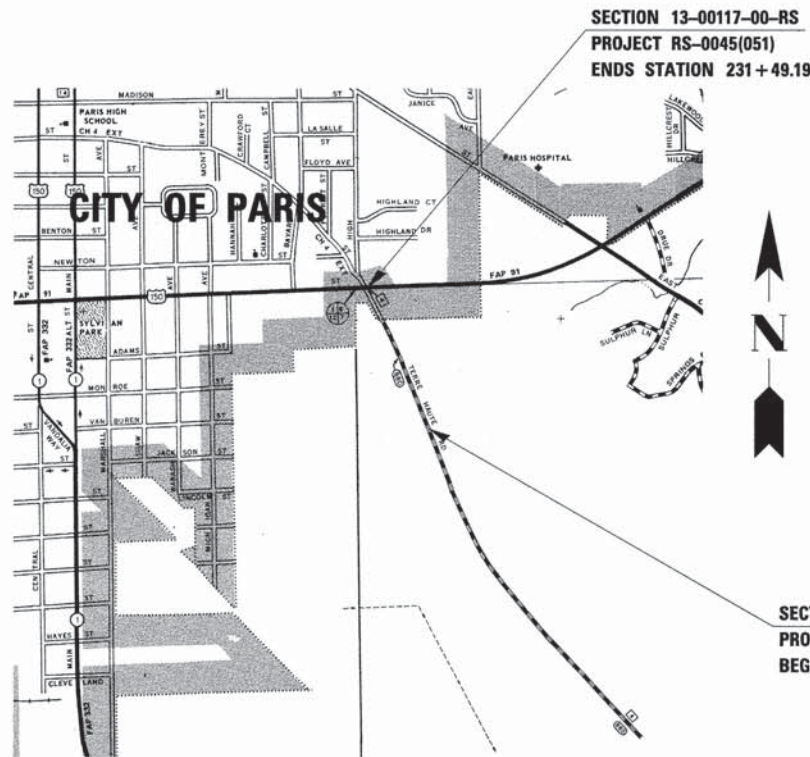

MAP NOT TO SCALE

GROSS LENGTH = 1,807.06 FT. = 0.342 MILES
NET LENGTH = 1,807.06 FT. = 0.342 MILES



LOCATION OF SECTION INDICATED THUS: - [shaded area symbol]

AGENCY RESPONSIBLE FOR LETTING

APPROVED *[Signature]* 10/11/13 20 13
 EDGAR COUNTY ENGINEER

PASSED *[Signature]* October 21, 2013
 DISTRICT FIVE ENGINEER OF LOCAL ROADS AND STREETS

RELEASING FOR BID
 BASED ON LIMITED REVIEW *[Signature]* 10/21/13 20 13
 DEPUTY DIRECTOR OF HIGHWAYS, REGION THREE ENGINEER
 STATE OF ILLINOIS
 DEPARTMENT OF TRANSPORTATION

ROUTE: FAS 680 (CH 4) EDGAR COUNTY DESCRIPTION INLAY LOWER T SOUTH EDGE OF WAL-MART TO US 150 SECTION: 13-00117-00-RS

ROUTE	SECTION	COUNTY	TOTAL SHEETS	SHEET NO.
FAU 7573 (CH 4)	13-00117-00-RS	EDGAR	17	2
EDGAR COUNTY, ILLINOIS			CONTRACT NO. 91504	
			FED. AID PROJECT	

G.N.-100

ENGLISH UNITS OF MEASUREMENT SHALL GOVERN OVER AND SUPERSEDE ANY METRIC UNITS SHOWN IN THIS CONTRACT. WHERE INCLUDED, METRIC UNITS ARE FOR INFORMATION ONLY.

G.N.-406

THE QUANTITIES INCLUDED IN THE PLANS FOR HOT-MIX ASPHALT RESURFACING ARE INTENDED TO GIVE THE COVERAGE SHOWN ON THE TYPICAL CROSS SECTIONS. IT IS NOT INTENDED TO INCREASE THE THICKNESS OF THE HOT-MIX ASPHALT MIXTURE IN ORDER TO USE ALL OF THE QUANTITIES INCLUDED IN THE CONTRACT.

G.N. -406H

MIXTURE REQUIREMENTS

The following mixture requirements are applicable for this project:

Location(s):	Station 213+42.13 to Station 231+49.19	
Mixture Use(s):	Surface Course	
AC/PG:	SBF PG 70-22	
RAP %: (Max)	*	
Design Air Voids:	4.0% @Ndes=70	
Mixture Composition: (Gradation Mixture)	IL 9.5	
Friction Aggregate:	Mix D	

* See RAP/RAS Special Provision

G.N.-703A (REV)

SHORT TERM PAVEMENT MARKING SHALL BE APPLIED TO THE PAVEMENT AFTER HMA SURFACE REMOVAL AND PLACING THE SURFACE COURSE. SHORT TERM PAVEMENT MARKING PLACED ON THE SURFACE, SHALL COINCIDE WITH THE FINAL PAVEMENT STRIPING. USE 4 FEET PER 40 FEET (OR 10% PER STATION).

GENERAL NOTES (CONT'D)

G.N.-781(REV)

RAISED REFLECTIVE PAVEMENT MARKERS SHALL BE PLACED IN ACCORDANCE WITH THE DETAIL INCLUDED IN THE PLANS. THE FINAL PAVEMENT MARKINGS SHALL BE IN PLACE PRIOR TO PLACING THE RAISED REFLECTIVE PAVEMENT MARKERS. THE RAISED REFLECTIVE PAVEMENT MARKERS SHALL BE PLACED MIDWAY IN THE 30 FOOT SPACE BETWEEN THE DASHED CENTERLINE STRIPES.

G.N. - 886

EXISTING DETECTOR LOOPS IN THE AREAS OF PROPOSED SURFACE REMOVAL SHALL BE REPLACED PER THE EXISTING SIZE AND LOCATION EXCEPT AS NOTED IN THE PLANS. EXISTING DETECTOR LOOPS SHALL BE DISCONNECTED AT THE GULFBOX JUNCTION OR HANDHOLE PRIOR TO COLD MILLING AT THAT RESPECTIVE LOCATION. NEW DETECTOR LOOPS SHALL BE CONNECTED TO THE RESPECTIVE EXISTING AMPLIFIER. IN GENERAL, ADVANCED DETECTOR LOOPS FOR DILEMMA ZONE PROTECTION LOCATED AT THE SAME STATION SHALL BE GROUPED TOGETHER ON A COMMON AMPLIFIER AND PRESENCE LOOPS SHALL BE GROUPED BY LANE ON A COMMON AMPLIFIER UNLESS OTHERWISE NOTED IN THE PLANS.

WHERE IT IS NECESSARY TO INSTALL MORE THAN ONE LOOP HOMERUN IN A CONDUIT, HOMERUNS SHARING THE SAME CONDUIT SHALL BE ON A COMMON AMPLIFIER.

G.N.-1004.01

COARSE AGGREGATE GRADATION CA-10 MAY BE USED WHENEVER COARSE AGGREGATE CA-6 IS SPECIFIED IN THE STANDARD SPECIFICATIONS.



ROUTE	SECTION	COUNTY	TOTAL SHEETS	SHEET NO.
FAU 7573 (CH 4)	13-00117-00-R5	EDGAR	17	3
		CONTRACT NO. 91504		
EDGAR COUNTY, ILLINOIS		FED. AID PROJECT		

SUMMARY OF QUANTITIES

<u>ITEM NO.</u>	<u>DESCRIPTION</u>	<u>UNIT</u>	<u>QUANTITY</u>
40600100	BITUMINOUS MATERIALS (PRIME COAT)	GALLON	745
40600300	AGGREGATE (PRIME COAT)	TON	11
40600982	HOT-MIX ASPHALT SURFACE REMOVAL - BUTT JOINT	SQ YD	121
40600990	TEMPORARY RAMP	SQ YD	414
40603540	POLYMERIZED HOT-MIX ASPHALT SURFACE COURSE, MIX "D", N70	TON	625
44000155	HOT-MIX ASPHALT SURFACE REMOVAL, 1 1/2"	SQ YD	5,477
44003510	MEDIAN REMOVAL PARTIAL DEPTH	SQ FT	225
48102100	AGGREGATE WEDGE SHOULDER, TYPE B	TON	45
60266600	VALVE BOXES TO BE ADJUSTED	EACH	2
60300105	FRAMES AND GRATES TO BE ADJUSTED	EACH	1
67100100	MOBILIZATION	L SUM	1
70102620	TRAFFIC CONTROL AND PROTECTION, STANDARD 701501	L SUM	1
70102622	TRAFFIC CONTROL AND PROTECTION, STANDARD 701502	L SUM	1
70300100	SHORT TERM PAVEMENT MARKING	FOOT	608
70301000	WORK ZONE PAVEMENT MARKING REMOVAL	SQ FT	101
* 78000100	THERMOPLASTIC PAVEMENT MARKING - LETTERS AND SYMBOLS	SQ FT	203
* 78000200	THERMOPLASTIC PAVEMENT MARKING - LINE 4"	FOOT	7,928
* 78000400	THERMOPLASTIC PAVEMENT MARKING - LINE 6"	FOOT	125
* 78000600	THERMOPLASTIC PAVEMENT MARKING - LINE 12"	FOOT	231
* 78000650	THERMOPLASTIC PAVEMENT MARKING - LINE 24"	FOOT	37
* 78100100	RAISED REFLECTIVE PAVEMENT MARKER	EACH	86
* 88600100	DETECTOR LOOP, TYPE I	FOOT	233
X4401198	HOT-MIX ASPHALT SURFACE REMOVAL, VARIABLE DEPTH	SQ YD	176
* X7830068	GROOVING FOR RECESSED PAVEMENT MARKING, LETTERS, NUMBERS AND SYMBOLS	SQ FT	640
* X7830070	GROOVING FOR RECESSED PAVEMENT MARKING 5"	FOOT	3,132
* X7830074	GROOVING FOR RECESSED PAVEMENT MARKING 7"	FOOT	125
* X7830077	GROOVING FOR RECESSED PAVEMENT MARKING 11"	FOOT	2,866
* X7830078	GROOVING FOR RECESSED PAVEMENT MARKING 13"	FOOT	231
* X7830090	GROOVING FOR RECESSED PAVEMENT MARKING 25"	FOOT	37

* SPECIALTY ITEM



SCHEDULES OF QUANTITIES

ROUTE	SECTION	COUNTY	TOTAL SHEETS	SHEET NO.
FAU 7573 (CH 4)	13-00117-00-R5	EDGAR	17	4
EDGAR COUNTY, ILLINOIS			CONTRACT NO. 91504	
FED. AID PROJECT				

POLYMERIZED HOT MIX ASPHALT SURFACE COURSE, MIX D, N70

STATION	TO	STATION	LENGTH	WIDTH	40600100	40600300	40603540	
					GALLONS	TONS	TONS	
					PRIME COAT	AGG PRIME	SURFACE	
213+42.13		218+30.84	488.71	24+34/2	170.8	2.52	143.3	
218+30.84		228+82.00	1,051.16	36.00	440.8	6.51	369.8	
228+82.00		230+66.90	184.90	36+30.97/2	72.1	1.06	60.5	
230+66.90		231+49.19	82.29	30.97+32.67/2	30.5	0.45	25.6	
RIGHT TURN AREA					AREA FROM PLANS	22.6	0.33	19.0
SOUTHWEST RADIUS AREA					AREA FROM PLANS	1.0	0.01	0.8
RT 218+30.84		RT 219+63	116.52	2.50	3.4	0.05	2.8	
RT 225+08		RT 226+43	118.64	2.70	3.7	0.06	3.1	
TOTALS =					745	11	625	
					GALLONS	TONS	TONS	

40600982 HMA SURFACE REMOVAL - BUTT JOINT

STATION	TO	STATION	LENGTH	WIDTH	SQ YDS
213+42.13		213+87.13	45.00	24+24.54/2	121
TOTAL =					121 SQ YDS

40600990 TEMPORARY RAMP

STATION	TO	STATION	LENGTH	WIDTH	SQ YDS
213+42.13		213+47.13	5.00	24.00	13.33
RT 218+46.08		RT 219+47.10	5.00	101.02	56.09
LT 219+00		LT 219+20	5.00	20.00	11.11
LT 220+44		LT 220+72	5.00	28.00	15.55
RT 221+88		RT 222+52	5.00	64.00	35.54
RT 225+24.82		RT 226+27.59	5.00	102.77	57.07
LT 225+80		LT 226+12	5.00	32.00	17.77
LT 227+50		LT 227+77	5.00	27.00	14.99
RT 228+36		RT 228+88	5.00	52.00	28.87
LT 229+00		LT 229+32	5.00	32.00	17.77
LT 229+47		LT 229+87	5.00	40.00	22.21
LT 230+05		LT 230+48	5.00	43.00	23.88
LT 230+88		LT 231+27	5.00	39.00	21.66
231+44.19		231+49.19	5.00	140.79	78.18
TOTAL =					414 SQ YDS

44000155 HMA SURFACE REMOVAL 1 1/2"

STATION	TO	STATION	LENGTH	WIDTH	SQ YDS	
218+30.84		228+82.00	1,051.16	36.00	4,204.9	
228+82.00		230+66.90	184.90	36+30.97/2	688.0	
230+66.90		231+49.19	82.29	30.97+32.67/2	291.0	
RIGHT TURN AREA					AREA FROM PLANS	215.7
SOUTHWEST RADIUS AREA					AREA FROM PLANS	9.5
RT 218+30.84		RT 219+63	116.52	2.50	32.4	
RT 225+08		RT 226+43	118.64	2.70	35.6	
TOTAL =					5,477 SQ YDS	

44003510 MEDIAN REMOVAL PARTIAL DEPTH

STATION	TO	STATION	LENGTH	WIDTH	SQ FT
230+64.58		231+25.47	60.89	VAR	225
TOTAL =					225 SQ FT

48102100 AGGREGATE WEDGE SHOULDER, TYPE B

STATION	TO	STATION	LENGTH	WIDTH	TONS
LT 213+42.13		LT 218+61	518.87	3.00	18.0
RT 213+42.13		RT 217+92	449.87	3.00	15.6
RT 218+08		RT 218+30.84	22.84	3.00	0.8
LT 219+60		LT 220+46	86.00	3.00	3.0
LT 220+69		LT 222+87.50	218.50	3.00	7.6
TOTAL =					45 TONS

60266600 VALVE BOXES TO BE ADJUSTED

STATION	EACH	
RT 224+21.39	1	
RT 231+37.10	1	
TOTAL =		2 EACH

60300105 FRAMES AND GRATES TO BE ADJUSTED

STATION	EACH
RT 221+28.02	1

70300100 SHORT TERM PAVEMENT MARKING

STATION	TO	STATION	DISTANCE	FOOT
LT 213+42.13		LT 218+30.84	488.71	48
RT 213+42.13		RT 218+30.84	488.71	48
LT 219+34		LT 221+88	254.00	24
RT 219+34		RT 221+88	254.00	24
LT 222+52		LT 225+41	289.00	28
RT 222+52		RT 225+41	289.00	28
LT 226+04		LT 231+26	522.00	52
RT 226+04		RT 231+26	522.00	52
TOTAL PER APPLICATION =				304 FOOT
PROJECT TOTAL =				608 FOOT

ASSUME: 4 FOOT IN 40 FOOT OR 10%
ASSUME: 2 APPLICATIONS

70301000 WORK ZONE PAVEMENT MARKING REMOVAL

STATION	TO	STATION	LENGTH	SQ FT
213+42.13		231+49.19	304.00	101
TOTAL =				101 SQ FT

78000100 THERMOPLASTIC PAVEMENT MARKING - LETTERS & SYMBOLS

STATION	DESCRIPTION	COLOR	PVT MARKING
219+64.00	BI-DIRECT LARGE ARROW	WHITE	15.6
219+88.00	BI-DIRECT LARGE ARROW	WHITE	15.6
221+34.00	BI-DIRECT LARGE ARROW	WHITE	15.6
221+58.00	BI-DIRECT LARGE ARROW	WHITE	15.6
222+82.00	BI-DIRECT LARGE ARROW	WHITE	15.6
223+06.00	BI-DIRECT LARGE ARROW	WHITE	15.6
224+87.00	BI-DIRECT LARGE ARROW	WHITE	15.6
225+11.00	BI-DIRECT LARGE ARROW	WHITE	15.6
226+22.00	LEFT TURN LARGE ARROW	WHITE	15.6
226+70.50	LEFT TURN LARGE ARROW	WHITE	15.6
227+19.00	LEFT TURN LARGE ARROW	WHITE	15.6
228+07.00	BI-DIRECT LARGE ARROW	WHITE	15.6
228+31.00	BI-DIRECT LARGE ARROW	WHITE	15.6

TOTAL = 203 SQ FT



SCHEDULES OF QUANTITIES

ROUTE	SECTION	COUNTY	TOTAL SHEETS	SHEET NO.
FAU 7573 (CH 4)	13-00117-00-RS	EDGAR	17	6
EDGAR COUNTY, ILLINOIS			CONTRACT NO. 91504	
			FED. AID PROJECT	

X7830068 GROOVING FOR RECESSED PAVEMENT MARKING, LETTERS, NUMBERS & SYMBOLS

STATION	DESCRIPTION	LENGTH	WIDTH	SQ FT
219+64	BI-DIRECT LARGE ARROW	8'-1"	6'-1"	49.2
219+88	BI-DIRECT LARGE ARROW	8'-1"	6'-1"	49.2
221+34	BI-DIRECT LARGE ARROW	8'-1"	6'-1"	49.2
221+58	BI-DIRECT LARGE ARROW	8'-1"	6'-1"	49.2
222+82	BI-DIRECT LARGE ARROW	8'-1"	6'-1"	49.2
223+06	BI-DIRECT LARGE ARROW	8'-1"	6'-1"	49.2
224+87	BI-DIRECT LARGE ARROW	8'-1"	6'-1"	49.2
225+11	BI-DIRECT LARGE ARROW	8'-1"	6'-1"	49.2
226+22	LEFT TURN LARGE ARROW	8'-1"	6'-1"	49.2
226+70.50	LEFT TURN LARGE ARROW	8'-1"	6'-1"	49.2
227+19	LEFT TURN LARGE ARROW	8'-1"	6'-1"	49.2
228+07	BI-DIRECT LARGE ARROW	8'-1"	6'-1"	49.2
228+31	BI-DIRECT LARGE ARROW	8'-1"	6'-1"	49.2

TOTAL = 640 SQ YDS

X7830070 GROOVING FOR RECESSED PAVEMENT MARKING, 5"

STATION	TO	STATION	DESCRIPTION	FOOT
LT 213+42.13		LT 229+98	EDGE STRIPE	1,655.87
RT 213+42.13		RT 218+30.84	EDGE STRIPE	488.71
RT 219+63		RT 221+88	EDGE STRIPE	225.00
RT 222+56		RT 225+08	EDGE STRIPE	252.00
LT 226+04		LT 227+19	LT TURN	115.00
RT 226+43		RT 230+38	EDGE STRIPE	395.00

TOTAL = 3,132 FOOT

X7830074 GROOVING FOR RECESSED PAVEMENT MARKING, 7"

STATION	TO	STATION	DESCRIPTION	FOOT
RT 230+94.86		RT 231+13.88	CROSSWALK	22.08
RT 230+96.85		RT 231+16.24	CROSSWALK	22.44
RT 231+22.44		LT 231+37.47	CROSSWALK	39.46
RT 231+28.79		LT 231+44.54	CROSSWALK	41.35

TOTAL = 125 FOOT

X7830077 GROOVING FOR RECESSED PAVEMENT MARKING, 11"

STATION	TO	STATION	DESCRIPTION	FOOT
213+42.13		214+65.36	NO-PASS	123.23
LT 214+65.36		LT 218+30.84	MEDIAN	365.48
RT 214+65.36		LT 218+30.84	MEDIAN	403.18
LT 219+34		LT 221+88	SOLID BI-DIRECT	254
RT 219+34		RT 221+88	SOLID BI-DIRECT	254
LT 222+52		LT 225+41	SOLID BI-DIRECT	289
RT 222+52		RT 225+41	SOLID BI-DIRECT	289
RT 226+04		RT 227+77	LT TURN	173
LT 227+77		LT 228+82	SOLID BI-DIRECT	105
RT 227+77		RT 228+82	SOLID BI-DIRECT	105
LT 228+82		LT 231+25.38	MEDIAN	243.38
RT 228+82		LT 231+25.38	MEDIAN	261.98

TOTAL = 2,866 FOOT

X7830078 GROOVING FOR RECESSED PAVEMENT MARKING, 13"

STATION	TO	STATION	DESCRIPTION	FOOT
215+54.00		218+30.84	MEDIAN DIAGONAL	110.98
228+82.00		231+25.38	MEDIAN DIAGONAL	120.07

TOTAL = 231 FOOT

X7830090 GROOVING FOR RECESSED PAVEMENT MARKING, 25"

STATION	TO	STATION	DESCRIPTION	FOOT
RT 230+91.96		RT 231+12.43	STOP BAR	22.91
RT 231+16.21		RT 231+18.21	STOP BAR	14.06

TOTAL = 37 FOOT



EXISTING TYPICAL CROSS SECTIONS

ROUTE	SECTION	COUNTY	TOTAL SHEETS	SHEET NO.
FAU 7573 (CH 4)	13-00117-00-R5	EDGAR	17	7
EDGAR COUNTY, ILLINOIS			CONTRACT NO. 91504	
EDGAR COUNTY, ILLINOIS			FED. AID PROJECT	

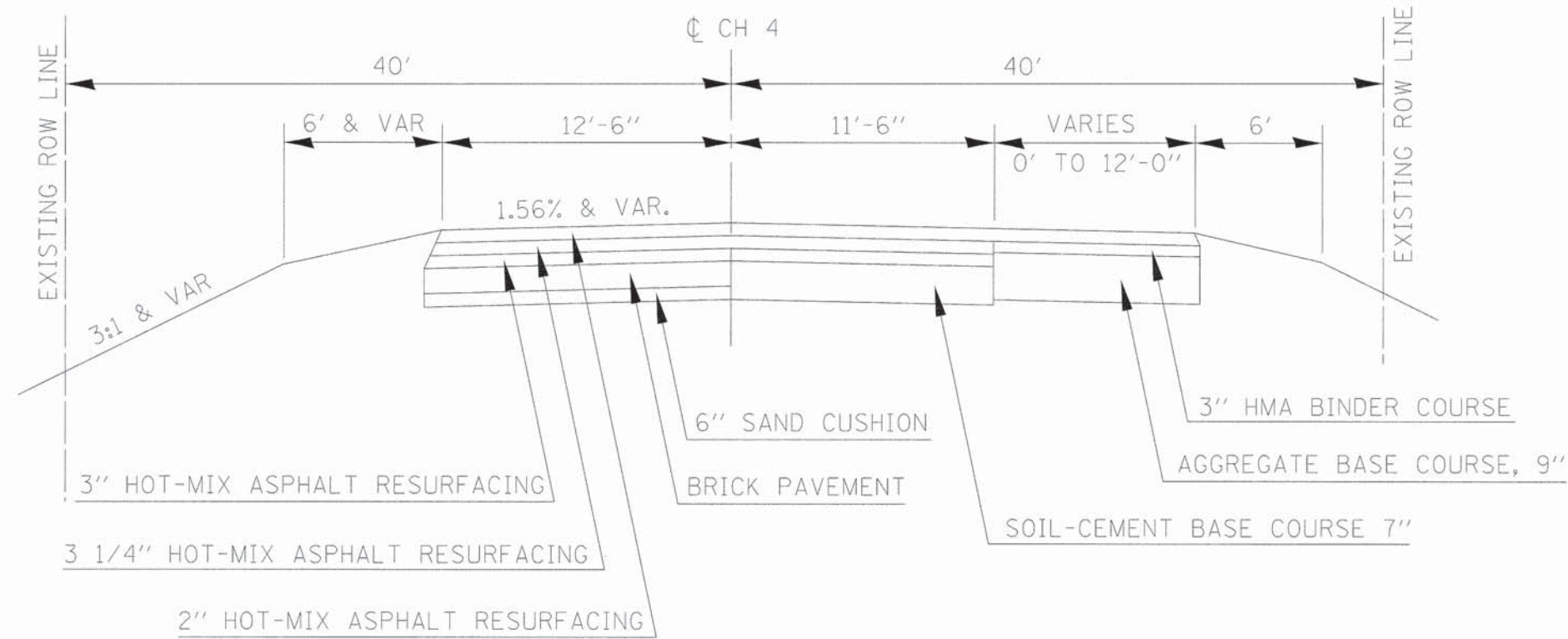

STATION 213+42.13 TO STATION 218+30.84

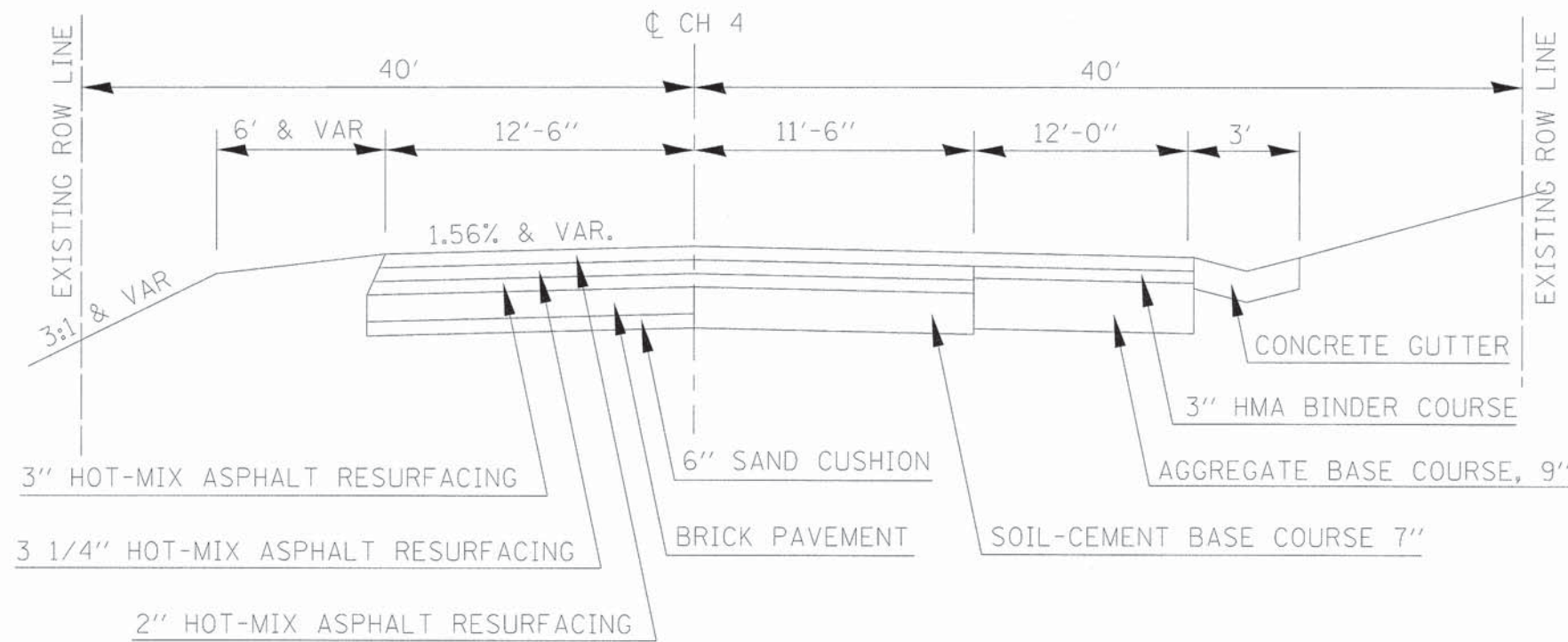

STATION 218+30.84 TO STATION 222+87.50

TYPICAL SECTION



**EDGAR COUNTY
HIGHWAY DEPARTMENT**

EXISTING TYPICAL CROSS SECTIONS

ROUTE	SECTION	COUNTY	TOTAL SHEETS	SHEET NO.
FAU 7573 (CH 4)	13-00117-00-R5	EDGAR	17	8
EDGAR COUNTY, ILLINOIS		CONTRACT NO. 91504		
		FED. AID PROJECT		

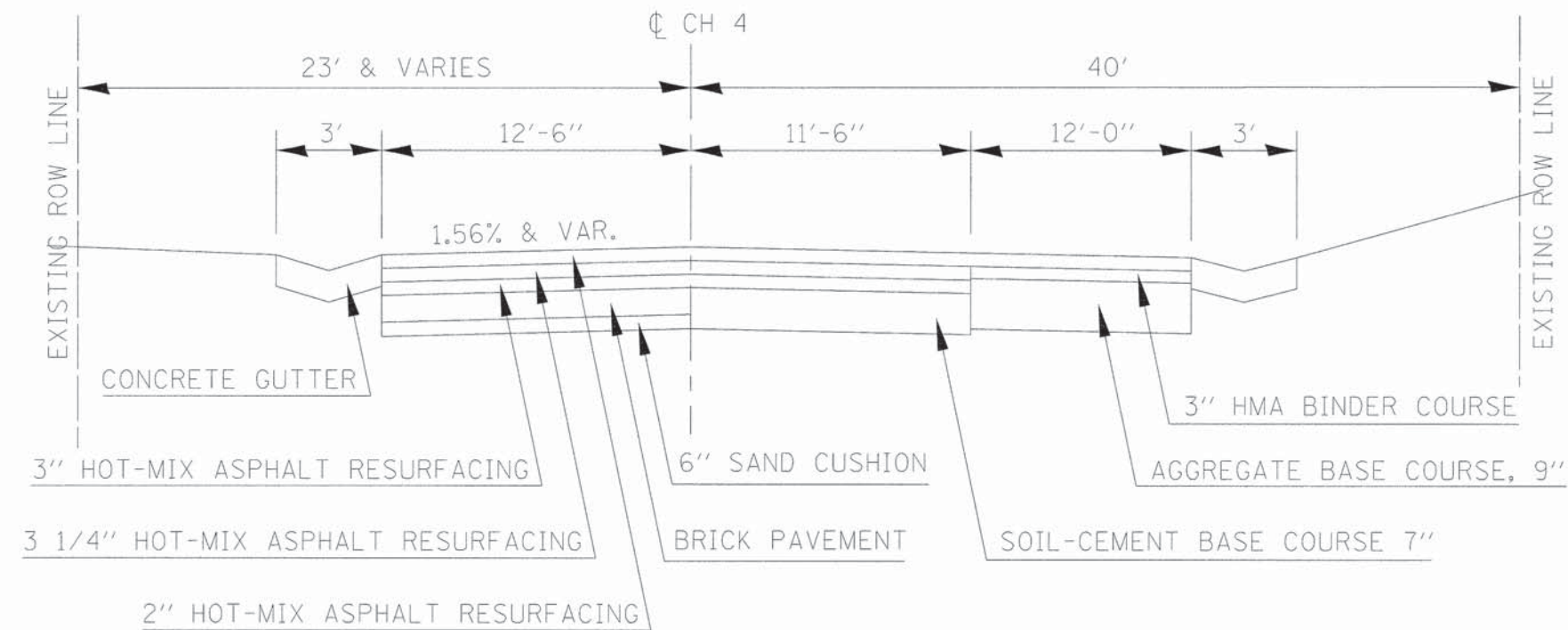

STATION 222+87.50 TO STATION 228+85.74

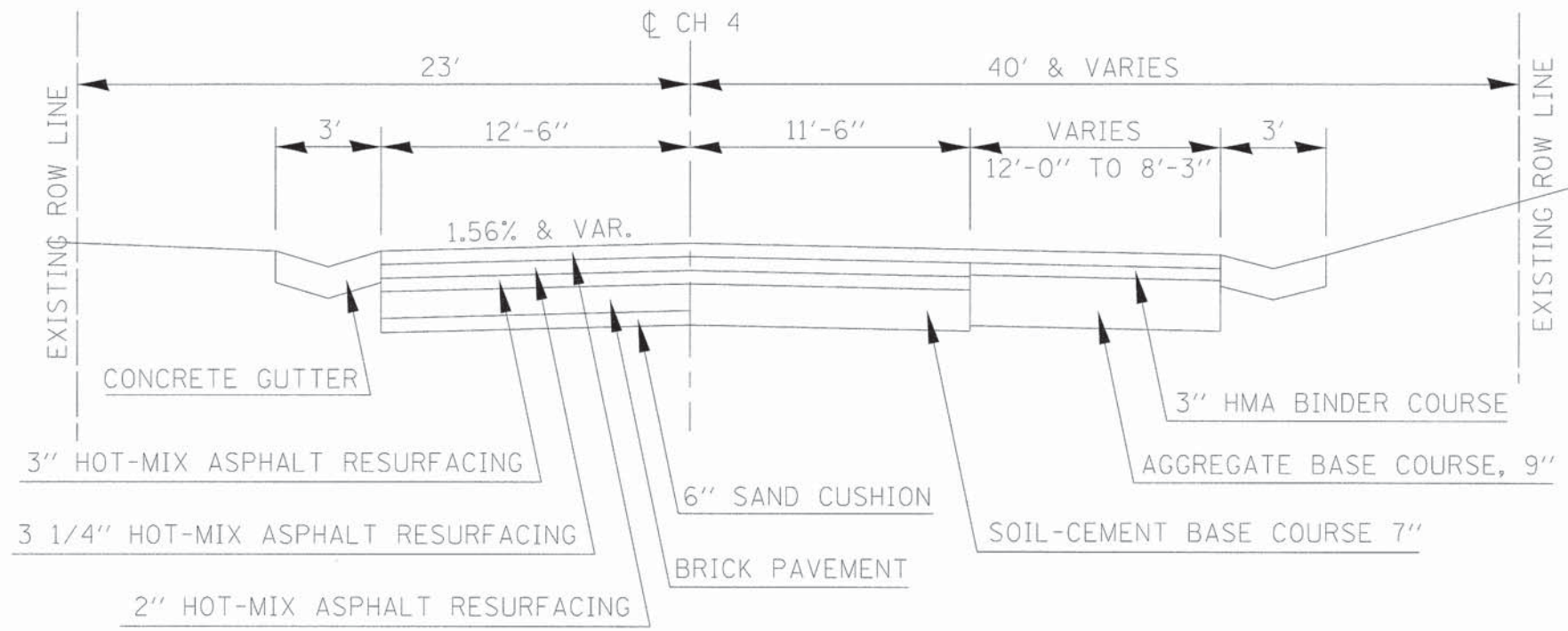

STATION 228+85.74 TO STATION 231+49.19

TYPICAL SECTION



**EDGAR COUNTY
HIGHWAY DEPARTMENT**

M:\Projects\Lower T - US 158 to Heaf and Pa-Kennel\Plan\p1.dgn

PROPOSED TYPICAL CROSS SECTIONS

ROUTE	SECTION	COUNTY	TOTAL SHEETS	SHEET NO.
FAU 7573 (CH 4)	13-00117-00-RS	EDGAR	17	9
EDGAR COUNTY, ILLINOIS			FED. AID PROJECT	
CONTRACT NO. 91504				

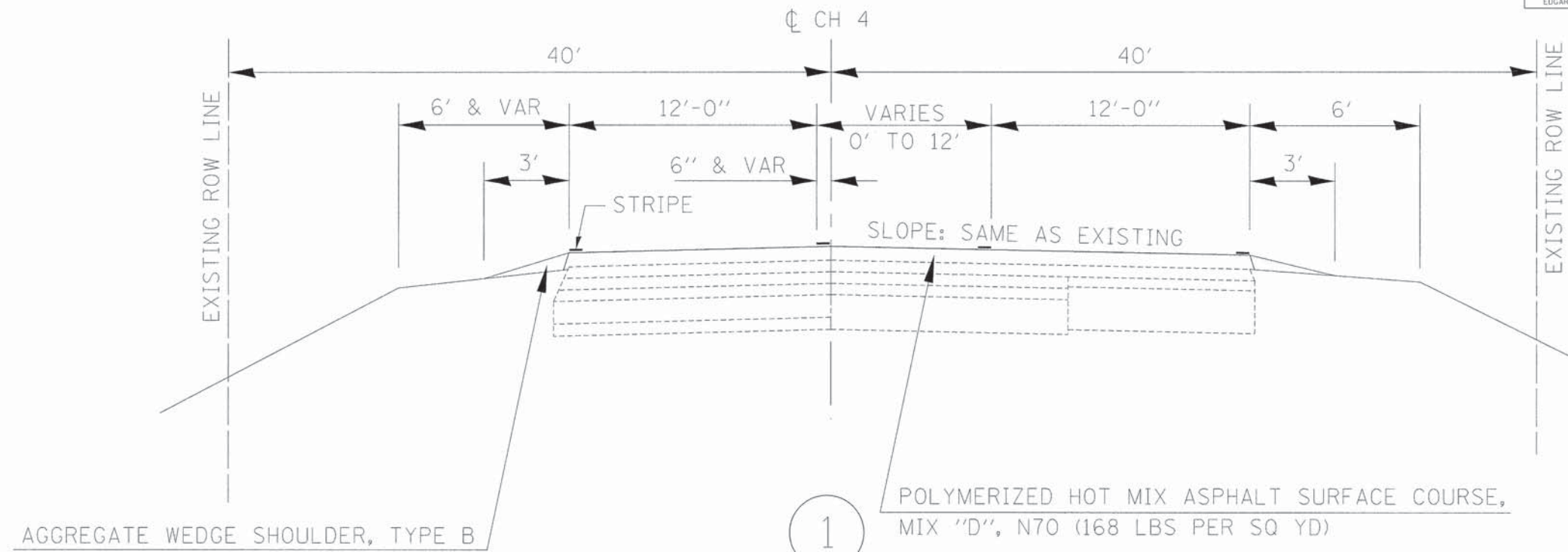

STATION 213+42.13 TO STATION 218+30.84 ②

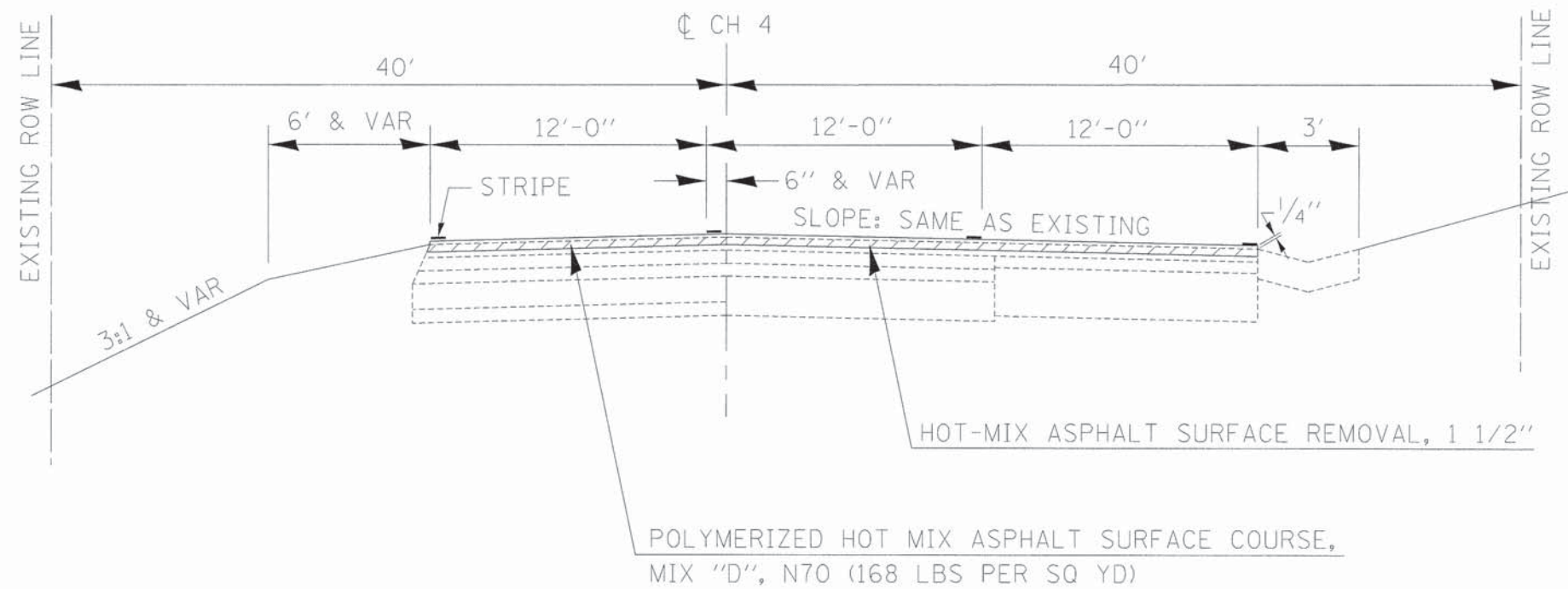

① STATION 218+30.84 TO STATION 222+87.50 ③

TYPICAL SECTION



EDGAR COUNTY
HIGHWAY DEPARTMENT

PROPOSED TYPICAL CROSS SECTIONS

ROUTE	SECTION	COUNTY	TOTAL SHEETS	SHEET NO.
FAU 7573 (CH 4)	13-00117-00-R5	EDGAR	17	10
EDGAR COUNTY, ILLINOIS			CONTRACT NO. 91504	
			FED. AID PROJECT	

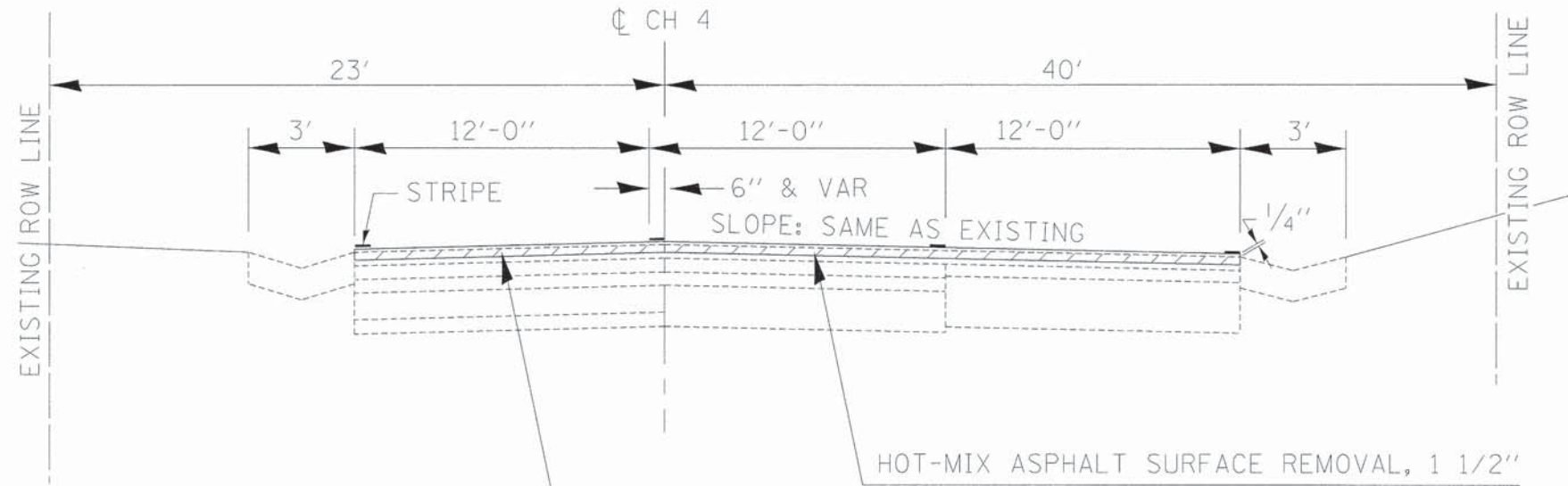

POLYMERIZED HOT MIX ASPHALT SURFACE COURSE,
MIX "D", N70 (168 LBS PER SQ YD)

3

2 STATION 222+87.50 TO STATION 228+82.00 4

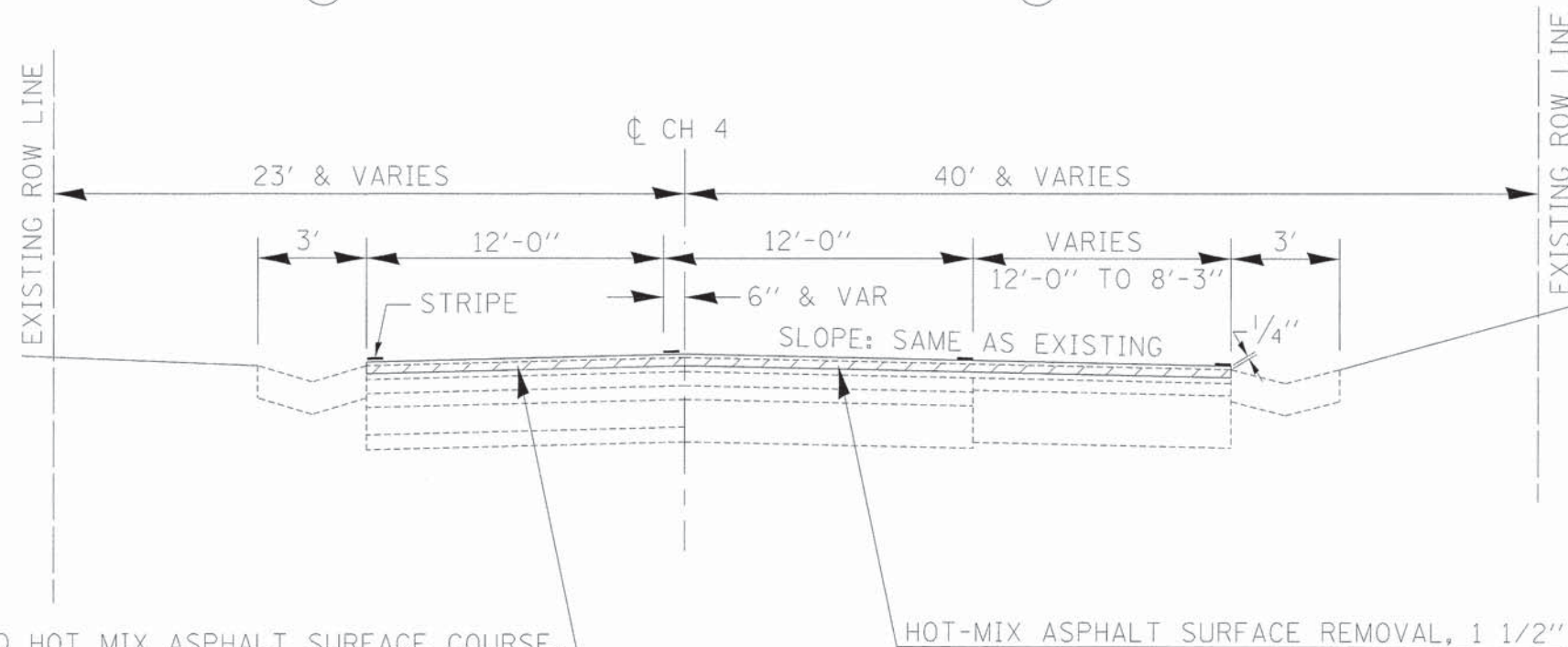

POLYMERIZED HOT MIX ASPHALT SURFACE COURSE,
MIX "D", N70 (168 LBS PER SQ YD)

4

3 STATION 228+82.00 TO STATION 231+49.19

M:\Projects\Leav T - US 158 to Hoof and Pa. Kennels\Plan.dgn

ROUTE	SECTION	COUNTY	TOTAL SHEETS	SHEET NO.
FAU 7573 (CH 4)	13-00117-00-RS	EDGAR	17	11
EDGAR COUNTY, ILLINOIS			CONTRACT NO. 91504	
			FED. AID PROJECT	

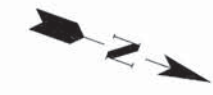

○ DENOTES PROPOSED TYPICAL CROSS SECTION WITH COORESPONDING NUMBER

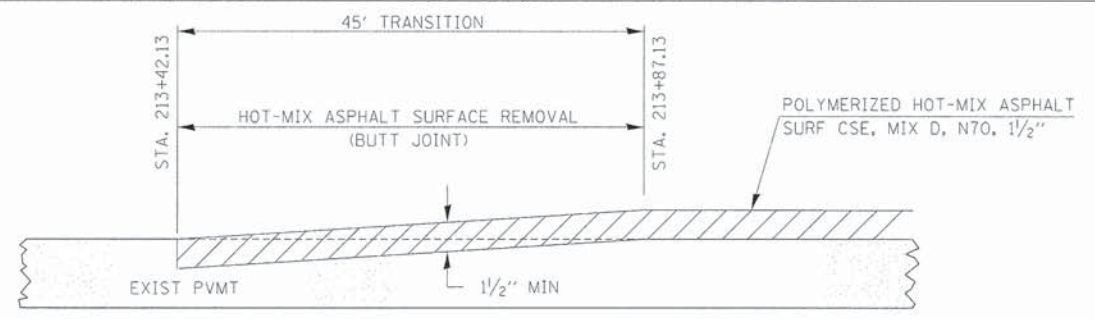

BUTT JOINT DETAIL

SECTION 13-00117-00-RS
PROJECT RS-0045 (051)
BEGINS STATION 213+42.13

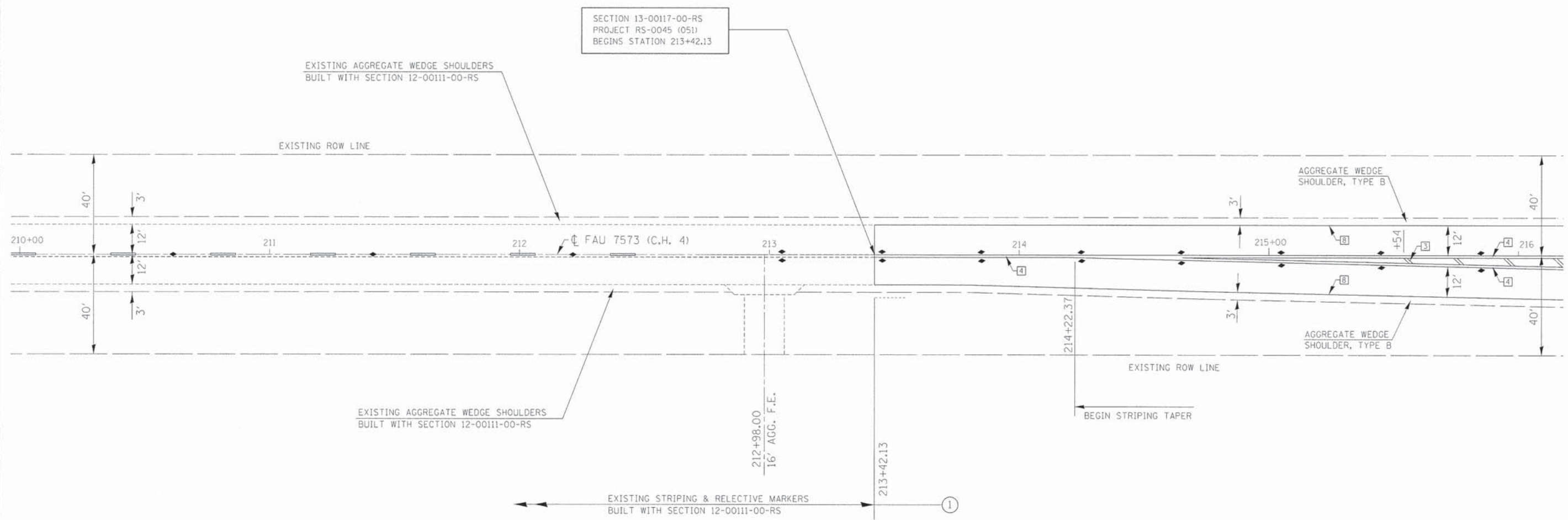

UTILITIES LOCATED WITHIN SECTION

UTILITY COMPANY	TYPE	LOCATION	RELOCATION REQUIRED
City of Paris Water	Buried Main	Throughout Project	None
Ameren Power	Aerial Lines	Throughout Project	None
Ameren Gas	Buried Main	Throughout Project	None
Frontier Communications	Aerial Lines	Throughout Project	None

TYPICAL PAVEMENT MARKING LEGEND

- 1 4" (100) SKIP-DASH (YELLOW)
- 2 4" (100) SOLID (YELLOW)
- 3 12" (300) DIAGONAL (YELLOW)
- 4 4" (100) DOUBLE YELLOW (NARROW)
- 8 4" (100) SOLID (WHITE)

TYPICAL PAVEMENT MARKERS LEGEND

- ◆ TWO-WAY AMBER MARKER
- ▶ ONE-WAY AMBER MARKER
- ▷ ONE-WAY CRYSTAL MARKER

PLAN

10/16/2013
SCALE: 1" = 20'

**EDGAR COUNTY
HIGHWAY DEPARTMENT**

R:\Projects\Lower T - US 158 to Hoof and Paw Kernels\Plan.dwg

ROUTE	SECTION	COUNTY	TOTAL SHEETS	SHEET NO.
FAU 7573 (CH 4)	13-00117-00-R5	EDGAR	17	12
EDGAR COUNTY, ILLINOIS			CONTRACT NO. 91504	
			FED. AID PROJECT	

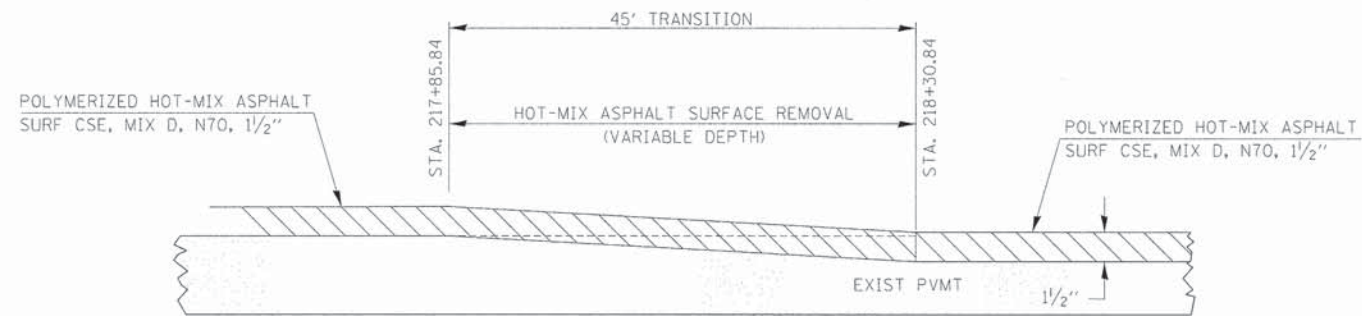

VARIABLE DEPTH MILLING DETAIL

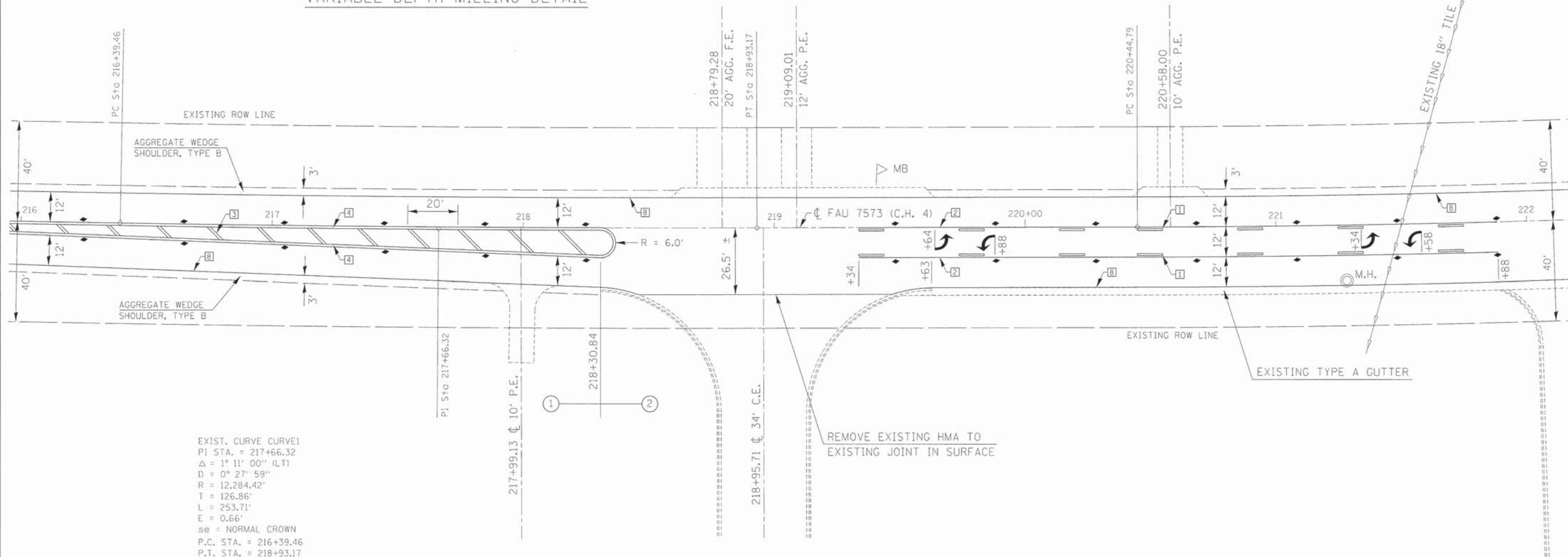

EXIST. CURVE CURVE1
 PI STA. = 217+66.32
 $\Delta = 1^\circ 11' 00''$ (LT)
 $D = 0^\circ 27' 59''$
 $R = 12,284.42'$
 $T = 126.86'$
 $L = 253.71'$
 $E = 0.66'$
 se = NORMAL CROWN
 P.C. STA. = 216+39.46
 P.T. STA. = 218+93.17

TYPICAL PAVEMENT MARKING LEGEND

- 1 4" (100) SKIP-DASH (YELLOW)
- 2 4" (100) SOLID (YELLOW)
- 3 12" (300) DIAGONAL (YELLOW)
- 4 4" (100) DOUBLE YELLOW (NARROW)
- 8 4" (100) SOLID (WHITE)

TYPICAL PAVEMENT MARKERS LEGEND

- ◆ TWO-WAY AMBER MARKER
- ▶ ONE-WAY AMBER MARKER
- ▷ ONE-WAY CRYSTAL MARKER

PLAN

10/16/2013
 SCALE: 1" = 20'



EDGAR COUNTY
 HIGHWAY DEPARTMENT

ROUTE	SECTION	COUNTY	TOTAL SHEETS	SHEET NO.
FAU 7573 (CH 4)	13-00117-00-R5	EDGAR	17	13
EDGAR COUNTY, ILLINOIS			CONTRACT NO. 91504	
			FED. AID PROJECT	

EXIST. CURVE CURVE2
 PI STA. = 224+27.89
 $\Delta = 7^\circ 39' 00''$ (LT)
 $D = 1^\circ 00' 00''$
 $R = 5,730.04'$
 $T = 383.10'$
 $L = 765.06'$
 $E = 12.79'$
 se = NORMAL CROWN
 P.C. STA. = 220+44.79
 P.T. STA. = 228+09.85

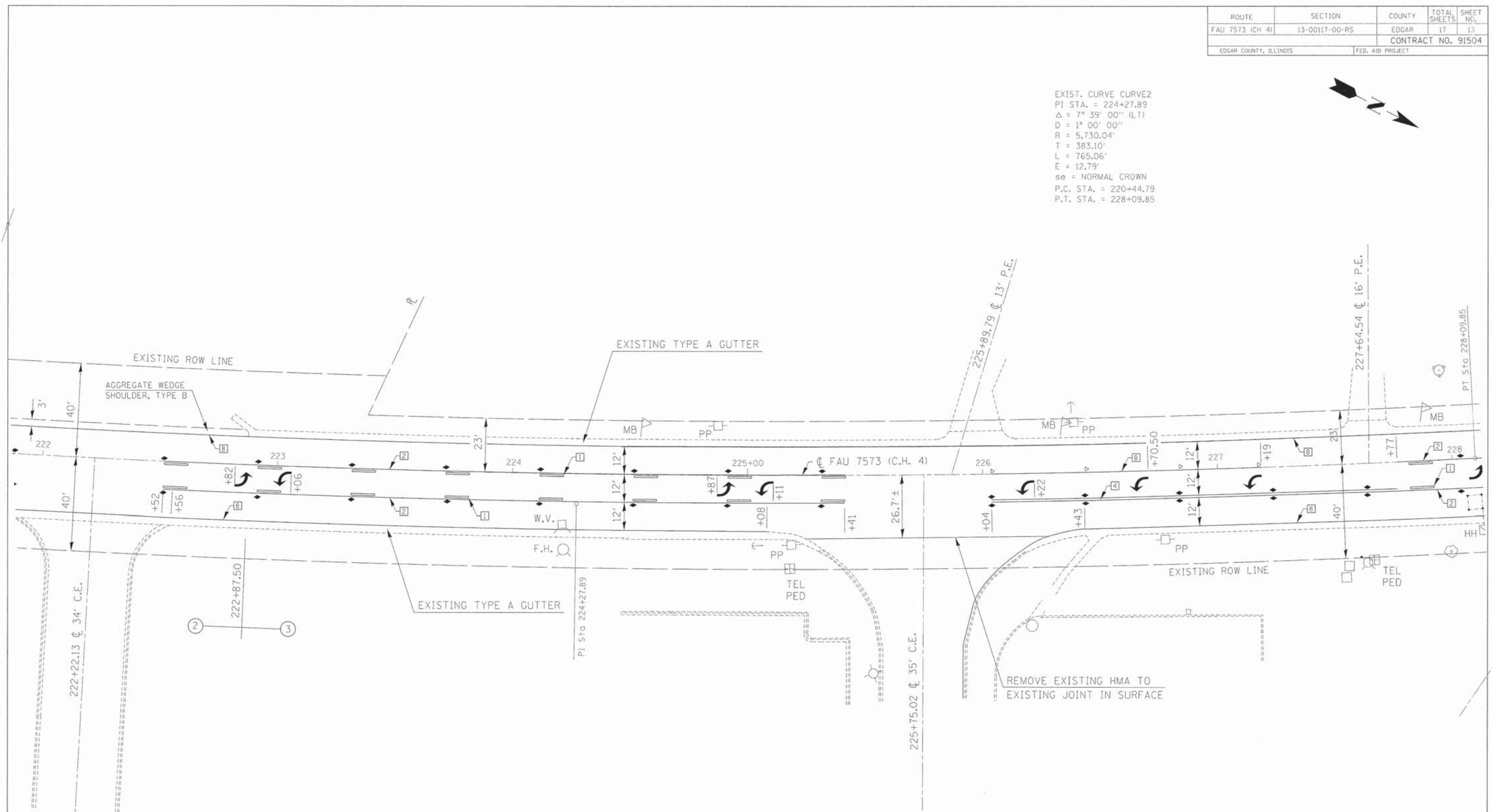

TYPICAL PAVEMENT MARKING LEGEND

- 1 4" (100) SKIP-DASH (YELLOW)
- 2 4" (100) SOLID (YELLOW)
- 3 12" (300) DIAGONAL (YELLOW)
- 4 4" (100) DOUBLE YELLOW (NARROW)
- 8 4" (100) SOLID (WHITE)

TYPICAL PAVEMENT MARKERS LEGEND

- ◆ TWO-WAY AMBER MARKER
- ▶ ONE-WAY AMBER MARKER
- ▷ ONE-WAY CRYSTAL MARKER

M:\Projects\Leap T - US 158 to Hoef and Paw Kennels\Plan.dgn

PLAN

10/16/2013
 SCALE: 1" = 20'

**EDGAR COUNTY
 HIGHWAY DEPARTMENT**

DETAIL OF DETECTOR LOOP WIRING
WIRED IN SERIES WITH MULTI-PAIR CABLE

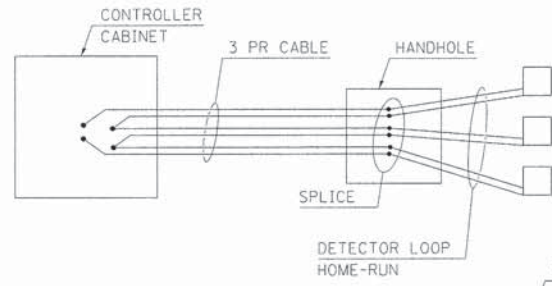

DETECTOR LOOP DATA				
U. S. 150 & LOWER TERRE HAUTE RD.				
Loop	Length	Width	No. of Turns	Delay (sec.)
B1	12'	6'	3	
B2	6'	6'	3	
B3-B4	6'	12'	3	10
B5	6'	6'	4	10

DETECTOR LOOP, TYPE 1 = 233 FOOT

ROUTE	SECTION	COUNTY	TOTAL SHEETS	SHEET NO.
FAU 7573 (C.H. 4)	13-00117-00-R5	EDGAR	17	14
EDGAR COUNTY, ILLINOIS			CONTRACT NO. 91504	
			FED. AID PROJECT	

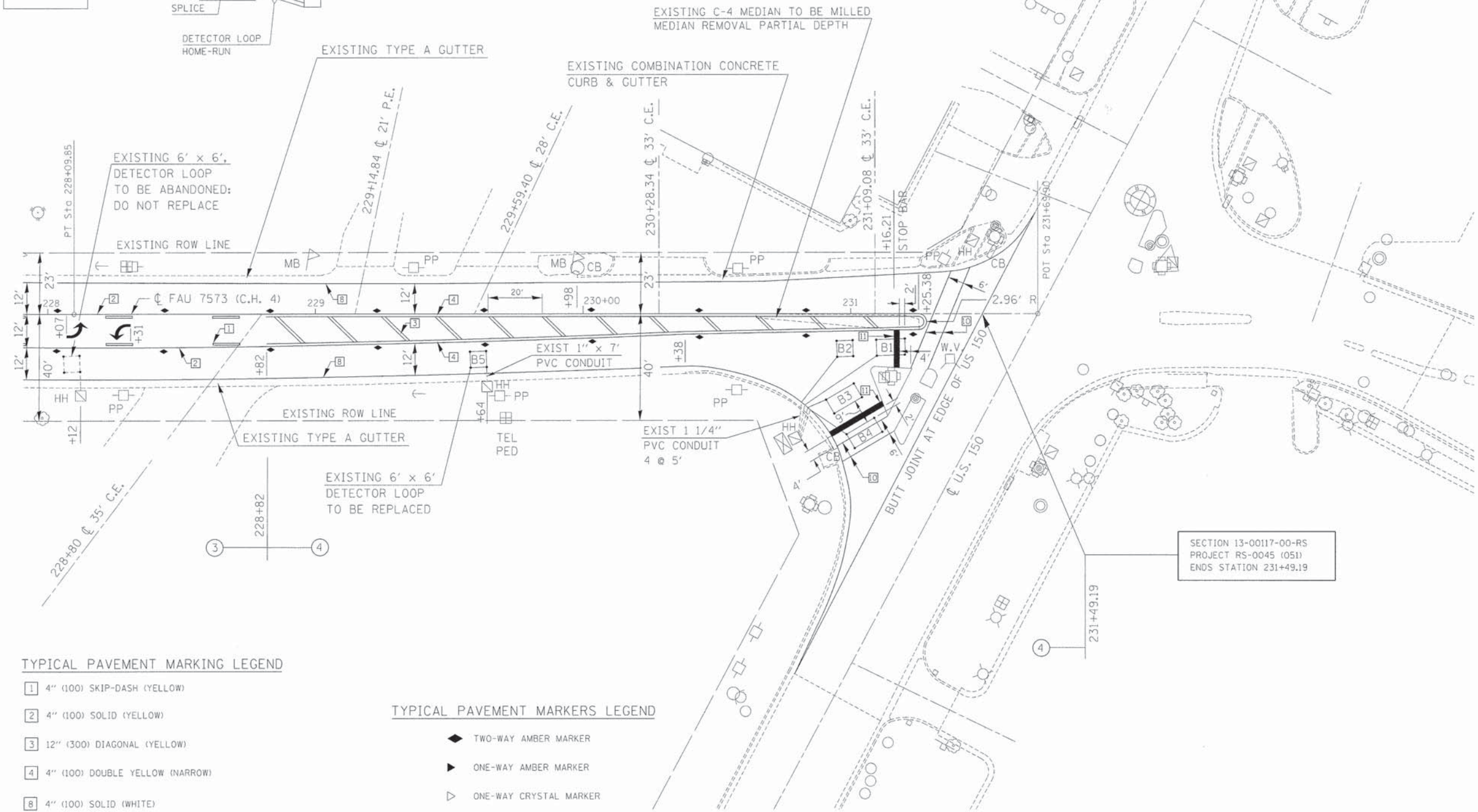

TYPICAL PAVEMENT MARKING LEGEND

- 1 4" (100) SKIP-DASH (YELLOW)
- 2 4" (100) SOLID (YELLOW)
- 3 12" (300) DIAGONAL (YELLOW)
- 4 4" (100) DOUBLE YELLOW (NARROW)
- 8 4" (100) SOLID (WHITE)
- 10 6" (150) SOLID (WHITE)
- 11 12" (300) SOLID (WHITE)

TYPICAL PAVEMENT MARKERS LEGEND

- ◆ TWO-WAY AMBER MARKER
- ▶ ONE-WAY AMBER MARKER
- ▷ ONE-WAY CRYSTAL MARKER

SECTION 13-00117-00-RS
PROJECT RS-0045 (051)
ENDS STATION 231+49.19

M:\Projects\Lower T - US 150 to Hoop and Pa. Kennedy\Plan-051.dgn

ROUTE	SECTION	COUNTY	TOTAL SHEETS	SHEET NO.
FAU 7573 (CH 4)	13-00117-00-RS	EDGAR	17	15
EDGAR COUNTY, ILLINOIS			CONTRACT NO. 91504	
			FED. AID PROJECT	

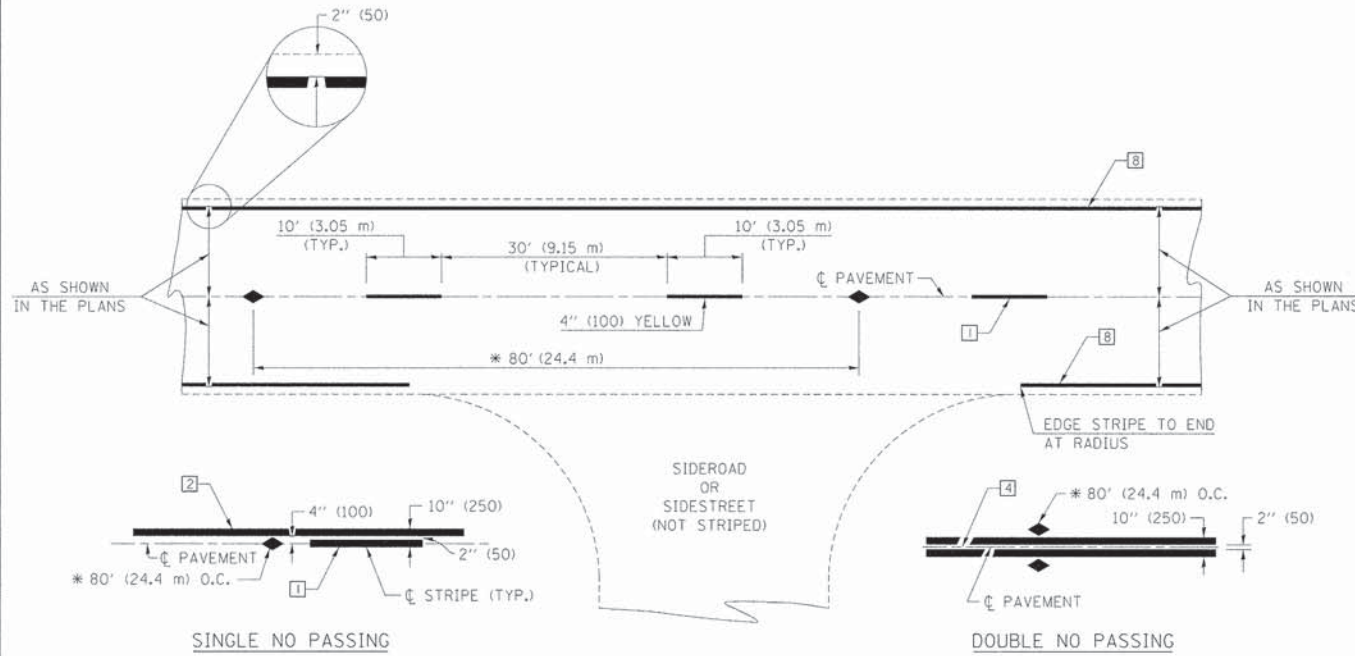

* REDUCE TO 40' (12.2 m) O.C. ON CURVES WITH POSTED OR ADVISORY SPEEDS OF 45 mph (70 km/h) OR LESS.

TWO LANE/TWO WAY

TYPICAL PAVEMENT MARKING LEGEND

- 1 4" (100) SKIP-DASH (YELLOW)
 - 2 4" (100) SOLID (YELLOW)
 - 3 12" (300) DIAGONAL (YELLOW)
 - 4 4" (100) DOUBLE YELLOW (NARROW)
 - 5 RESERVED
 - 6 RESERVED
 - 7 4" (100) SKIP-DASH (WHITE)
 - 8 4" (100) SOLID (WHITE)
 - 9 12" (300) DIAGONAL (WHITE)
 - 10 6" (150) SOLID (WHITE)
 - 11 24" (600) STOP BAR (WHITE)
 - 12 8" (200) SOLID (WHITE)
 - 13 4" (100) LANE LINE EXTENSIONS (WHITE)
 - 14 4" (100) PARKING WHITE
-

TYPICAL PAVEMENT MARKERS LEGEND

- ◆ TWO-WAY AMBER MARKER
- ▶ ONE-WAY AMBER MARKER
- ▷ ONE-WAY CRYSTAL MARKER

RURAL LEFT TURN

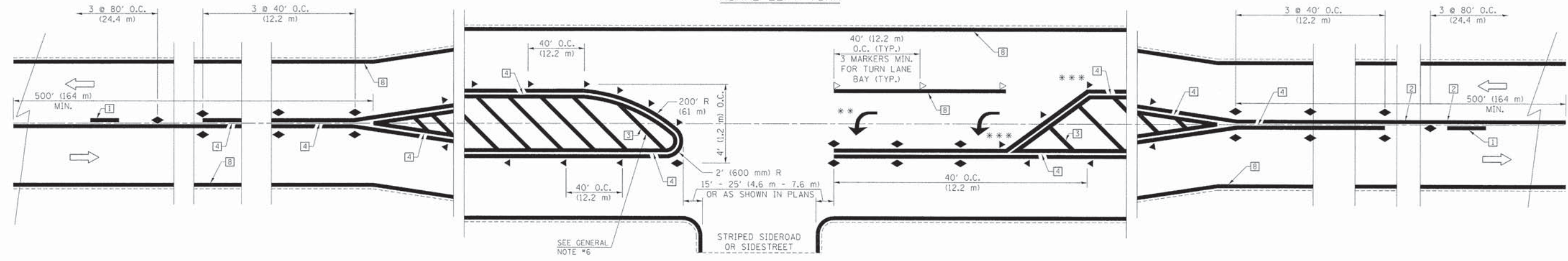

*** REDUCE SPACING IF NECESSARY TO ASSURE MARKERS AT CORNER POINTS.
 ** TURN ARROWS SHALL BE PLACED AS SHOWN ON SHEET #2.

Note: All dimensions are in INCHES (millimeters) unless otherwise shown.

M:\Projects\Lower T - US 158 to Hoof and P...	DESIGNED	10/16/2013	10/16/2013
	DRAWN		
	CHECKED		
	DATE		

PAVEMENT MARKING AND MARKERS (RURAL AND URBAN APPLICATIONS)



ROUTE	SECTION	COUNTY	TOTAL SHEETS	SHEET NO.
FAU 7573 (CH 4)	13-00117-00-R5	EDGAR	17	16
EDGAR COUNTY, ILLINOIS		FED. AID PROJECT		
CONTRACT NO. 91504				

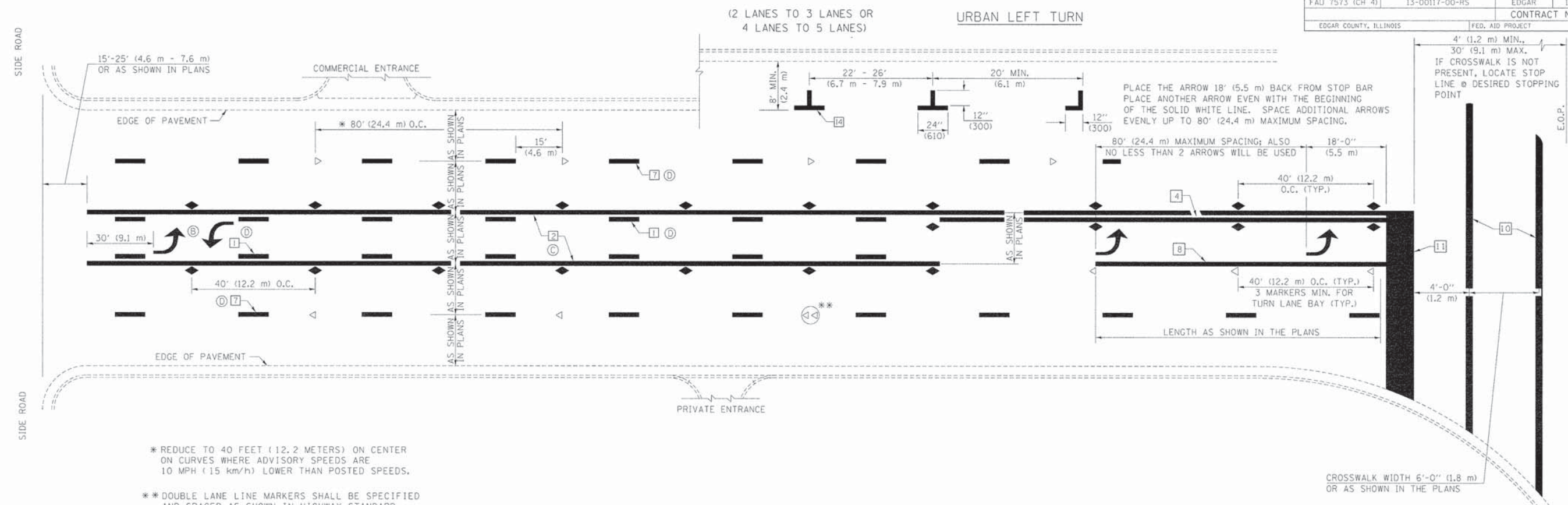

* REDUCE TO 40 FEET (12.2 METERS) ON CENTER ON CURVES WHERE ADVISORY SPEEDS ARE 10 MPH (15 km/h) LOWER THAN POSTED SPEEDS.

** DOUBLE LANE LINE MARKERS SHALL BE SPECIFIED AND SPACED AS SHOWN IN HIGHWAY STANDARD 781001 FOR MULTI-LANE DIVIDED AND UNDIVIDED HIGHWAYS.

- GENERAL NOTES:**
- (B) TURN ARROW PAIRS SHALL BE PLACED AT 250' (75 m) INTERVALS AND SHALL BE EVENLY SPACED BETWEEN BOTH ENDS OF THE BIDIRECTIONAL LEFT TURN LANE.
 - (C) THE SOLID YELLOW PAVEMENT MARKINGS [2] SHOULD GENERALLY START OR END NEAR THE RADIUS POINT OF EACH STREET RETURN EXCEPT WHERE ONE OR BOTH ENDS WOULD INCLUDE STOP BARS.
 - (D) THE SKIP-DASH PAVEMENT MARKINGS [1] OR [7] SHOULD BE CENTERED BETWEEN BOTH ENDS OF EACH CITY BLOCK AND SHALL BE PLACED SO THEY LINE UP ACROSS FROM EACH OTHER. SEE EXAMPLE ON SHEET 2 OF 3.
 - (E) USE LARGE ARROW SIZE FOR BOTH RURAL AND URBAN LOCATIONS. (SEE LAST PAGE OF SECTION 780x FOR SYMBOLS TABLE)

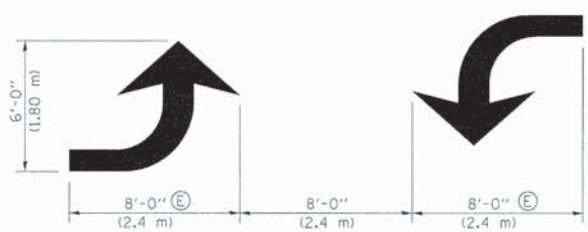
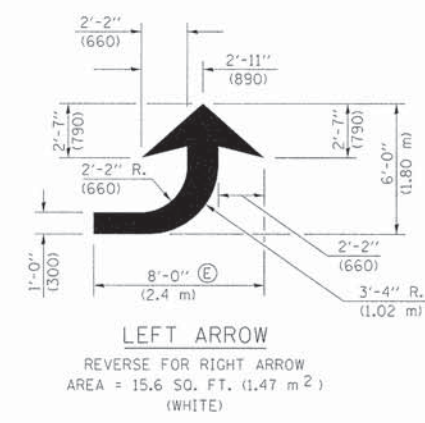

TYPICAL DOUBLE TURN ARROWS (WHITE)

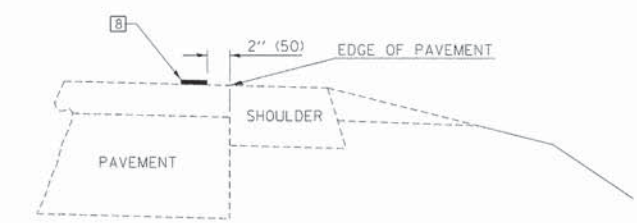

RELATIONSHIP OF EDGE LINE TO EDGE OF PAVEMENT (SAFETY SHOULDER OR PAVED SURFACE) SEE ARTICLE 780.04

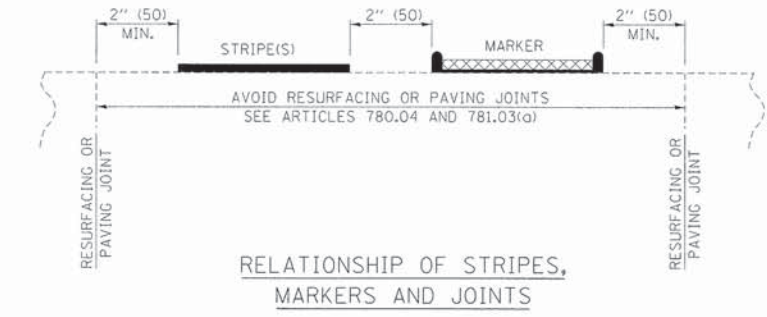

RELATIONSHIP OF STRIPES, MARKERS AND JOINTS

Note: All dimensions are in INCHES (millimeters) unless otherwise shown.

M:\Projects\Lower I - US 150 to Hoop and P...	DESIGNED	10/16/2013	10/16/2013
	DRAWN		
	CHECKED		
	DATE		

PAVEMENT MARKING AND MARKERS (RURAL AND URBAN APPLICATIONS)



ROUTE	SECTION	COUNTY	TOTAL SHEETS	SHEET NO.
FAU 7573 (CH 4)	13-00117-00-RS	EDGAR	17	17
EDGAR COUNTY, ILLINOIS			CONTRACT NO. 91504	
			FED. AID PROJECT	

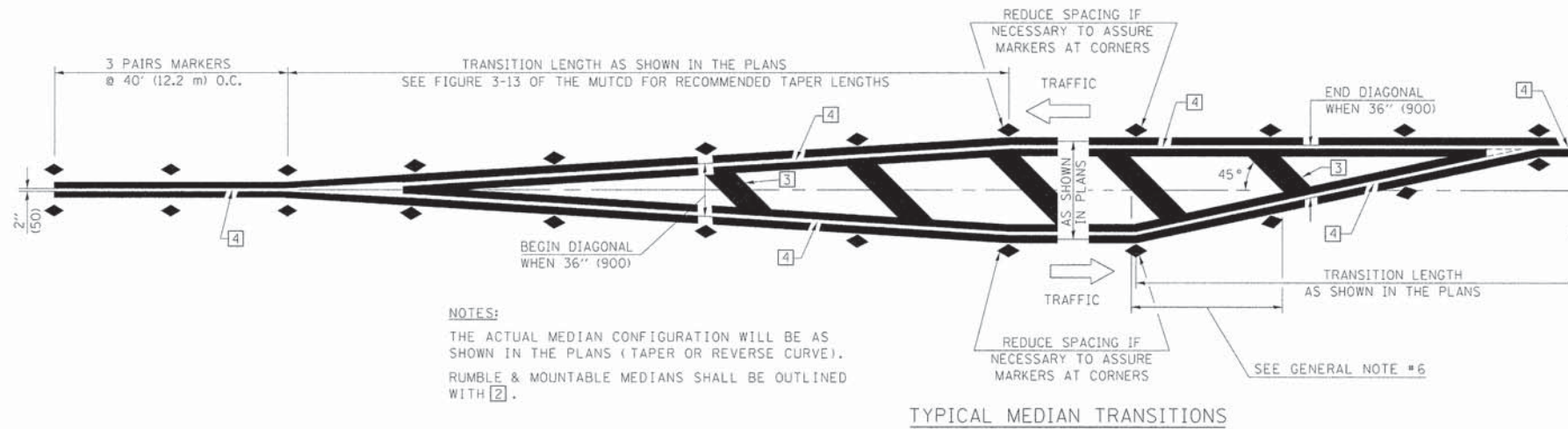

GENERAL NOTES

1. WHEN MEDIANS ARE PRESENT, PAVEMENT MARKINGS ARE TO BE PLACED ADJACENT TO MEDIANS.
2. SOME OF THE INFORMATION INCLUDED WITH THIS DETAIL MAY NOT BE APPLICABLE TO THIS IMPROVEMENT.
3. PAVEMENT MARKINGS ARE TO BE EXTENDED THROUGH OMISSIONS WHEN APPLICABLE.
4. A STRIPING KEY IS AVAILABLE ELSEWHERE AND SHALL BE SHOWN WHERE THE QUANTITIES ARE LISTED.
5. FINAL PAVEMENT MARKINGS SHALL BE IN PLACE PRIOR TO PLACING ANY RAISED REFLECTIVE PAVEMENT MARKERS.
6. THE FOLLOWING CRITERIA SHALL BE USED FOR SELECTING THE DIAGONAL PAVEMENT MARKING SPACING.
< 30 MPH USE 15' (< 50 km/h USE 4.5 m)
30-45 MPH USE 20' (50-75 km/h USE 6.0 m)
> 45 MPH USE 30' (> 75 km/h USE 9.0 m)

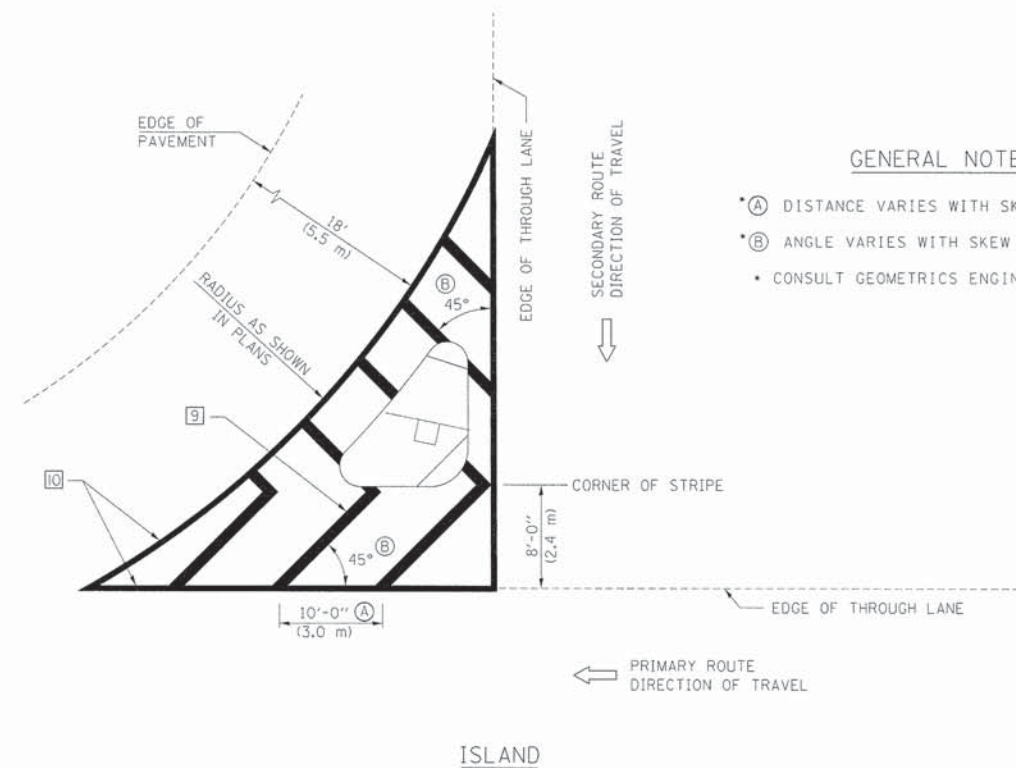
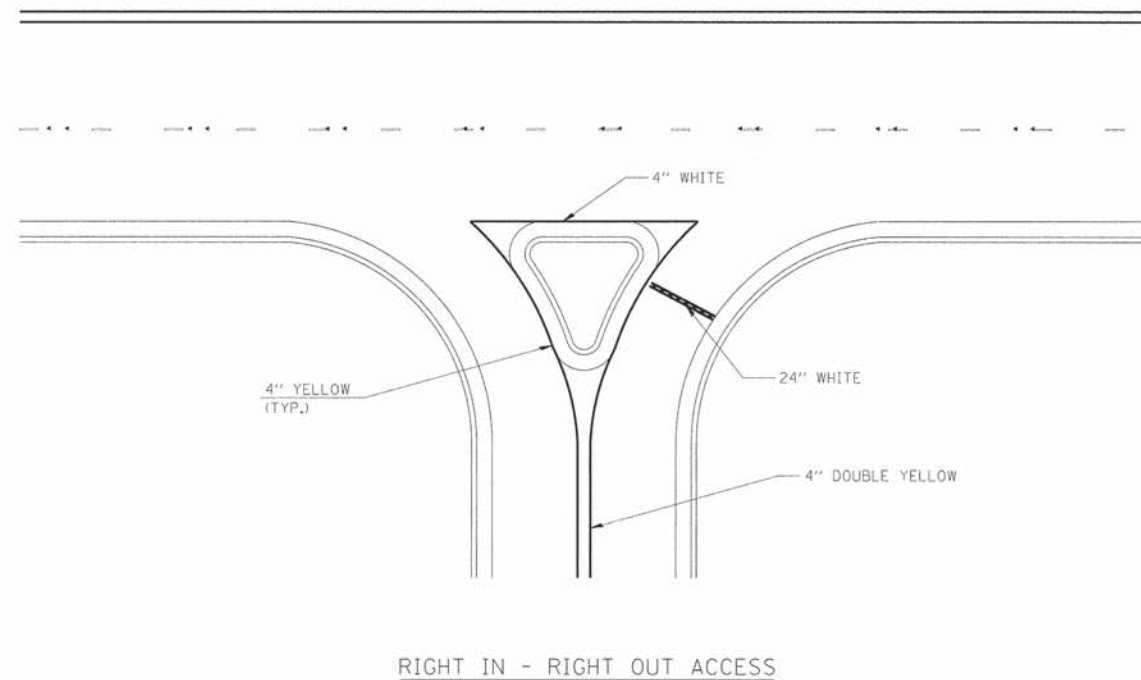

GENERAL NOTES

- (A) DISTANCE VARIES WITH SKEW OF INTERSECTION.
- (B) ANGLE VARIES WITH SKEW OF INTERSECTION.
- CONSULT GEOMETRICS ENGINEER

Note: All dimensions are in INCHES (millimeters) unless otherwise shown.

M:\Projects\Lower T - US 150 to Hoop and P...	DESIGNED [signature]	REVISED -
10/16/2013	DRAWN -	REVISED -
	CHECKED -	REVISED -
	DATE -	REVISED -

PAVEMENT MARKING AND MARKERS
(RURAL AND URBAN APPLICATIONS)



EDGAR COUNTY
HIGHWAY DEPARTMENT