

NOV 26, 2013 9:15 AM SCHMED1296  
 p:\s\spi-svr306\hanson\Projects\Documents\12A0059D\CAD\Airport\Sheet\C-181-SWP

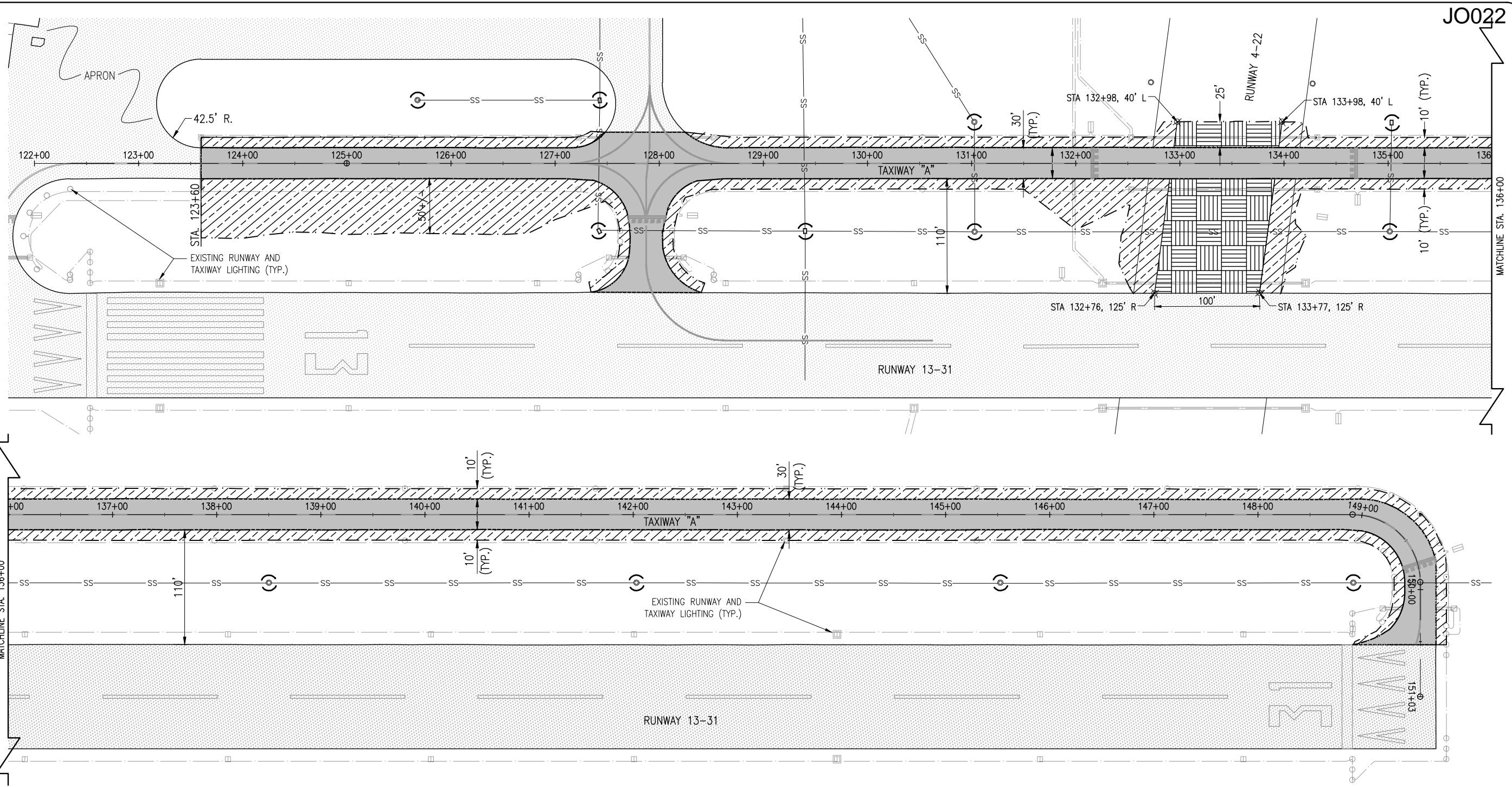

JO022

MATCHLINE STA. 136+00

MATCHLINE STA. 136+00

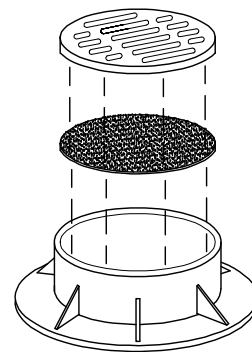

**INLET PROTECTION DETAIL**  
 "NOT TO SCALE"

**NOTE**

FILTER WRAP TO BE PLACED IN ALL PROPOSED AND EXISTING INLETS LOCATED IN PAVED AREAS.

FABRIC SHALL BE IN CONFORMANCE WITH MATERIALS SPECIFIED FOR EROSION CONTROL FENCING.

FABRIC SHALL OVERLAY FRAME BY 2" MIN.

THE CONTRACTOR SHALL CLEAR DEBRIS AND SILT AS REQUIRED FROM FABRIC TO MAINTAIN DRAINAGE THROUGH THE STRUCTURE.

FABRIC SHALL REMAIN IN PLACE UNTIL TURFED AREAS HAVE DEVELOPED A MIN. OF 80% COVERAGE.

COST OF FILTER WRAP SHALL BE PAID FOR UNDER ITEM NO. AR156520.

**LEGEND**

- EXISTING PAVEMENT
- PROPOSED PAVEMENT IMPROVEMENTS
- PROPOSED SEEDING AND MULCHING
- PROPOSED SODDING
- SHOULDER ADJUSTMENT LIMITS
- EXISTING STORM SEWER
- EXISTING INLET
- INLET PROTECTION

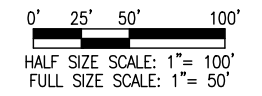
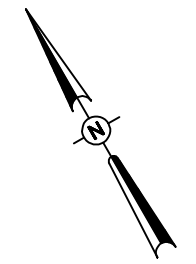

REVISION	DATE

**JOLIET REGIONAL AIRPORT  
 JOLIET PARK DISTRICT  
 JOLIET, ILLINOIS**

IL PROJ.: JOT-4233 S.B.G. PROJ.: 3-17-SBGP-XX

Hanson Project No.	12A0059
Filename	C-181-EC.dwg
Scale	1" = 50'
Date	11/1/13
LAYOUT	KBS 04/30/13
DRAWN	RAD 04/30/13
REVIEWED	CAH 11/1/13

**HANSON**  
 Hanson Professional Services Inc. 2013  
 Hanson Professional Services Inc.  
 1525 South Sixth Street  
 Springfield, Illinois 62703-2886  
 Ph: (217) 788-2450 Fax: (217) 788-2503  
 www.hanson-inc.com  
 Offices Nationwide

**REHABILITATE  
 TAXIWAY "A"**

**SWPPP & LANDSCAPING PLAN**