

CONSTRUCTION PLANS FOR JOLIET REGIONAL AIRPORT JOLIET, WILL COUNTY, ILLINOIS REHABILITATE TAXIWAY "A"

SCOPE OF WORK

THIS PROJECT CONSISTS OF REHABILITATING TAXIWAY "A" WHICH INCLUDES PAVEMENT MILLING, CRACK REPAIR, BITUMINOUS LEVELING (VARIABLE DEPTH), GRID INTERLAY, BITUMINOUS OVERLAY (1-1/2" DEPTH), MARKING, SHOULDER ADJUSTMENT, SEEDING AND MULCHING.

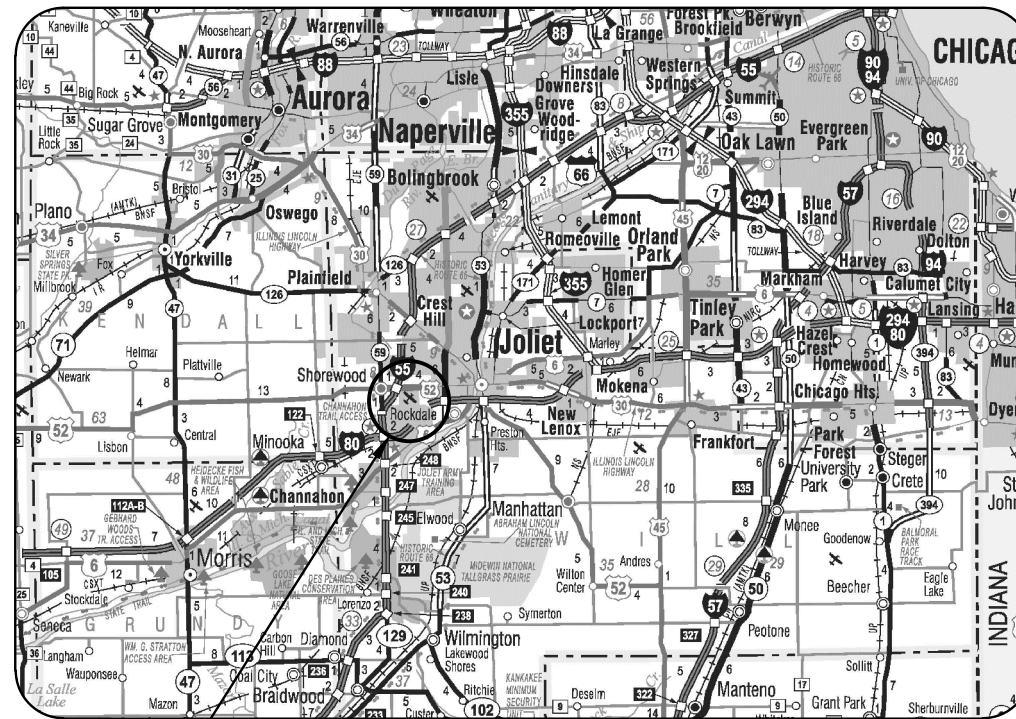

LOCATION

PROJECT LOCATION

ILL. PROJ.: JOT-4233
S.B.G. PROJ.: 03-17-SBGP-XX
LATITUDE: 41° 31' 03"
LONGITUDE: 88° 10' 30"
ELEVATION: 581.0' M.S.L.
DATE: NOV 15, 2013

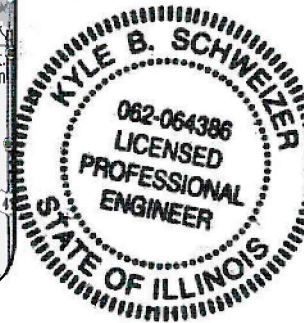

HANSON
Hanson Professional Services Inc.

Submitted by: *Kyle B. Schweizer* ENG'R
Date Submitted: *11/15/2013*
Lic. Exp. Date: *11/30/2015*

JOLIET PARK DISTRICT

Approved: *Alan A. Man* CHAIRMAN
Date: *11.25.13*
Approved: *[Signature]* SECRETARY
Date: *11.25.13*

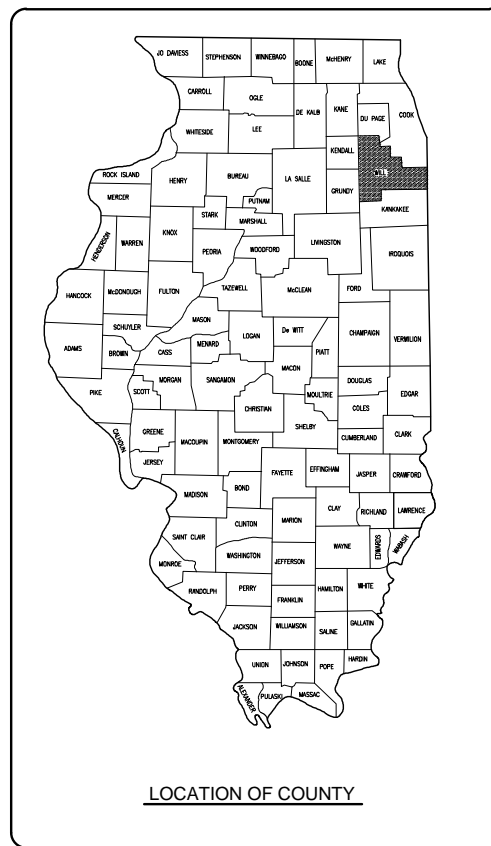

REVISION	DATE

**JOLIET REGIONAL AIRPORT
JOLIET PARK DISTRICT
JOLIET, ILLINOIS**

Hanson Project No.	12A0059
Filename	C-001-CVR.dwg
Scale	NOT TO SCALE
Date	11/1/13
LAYOUT	KBS 04/30/13
DRAWN	KBS 04/30/13
REVIEWED	CAH 11/1/13

HANSON
Hanson Professional Services Inc. 2013
1525 South Sixth Street
Springfield, Illinois 62703-2886
Ph: (217) 788-2450 Fax: (217) 788-2503
www.hanson-inc.com
Offices Nationwide

REHABILITATE
TAXIWAY "A"

COVER SHEET

1
1 of 17 sheets

DEC 03, 2013 9:02 AM SCHMED1296
p:\s\sp-3\306\hanson\dom\hanson\Projects\Documents\12\lots\12A0059\12A0059D\CAD\Airport\Sheet\G-001-CVR

SUMMARY OF QUANTITIES				
ITEM NO.	DESCRIPTION	UNIT	QUANTITY	AS-BUILT QUANTITY
AR150510	ENGINEER'S FIELD OFFICE	LS	1	
AR150520	MOBILIZATION	LS	1	
AR150540	HAUL ROUTE	LS	1	
AR152480	SHOULDER ADJUSTMENT	SY	10,200	
AR156520	INLET PROTECTION	EA	12	
AR201670	CRACK CONTROL FABRIC	SY	9,555	
AR401613	BIT. SURF. CSE.-METHOD I, SUPERPAVE	TON	865	
AR401650	BITUMINOUS PAVEMENT MILLING	SY	9,727	
AR401910	REMOVE & REPLACE BIT. PAVEMENT	SY	650	
AR403613	BIT. BASE CSE.-METHOD I, SUPERPAVE	TON	1,115	
AR603510	BITUMINOUS TACK COAT	GAL	3,900	
AR620520	PAVEMENT MARKING-WATERBORNE	SF	3,984	
AR620525	PAVEMENT MARKING-BLACK BORDER	SF	641	
AR901510	SEEDING	ACRE	2.0	
AR904510	SODDING	SY	1,550	
AR908510	MULCHING	ACRE	2.0	

INDEX TO SHEETS	
SHEET NO.	DESCRIPTION
1	COVER SHEET
2	SUMMARY OF QUANTITIES AND INDEX TO SHEETS
3	SCOPE OF WORK, GENERAL NOTES, TYPICAL SECTION
4	CONSTRUCTION SAFETY AND PHASING PLAN
5	PAVEMENT PREPARATION PLAN
6	TAXIWAY A PLAN & PROFILE STA. 123+60 TO STA 137+00
7	TAXIWAY A PLAN & PROFILE STA. 137+00 TO 150+53
8	MARKING PLAN
9	SWPPP & LANDSCAPING PLAN
10	TAXIWAY A CROSS SECTIONS STA. 123+60 TO 127+50
11	TAXIWAY A CROSS SECTIONS STA. 127+75 TO 128+50
12	TAXIWAY A CROSS SECTIONS STA. 129+00 TO 132+00
13	TAXIWAY A CROSS SECTIONS STA. 132+50 TO 134+00
14	TAXIWAY A CROSS SECTIONS STA. 134+50 TO 139+00
15	TAXIWAY A CROSS SECTIONS STA. 139+50 TO 144+00
16	TAXIWAY A CROSS SECTIONS STA. 144+50 TO 149+00
17	TAXIWAY A CROSS SECTIONS STA. 149+50 TO 150+53

REVISION	DATE

**JOLIET REGIONAL AIRPORT
 JOLIET PARK DISTRICT
 JOLIET, ILLINOIS**

IL PROJ.: J0T-4233 S.B.G. PROJ.: 3-17-SBGP-XX

Hanson Project No. 12A0059	File Name C-002-FLP.dwg	Scale NOT TO SCALE	Date 11/1/13
LAYOUT	KBS	04/30/13	
DRAWN	KBS	4/30/13	
REVIEWED	CAH	11/1/13	



HANSON
 Professional Services Inc. 2013
 Hanson Professional Services Inc.
 1525 South Sixth Street
 Springfield, Illinois 62703-2886
 Ph: (217) 788-2450 Fax: (217) 788-2503
 www.hanson-inc.com
 Offices Nationwide

REHABILITATE
 TAXIWAY "A"
 SUMMARY OF QUANTITIES
 AND INDEX TO SHEETS

GENERAL NOTES

1. THE SCOPE OF WORK SHEET IS INTENDED ONLY AS A GENERAL DESCRIPTION OF WORK ITEMS AND THEIR APPROXIMATE LOCATIONS AND LIMITS, FOR THE PURPOSE OF UNDERSTANDING THE SCOPE OF THE PROJECT. THIS SHEET SHALL NOT BE USED AS A CONSTRUCTION PLAN. REFER TO THE FOLLOWING PLAN SHEETS FOR DETAILED CONSTRUCTION REQUIREMENTS, LOCATIONS, AND ITEMS OF WORK.
2. WORK FOR THIS PROJECT SHALL CONSIST OF, BUT IS NOT LIMITED TO, PAVEMENT MILLING, PLACEMENT OF BITUMINOUS PAVEMENT, CRACK CONTROL FABRIC, PAVEMENT MARKING, EROSION CONTROL, SEEDING, SODDING, AND OTHER ASSOCIATED ITEMS.
3. THE PROJECT PAY ITEMS ARE INTENDED TO BE INCLUSIVE OF ALL WORK TO BE PERFORMED AS SHOWN IN THESE PLANS. ALL INCIDENTAL WORK REQUIRED TO COMPLETE THE PROJECT TO THE SATISFACTION OF THE ENGINEER IS TO BE INCLUDED IN THE COSTS OF PERFORMING THESE ITEMS. THE CONTRACTOR SHALL FURNISH ALL LABOR, MATERIAL, EQUIPMENT, AND TRANSPORTATION NECESSARY TO CONSTRUCT ALL ELEMENTS OF THE PROJECT AS DESCRIBED IN THE CONSTRUCTION PLANS AND SPECIFICATIONS.
4. NO EQUIPMENT SHALL BE PERMITTED TO CROSS OR USE ANY EXISTING PAVEMENT OUTSIDE THE GENERAL PROJECT AREA OR HAUL ROUTE. ACCESS TO THE PROJECT AREA FOR ALL HAULING OF MATERIALS AND EQUIPMENT SHALL BE RESTRICTED TO THE DESIGNATED CONSTRUCTION ENTRANCE, STAGING AREA AND HAUL ROUTE.
5. IT SHALL BE THE RESPONSIBILITY OF THE CONTRACTOR TO PROTECT, PRESERVE AND REPAIR THE EXISTING AIRFIELD AND ROADWAY (PUBLIC OR PRIVATE) PAVEMENTS AT ALL TIMES. THE CONTRACTOR SHALL REPAIR ANY DAMAGE TO EXISTING ELECTRICAL, DRAINAGE, AND PAVEMENT STRUCTURES AT NO ADDITIONAL COST TO THE CONTRACT. THE CONTRACTOR SHALL BE RESPONSIBLE FOR OBTAINING PERMITS FOR HAULING ON PUBLIC ROADS, AS APPLICABLE.
6. CONTRACTOR IS REQUIRED TO PROVIDE THEIR OWN RESTROOM FACILITIES.
7. THE OWNER SHALL HAVE THE RIGHT OF FIRST REFUSAL FOR ALL SALVAGEABLE MATERIAL REMOVED ON THE PROJECT.
9. THE CONTRACTOR SHALL PROVIDE ONE SET OF REDLINED RECORD DRAWINGS TO THE RESIDENT ENGINEER AT THE COMPLETION OF THE PROJECT.
10. APPROXIMATE LOCATIONS OF UNDERGROUND UTILITIES ARE SHOWN THROUGHOUT THESE PLANS. THE CONTRACTOR SHALL DETERMINE EXACT LOCATIONS AND PROTECT THESE UTILITIES DURING CONSTRUCTION. ANY UTILITIES DAMAGED DURING CONSTRUCTION SHALL BE REPAIRED AT THE CONTRACTOR'S EXPENSE. CONTRACTOR SHALL COORDINATE WITH THE PROPER AUTHORITIES FOR THE PURPOSE OF LOCATING AND PROTECTING EXISTING UNDERGROUND UTILITIES.
11. THE CONTRACTOR MUST AT ALL TIMES MAINTAIN PROPER DRAINAGE AND EROSION CONTROL FOR ALL AREAS AFFECTED BY HIS WORK.
12. ALL WORKED PERFORMED SHALL BE DONE IN AN ORDERLY AND EFFECTIVE MANNER TO MINIMIZE RUNWAY CLOSURES.
13. NO TRENCHES OR HOLES OR PAVEMENT DROP-OFF'S GREATER THAN 3 INCHES ARE ALLOWED TO REMAIN WITHIN THE RUNWAY SAFETY AREA WHEN IT IS TO BE OPENED TO AIRCRAFT TRAFFIC.
14. THE LOCATION OF THE ENGINEER'S FIELD OFFICE WILL BE DETERMINED AT THE PRE-CONSTRUCTION MEETING.
15. THIS PROJECT WILL DISTURB MORE THAN 1 ACRE OF LAND, THEREFORE A NPDES PERMIT IS REQUIRED. THE CONTRACTOR IS RESPONSIBLE FOR IMPLEMENTING AND MAINTAINING THE EROSION CONTROL MEASURES AS SHOWN IN THE STORMWATER POLLUTION PREVENTION PLAN (SWPPP) AND IN ACCORDANCE WITH THE STANDARDS AND SPECIFICATIONS FOR SOIL EROSION AND SEDIMENT CONTROL, ILLINOIS ENVIRONMENTAL PROTECTION AGENCY, CURRENT ISSUE.
16. A PORTION OF THE HAUL ROUTE AND STAGING AREA SHALL REMAIN IN PLACE AT THE CONCLUSION OF THE PROJECT AS NOTED ON THIS SHEET. ALL OTHER DISTURBED AREAS SHALL BE RESTORED TO ORIGINAL CONDITION. REFER TO AR150540 "HAUL ROUTE" SPECIAL PROVISION.

UTILITY NOTE

THE LOCATION, SIZE, AND TYPE OF MATERIAL OF EXISTING UNDERGROUND AND/OR ABOVEGROUND UTILITIES INDICATED ON THE PLANS ARE NOT REPRESENTED AS BEING ACCURATE, SUFFICIENT OR COMPLETE. NEITHER THE OWNER NOR THE ENGINEER ASSUMES ANY RESPONSIBILITY WHATEVER IN RESPECT TO THE ACCURACY, COMPLETENESS, OR SUFFICIENCY OF THE INFORMATION. THERE IS NO GUARANTEE, EITHER EXPRESSED OR IMPLIED, THAT THE LOCATIONS, SIZE AND TYPE OF MATERIAL OF EXISTING UNDERGROUND UTILITIES INDICATED ARE REPRESENTATIVE OF THOSE TO BE ENCOUNTERED IN THE CONSTRUCTION. IT SHALL BE THE CONTRACTOR'S RESPONSIBILITY TO DETERMINE THE ACTUAL LOCATION OF ALL SUCH FACILITIES, INCLUDING SERVICE CONNECTIONS TO UNDERGROUND UTILITIES. PRIOR TO CONSTRUCTION, THE CONTRACTOR SHALL NOTIFY THE UTILITY COMPANIES OF HIS OPERATIONAL PLANS AND SHALL OBTAIN FROM THE RESPECTIVE UTILITY COMPANIES DETAILED INFORMATION AND ASSISTANCE RELATIVE TO THE LOCATION OF THEIR FACILITIES AND THE WORKING SCHEDULE OF THE COMPANIES FOR REMOVAL OR ADJUSTMENT WHERE REQUIRED. IN THE EVENT AN UNEXPECTED UTILITY INTERFERENCE IS ENCOUNTERED DURING CONSTRUCTION, THE CONTRACTOR SHALL IMMEDIATELY NOTIFY THE UTILITY COMPANY OF JURISDICTION. THE OWNER'S REPRESENTATIVE AND/OR THE RESIDENT ENGINEER SHALL ALSO BE IMMEDIATELY NOTIFIED. ANY DAMAGE TO SUCH MAINS AND SERVICES SHALL BE RESTORED TO SERVICE AT ONCE AND PAID FOR BY THE CONTRACTOR AT NO ADDITIONAL COST TO THE CONTRACT. ALL UTILITY CABLES AND LINES SHALL BE LOCATED BY THE RESPECTIVE UTILITY. **CONTACT JULIE (JOINT UTILITY LOCATION INFORMATION FOR EXCAVATORS) FOR UTILITY INFORMATION, PHONE: 1-800-892-0123.** ALSO CONTACT AIRPORT DIRECTOR/MANAGER AND AIRPORT PERSONNEL FOR ASSISTANCE IN LOCATING UNDERGROUND AIRPORT CABLES AND/OR UTILITIES.

NOTES

1. SODDING IS TO BE PLACED IN LIEU OF SEEDING/MULCHING IN MIDDLE 100' OF TURF RUNWAY INTERSECTION.
2. PAVEMENT CROSS-SLOPE VARIES AT THE FOLLOWING STATION RANGES:
123+60-124+00
127+25-128+50
132+50-134+50
150+00-150+53

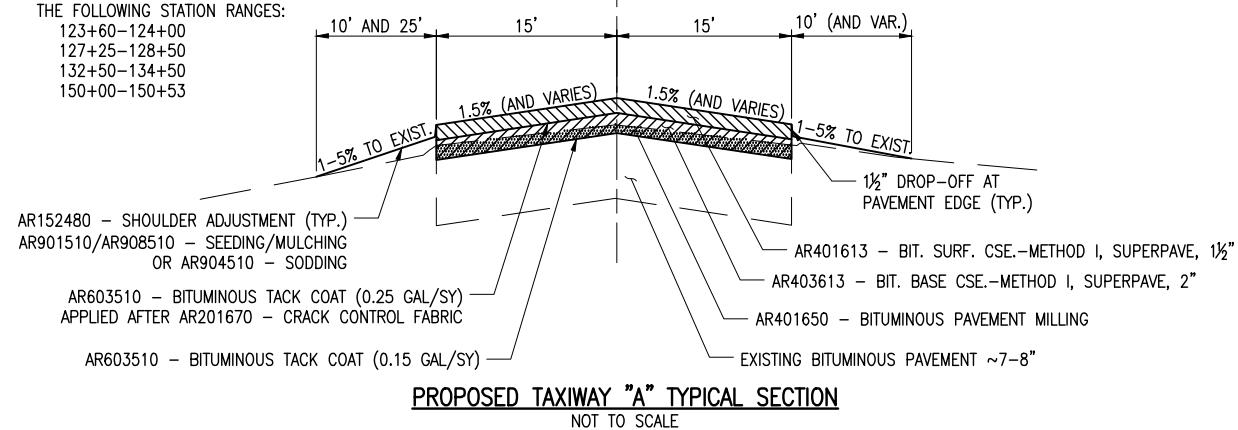

CERTIFIED PAYROLLS

THE RESIDENT ENGINEER CANNOT FORWARD CONSTRUCTION REPORTS FOR PAYMENT TO THE IDOT - DIVISION OF AERONAUTICS FOR PROCESSING UNTIL ALL CERTIFIED PAYROLLS FOR THE PERIOD HAVE BEEN RECEIVED.

MATERIAL CERTIFICATION

COMPLETED WORK CANNOT BE PLACED ON A CONSTRUCTION REPORT FOR PAYMENT UNTIL ALL MATERIAL CERTIFICATIONS FOR THAT PAY ITEM HAVE BEEN RECEIVED, REVIEWED AND ACCEPTED BY THE RESIDENT ENGINEER.

J.U.L.I.E. INFORMATION

COUNTY _____ WILL
CITY _____ JOLIET
TOWNSHIP _____ TROY
SECTION NO. _____ 14 & 15
ADDRESS _____ JOLIET REGIONAL AIRPORT
3000 WEST JEFFERSON STREET
JOLIET, ILLINOIS 60435

HORIZONTAL AND VERTICAL CONTROL DATA				
NO.	DESCRIPTION	NORTHING	EASTING	ELEV.
①	NGS BRASS MONUMENT "G142 1947" NAVD 88. LOCATED ON THE N.E. FACE OF THE AIRPORT TERMINAL BUILDING.	***	***	583.15
②	NGS BRASS MONUMENT "JOLIPOINT" NAD83 (2007) IL. E. ZONE.	1,767,814.89	1,026,441.63	579.87
③	NGS BRASS MONUMENT "JOLIPOINT AZ MK" NAD83 (2007), IL. E. ZONE.	1,766,728.01	1,027,868.33	581.29

LEGEND

- EXISTING PAVEMENT
- PROPOSED IMPROVEMENTS
- EXISTING BUILDINGS
- PROPOSED HAUL ROUTE
- AIRPORT PROPERTY LINE

0' 100' 200' 400'
HALF SIZE SCALE: 1" = 400'
FULL SIZE SCALE: 1" = 200'

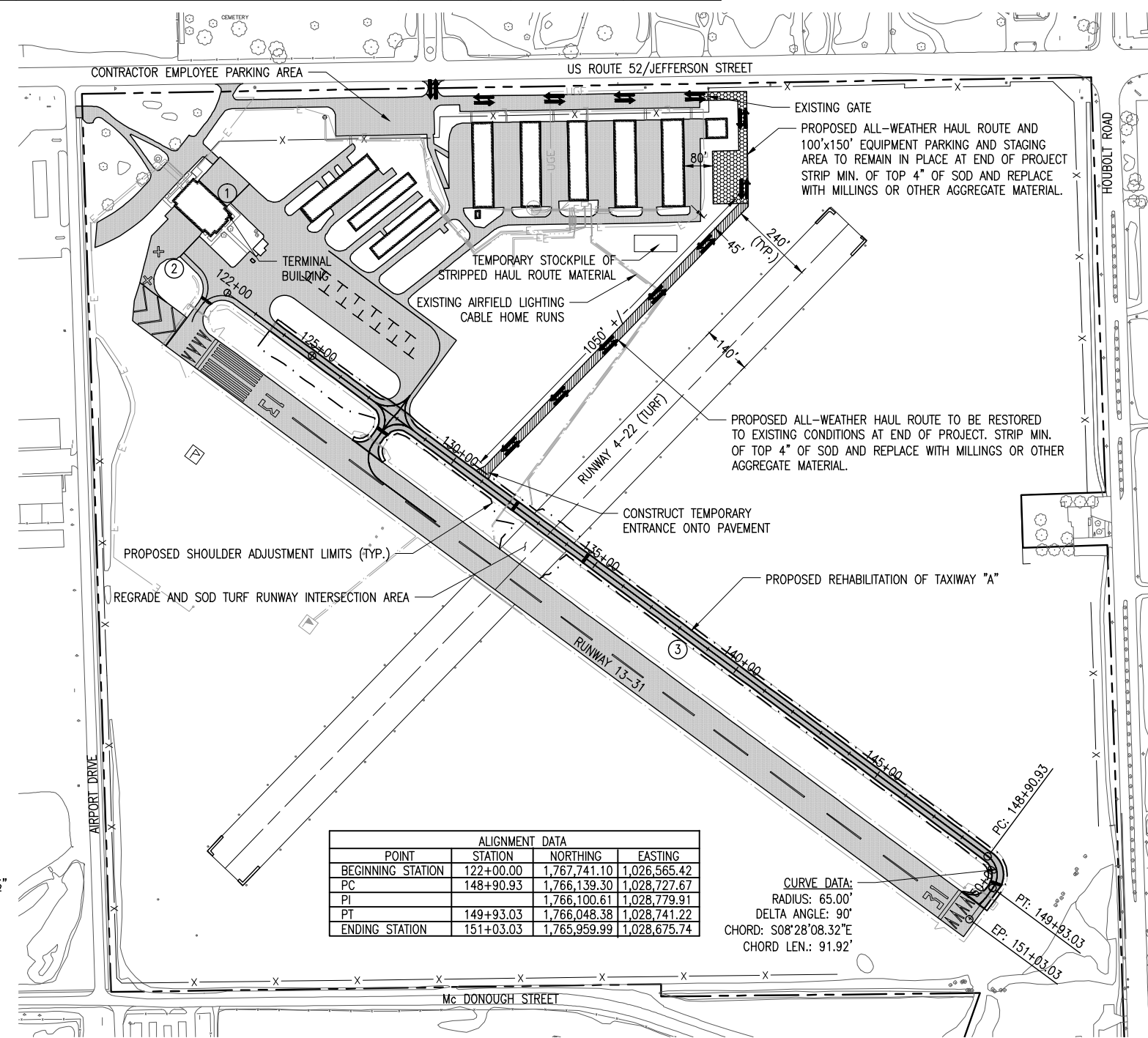

ALIGNMENT DATA			
POINT	STATION	NORTHING	EASTING
BEGINNING STATION	122+00.00	1,767,741.10	1,026,565.42
PC	148+90.93	1,766,139.30	1,028,727.67
PI		1,766,100.61	1,028,779.91
PT	149+93.03	1,766,048.38	1,028,741.22
ENDING STATION	151+03.03	1,765,959.99	1,028,675.74

CURVE DATA:
RADIUS: 65.00'
DELTA ANGLE: 90'
CHORD: S08°28'08.32"E
CHORD LEN.: 91.92'

JO022

REVISION	DATE

**JOLIET REGIONAL AIRPORT
JOLIET PARK DISTRICT
JOLIET, ILLINOIS**

IL. PROJ.: JOT-4233
S.B.G. PROJ.: 3-17-SBGP-XX

Hanson Project No.	C-003-SOM.DWG
Filename	C-003-SOM.DWG
Scale	1"=200'
Date	11/1/13
LAYOUT	KBS 4/30/13
DRAWN	KBS 4/30/13
REVIEWED	CAH 11/1/13

HANSON
© Copyright Hanson Professional Services Inc. 2013
Hanson Professional Services Inc.
1525 South Sixth Street
Springfield, Illinois 62703-2886
Ph: (217) 788-2450 Fax: (217) 788-2503
www.hanson-inc.com
Offices Nationwide

REHABILITATE TAXIWAY "A"

SCOPE OF WORK,
GENERAL NOTES,
TYPICAL SECTION

3

3 of 17 sheets

PROPOSED SAFETY PLAN

JO022

GENERAL - THE JOLIET REGIONAL AIRPORT IS COMPRISED OF TWO RUNWAYS. THE PROPOSED CONSTRUCTION WILL NECESSITATE CLOSING BOTH RUNWAYS, AND THE MAIN TAXIWAY "A", WHICH IS TO BE REHABILITATED. THE CONTRACTOR SHALL COORDINATE ALL CLOSURES WITH THE AIRPORT MANAGER. TEMPORARY MARKINGS, BARRICADES AND CLOSURE CROSSES SHALL BE PLACED AND MAINTAINED AS DETAILED ON THIS SHEET AND AS DIRECTED BY THE ENGINEER. ALL CONSTRUCTION/OPERATIONS ARE TO BE PERFORMED IN ACCORDANCE WITH FAA ADVISORY CIRCULAR (AC) 150/5370-2F "OPERATIONAL SAFETY ON AIRPORTS DURING CONSTRUCTION" AND AC 150/5300-13A "AIRPORT DESIGN". ALL WORK INVOLVING CONSTRUCTION SAFETY AND PHASING AS SHOWN ON THIS SHEET IS CONSIDERED INCIDENTAL TO THE PROJECT AND NO ADDITIONAL COMPENSATION WILL BE ALLOWED.

RUNWAY 13-31 - RUNWAY 13-31 WILL BE CLOSED ANY TIME THE CONTRACTOR INTENDS TO WORK WITHIN 125' OF THE RUNWAY CENTERLINE, AS DICTATED BY FAA CRITERIA AND DELINEATED ON THIS SHEET BY THE "AIRCRAFT OPERATION LINE". RUNWAY 13-31 SHALL BE CLOSED ONLY DURING THE CONSTRUCTION DAY AND SHALL BE RE-OPENED AS SOON AS POSSIBLE. THE CONTRACTOR SHALL BE PERMITTED ONE HALF-DAY OF CLOSURE FOR EACH ITEM OF WORK TO BE COMPLETED WITHIN THE AIRCRAFT OPERATION AREA. NO CLOSURES OF RUNWAY 13-31 WILL BE PERMITTED ON WEEKENDS. THE AIRPORT MANAGER HAS COMPLETE AUTHORITY ON DETERMINING WHEN THE RUNWAY MAY BE CLOSED.

RUNWAY 4-22 (TURF RUNWAY) - RUNWAY 4-22 WILL BE CLOSED FOR THE DURATION OF THE PROJECT AND UNTIL THE PROPOSED SEEDING/SODDING OF THE RUNWAY INTERSECTION AREA HAS BEEN ESTABLISHED.

TAXIWAY "A" - TAXIWAY "A" SHALL BE CLOSED FOR THE DURATION OF THE PROJECT. IT WILL BE REOPENED UPON COMPLETION OF THE SHOULDER ADJUSTMENT, SEEDING/SODDING AND MARKING ITEMS.

RUNWAY/TAXIWAY CLOSURE PROCEDURES:

- CONTACT THE AIRPORT MANAGEMENT OR ASSIGNED REPRESENTATIVE A MINIMUM OF 48 HOURS BEFORE THE DESIRED CLOSING TIME.
- ISSUANCE OF NOTAM AND DEACTIVATION OF AIRFIELD LIGHTING AND NAVAIDS BY AIRPORT MANAGEMENT.
- PLACEMENT OF CROSSES, THEN LIGHTED BARRICADES AND CONES (SEE DETAIL ON THIS SHEET).
- ONLY AT THE TIME THAT ALL OF THE ABOVE ARE COMPLETED MAY ANY CONSTRUCTION OPERATIONS WITHIN 125 FT OF RUNWAY 13-31 OR RUNWAY 4-22 CENTERLINE, OR 45 FT OF TAXIWAY "A" CENTERLINE BEGIN.

RUNWAY/TAXIWAY RE-OPENING PROCEDURES:

- REMOVE CROSSES AND THEN LIGHTED BARRICADES AND CONES.
 - NOTIFY THE AIRPORT MANAGEMENT TO CANCEL THE NOTAM.
 - CANCELLATION OF THE NOTAM AND ACTIVATION OF AIRFIELD LIGHTING AND NAVAIDS BY AIRPORT MANAGEMENT.
- A CLOSED RUNWAY/TAXIWAY WILL NOT BE RE-OPENED UNTIL ALL EQUIPMENT AND WORK ARE FURTHER THAN 125 FT. FROM THE AFFECTED RUNWAY CENTERLINE OR 45 FT. FROM THE CENTERLINE OF TAXIWAY "A".

AIRCRAFT OPERATION LINE - THE CONTRACTOR WILL LOCATE THIS LINE AT THE START OF CONSTRUCTION AND WILL PLACE AND MAINTAIN A FLAGGED LATHE EVERY 150' ALONG IT THROUGH THE PROJECT AREA. THIS LINE WILL BE THE LIMITS THAT ALL CONTRACTOR PERSONNEL MAY VENTURE WHEN A RUNWAY IS NOT CLOSED.

AIRCRAFT SECURITY WILL BE MAINTAINED AT ALL TIMES. THE CONTRACTOR WILL KEEP THE EXISTING GATE CLOSED THROUGHOUT THE CONSTRUCTION DAY UNLESS HE IS IN A CONTINUOUS HAULING OPERATION. THEN HE WILL PROVIDE A PERSON TO WATCH THE GATE TO INSURE NO PUBLIC VEHICLE ENTERS THROUGH THE GATE. AT THE END OF EACH CONSTRUCTION DAY THE GATE WILL BE CLOSED AND LOCKED.

IDENTIFICATION - ALL CONSTRUCTION EQUIPMENT ON THE AIRPORT SHALL BE MARKED, LIGHTED AND/OR FLAGGED IN ACCORDANCE WITH AC 150/5210-5 AND 70/7460-1. CONTRACTOR VEHICLES AND EQUIPMENT SHALL BE PROPERLY MARKED WITH THREE (3) FOOT SQUARE CHECKERED FLAGS (INTERNATIONAL ORANGE AND WHITE). THE CONTRACTOR WILL ALSO PROVIDE WORKERS WITH SOME TYPE OF TAG OR GARMENT TO IDENTIFY THE PERSON AS BEING PART OF THE CONSTRUCTION CREW.

RADIO CONTROL - THE CONTRACTOR WILL BE REQUIRED TO BE IN CONSTANT TWO-WAY RADIO CONTACT (122.70 MHz.) WITH THE JOLIET REGIONAL AIRPORT ANYTIME HE HAS EQUIPMENT OR PERSONNEL ON THE AIRFIELD.

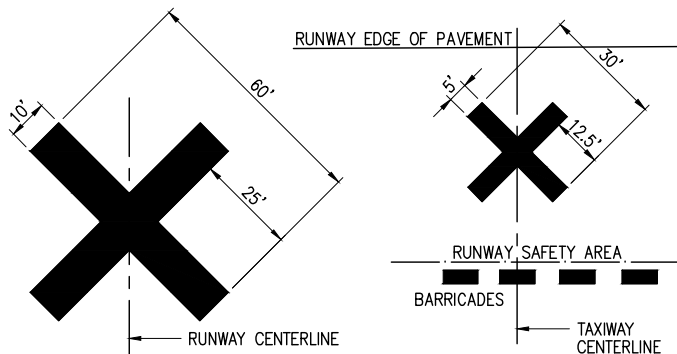

TEMPORARY CLOSURE CROSS DETAIL

NOT TO SCALE

1. TEMPORARY "CLOSED RUNWAY" AND "CLOSED TAXIWAY" MARKINGS SHALL BE "AVIATION YELLOW"
2. TEMPORARY "CLOSED RUNWAY" MARKINGS SHALL BE CONSTRUCTED OF PLYWOOD, DOUBLE-LAYERED SNOW FENCE OR APPROVED FABRIC AND SHALL BE SECURED TO PAVEMENT BY SANDBAGS OR OTHER APPROVED METHOD.
3. TEMPORARY "CLOSED RUNWAY" MARKINGS SHALL BE PLACED OVER THE RUNWAY DESIGNATION NUMBERS UNLESS OTHERWISE DIRECTED BY THE ENGINEER.
4. TEMPORARY "CLOSED TAXIWAY" MARKINGS SHALL BE CONSTRUCTED USING TEMPORARY PAINT SUCH AS SEYMOUR TEMPORARY MARKER, PART NO. 20-636, OR AN EQUIVALENT PAINT EASILY REMOVED WITH WATER WITHOUT DEFACING THE PAVEMENT.
5. TEMPORARY "CLOSED TAXIWAY" MARKINGS SHALL BE PLACED WHEN THE RUNWAY IS OPEN AND THE TAXIWAY IS CLOSED MORE THAN 72 HOURS. THE "CLOSED TAXIWAY" MARKINGS SHALL BE PLACED AS SHOWN ON THIS SHEET.
6. THE PROPOSED CROSSES WILL BE PLACED EACH DAY THE RUNWAY OR TAXIWAY IS CLOSED AND REMOVED WHEN THE RUNWAY OR TAXIWAY IS RE-OPENED. THE CONTRACTOR WILL BE RESPONSIBLE FOR THE PLACEMENT AND REMOVAL OF THE CROSSES. "CLOSED RUNWAY" AND "CLOSED TAXIWAY" MARKINGS SHALL NOT BE A PAY ITEM AND SHALL BE INCIDENTAL TO OTHER CONTRACT BID ITEMS.

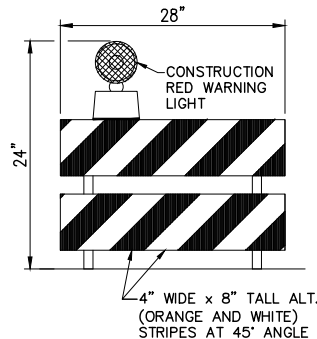

MODIFIED TYPE II BARRICADE

NOT TO SCALE

1. MODIFIED TYPE II BARRICADES SHALL BE SPACED END TO END THE WIDTH OF THE PAVEMENT IN 4' INCREMENTS AS DIRECTED BY THE ENGINEER. BARRICADES ARE TO BE SET BACK 125' FROM THE ACTIVE RUNWAY CENTERLINE OR AS SHOWN ON THE PLANS.
2. CONSTRUCTION RED WARNING LIGHT: THESE ARE PORTABLE, LENS DIRECTED, ENCLOSED LIGHTS. THE COLOR OF THE LIGHT EMITTED SHALL BE RED. THEY MAY BE USED IN EITHER A STEADY BURN (TYPE C) OR LOW INTENSITY FLASHING MODE (TYPE A) UNLESS NOTED OTHERWISE.
3. THE LIGHTING SHALL BE MAINTAINED IN OPERATION DURING THE HOURS OF DARKNESS BETWEEN 1/2 HOUR AFTER SUNSET AND 1/2 HOUR BEFORE SUNRISE AND WHEN CONDITIONS EXIST WHICH TEND TO OBSCURE VISION.
4. BARRICADES SHALL BE SECURED TO THE GROUND BY APPROVED METHODS TO PREVENT MOVEMENT BY PROP WASH, JET BLAST OR OTHER WIND CURRENTS.
5. THE ONLY COLOR COMBINATION ON TYPE II BARRICADES IS ORANGE AND WHITE. THE ORANGE STRIPES SHALL BE ENCAPSULATED LENS REFLECTIVE SHEETING. THE WHITE STRIPES SHALL BE EITHER ENCAPSULATED OR ENCLOSED LENS REFLECTIVE SHEETING AND MUST BE IN ACCEPTABLE CONDITION.

CRITICAL POINTS					
POINT #	DESCRIPTION	LATITUDE	LONGITUDE	GROUND ELEV. (MSL)	HEIGHT (AGL)
1	PAVING	041° 31' 08.29"	-088° 10' 37.94"	578.3	20
2	PAVING	041° 30' 55.52"	-088° 10' 15.06"	577.0	20
3	PAVING	041° 31' 14.57"	-088° 10' 24.27"	580.0	20
4	HAULING	041° 31' 11.10"	-088° 10' 42.17"	579.4	15
5	HAULING	041° 31' 07.02"	-088° 10' 34.22"	578.0	15
6	STOCKPILE	041° 31' 13.25"	-088° 10' 26.94"	578.0	3

LEGEND

- EXISTING IMPROVEMENTS
- PROPOSED IMPROVEMENTS
- EXISTING BUILDINGS
- PROPOSED HAUL ROUTE
- AIRCRAFT PROPERTY LINE
- PROPOSED BARRICADES WHEN TAXIWAY "A" IS CLOSED
- PROPOSED BARRICADES WHEN RUNWAY 13-31 IS CLOSED
- PROPOSED BARRICADES WHEN RUNWAY 4-22 IS CLOSED
- RUNWAY/TAXIWAY CLOSURE CROSSES

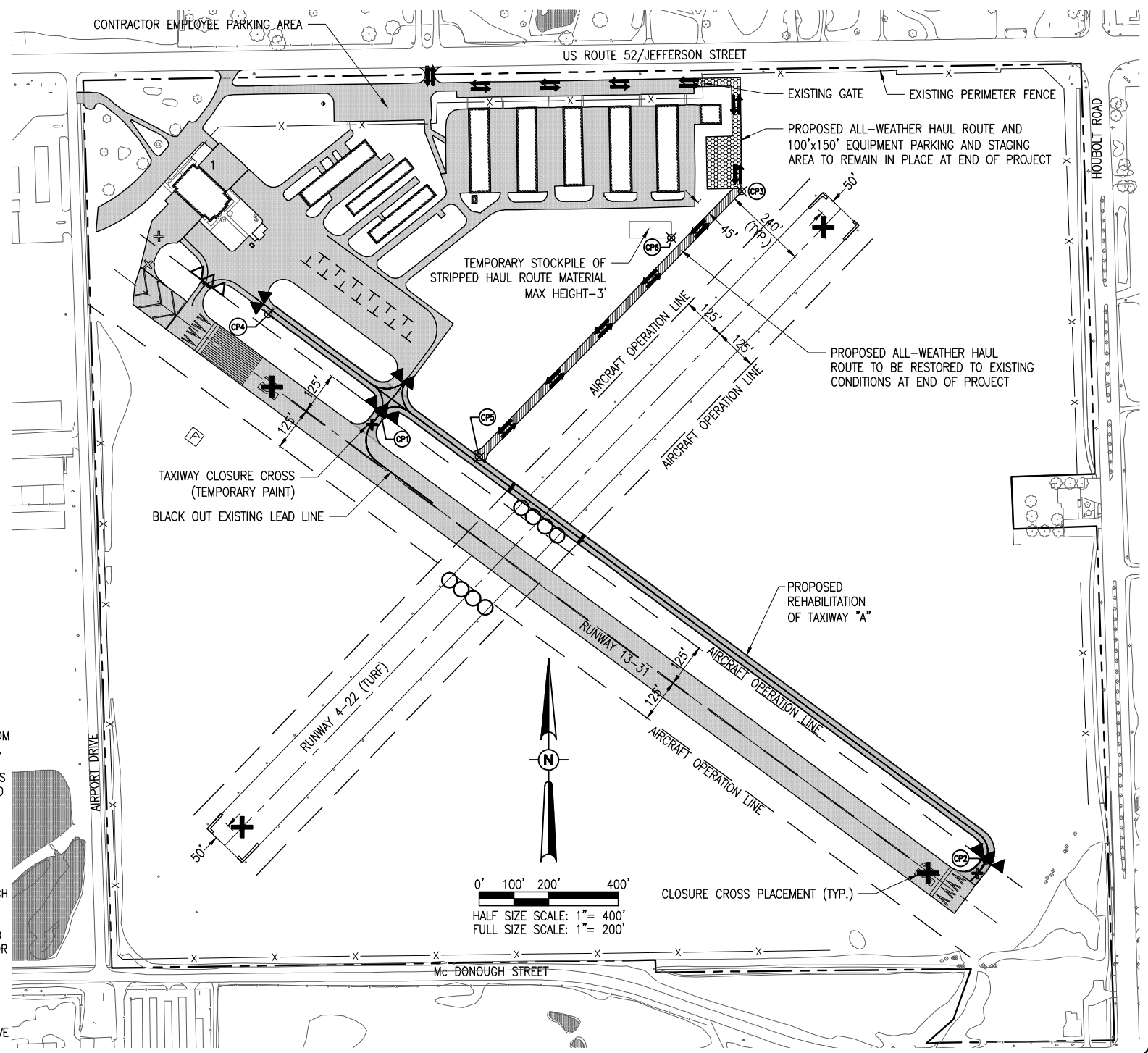

REVISION	DATE			
JOLIET REGIONAL AIRPORT JOLIET PARK DISTRICT JOLIET, ILLINOIS				
S.B.G. PROJ.: 3-17-SBGP-XX				
I.L. PROJ.: JOT-4233				
Hanson Project No.	C-004-SFL.DWG			
Filename	1-200			
Scale	1"=200'			
Date	11/1/13			
LAYOUT	KBS	4/30/13		
DRAWN	KBS	4/30/13		
REVIEWED	CAH	11/1/13		
HANSON Professional Services Inc. 2013 Hanson Professional Services Inc. 1525 South Sixth Street Springfield, Illinois 62703-2886 Ph: (217) 788-2450 Fax: (217) 788-2503 www.hanson-inc.com Offices Nationwide				
REHABILITATE TAXIWAY "A"		CONSTRUCTION SAFETY AND PHASING PLAN		
4				
4 of 17 sheets				

NOV 26, 2013 8:25 AM SCHWED1296

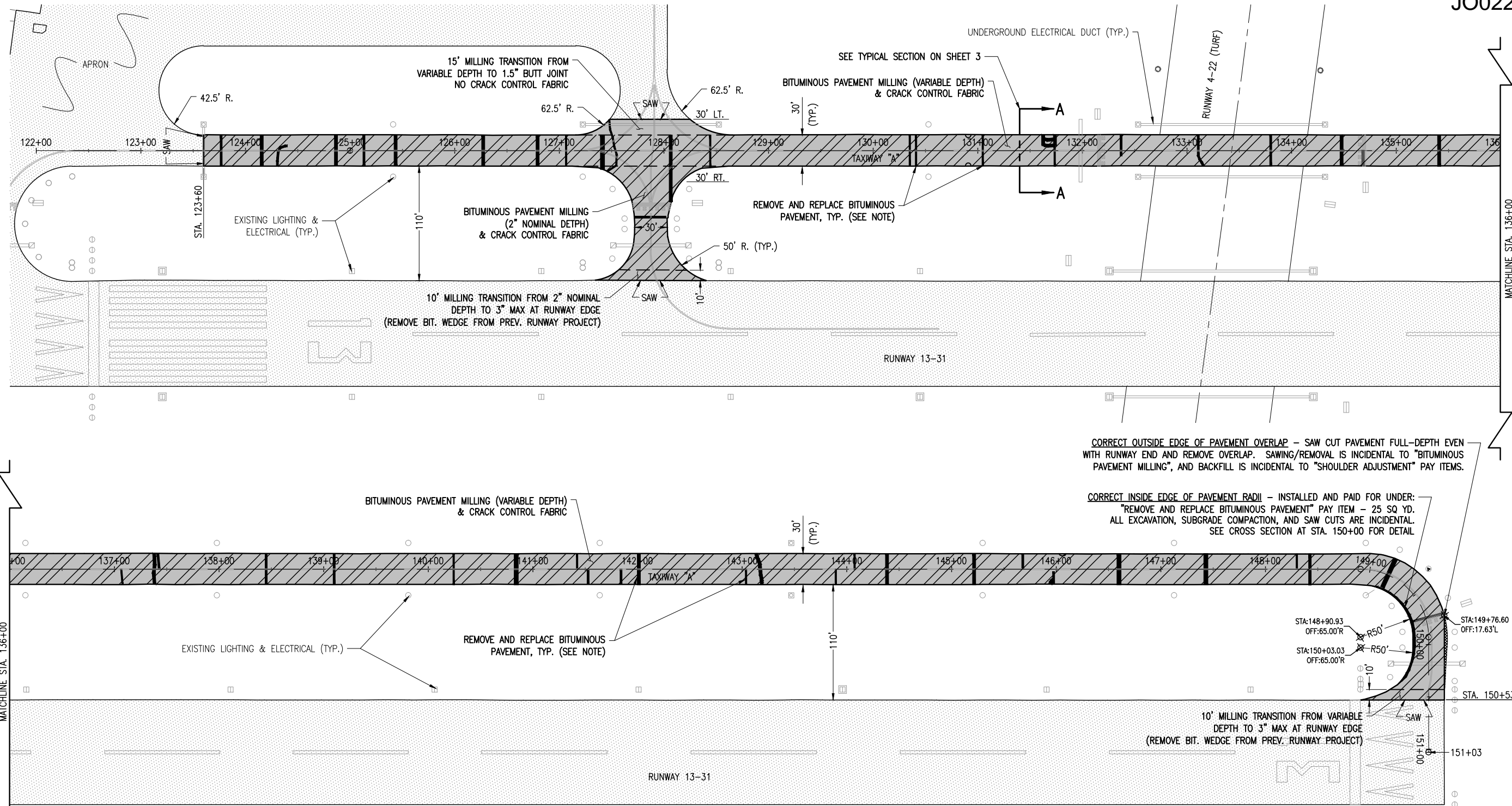

REVISION	DATE

**JOLIET REGIONAL AIRPORT
JOLIET PARK DISTRICT
JOLIET, ILLINOIS**

IL PROJ.: JOT-4233 S.B.G. PROJ.: 3-17-SBGP-XX

Hanson Project No. 12A0059	File Name C-111-PRP.dwg	Scale 1" = 50'	Date 11/1/13
LAYOUT	KBS	4/30/13	
DRAWN	RAD	4/30/13	
REVIEWED	CAH	11/1/13	

HANSON
Professional Services Inc. 2013
Hanson Professional Services Inc.
1525 South Sixth Street
Springfield, Illinois 62703-2886
Ph: (217) 788-2450 Fax: (217) 788-2503
www.hanson-inc.com
Offices Nationwide

**REHABILITATE
TAXIWAY "A"**

PAVEMENT PREPARATION PLAN

PAVEMENT PREPARATION NOTES

1. THE PAVEMENT CONDITIONS AND CRACKS WERE IDENTIFIED DURING A SURVEY OF THE EXISTING TAXIWAY AREA PERFORMED ON 4/15/2013. THE EXACT AMOUNT AND LOCATION OF PAVEMENT TO BE REMOVED AND REPLACED WILL BE DETERMINED AND MARKED OUT BY THE RESIDENT ENGINEER AFTER COMPLETION OF THE MILLING OPERATION. ALL PATCHES, WITH THE EXCEPTION OF THE RADIUS CORRECTION AREAS, WILL HAVE A MINIMUM WIDTH OF 2 FT.
2. IF A SQUARE STRAIGHT EDGE IS NOT OBTAINED FROM THE MILLING OPERATIONS, THE EXISTING PAVEMENT WILL BE SAWED AS SHOWN ON THIS SHEET. SAWING WILL BE CONSIDERED AS AN INCIDENTAL ITEM TO THE PROPOSED PAVEMENT MILLING AND NO ADDITIONAL COMPENSATION WILL BE ALLOWED.
3. ANY ADJACENT PAVEMENT DAMAGED BY THE MILLING OPERATIONS WILL BE REPAIRED AT THE CONTRACTOR'S OWN EXPENSE.
4. ALL MILLED MATERIAL WILL BE DISPOSED OF OFF THE AIRPORT SITE UNLESS OTHERWISE NOTED.
5. THE PROPOSED CRACK CONTROL FABRIC IS TO BE INSTALLED BETWEEN THE PROPOSED BITUMINOUS BASE AND SURFACE COURSE LIFTS.

LEGEND

- EXISTING PAVEMENT
- PROPOSED BITUMINOUS PAVEMENT MILLING (VARIABLE & NOMINAL DEPTHS)
- PROPOSED REMOVE & REPLACE BITUMINOUS PAVEMENT
- PROPOSED CRACK CONTROL FABRIC (TO BE PLACED AFTER BASE COURSE LIFT)

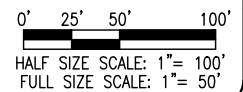

NOV 26, 2013 8:26 AM SCHMED1286 p:\s\sp-306\hanson\Documents\12\jobs\12A0059\CAD\Airport\Sheet\C-111-PRP

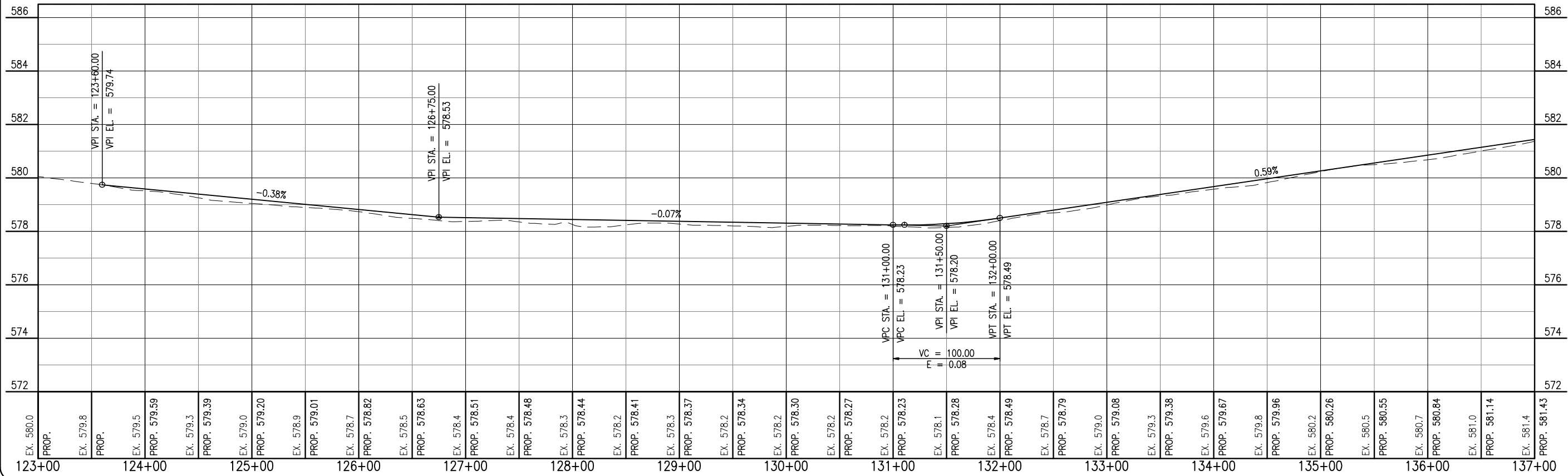
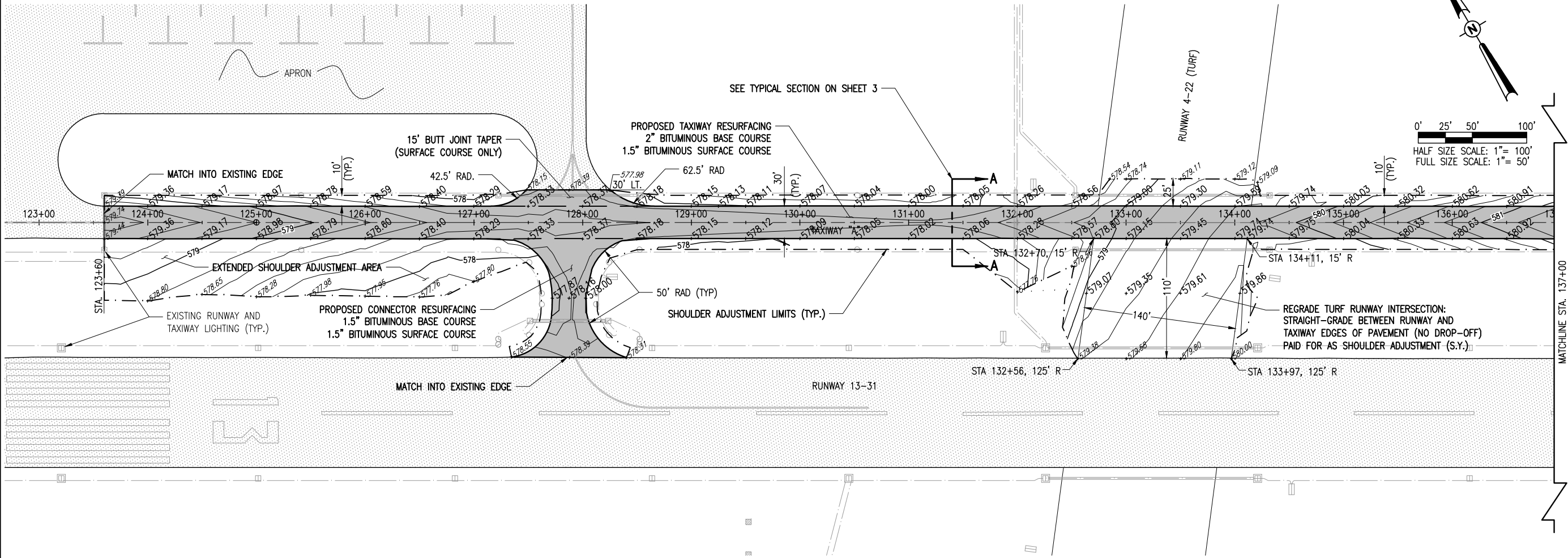

REVISION	DATE	DATE	DATE	DATE

**JOLIET REGIONAL AIRPORT
 JOLIET PARK DISTRICT
 JOLIET, ILLINOIS**

IL PROJ.: J0T-4233 S.B.G. PROJ.: 3-17-SBGP-XX

Hanson Project No.	12A0059
Filename	C-701-PNP.dwg
Scale	1"=50'H, 1"=2'V
Date	11/1/13

LAYOUT	KBS	04/30/13
DRAWN	RAD	04/30/13
REVIEWED	CAH	11/1/13

HANSON
 © Copyright Hanson Professional Services Inc. 2013
 Hanson Professional Services Inc.
 1525 South Sixth Street
 Springfield, Illinois 62703-2886
 Ph: (217) 788-2450 Fax: (217) 788-2503
 www.hanson-inc.com
 Offices Nationwide

**REHABILITATE
 TAXIWAY "A"**

TAXIWAY A PLAN & PROFILE
 STA. 123+60 TO STA 137+00

6
 6 of 17 sheets

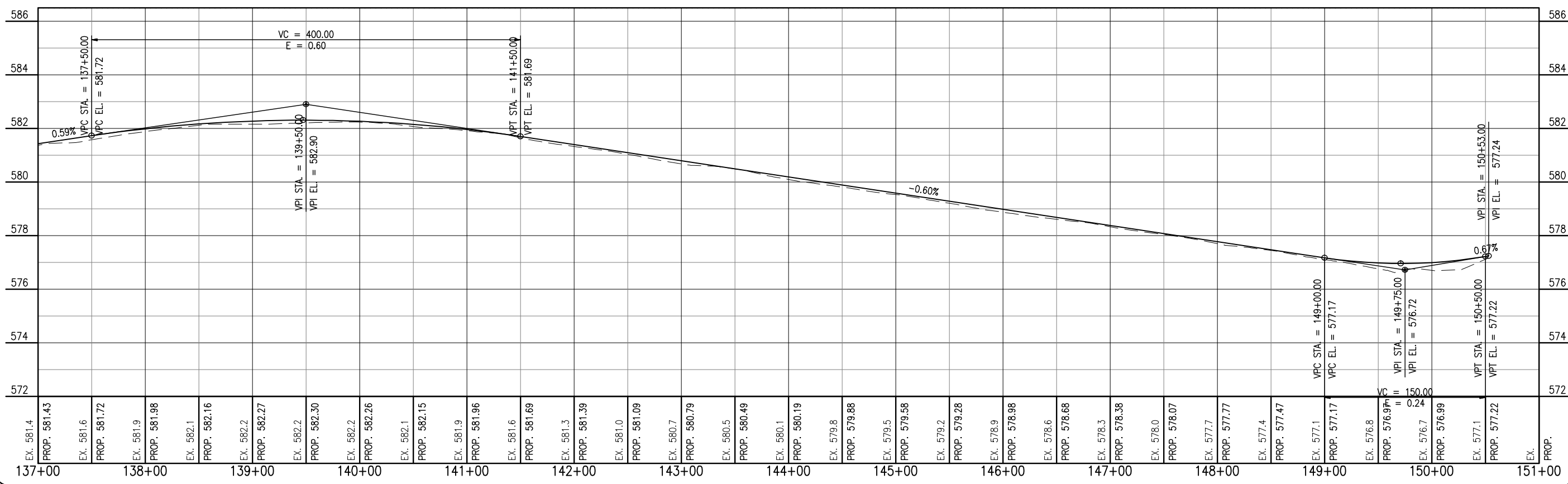
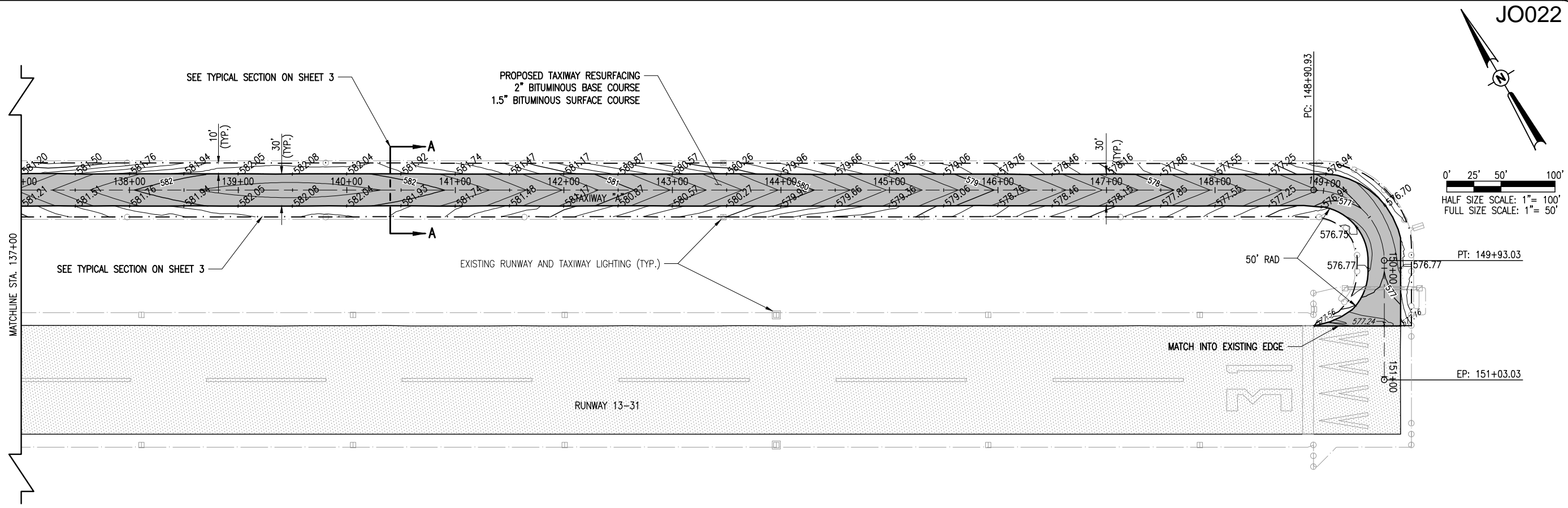

REVISION	
DATE	
JOLIET REGIONAL AIRPORT JOLIET PARK DISTRICT JOLIET, ILLINOIS	
IL PROJ.: JOT-4233 S.B.G. PROJ.: 3-17-SBGP-XX	
Hanson Project No. 12A0059	LAYOUT KRS 04/30/13
Filename C-701-PNP.dwg	DRAWN RAD 04/30/13
Scale 1"=50'H, 1"=2'V	REVIEWED CAH 11/1/13
Date 11/1/13	
HANSON © Copyright Hanson Professional Services Inc. 2013 Hanson Professional Services Inc. 1525 South Sixth Street Springfield, Illinois 62703-2886 Ph: (217) 788-2450 Fax: (217) 788-2503 www.hanson-inc.com Offices Nationwide	
REHABILITATE TAXIWAY "A"	
TAXIWAY A PLAN & PROFILE STA. 137+00 TO 150+53	
7	
7 of 17 sheets	

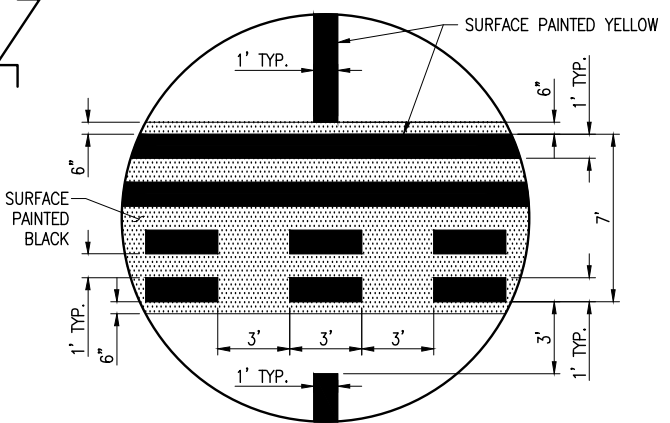
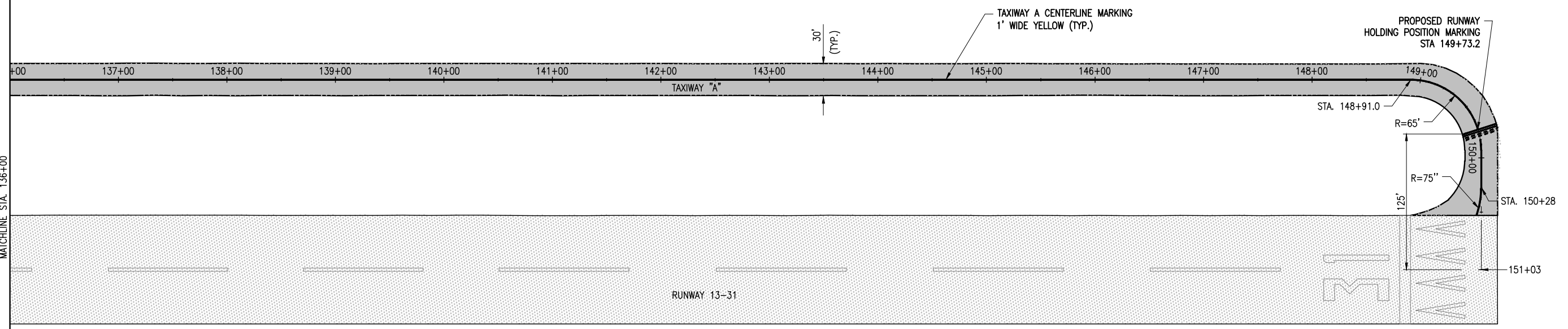
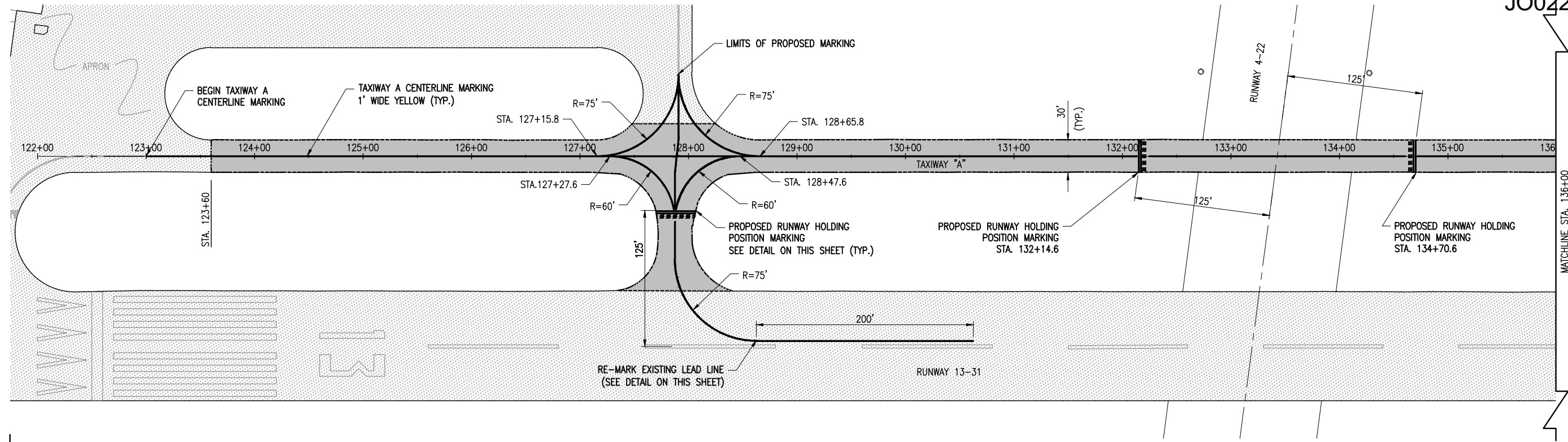

HOLDING POSITION DETAIL
"NOT TO SCALE"

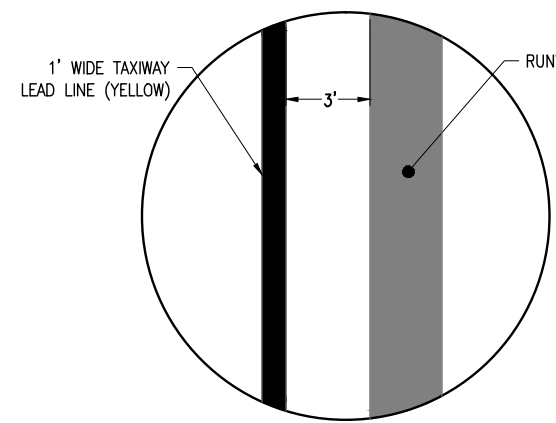

TAXIWAY CENTERLINE LEAD-IN DETAIL
NOT TO SCALE

620-PAVEMENT MARKING-WATERBORNE NOTES

THIS ITEM SHALL CONSIST OF TAXIWAY CENTERLINE, AND HOLDING POSITION MARKING IN ACCORDANCE WITH THESE SPECIFICATIONS AND AT THE LOCATIONS SHOWN ON THE CONSTRUCTION PLANS. ALL MARKING WITH THE EXCEPTION OF THE BORDER WILL BE YELLOW IN COLOR. THE PROPOSED PAVEMENT MARKING WILL BE APPLIED IN TWO APPLICATIONS.

ANY MATERIAL DELIVERED THAT FAILS TO MEET THE SPECIFICATIONS SHALL BE DISPOSED OF BY THE VENDOR AND IMMEDIATELY REPLACED WITH ACCEPTABLE MATERIAL ENTIRELY AT THE VENDOR'S EXPENSE, INCLUDING HANDLING AND TRANSPORTATION CHARGES.

GLASS BEADS SHALL BE REQUIRED ONLY ON THE SECOND APPLICATION OF YELLOW MARKING.

CUT-OFF SHEETS WILL BE REQUIRED TO INSURE STRAIGHT EDGES.

LEGEND

- EXISTING PAVEMENT
- PROPOSED IMPROVEMENTS

0' 25' 50' 100'

HALF SIZE SCALE: 1" = 100'

FULL SIZE SCALE: 1" = 50'

REVISION	DATE

JOLIET REGIONAL AIRPORT
JOLIET PARK DISTRICT
JOLIET, ILLINOIS

IL PROJ.: JOT-4233 S.B.G. PROJ.: 3-17-SBGP-XX

Hanson Project No.	12A0059
Filename	C-151-MRK.dwg
Scale	1" = 50'
Date	11/1/13
LAYOUT	KBS 04/30/13
DRAWN	KBS 04/30/13
REVIEWED	CAH 11/1/13

HANSON
Professional Services Inc. 2013
Hanson Professional Services Inc.
1525 South Sixth Street
Springfield, Illinois 62703-2886
Ph: (217) 788-2450 Fax: (217) 788-2503
www.hanson-inc.com
Offices Nationwide

REHABILITATE TAXIWAY "A"

MARKING PLAN

8

8 of 17 sheets

NOV 26, 2013 9:15 AM SCHMED1296
p:\s\spi-sv306\hanson\dom\hanson\Projects\Documents\12\jobs\12A0059\12A0059D\CAD\Airport\Sheet\C-151-MRK

NOV 26, 2013 9:15 AM SCHMED1296
 p:\s\spi-svr306\hanson\Projects\Documents\12\12A0059\12A0059D\CAD\Airport\Sheet\C-181-SWP

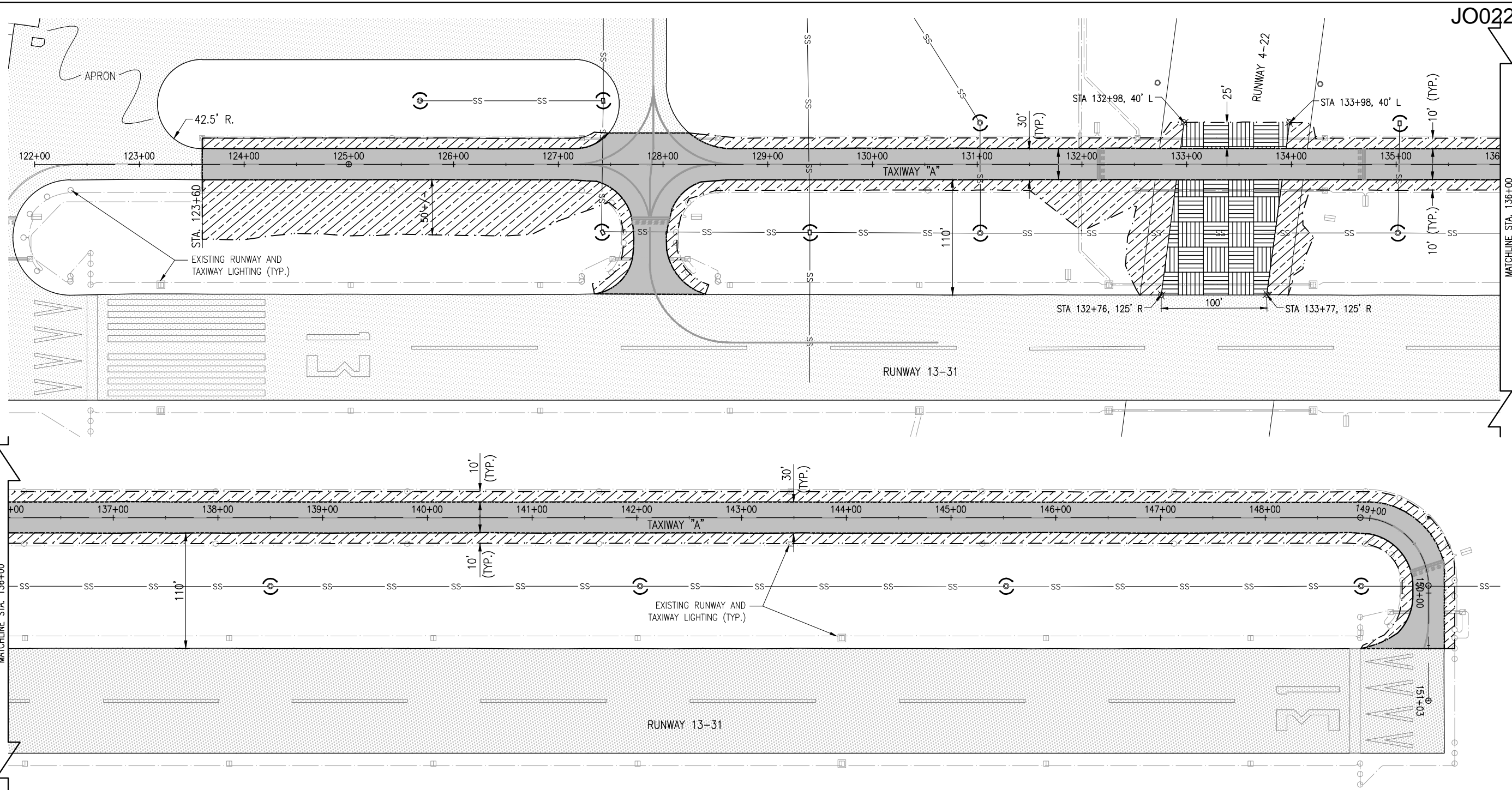

JO022

REVISION	DATE

**JOLIET REGIONAL AIRPORT
 JOLIET PARK DISTRICT
 JOLIET, ILLINOIS**

IL PROJ.: JOT-4233 S.B.G. PROJ.: 3-17-SBGP-XX

Hanson Project No.	12A0059
Filename	C-181-EC.dwg
Scale	1" = 50'
Date	11/1/13

LAYOUT	KBS	04/30/13
DRAWN	RAD	04/30/13
REVIEWED	CAH	11/1/13

HANSON
 © Copyright Hanson Professional Services Inc. 2013
Hanson Professional Services Inc.
 1525 South Sixth Street
 Springfield, Illinois 62703-2886
 Ph: (217) 788-2450 Fax: (217) 788-2503
 www.hanson-inc.com
 Offices Nationwide

**REHABILITATE
 TAXIWAY "A"**

SWPPP & LANDSCAPING PLAN

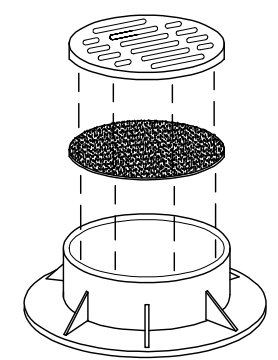

INLET PROTECTION DETAIL
 "NOT TO SCALE"

NOTE

FILTER WRAP TO BE PLACED IN ALL PROPOSED AND EXISTING INLETS LOCATED IN PAVED AREAS.

FABRIC SHALL BE IN CONFORMANCE WITH MATERIALS SPECIFIED FOR EROSION CONTROL FENCING.

FABRIC SHALL OVERLAY FRAME BY 2" MIN.

THE CONTRACTOR SHALL CLEAR DEBRIS AND SILT AS REQUIRED FROM FABRIC TO MAINTAIN DRAINAGE THROUGH THE STRUCTURE.

FABRIC SHALL REMAIN IN PLACE UNTIL TURFED AREAS HAVE DEVELOPED A MIN. OF 80% COVERAGE.

COST OF FILTER WRAP SHALL BE PAID FOR UNDER ITEM NO. AR156520.

- LEGEND**
- EXISTING PAVEMENT
 - PROPOSED PAVEMENT IMPROVEMENTS
 - PROPOSED SEEDING AND MULCHING
 - PROPOSED SODDING
 - SHOULDER ADJUSTMENT LIMITS
 - EXISTING STORM SEWER
 - EXISTING INLET
 - INLET PROTECTION

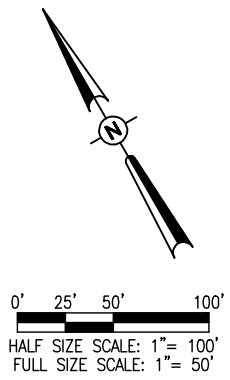

NOV 26, 2013 9:08 AM SCHMED1296
 p:\s\sv\306\hanson\Projects\Documents\12\lots\12A0059\CAD\Airport\Sheet\C-301-XS-ACAD

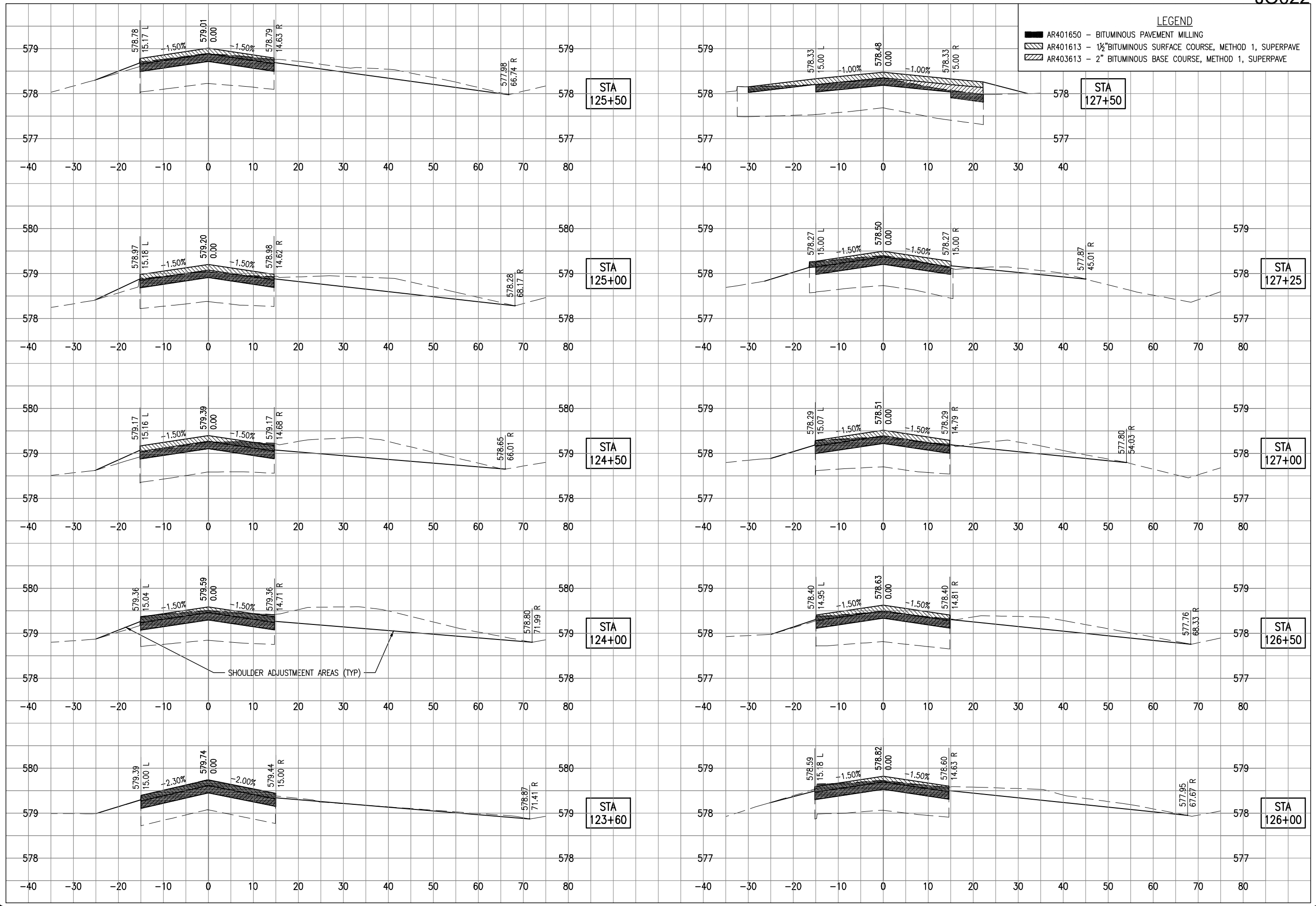

REVISION	DATE

JOLIET REGIONAL AIRPORT
JOLIET PARK DISTRICT
JOLIET, ILLINOIS

IL PROJ: J01-4233 S.B.G. PROJ: 3-17-SBGP-XX

Hanson Project No.	12A0059
Filename	C-301-XS-ACAD.dwg
Scale	1"=20'H 1"=2'V
Date	11/1/13
LAYOUT	KBS 05/28/13
DRAWN	KBS 05/28/13
REVIEWED	CAH 11/1/13

HANSON
 Hanson Professional Services Inc. 2013
 1525 South Sixth Street
 Springfield, Illinois 62703-2886
 Ph: (217) 788-2450 Fax: (217) 788-2503
 www.hanson-inc.com
 Offices Nationwide

REHABILITATE TAXIWAY "A"
 TAXIWAY A CROSS SECTIONS
 STA. 123+60 TO 127+50

LEGEND

- AR401650 - BITUMINOUS PAVEMENT MILLING
- AR401613 - 1½" BITUMINOUS SURFACE COURSE, METHOD 1, SUPERPAVE
- AR403613 - 2" BITUMINOUS BASE COURSE, METHOD 1, SUPERPAVE

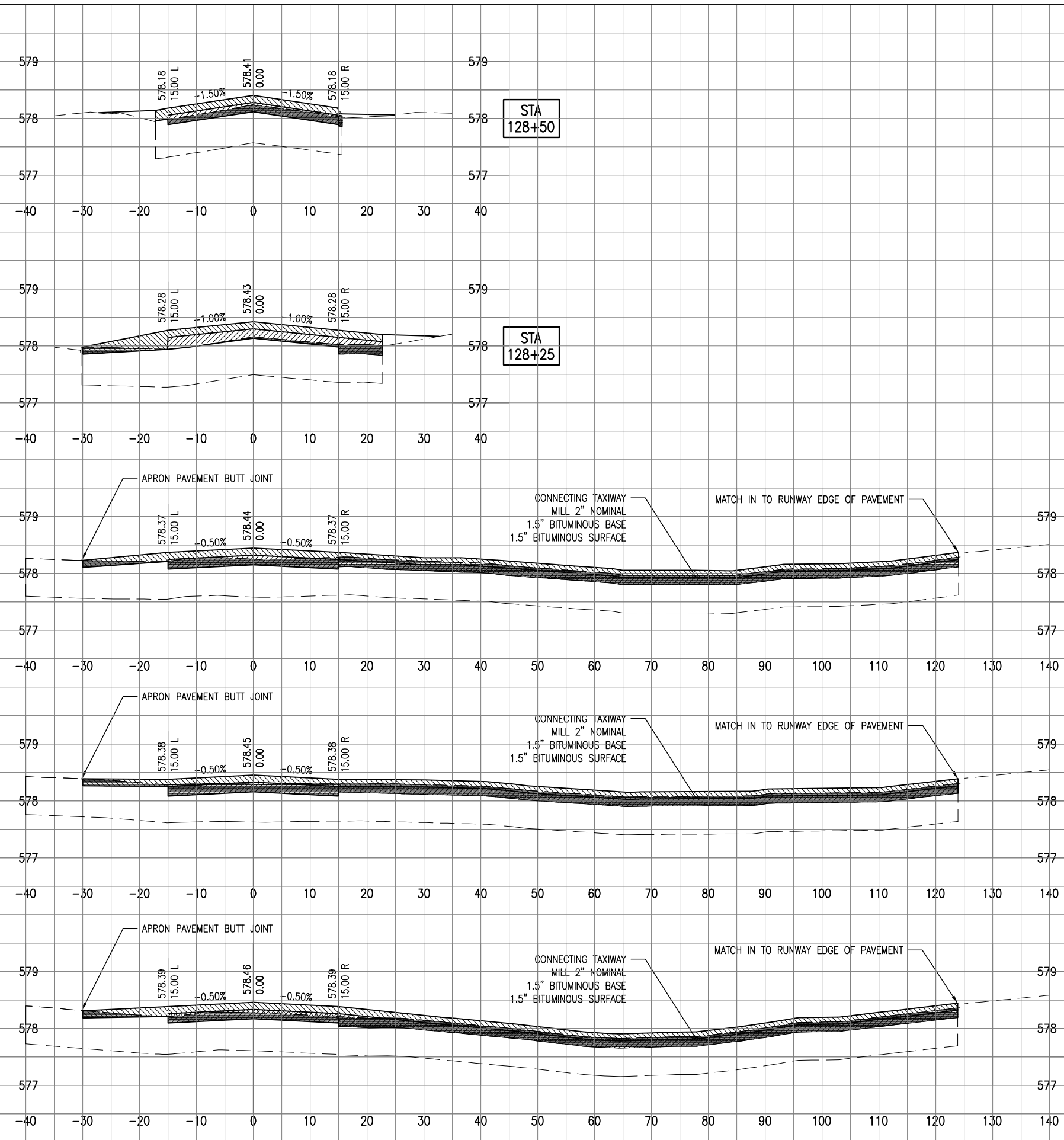

REVISION	DATE

**JOLIET REGIONAL AIRPORT
JOLIET PARK DISTRICT
JOLIET, ILLINOIS**

IL PROJ: J01-4233 S.B.G. PROJ: 3-17-SBGP-XX



Hanson Project No.	12A0059
Filename	C-301-XS-ACAD.dwg
Scale	1"=20'H 1"=2'V
Date	11/1/13
LAYOUT	KBS 05/28/13
DRAWN	KBS 05/28/13
REVIEWED	CAH 11/1/13

HANSON
 © Copyright Hanson Professional Services Inc. 2013
 Hanson Professional Services Inc.
 1525 South Sixth Street
 Springfield, Illinois 62703-2886
 Ph: (217) 788-2450 Fax: (217) 788-2503
 www.hanson-inc.com
 Offices Nationwide

**REHABILITATE
TAXIWAY "A"**
 TAXIWAY A CROSS SECTIONS
 STA. 127+75 TO 128+50

NOV 26, 2013 9:08 AM SCHMED1296
 p:\s\sp-sv\301c\hanson\dom\hanson\Projects\Documents\12\lots\12A0059\12A0059D\CAD\Work\Sheet\C-301-XS-ACAD

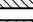
LEGEND

-  AR401650 - BITUMINOUS PAVEMENT MILLING
-  AR401613 - 1 1/2" BITUMINOUS SURFACE COURSE, METHOD 1, SUPERPAVE
-  AR403613 - 2" BITUMINOUS BASE COURSE, METHOD 1, SUPERPAVE

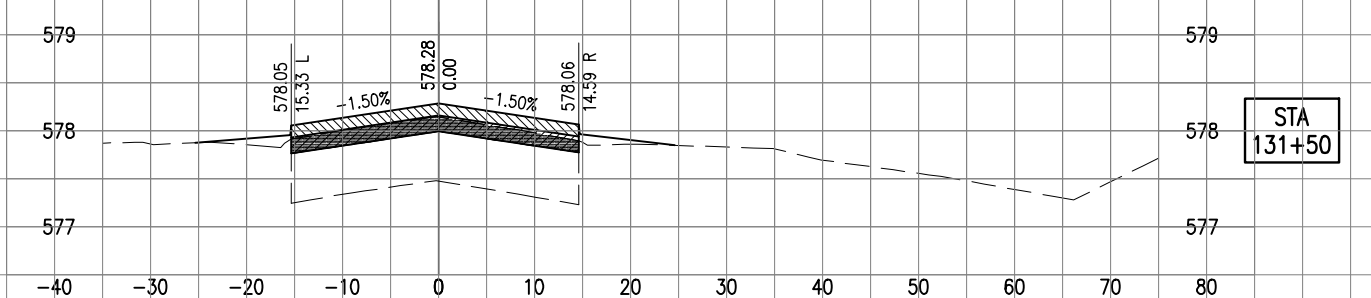
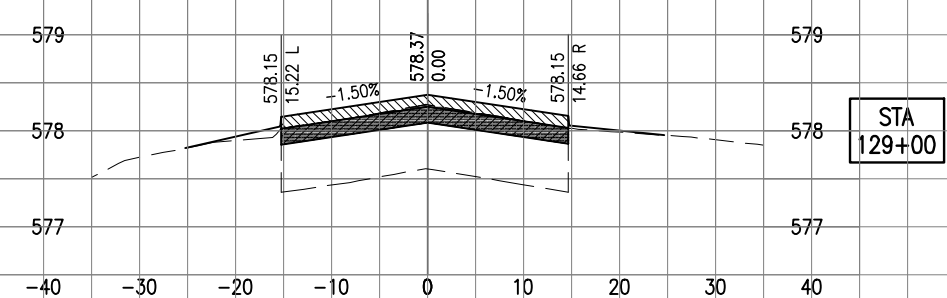
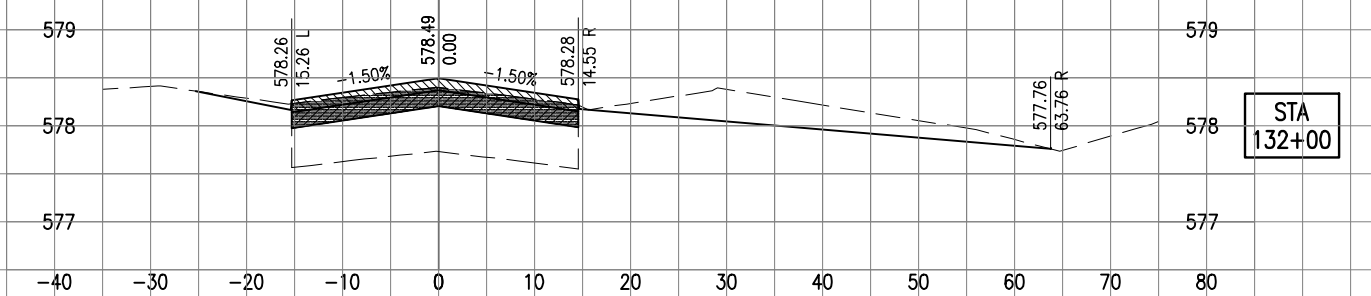
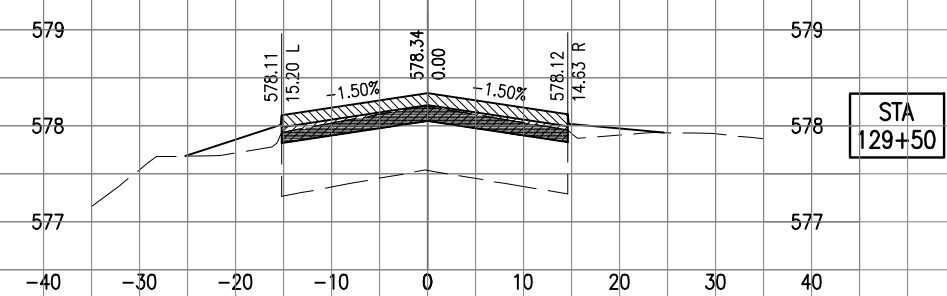
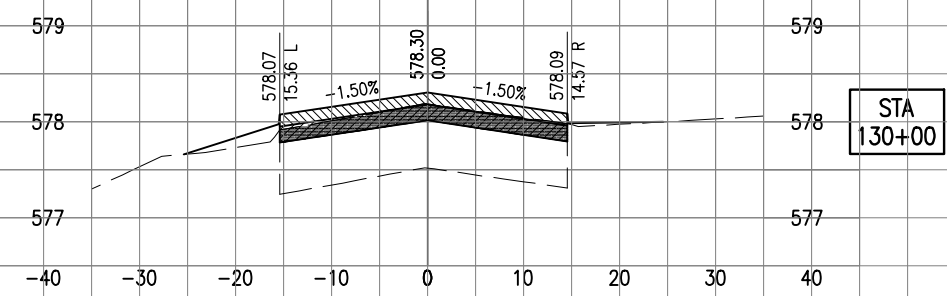
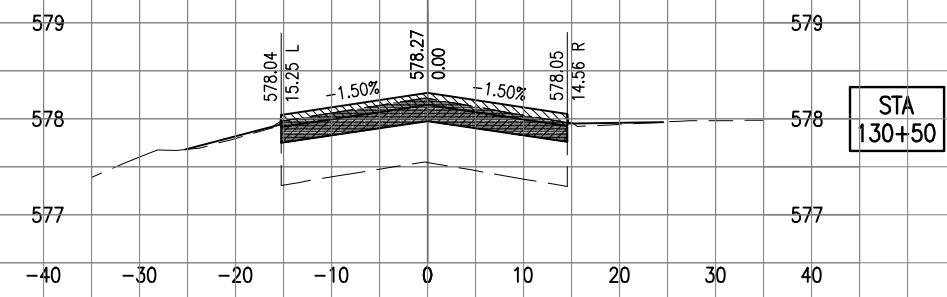
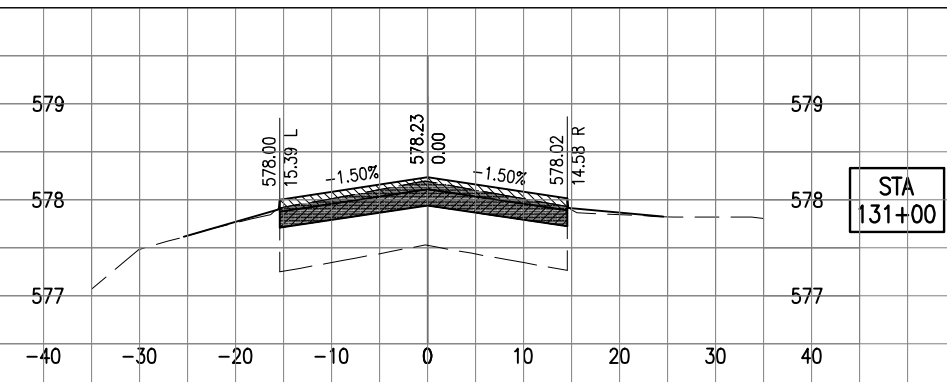

NOV 26, 2013 9:09 AM SCHMED1296
 p:\s\sp-sv\306\hanson\dom\hanson\Projects\Documents\12\lots\12A0059\12A0059D\CAD\Airport\Sheet\C-301-XS-ACAD

REVISION	DATE

**JOLIET REGIONAL AIRPORT
JOLIET PARK DISTRICT
JOLIET, ILLINOIS**

IL PROJ: J01-4233 S.B.G. PROJ: 3-17-SBGP-XX

Hanson Project No.	12A0059
Filename	C-301-XS-ACAD.dwg
Scale	1"=20'H 1"=2'V
Date	11/1/13
LAYOUT	KBS 05/28/13
DRAWN	KBS 05/28/13
REVIEWED	CAH 11/1/13

HANSON
 © Copyright Hanson Professional Services Inc. 2013
 Hanson Professional Services Inc.
 1525 South Sixth Street
 Springfield, Illinois 62703-2886
 Ph: (217) 788-2450 Fax: (217) 788-2503
 www.hanson-inc.com
 Offices Nationwide

**REHABILITATE
TAXIWAY "A"**
 TAXIWAY A CROSS SECTIONS
 STA. 129+00 TO 132+00

LEGEND

- AR401650 - BITUMINOUS PAVEMENT MILLING
- AR401613 - 1½" BITUMINOUS SURFACE COURSE, METHOD 1, SUPERPAVE
- AR403613 - 2" BITUMINOUS BASE COURSE, METHOD 1, SUPERPAVE

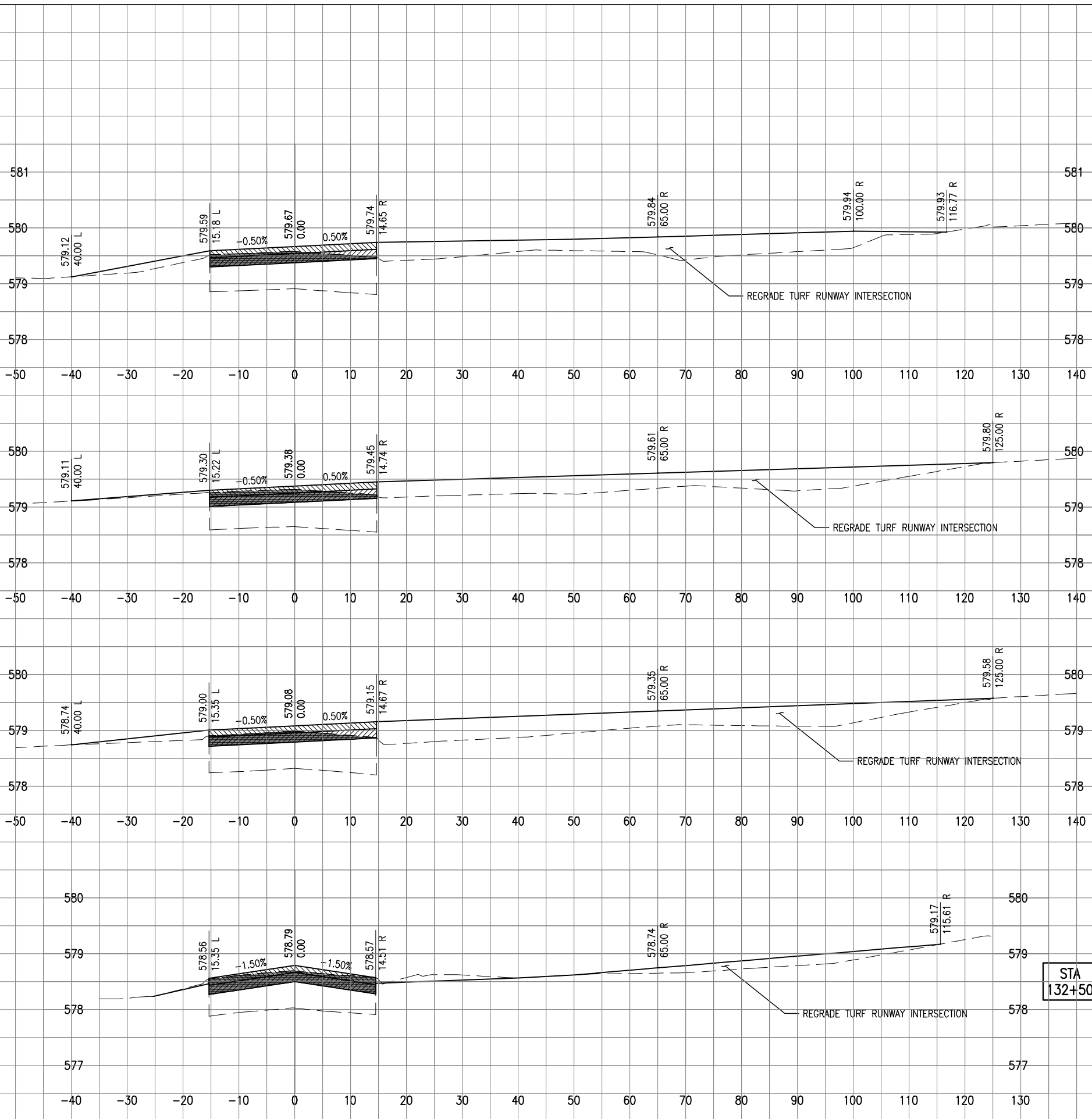

NOV_26_2013_9:09 AM SCHMED1296
 p:\s\sw\306\hanson\dom\hanson\Projects\Documents\12\lots\12A0059\CAD\Airport\Sheet\C-301-XS-ACAD

REVISION		JOLIET REGIONAL AIRPORT JOLIET PARK DISTRICT JOLIET, ILLINOIS	IL. PROJ.: J01-4233 S.B.G. PROJ.: 3-17-SBGP-XX
DATE			
Hanson Project No. 12A0059 Filename C-301-XS-ACAD.dwg Scale 1"=20'H 1"=2'V Date 11/1/13		LAYOUT KES 05/28/13 DRAWN KES 05/28/13 REVIEWED CAH 11/1/13	
© Copyright Hanson Professional Services Inc. 2013 Hanson Professional Services Inc. 1525 South Sixth Street Springfield, Illinois 62703-2886 Ph: (217) 788-2450 Fax: (217) 788-2503 www.hanson-inc.com Offices Nationwide		REHABILITATE TAXIWAY "A" TAXIWAY A CROSS SECTIONS STA. 132+50 TO 134+00	
13		13 of 17 sheets	

LEGEND

- AR401650 - BITUMINOUS PAVEMENT MILLING
- AR401613 - 1½" BITUMINOUS SURFACE COURSE, METHOD 1, SUPERPAVE
- AR403613 - 2" BITUMINOUS BASE COURSE, METHOD 1, SUPERPAVE

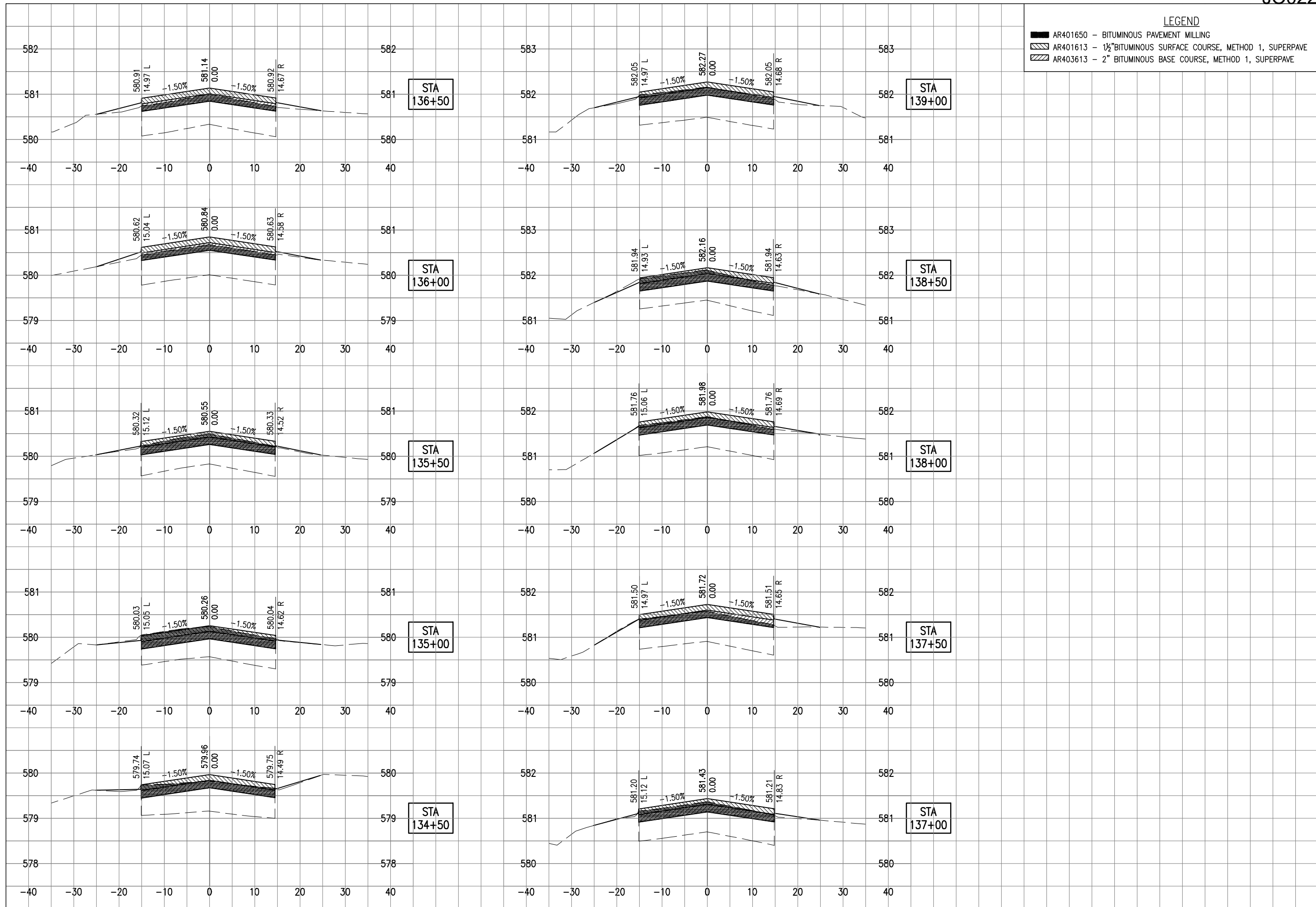

REVISION	DATE

**JOLIET REGIONAL AIRPORT
JOLIET PARK DISTRICT
JOLIET, ILLINOIS**

IL PROJ: J01-4233 S.B.G. PROJ: 3-17-SBGP-XX

Hanson Project No.	12A0059
Filename	C-301-XS-ACAD.dwg
Scale	1"=20'H 1"=2'V
Date	11/1/13
LAYOUT	KBS 05/28/13
DRAWN	KBS 05/28/13
REVIEWED	CAH 11/1/13

HANSON
 © Copyright Hanson Professional Services Inc. 2013
 Hanson Professional Services Inc.
 1525 South Sixth Street
 Springfield, Illinois 62703-2886
 Ph: (217) 788-2450 Fax: (217) 788-2503
 www.hanson-inc.com
 Offices Nationwide

**REHABILITATE
TAXIWAY "A"**
 TAXIWAY A CROSS SECTIONS
 STA. 134+50 TO 139+00

NOV 26, 2013 9:09 AM SCHMED1296
 p:\s\sp-sv\301c\hanson\Documents\12\12A0059\12A0059D\CAD\Xport\Sheet\C-301-XS-ACAD

LEGEND

- AR401650 - BITUMINOUS PAVEMENT MILLING
- AR401613 - 1½" BITUMINOUS SURFACE COURSE, METHOD 1, SUPERPAVE
- AR403613 - 2" BITUMINOUS BASE COURSE, METHOD 1, SUPERPAVE

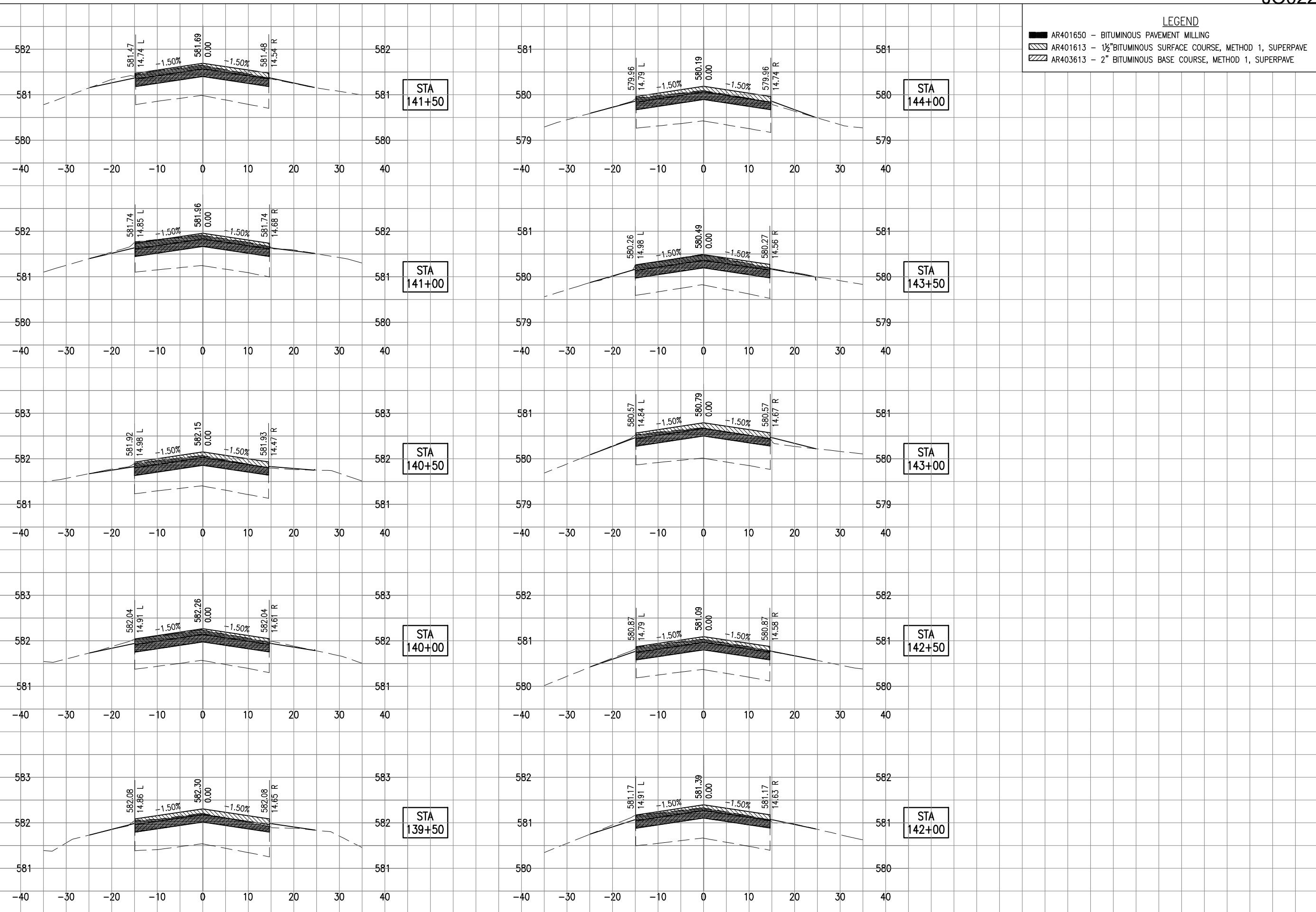

REVISION	DATE

**JOLIET REGIONAL AIRPORT
JOLIET PARK DISTRICT
JOLIET, ILLINOIS**

IL PROJ.: J01-4233 S.B.G. PROJ.: 3-17-SBGP-XX

Hanson Project No.	12A0059
Filename	C-301-XS-ACAD.dwg
Scale	1"=20'H 1"=2'V
Date	11/1/13
LAYOUT	KBS 05/28/13
DRAWN	KBS 05/28/13
REVIEWED	CAH 11/1/13

HANSON
 © Copyright Hanson Professional Services Inc. 2013
 Hanson Professional Services Inc.
 1525 South Sixth Street
 Springfield, Illinois 62703-2886
 Ph: (217) 788-2450 Fax: (217) 788-2503
 www.hanson-inc.com
 Offices Nationwide

**REHABILITATE
TAXIWAY "A"**
 TAXIWAY A CROSS SECTIONS
 STA. 139+50 TO 144+00

NOV 26 2013 9:09 AM SCHMED1296
 p:\s\sp-sv\301c\hanson\dom\hanson\Projects\Documents\12\12A0059\12A0059D\CAD\Virport\Sheet\C-301-XS-ACAD

LEGEND

- AR401650 - BITUMINOUS PAVEMENT MILLING
- AR401613 - 1 1/2" BITUMINOUS SURFACE COURSE, METHOD 1, SUPERPAVE
- AR403613 - 2" BITUMINOUS BASE COURSE, METHOD 1, SUPERPAVE

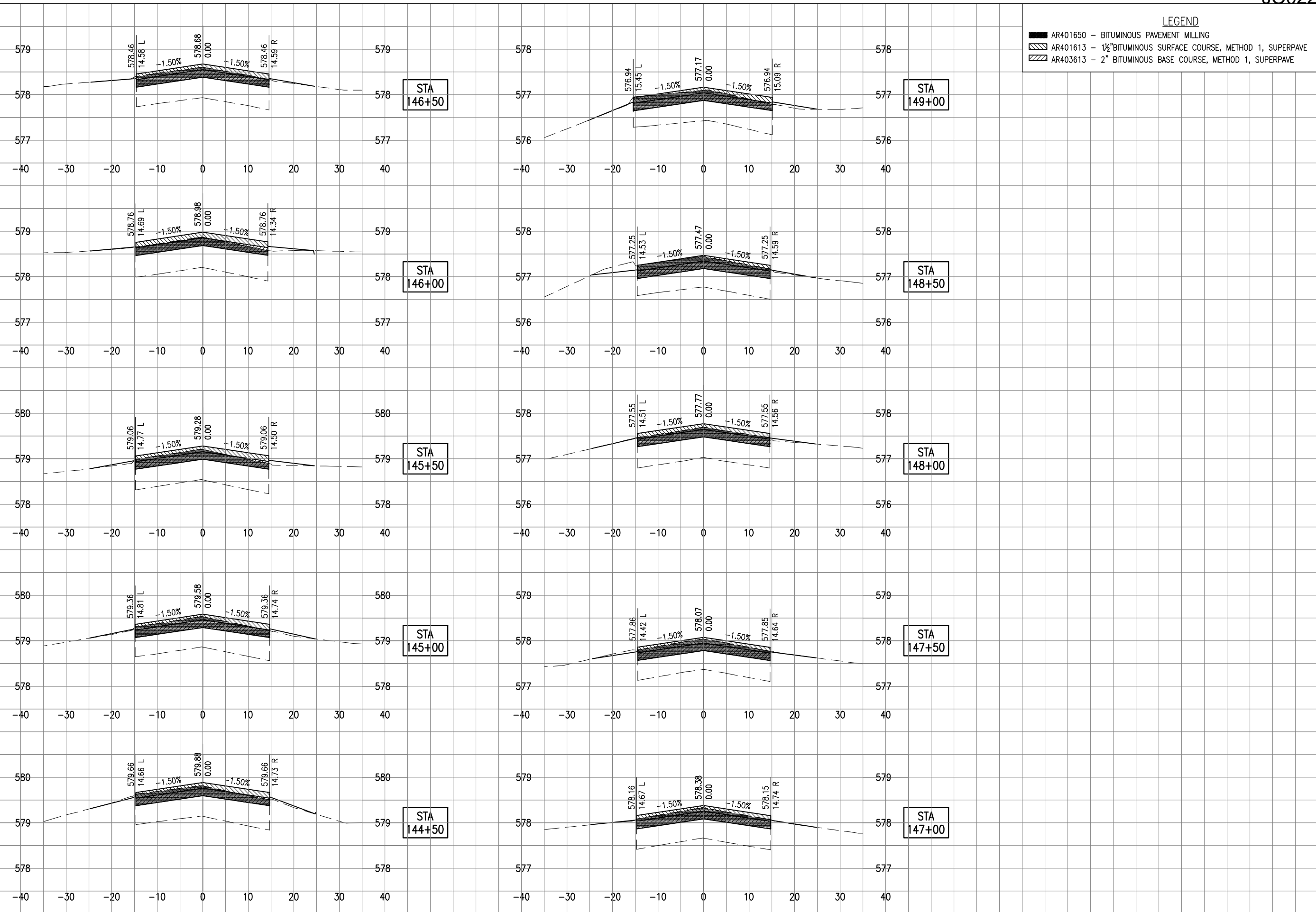

REVISION	DATE

**JOLIET REGIONAL AIRPORT
JOLIET PARK DISTRICT
JOLIET, ILLINOIS**

IL PROJ.: J01-4233 S.B.G. PROJ.: 3-17-SBGP-XX

Hanson Project No.	12A0059
Filename	C-301-XS-ACAD.dwg
Scale	1"=20'H 1"=2'V
Date	11/1/13
LAYOUT	KBS 05/28/13
DRAWN	KBS 05/28/13
REVIEWED	CAH 11/1/13

HANSON
 © Copyright Hanson Professional Services Inc. 2013
 Hanson Professional Services Inc.
 1525 South Sixth Street
 Springfield, Illinois 62703-2886
 Ph: (217) 788-2450 Fax: (217) 788-2503
 www.hanson-inc.com
 Offices Nationwide

**REHABILITATE
TAXIWAY "A"**

TAXIWAY A CROSS SECTIONS
 STA. 144+50 TO 149+00

NOV 26, 2013 9:09 AM SCHMED1296
 p:\s\sp-sv\306\hanson\dom\hanson\Projects\Documents\12\lots\12A0059\12A0059D\CAD\Work\Sheet\C-301-XS-ACAD

LEGEND

	AR401650 - BITUMINOUS PAVEMENT MILLING
	AR401613 - 1 1/2" BITUMINOUS SURFACE COURSE, METHOD 1, SUPERPAVE
	AR403613 - 2" BITUMINOUS BASE COURSE, METHOD 1, SUPERPAVE

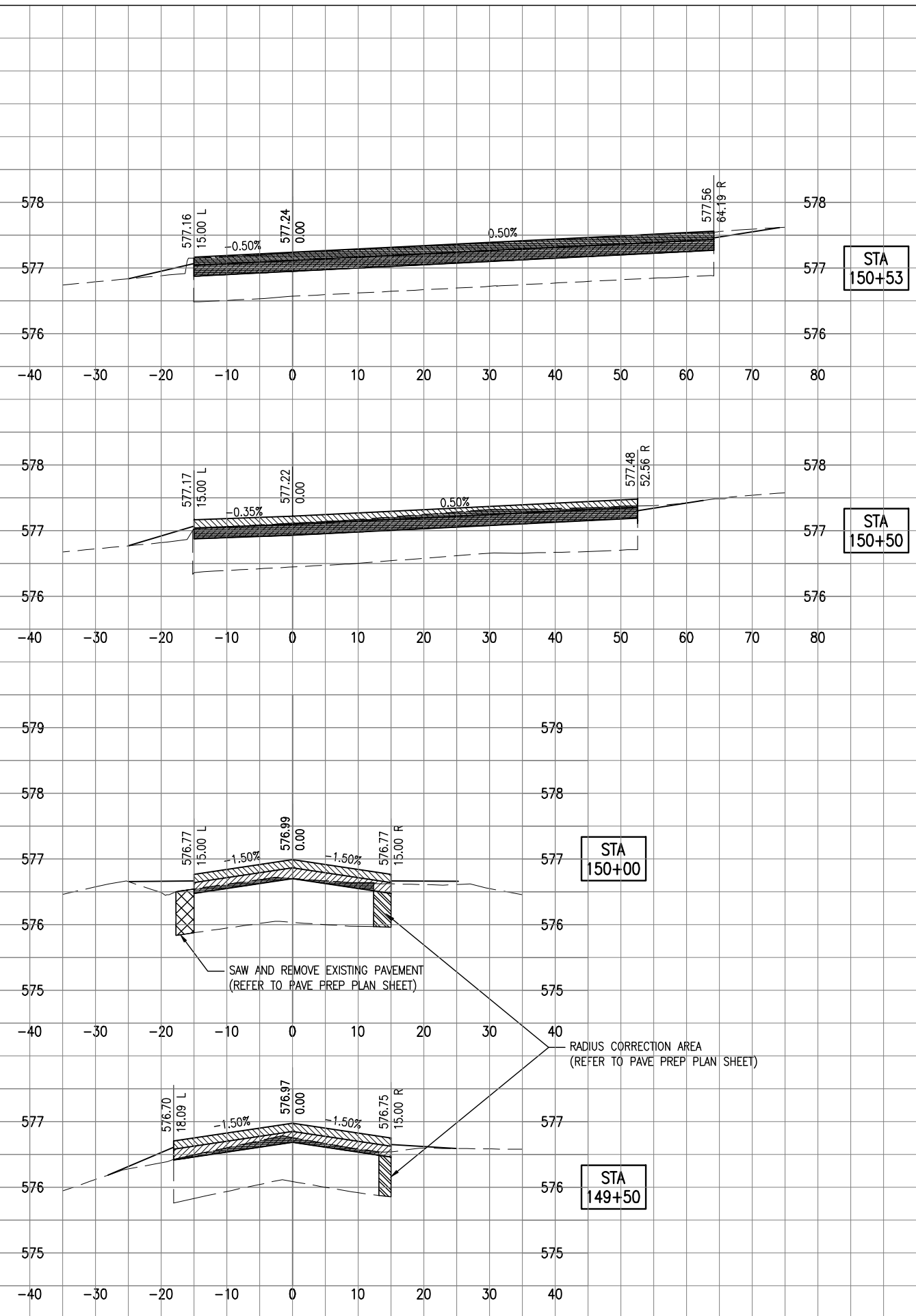

REVISION	DATE

**JOLIET REGIONAL AIRPORT
JOLIET PARK DISTRICT
JOLIET, ILLINOIS**

IL PROJ.: J01-4233 S.B.G. PROJ.: 3-17-SBGP-XX

Hanson Project No.	12A0059
Filename	C-301-XS-ACAD.dwg
Scale	1"=20'H 1"=2'V
Date	11/1/13
LAYOUT	KBS 05/28/13
DRAWN	KBS 05/28/13
REVIEWED	CAH 11/1/13

HANSON
 © Copyright Hanson Professional Services Inc. 2013
 Hanson Professional Services Inc.
 1525 South Sixth Street
 Springfield, Illinois 62703-2886
 Ph: (217) 788-2450 Fax: (217) 788-2503
 www.hanson-inc.com
 Offices Nationwide

REHABILITATE TAXIWAY "A"

TAXIWAY A CROSS SECTIONS
 STA. 149+50 TO 150+53

NOV 26, 2013 9:09 AM SCHMED1296
 p:\s\sp-sv\301c\hanson\dom\hanson\Projects\Documents\12\lots\12A0059\12A0059D\CAD\Airport\Sheet\C-301-XS-ACAD