

STATE OF ILLINOIS
DEPARTMENT OF TRANSPORTATION

F.A.I. RTE.	SECTION	COUNTY	TOTAL SHEETS	SHEET NO.
2457	D9 Weed Spray 2020-1	VARIOUS	10	1
		ILLINOIS	CONTRACT NO. 78755	

PROPOSED HIGHWAY PLANS

FAI ROUTE 2457 (I-241-57)
SECTION D9 WEED SPRAY 2020-1
PROJECT 0-02065-9001
WEED SPRAYING
VARIOUS COUNTIES

FOR INDEX OF SHEETS, SEE SHEET NO. 3
FOR SUMMARY OF QUANTITIES, SEE SHEET NO. 4
FOR STRUCTURAL PAVEMENT DESIGN
INFORMATION, SEE SHEET NO.

TRAFFIC DATA

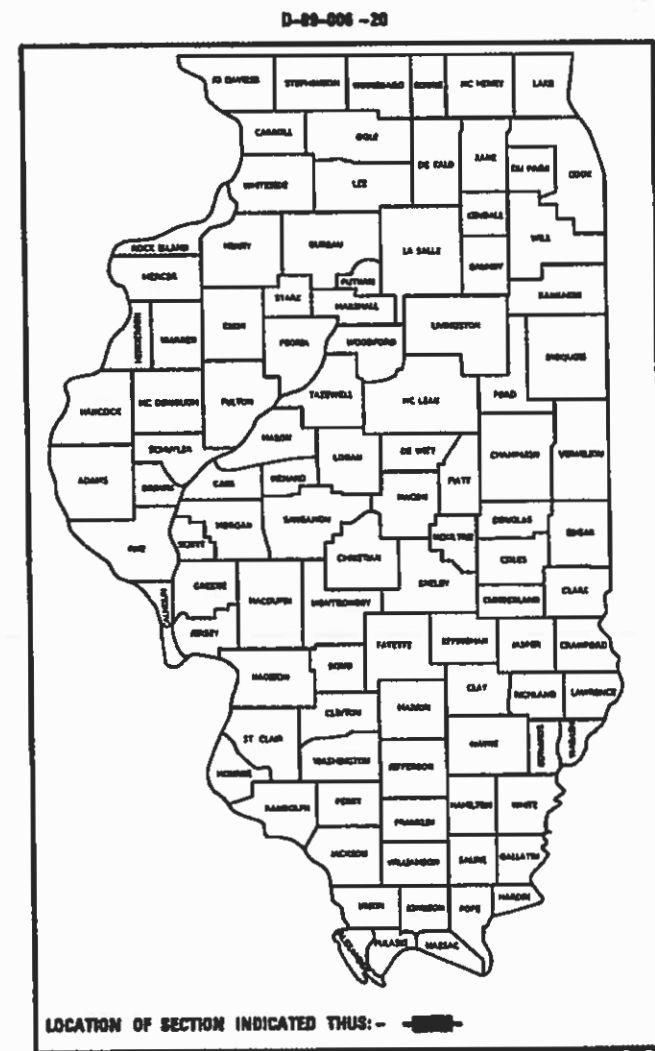

TOWNSHIPS

LOCATION #1 I-57
MP 43.3 TO MP 58.6

LOCATION #2 I-24
MP 1.6 SOUTH TO MP 0
(JOHNSON/WILLIAMSON COUNTY LINE)

LOCATION #3 I-57
MP 39 SOUTH TO MP 43
(JOHNSON/UNION COUNTY LINE)

LOCATION #4 I-57
MP 37 TO MP 22

C-99-009-20

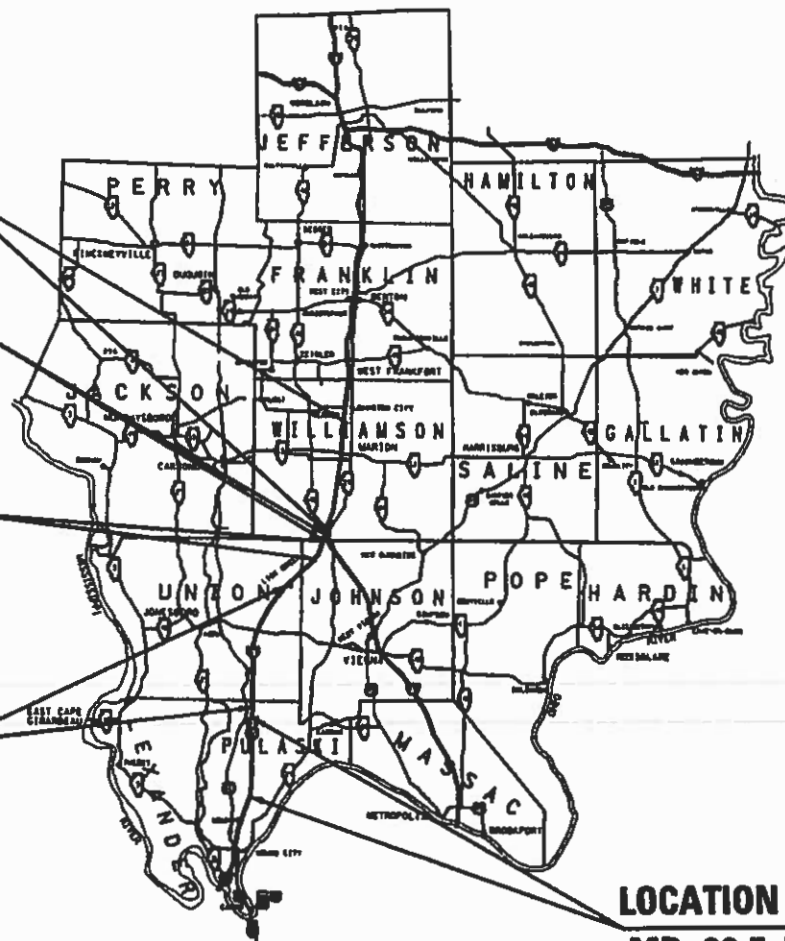

DESIGN DESIGNATION : NA
COORDINATE SYSTEM : NA
POSTED SPEED : 70

J.U.L.I.E.
JOINT UTILITY LOCATION INFORMATION FOR EXCAVATION
1-800-892-0123
OR 811

PROJECT ENGINEER: VALERIE ROLLA (618)-351-5214
PROJECT DESIGNER: MICHAELA DOLLINS (618)-351-5215

CONTRACT NO. 78755

GROSS LENGTH = . FT. = . MILES
NET LENGTH = . FT. = . MILES

LOCATION #5 I-57
MP 22.5 TO MP 18
SOUTH OF ULLIN INTERCHANGE

STATE OF ILLINOIS
DEPARTMENT OF TRANSPORTATION

SUBMITTED 10-02-2017
[Signature]
REGION FIVE ENGINEER

Dec 6 2018
[Signature]
ENGINEER OF DESIGN AND ENVIRONMENT

Dec 10 2018
[Signature]
DIRECTOR OF HIGHWAYS PROJECT IMPLEMENTATION

PRINTED BY THE AUTHORITY
OF THE STATE OF ILLINOIS

INDEX OF SHEETS

SHEET NO.	DESCRIPTION
1	COVER SHEET
2	SIGNATURE SHEET
3	INDEX OF SHEETS AND HIGHWAY STANDARDS
4	SUMMARY OF QUANTITIES
5	SCHEDULE OF QUANTITIES
6	SCHEDULE OF ROUTES AND SPRAY MIXTURES
7	WILLIAMSON COUNTY LOCATION MAP
8	JOHNSON COUNTY LOCATION MAP
9	UNION COUNTY LOCATION MAP
10	PULASKI COUNTY LOCATION MAP

HIGHWAY STANDARDS

- 701101-05: OFF-ROAD OPERATIONS, MULTILANE, 15' (4.5 M) TO 24" (600 MM) FROM PAVEMENT EDGE
- 701106-02: OFF-ROAD OPERATIONS, MULTILANE, MORE THAN 15' (4.5 M) AWAY
- 701426-09: LANE CLOSURE, MULTILANE, INTERMITTENT OR MOVING OPERATION, FOR SPEEDS ≥ 45 MPH
- 701428-01: TRAFFIC CONTROL SETUP AND REMOVAL FREEWAY/EXPRESSWAY
- 701901-08: TRAFFIC CONTROL DEVICES

MODEL: Default
 FILE: \\nls01c-pub\pubroom\data\illinois.gov\PWIDOT\Documents\DOT_Offices\District_9\Projects\78755\CAAD\Drawings\CAD\Drawings\978755_Sheets.dgn

USER NAME = DOLLINSML	DESIGNED -	REVISED -	STATE OF ILLINOIS DEPARTMENT OF TRANSPORTATION	INDEX OF SHEETS HIGHWAY STANDARDS			F.A.I. RTE.	SECTION	COUNTY	TOTAL SHEETS	SHEET NO.
DRAWN -	REVISED -	2457					D9 Weed Spray 2020-1	VARIOUS	10	3	
PLOT SCALE = 100,0000 ' / in.	CHECKED -	REVISED -		CONTRACT NO. 78755							
PLOT DATE = 10/1/2019	DATE -	REVISED -		SCALE:	SHEET	OF	SHEETS	STA.	TO	STA.	ILLINOIS

SUMMARY OF QUANTITIES

0031

ROUTE:	FAI 24/FAI 57 (I-24/I-57)
COUNTY:	VARIOUS
FUNDING:	100% STATE
LOCATION:	RURAL
	ROADWAY
	RURAL

CODE NUMBER	ITEM DESCRIPTION	UNIT	QUANTITY
67100100	MOBILIZATION	L SUM	1
X0325681	NON-IONIC SURFACTANT	GALLON	93
X0325947	MILESTONE VM	GALLON	57
X2000002	VASTLAN	GALLON	223

MODEL: Default
 FILE: \\nas01c.psu.edu\pub\baronm\data\illinois.gov\PWIDOT\Documents\DOT_Offices\District_9\Projects\78755\CAAD\Drawings\978755_Sheets.dgn

SCHEDULE OF QUANTITIES

LOCATION	MARKED ROUTE	COUNTY	ESTIMATED ACRES	MILESTONE VM	VASTLAN	NON-IONIC SURFACTANT
				GALLONS	GALLONS	GALLONS
1	FAI 57 NB	WILLIAMSON	255.1	12	48	20
	FAI 57 SB	WILLIAMSON	255.1	12	48	20
2	FAI 24 EB	WILLIAMSON	17.5	1	3.5	1.5
	FAI 24WB	WILLIAMSON	17.5	1	3.5	1.5
3	FAI 57 NB	JOHNSON	28.75	1.5	5.5	2.5
	FAI 57 SB	JOHNSON	28.75	1.5	5.5	2.5
4	FAI 57 NB	UNION	218	10.5	41	17
	FAI 57 SB	UNION	218	10.5	41	17
5	FAI 57 NB	PULASKI	70.5	3.5	13.5	5.5
	FAI 57 SB	PULASKI	70.5	3.5	13.5	5.5
			TOTAL	57	223	93

MODEL: Default
 FILE: \\nrcs-pub\pub\rooms\dat\illinois\gov\PIWDOT\Documents\DOT_Offices\District_9\Projects\78755\CAAD\Bids\78755_Sheets.dgn

SCHEDULE OF ROUTES

LOCATION	COUNTY	MARKED ROUTE
1	WILLIAMSON	INTERSTATE 57 FROM MP 43.3 (JOHNSON/WILLIAMSON COUNTY LINE) TO MP 58.6 (JUST SOUTH OF JOHNSTON CITY INTERCHANGE)
2	WILLIAMSON	INTERSTATE 24 FROM MP 1.6 (JOHNSON/WILLIAMSON COUNTY LINE) TO MP 0
3	JOHNSON	INTERSTATE 57 FROM MP 43.3 (JOHNSON/WILLIAMSON COUNTY LINE) TO MP 39 (JOHNSON/UNION COUNTY LINE)
4	UNION	INTERSTATE 57 FROM MP 37 (NORTH OF LICK CREEK INTERCHANGE) TO MP 22 (UNION/PULASKI COUNTY LINE)
5	PULASKI	INTERSTATE 57 FROM MP 22 (UNION/PULASKI COUNTY LINE) TO MP 18 (JUST SOUTH OF ULLIN INTERCHANGE)

ESTIMATE OF TOTAL MATERIALS FOR SPRAY MIXTURE

MATERIAL	GALLONS
MILESTONE	57
VASTLAN	223
SURFACTANT	93
CLEAN WATER	35,391

SPRAY MIXTURE

MILESTONE MIXTURE	
MILESTONE	6.0 OZ OF PRODUCT/ACRE
VASTALAN	24 OZ. OF PRODUCT/ACRE
SURFACTANT	10 OZ. OF PRODUCT/ACRE
CLEAN WATER	30 GALLONS/ACRE

MODEL: Default
 FILE: \\nrcs-pub\pubroom\data\illinois.gov\PI\DOT\Documents\DOT_Offices\District_9\Projects\78755\CAAD\Drawings\978755_Sheets.dgn

USER NAME = DOLLINSML	DESIGNED -	REVISED -	STATE OF ILLINOIS DEPARTMENT OF TRANSPORTATION	SCHEDULE OF ROUTES SPRAY MIXTURES		F.A.I. RTE.	SECTION	COUNTY	TOTAL SHEETS	SHEET NO.					
PLOT SCALE = 100,0000' / in.	DRAWN -	REVISED -		SCALE:	SHEET	OF	SHEETS	STA.	TO	STA.	2457	D9 Weed Spray 2020-1	VARIOUS	10	6
PLOT DATE = 10/1/2019	CHECKED -	REVISED -								CONTRACT NO. 78755					
	DATE -	REVISED -								ILLINOIS FED. AID PROJECT					

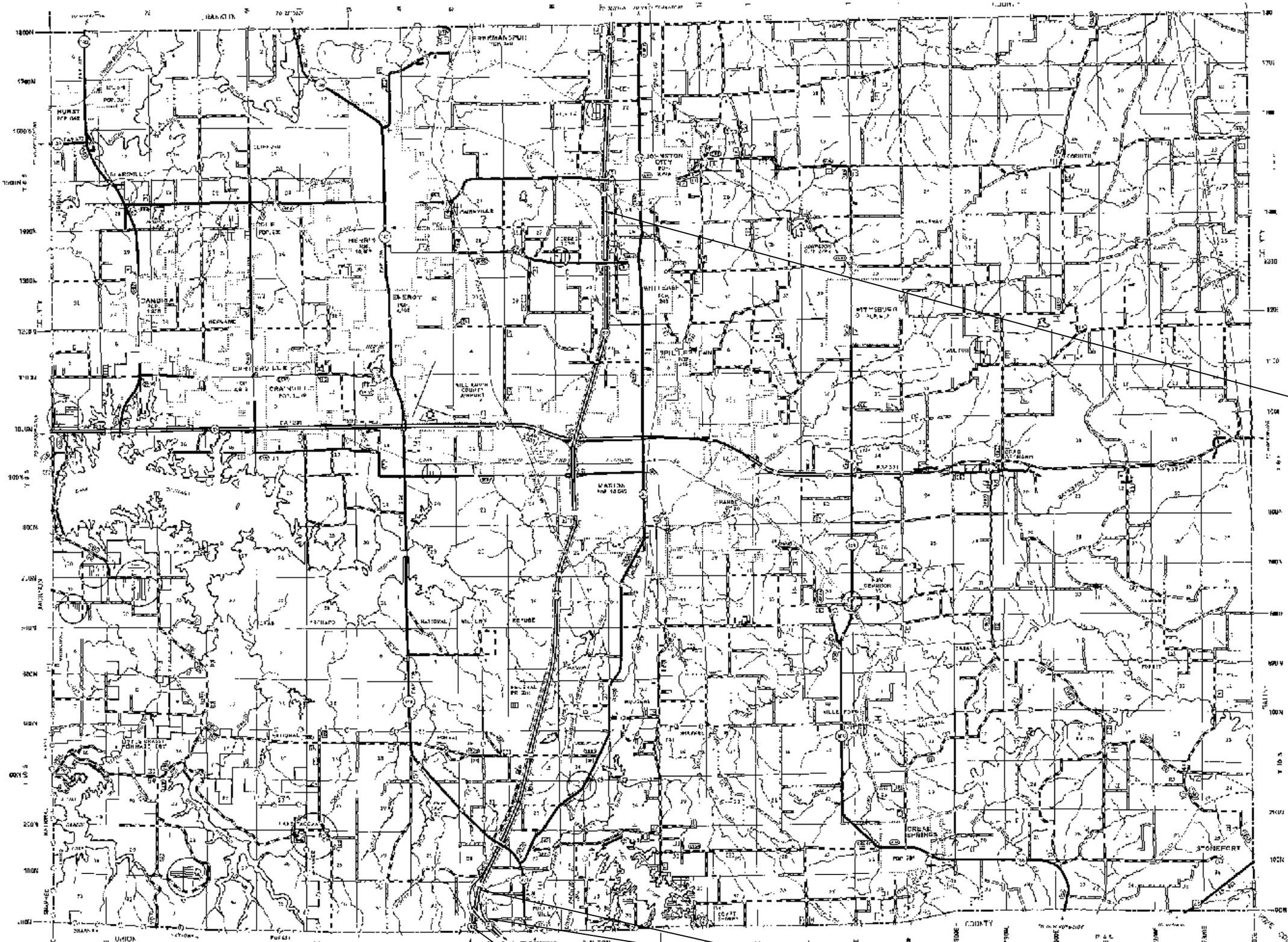

END LOCATION 1: I-57 AT MP 58.6

START LOCATION 1: I-57 AT MP 43.3

START LOCATION 2: I-24 AT MP 1.6
END LOCATION 2: I-24 AT MP 0

MODEL: Default
 FILE: \\sdr01\pub\baronm.dwg
 PROJECT: \\sdr01\pub\baronm.dwg
 OFFICE: \\sdr01\pub\baronm.dwg
 SHEET: 7

USER NAME = DOLLINSML	DESIGNED -	REVISED -
	DRAWN -	REVISED -
PLOT SCALE = 100,000' / in.	CHECKED -	REVISED -
PLOT DATE = 10/1/2019	DATE -	REVISED -

**STATE OF ILLINOIS
DEPARTMENT OF TRANSPORTATION**

WILLIAMSON COUNTY LOCATION MAP

SCALE: SHEET OF SHEETS STA. TO STA.

F.A.I. RTE.	SECTION	COUNTY	TOTAL SHEETS	SHEET NO.
2457	D9 Weed Spray 2020-1	VARIOUS	10	7
CONTRACT NO. 78755				

ILLINOIS FED. AID PROJECT

BEGIN LOCATION 3: I-57 AT MP 43.3
JOHNSON/WILLIAMSON COUNTY LINE

END LOCATION 3: I-57 AT MP 39
JOHNSON/WILLIAMSON COUNTY LINE

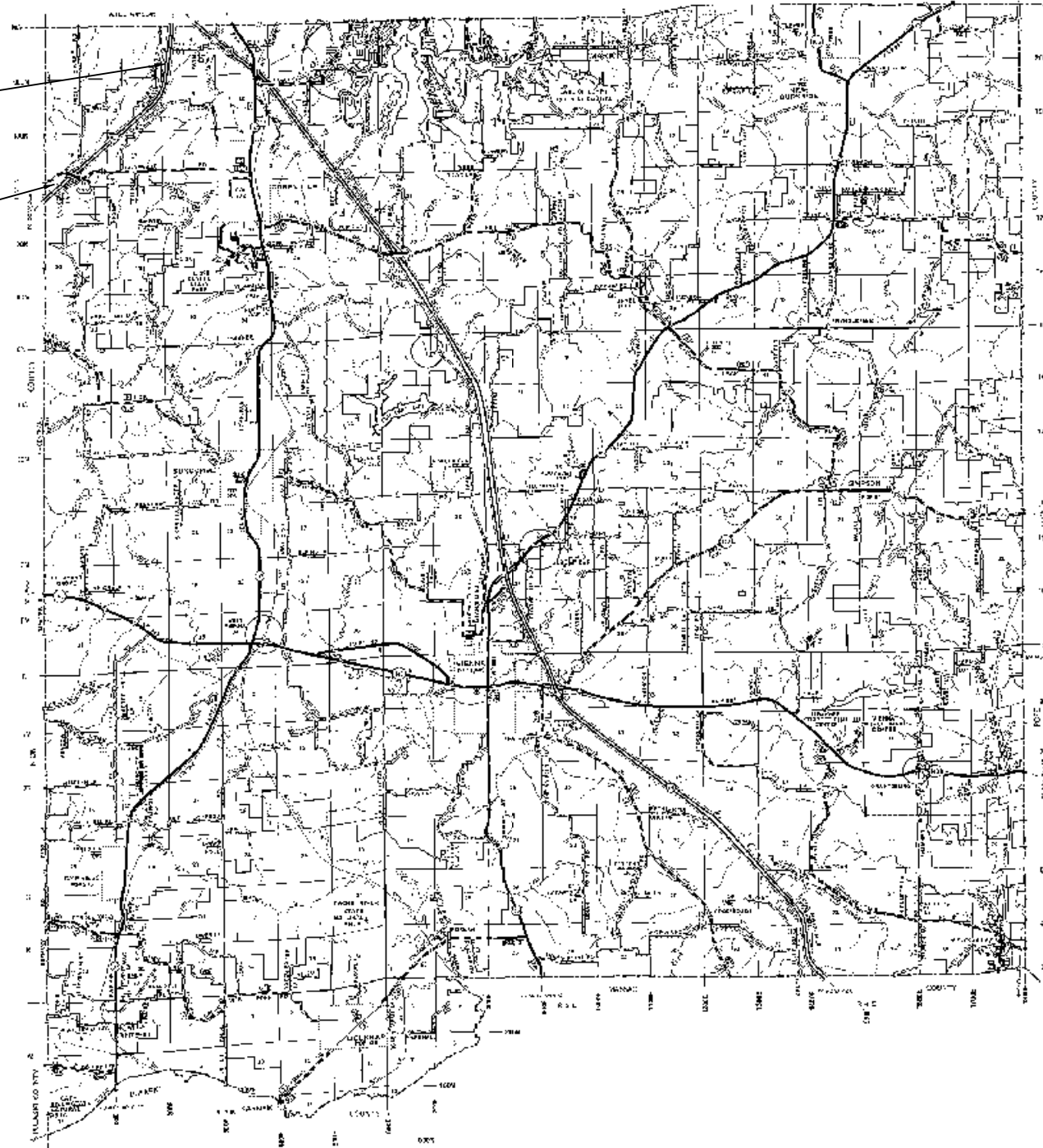

MODEL: Default
FILE: Model: p:\pub\baron.com.dta\illinois.gov\PI\DOT\Documents\DOT_Offices\District 9\Projects\78755\CAD\Sheet\0978755_Sheets.dgn

USER NAME = DOLLINSML	DESIGNED -	REVISED -
	DRAWN -	REVISED -
PLOT SCALE = 100,0000' / in.	CHECKED -	REVISED -
PLOT DATE = 10/1/2019	DATE -	REVISED -

**STATE OF ILLINOIS
DEPARTMENT OF TRANSPORTATION**

JOHNSON COUNTY LOCATION MAP

SCALE: SHEET OF SHEETS STA. TO STA.

F.A.I. RTE.	SECTION	COUNTY	TOTAL SHEETS	SHEET NO.
2457	D9 Weed Spray 2020-1	VARIOUS	10	8
CONTRACT NO. 78755				
ILLINOIS FED. AID PROJECT				

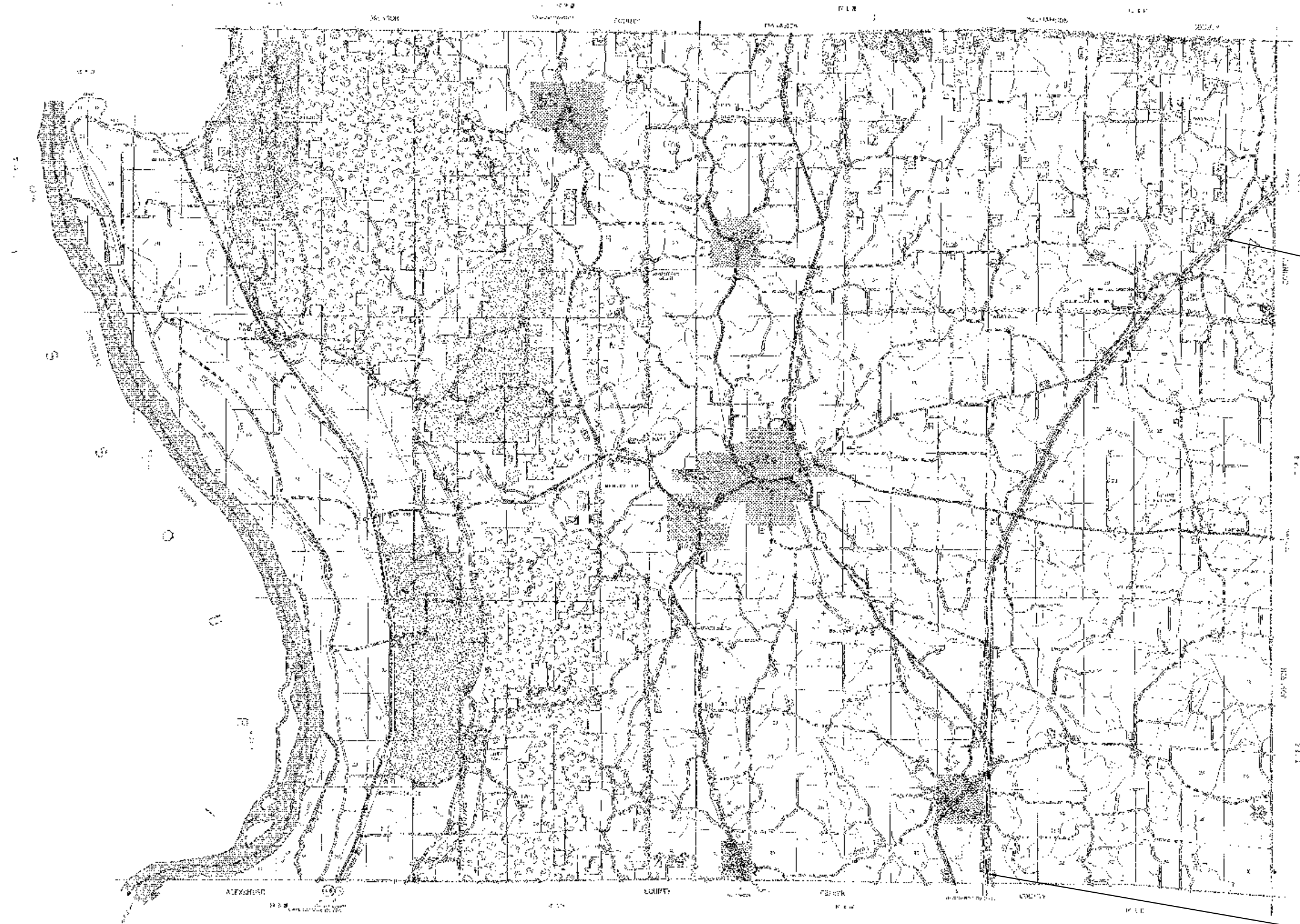

END LOCATION 4: I-57 AT MP 37

START LOCATION 4: I-57 AT MP 22
(PULASKI/UNION COUNTY LINE)

MODEL: Default
 FILE: \\pulsar.com\data\illinois\pulsar\DOT\Documents\DOT_Offices\District_9\Projects\78755\CADD\Map\Sheet0978755_Sheet.dgn

USER NAME = DOLLINSML	DESIGNED -	REVISED -
	DRAWN -	REVISED -
PLOT SCALE = 100,0000' / in.	CHECKED -	REVISED -
PLOT DATE = 10/1/2019	DATE -	REVISED -

**STATE OF ILLINOIS
DEPARTMENT OF TRANSPORTATION**

UNION COUNTY LOCATION MAP

SCALE: SHEET OF SHEETS STA. TO STA.

F.A.I. RTE.	SECTION	COUNTY	TOTAL SHEETS	SHEET NO.
2457	D9 Weed Spray 2020-1	VARIOUS	10	9
CONTRACT NO. 78755				
ILLINOIS FED. AID PROJECT				

END LOCATION 5: I-57 AT MP 22

BEGIN LOCATION 5: I-57 AT MP 18



MODEL: Default
FILE: \\pulsarroom.dia.illinois.gov\PWDOT\Documents\DOT_Offices\District_9\Projects\78755\CADD\Drawings\DOT_78755_Sheets.dgn

USER NAME = DOLLINSML	DESIGNED -	REVISED -
	DRAWN -	REVISED -
PLOT SCALE = 100,0000' / in.	CHECKED -	REVISED -
PLOT DATE = 10/1/2019	DATE -	REVISED -

**STATE OF ILLINOIS
DEPARTMENT OF TRANSPORTATION**

PULASKI COUNTY LOCATION MAP

SCALE: SHEET OF SHEETS STA. TO STA.

F.A.I. RTE.	SECTION	COUNTY	TOTAL SHEETS	SHEET NO.
2457	D9 Weed Spray 2020-1	VARIOUS	10	10
CONTRACT NO. 78755				
ILLINOIS FED. AID PROJECT				