

STATE OF ILLINOIS
DEPARTMENT OF TRANSPORTATION

F.A. II. RTE.	SECTION	COUNTY	TOTAL SHEETS	SHEET NO.
72	(75-6)CJS	PIKE	19	1
		ILLINOIS	CONTRACT NO. 72878	

D-96-018-24

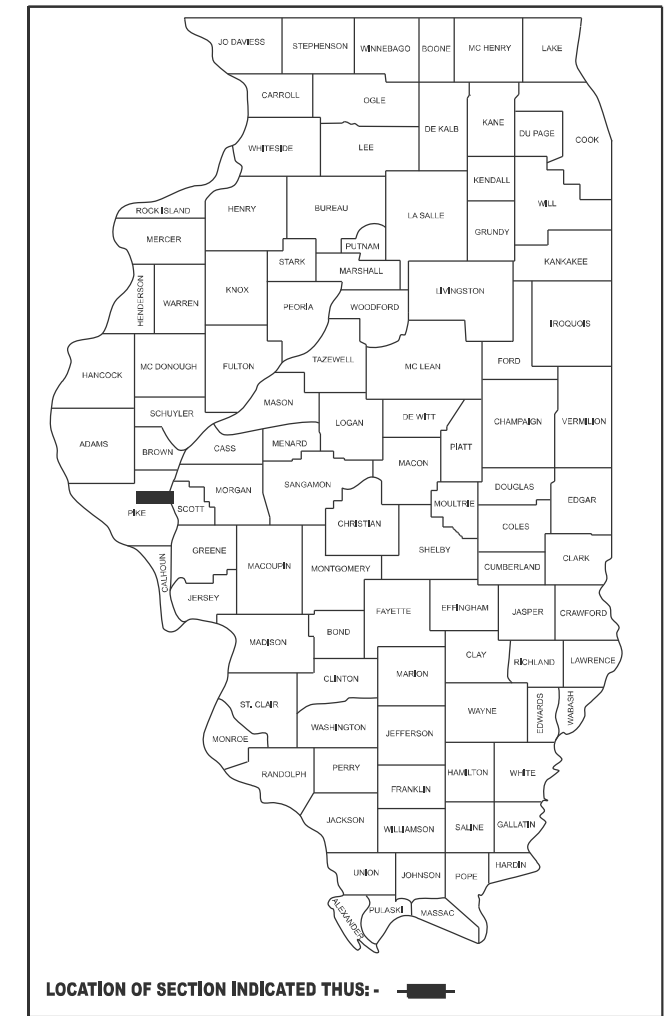

LOCATION OF SECTION INDICATED THUS: - [Black Box] -

INDEX OF SHEETS

- 1 COVER SHEET
- 2 GENERAL NOTES
- 3 SUMMARY OF QUANTITIES
- 4 SCHEDULES OF QUANTITIES
- 5 TYPICAL SECTIONS
- 6-19 I-72 PLAN SHEETS

PROPOSED HIGHWAY PLANS

**FAI ROUTE I-72
SECTION: (75-6) CJS
PROJECT NHPP-XK8Y(419)
JOINT SEALING
PIKE COUNTY**

C-96-077-23

ROADWAY DATA

FUNCTIONAL CLASS: INTERSTATE
ADT YR: 2023
ADT: 9,900
PV 65.40%
SU 3.28%
MU 31.31%

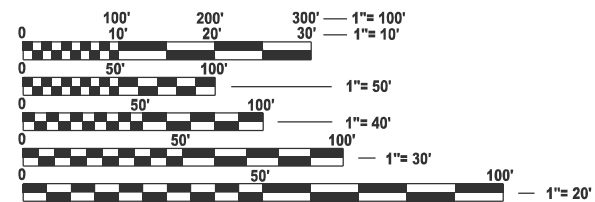

FULL SIZE PLANS HAVE BEEN PREPARED USING STANDARD ENGINEERING SCALES. REDUCED SIZED PLANS WILL NOT CONFORM TO STANDARD SCALES. IN MAKING MEASUREMENTS ON REDUCED PLANS, THE ABOVE SCALES MAY BE USED.

J.U.L.I.E.
JOINT UTILITY LOCATION INFORMATION FOR EXCAVATION
 1-800-892-0123
 OR 811

PROJECT ENGINEER: BRIAN LANINGHAM (217)782-6990
PROJECT MANAGER: FRANK CARABALLO (217)524-7690

CONTRACT NO. 72878

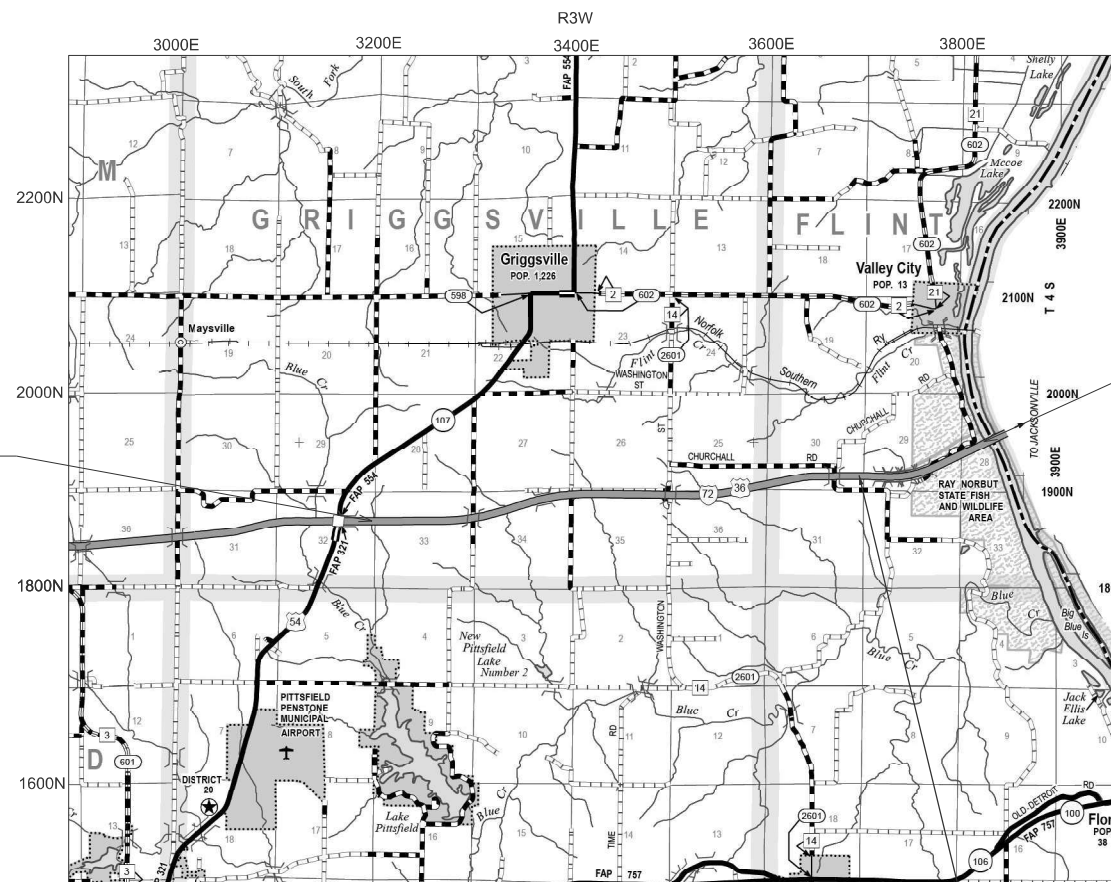

PROJECT BEGINS (I-72)
WB & EB: STA. 58+00.00

PROJECT ENDS (I-72)
WB: STA. 587+12.98
EB: STA. 85+56.00

GROSS LENGTH = 33,215.54 FT. = 6.29 MILE
 NET LENGTH = 32,263.21 FT. = 6.11 MILE

STATION EQUATION:
 STA 325+65.92 BK = WB STA 522+63.36 AH
 = EB STA 23+31.87 AH

STATE OF ILLINOIS
DEPARTMENT OF TRANSPORTATION

SUBMITTED October 10 20 24

[Signature]
REGIONAL ENGINEER

December 6, 2024

[Signature]
ENGINEER OF DESIGN AND ENVIRONMENT

December 6, 2024

[Signature]
DIRECTOR OF HIGHWAYS PROJECT IMPLEMENTATION 13

**PRINTED BY THE AUTHORITY
OF THE STATE OF ILLINOIS**

GENERAL NOTES

THE CONTRACTOR SHALL MAKE EVERY EFFORT TO AVOID DAMAGE OR COVERAGE OF EXISTING PAVEMENT MARKINGS WITH CRACK SEALANT. THE CONTRACTOR SHALL NOTIFY THE ENGINEER OF ANY ANTICIPATED PAVEMENT MARKING CONFLICTS AND ANY DAMAGE SHALL BE DOCUMENTED. EXCESS SEALANT SHOULD NOT BE SQUEEGED OUT OVER EXISTING PAVEMENT MARKINGS. THE ENGINEER SHALL CONTACT THE DISTRICT 6 TRAFFIC OPERATIONS ENGINEER AT (217)785-5306 IF MORE THAN 25% OF THE EXISTING PAVEMENT MARKING IS DAMAGED OR COVERED BY SEALANT.

HIGHWAY STANDARDS

000001-08 STANDARD SYMBOLS, ABBREVIATIONS AND PATTERNS
 001006 DECIMAL OF AN IN AND OF A FOOT
 701101-05 OFF ROAD OPERATIONS, MULTILANE, 15 FT TO 24" FROM THE PAVEMENT EDGE
 701106-02 OFF ROAD OPERATIONS, MULTILANE, MORE THAN 15 FT FROM THE PAVEMENT EDGE
 701426-09 LANE CLOSURE, MULTILANE, INTERMITTENT OR MOVING OPERATIONS FOR SPEEDS >= 45 MPH
 701901-10 TRAFFIC CONTROL DEVICES

APPLICATION RATES

LONGITUDINAL CRACK / JOINT FILLING 0.18 POUND / LIN. FT.

COMMITMENTS

NONE

JOINT /CRACK SEAL DETAIL

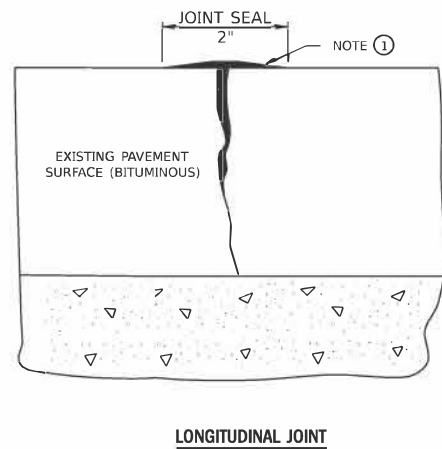

NOTES

- ① OVERFILL WITH SEALANT; SQUEEGE TO PROVIDE 2" WIDE FLUSH "BAND AID" EFFECT; FEATHER EDGES FLUSH.
- ② CRACK OR JOINT SEAL IN AREAS ADJACENT TO EXISTING PAVEMENT MARKINGS SHALL BE REDUCED OR ELIMINATED AS DIRECTED BY THE ENGINEER.

**STATE OF ILLINOIS
 DEPARTMENT OF TRANSPORTATION
 DIVISION OF HIGHWAYS
 DISTRICT 6**

EXAMINED September 24, 20 24

[Signature]
 ENGINEER OF OPERATIONS

EXAMINED September 30, 20 24

[Signature]
 ENGINEER OF PROJECT IMPLEMENTATION

EXAMINED October 3, 20 24

[Signature]
 ENGINEER OF PROGRAM DEVELOPMENT

MODEL: GEN NOTES [Sheet]
 FILE NAME: c:\pw\work\pwr\caraballo\092459\06 72878 General Notes.dgn

USER NAME = frank.caraballo	DESIGNED -	REVISED -
	DRAWN -	REVISED -
	CHECKED -	REVISED -
PLOT DATE = 10/9/2024	DATE -	REVISED -

**STATE OF ILLINOIS
 DEPARTMENT OF TRANSPORTATION**

GENERAL NOTES

SCALE: SHEET 2 OF 1 SHEETS STA. TO STA.

FAI RTE.	SECTION	COUNTY	TOTAL SHEETS	SHEET NO.
I-72	(75-6)CJS	PIKE	19	2
CONTRACT NO. 72878				
ILLINOIS FED. AID PROJECT				

6-01576-0000
NHPP FUNDING
90% FEDERAL,
10% STATE

CODE NO.	ITEM	UNIT	TOTAL QUANTITY	ROADWAY
				0005
				INTERSTATE
45100200	CRACK FILLING	POUND	34548	34548
67100100	MOBILIZATION	LSUM	1	1
70107025	CHANGEABLE MESSAGE SIGN	CAL DA	44	44
X7010216	TRAFFIC CONTROL AND PROTECTION, (SPECIAL)	LSUM	1	1

MODEL: SOQ (Sheet)
FILE NAME: c:\p\work\pww\roher\m\0832459\06 72878 SOQ Sheet.dgn

USER NAME = Tina.Roher	DESIGNED -	REVISED -
	DRAWN -	REVISED -
	CHECKED -	REVISED -
PLOT DATE = 10/9/2024	DATE -	REVISED -

STATE OF ILLINOIS
DEPARTMENT OF TRANSPORTATION

SUMMARY OF QUANTITIES

SCALE: SHEET 1 OF 1 SHEETS STA. TO STA.

F.A.I RTE.	SECTION	COUNTY	TOTAL SHEETS	SHEET NO.
I-72	(75-6)CJS	PIKE	19	3
CONTRACT NO. 72878			ILLINOIS FED. AID PROJECT	

LONGITUDINAL CRACK FILLING SCHEDULE						
1	2	3 = 2 - 1	4	5 = 3 - 4	6	7 = 5 * 6 * (0.18 lb/ft)
START STATION	END STATION	GROSS LENGTH	OMISSIONS	NET LENGTH	NO. OF JOINTS	45100200 CRACK FILLING POUND
WESTBOUND I-72						
58+00.00	325+65.92	26,765.92		26,765.92	3	14,453.60
<i>STATION EQUATION: 325+65.92 BK = 522+63.36 AH</i>						
522+63.36	543+67.56	2,104.20		2,104.20	3	1,136.27
543+67.56	547+11.00	343.44	343.44	0.00		
547+11.00	558+58.23	1,147.23		1,147.23	3	619.50
558+58.23	562+02.93	344.70	344.70	0.00		
562+02.93	577+76.75	1,573.82		1,573.82	3	849.86
577+62.00	580+18.00	256.00	256.00	0.00		
580+40.94	587+12.98	672.04		672.04	3	362.90
<i>WB I-72 SUB-TOTAL =</i>						17,422.13
EASTBOUND I-72						
58+00.00	325+65.92	26,765.92		26,765.92	3	14,453.60
<i>STATION EQUATION: 325+65.92 BK = 23+31.87 AH</i>						
23+31.87	47+16.74	2,384.87		2,384.87	3	1,287.83
47+16.74	50+06.92	290.18	290.18	0.00		
50+06.92	58+57.34	850.42		850.42	3	459.23
58+57.34	62+91.03	433.69	433.69	0.00		
62+91.03	68+47.86	556.83		556.83	3	300.69
68+42.00	74+00.00	558.00	558.00	0.00		
74+00.00	85+56.00	1,156.00		1,156.00	3	624.24
<i>EB I-72 SUB-TOTAL =</i>						17,125.58
TOTAL =						34,547.72

MODEL: Schedules (Sheet)
 FILE NAME: c:\p\work\frank\caraballo\0832459\06 72878 Schedules Sheet.dgn

USER NAME = frank.caraballo	DESIGNED -	REVISED -	STATE OF ILLINOIS DEPARTMENT OF TRANSPORTATION	SCHEDULE OF QUANTITIES			F.A.I RTE.	SECTION	COUNTY	TOTAL SHEETS	SHEET NO.
PLOT SCALE = \$SCALE\$	DRAWN -	REVISED -					I-72	(75-6)CJS	PIKE	19	4
PLOT DATE = 9/11/2024	CHECKED -	REVISED -		SCALE: SHEET OF 1 SHEETS STA. TO STA.			CONTRACT NO. 72878				
	DATE -	REVISED -					ILLINOIS FED. AID PROJECT				

I-72

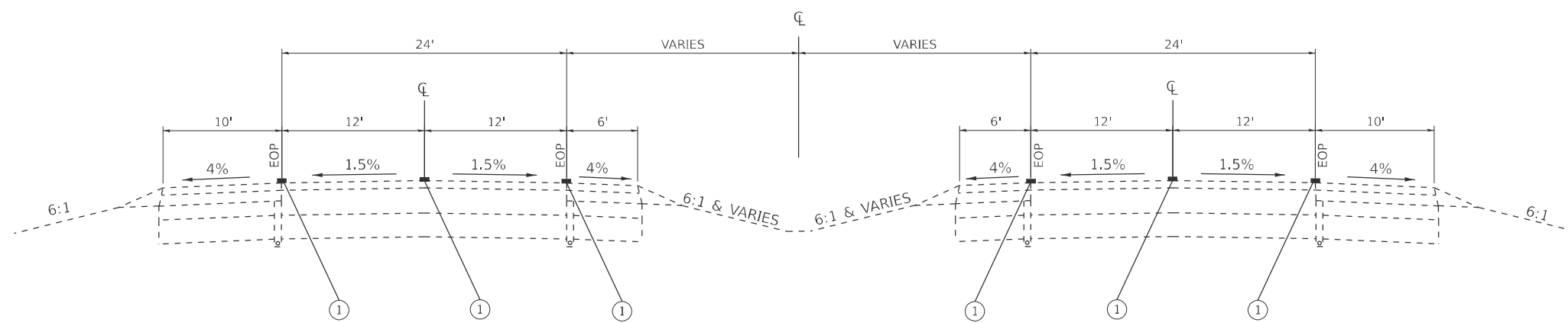

WESTBOUND I-72 TYPICAL TANGENT SECTION

STA 58+00.00 TO 325+65.92
 STATION EQUATION: 325+62.92 BK = 522+63.36 AH
 STA 522+63.36 TO STA 587+12.98

EASTBOUND I-72 TYPICAL TANGENT SECTION

STA 58+00.00 TO 325+65.92
 STATION EQUATION: 325+62.92 BK = 23+31.87 AH
 STA 23+31.87 TO STA 85+56.00

LEGEND

- 1. PROPOSED CRACK FILLING, 2" BEAD

MODEL: TYPICALS (Sheet)
 FILE NAME: c:\p\work\wrt\roher\m\082459\06 72878 Typical Section Sheet.dgn

USER NAME = Tina.Roher	DESIGNED -	REVISED -
	DRAWN -	REVISED -
	CHECKED -	REVISED -
PLOT DATE = 10/8/2024	DATE -	REVISED -

STATE OF ILLINOIS
 DEPARTMENT OF TRANSPORTATION

TYPICAL SECTIONS

SCALE: SHEET 1 OF 1 SHEETS STA. TO STA.

F.A.I RTE.	SECTION	COUNTY	TOTAL SHEETS	SHEET NO.
I-72	(75-6)CJS	PIKE	19	5
CONTRACT NO. 72878				
ILLINOIS FED. AID PROJECT				

BEGIN PROJECT
STA 58+00.00

257 | 58 | 59 | 60+00 | 61 | 62 | 63 | 64 | 65+00 | 66 | 67 | 68 | 69 | 70+00 | 71

PR JOINT FILLING
EOP's & CENTERLINE

PR JOINT FILLING
EOP's & CENTERLINE



MATCHLINE STA. 72+00.00

MATCHLINE STA. 72+00.00

72 | 73 | 74 | 75+00 | 76 | 77 | 78 | 79 | 80+00 | 81 | 82 | 83 | 84 | 85+00 | 86

PR JOINT FILLING
EOP's & CENTERLINE

PR JOINT FILLING
EOP's & CENTERLINE



MATCHLINE STA. 87+00.00

MODEL: EXCL6 - Plans Double (Sheet)
FILE NAME: c:\p\work\pwr\caraballo\0832459\06 72878 Plan Sheet.dgn

USER NAME = frank.caraballo	DESIGNED -	REVISED -
	DRAWN -	REVISED -
	CHECKED -	REVISED -
PLOT DATE = 9/11/2024	DATE -	REVISED -

**STATE OF ILLINOIS
DEPARTMENT OF TRANSPORTATION**

I-72 PLANS

SCALE: 1"=50' SHEET 6 OF 14 SHEETS STA. 257+00.00 TO STA. 87+00.00 R3

F.A.I RTE.	SECTION	COUNTY	TOTAL SHEETS	SHEET NO.
I-72	(75-6)CJS	PIKE	19	6
CONTRACT NO. 72878				
ILLINOIS FED. AID PROJECT				

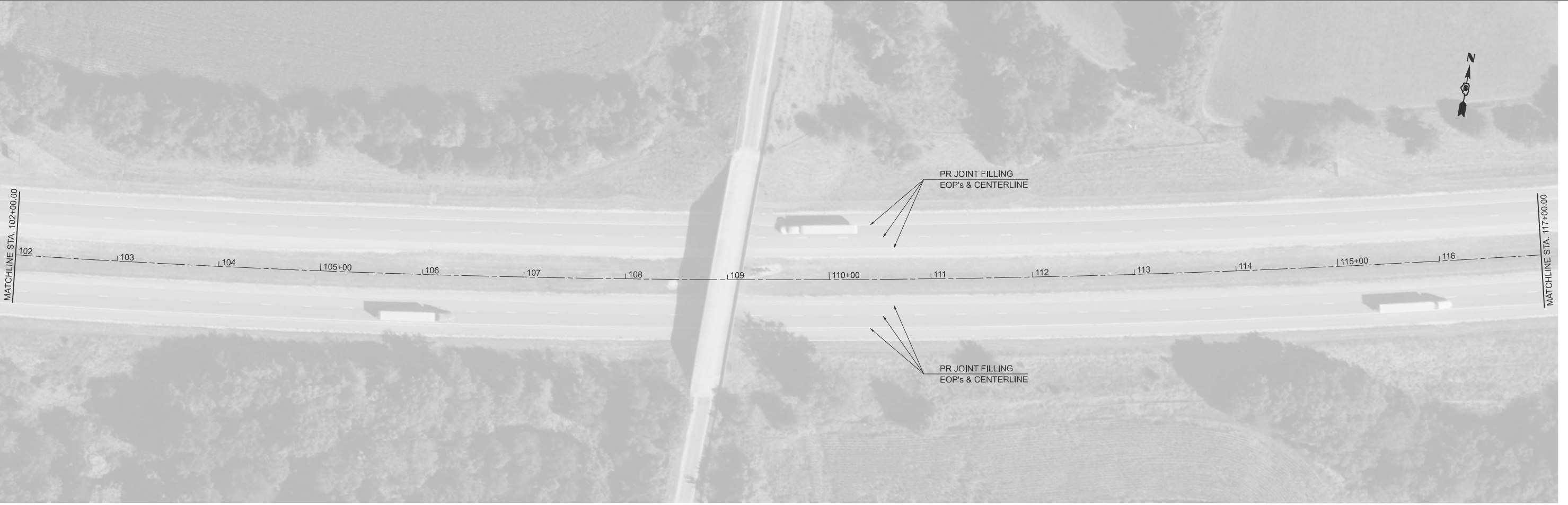

MODEL: EXCL6 - Plans Double-2 [Sheet]
 FILE NAME: c:\p\work\pwr\dot\caraballo\040832459\06 72878 Plan Sheet.dgn

USER NAME = frank.caraballo	DESIGNED -	REVISED -
	DRAWN -	REVISED -
	CHECKED -	REVISED -
PLOT DATE = 9/11/2024	DATE -	REVISED -

**STATE OF ILLINOIS
 DEPARTMENT OF TRANSPORTATION**

I-72 PLANS

SCALE: 1"=50' SHEET 7 OF 14 SHEETS STA. 87+00.00 R3 TO STA. 117+00.00 R3

F.A.I RTE.	SECTION	COUNTY	TOTAL SHEETS	SHEET NO.
I-72	(75-6)CJS	PIKE	19	7
CONTRACT NO. 72878				
ILLINOIS FED. AID PROJECT				

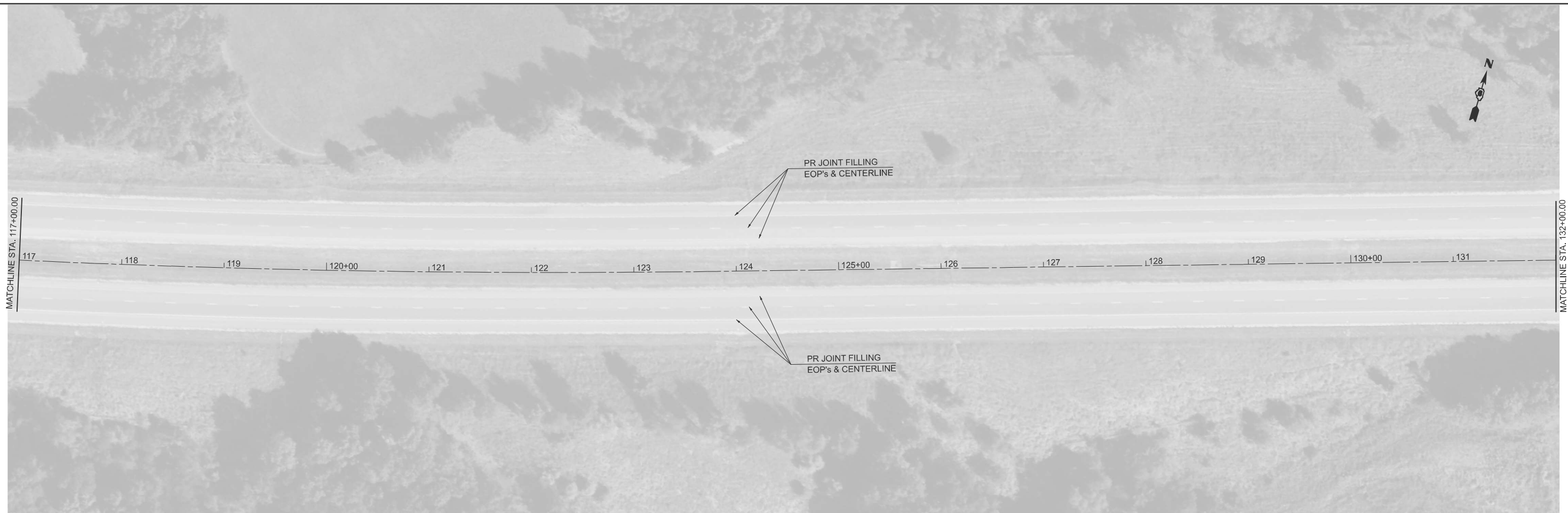

MODEL: EXCL6 - Plans Double4 [Sheet]
 FILE NAME: c:\p\work\pwr\caraballo\00832459\06 72878 Plan Sheet.dgn

USER NAME = frank.caraballo	DESIGNED -	REVISED -
	DRAWN -	REVISED -
	CHECKED -	REVISED -
PLOT DATE = 9/11/2024	DATE -	REVISED -

**STATE OF ILLINOIS
 DEPARTMENT OF TRANSPORTATION**

I-72 PLANS

SCALE: 1"=50' SHEET 8 OF 14 SHEETS STA. 117+00.00 R3 TO STA. 147+00.00 R3

F.A.I RTE.	SECTION	COUNTY	TOTAL SHEETS	SHEET NO.
I-72	(75-6)CJS	PIKE	19	8
CONTRACT NO. 72878				
ILLINOIS FED. AID PROJECT				

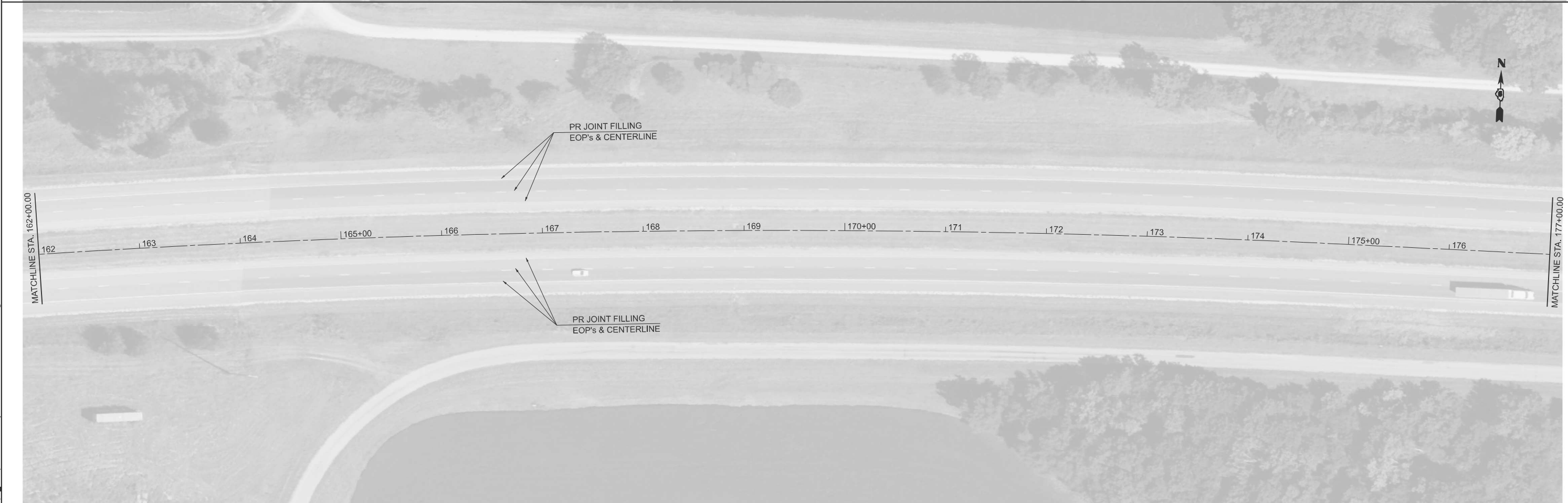

MODEL: EXCL6 - Plans Double6 [Sheet]
 FILE NAME: c:\p\work\pwr\caraballo\0832459\06 72878 Plan Sheet.dgn

USER NAME = frank.caraballo	DESIGNED -	REVISED -
	DRAWN -	REVISED -
	CHECKED -	REVISED -
PLOT DATE = 9/11/2024	DATE -	REVISED -

STATE OF ILLINOIS
DEPARTMENT OF TRANSPORTATION

I-72 PLANS

SCALE: 1"=50' SHEET 9 OF 14 SHEETS STA. 147+00.00 R3 TO STA. 177+00.00 R3

F.A.I. RTE.	SECTION	COUNTY	TOTAL SHEETS	SHEET NO.
I-72	(75-6)CJS	PIKE	19	9
CONTRACT NO. 72878				
ILLINOIS FED. AID PROJECT				

MODEL: EXCL6 - Plans Double-8 [Sheet]
 FILE NAME: c:\p\work\pwr\caraballo\00032459\06 72878 Plan Sheet.dgn

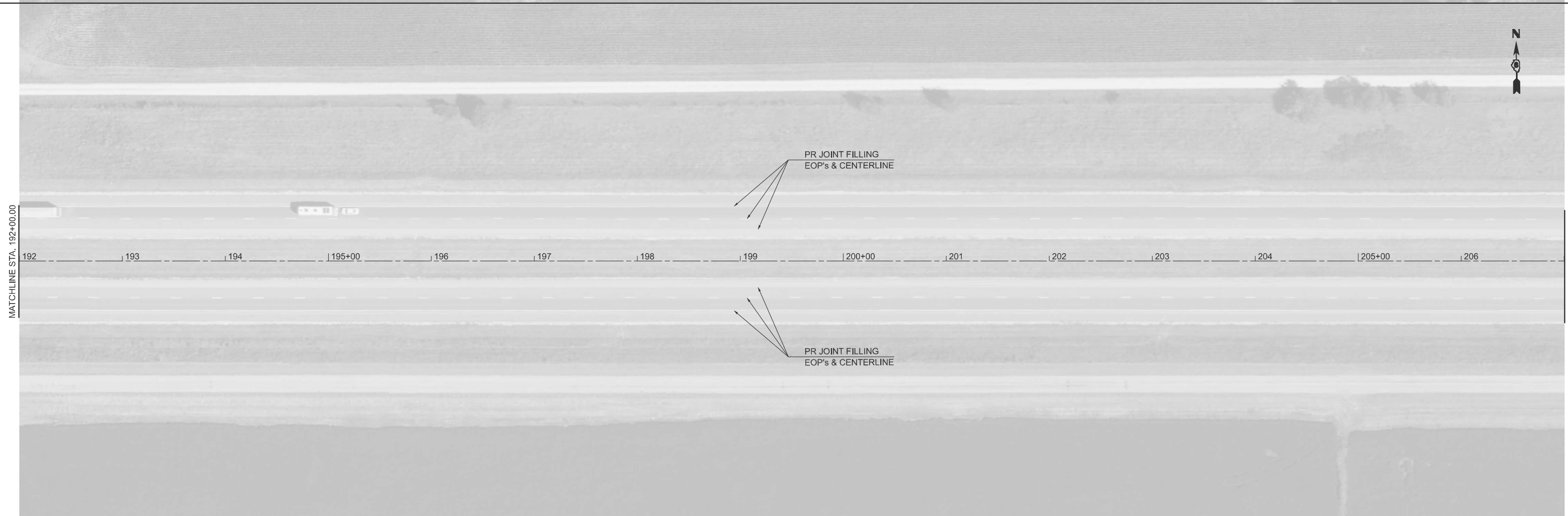
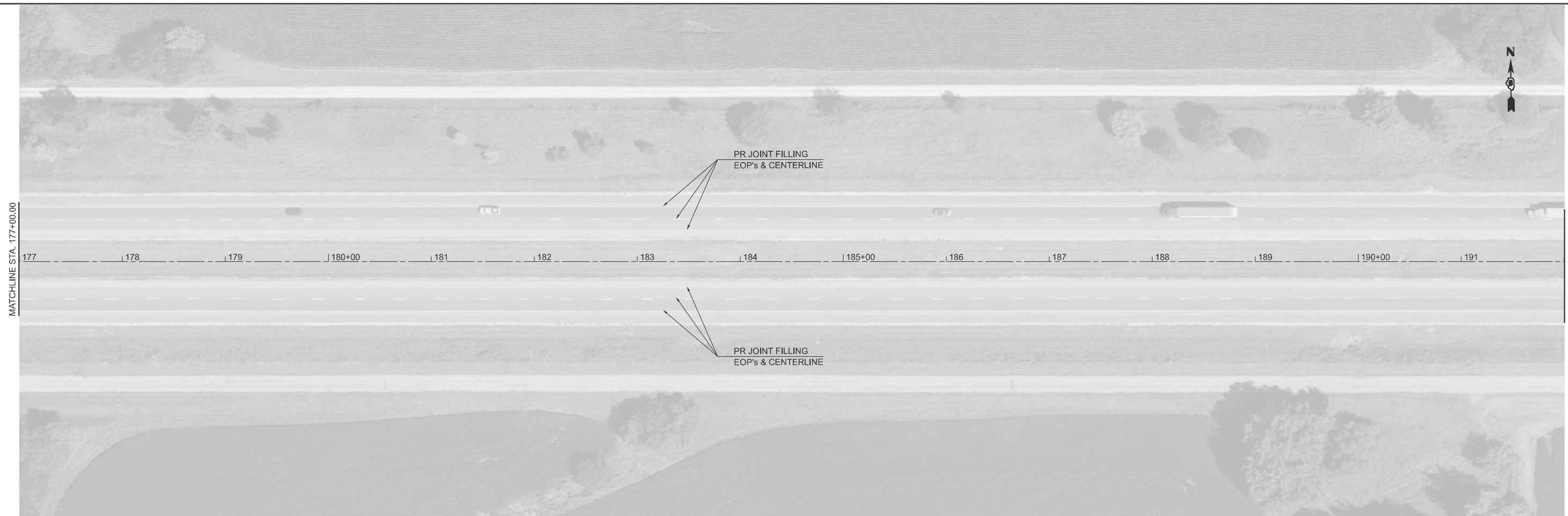

USER NAME = frank.caraballo	DESIGNED -	REVISED -
	DRAWN -	REVISED -
	CHECKED -	REVISED -
PLOT DATE = 9/11/2024	DATE -	REVISED -

**STATE OF ILLINOIS
 DEPARTMENT OF TRANSPORTATION**

I-72 PLANS

SCALE: 1"=50' SHEET 10 OF 14 SHEETS STA. 177+00.00 R3 TO STA. 207+00.00 R3

F.A.I RTE.	SECTION	COUNTY	TOTAL SHEETS	SHEET NO.
I-72	(75-6)CJS	PIKE	19	10
CONTRACT NO. 72878				
ILLINOIS FED. AID PROJECT				

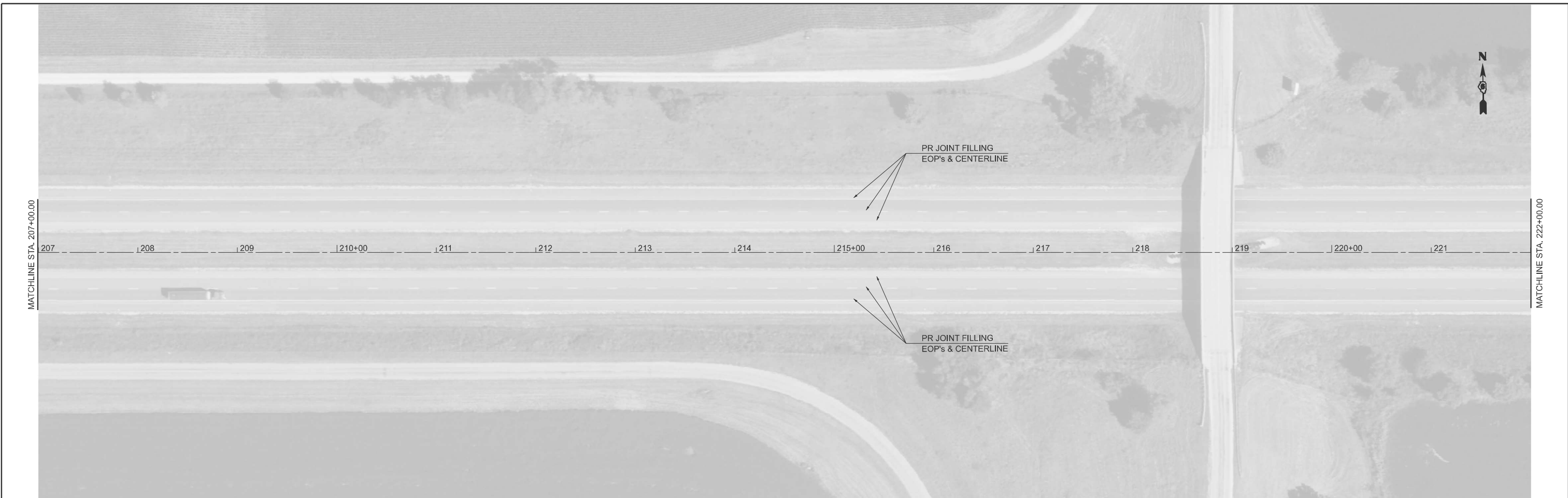

MODEL: EXCL6 - Plans Double-10 (Sheet)
 FILE NAME: c:\p\work\pwr\caraballo\0832459\06 72878 Plan Sheet.dgn

USER NAME = frank.caraballo	DESIGNED -	REVISED -
	DRAWN -	REVISED -
	CHECKED -	REVISED -
PLOT DATE = 9/11/2024	DATE -	REVISED -

**STATE OF ILLINOIS
 DEPARTMENT OF TRANSPORTATION**

I-72 PLANS

SCALE: 1"=50' SHEET 11 OF 14 SHEETS STA. 207+00.00 R3 TO STA. 237+00.00 R3

F.A.I RTE.	SECTION	COUNTY	TOTAL SHEETS	SHEET NO.
I-72	(75-6)CJS	PIKE	19	11
CONTRACT NO. 72878				
ILLINOIS FED. AID PROJECT				

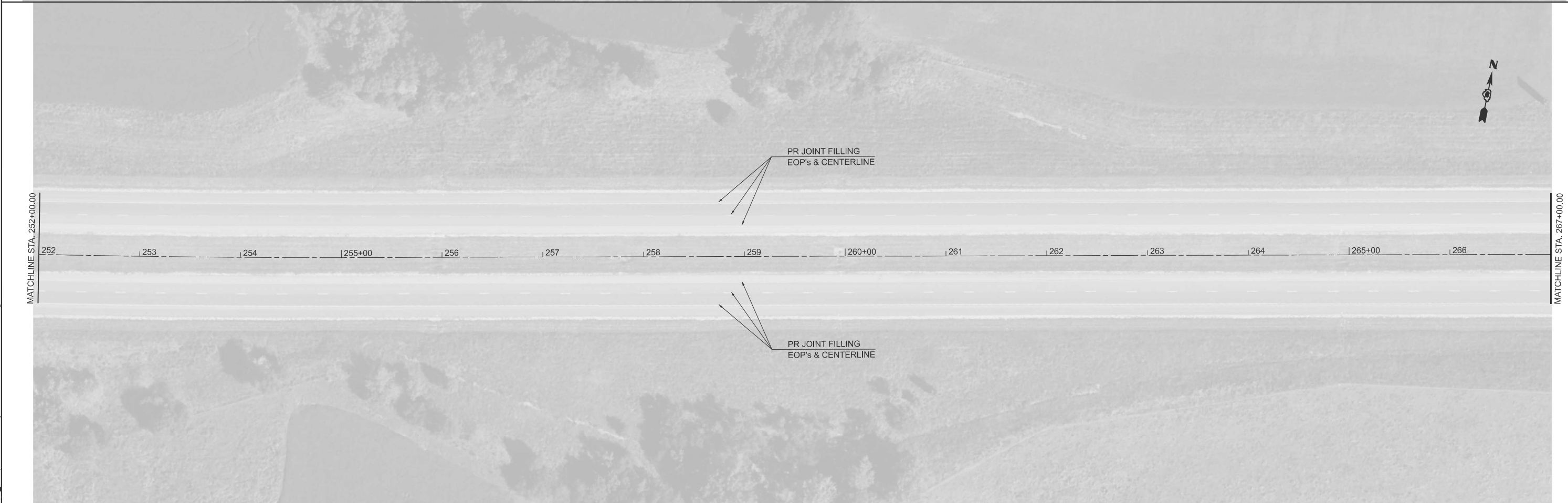

MODEL: EXCL6 - Plans Double+12 (Sheet)
 FILE NAME: c:\p\work\pwr\caraballo\0832459\06 72878 Plan Sheet.dgn

USER NAME = frank.caraballo	DESIGNED -	REVISED -
	DRAWN -	REVISED -
	CHECKED -	REVISED -
PLOT DATE = 9/11/2024	DATE -	REVISED -

**STATE OF ILLINOIS
DEPARTMENT OF TRANSPORTATION**

I-72 PLANS			
SCALE: 1"=50'	SHEET 12	OF 14 SHEETS	STA. 237+00.00 R3 TO STA. 267+00.00 R3

F.A.I RTE.	SECTION	COUNTY	TOTAL SHEETS	SHEET NO.
I-72	(75-6)CJS	PIKE	19	12
CONTRACT NO. 72878				
ILLINOIS FED. AID PROJECT				

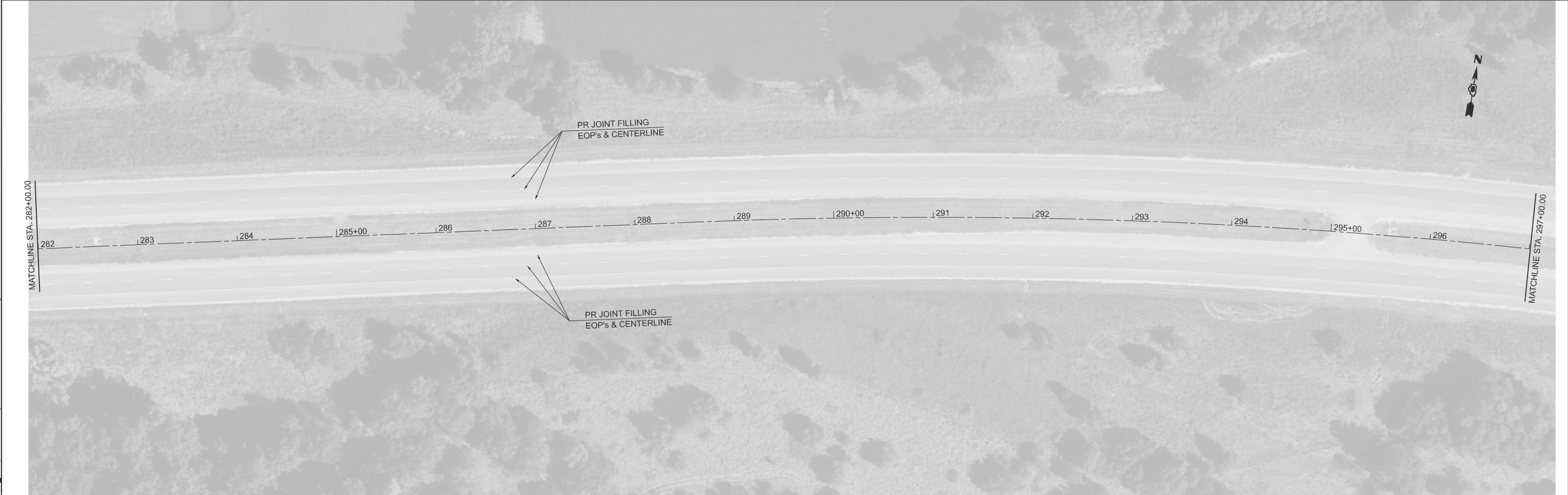

MODEL: EXCL6 - Plans Double-14 (Sheet)
 FILE NAME: c:\p\work\pwr\caraballo\0832459\06 72878 Plan Sheet.dgn

USER NAME = frank.caraballo	DESIGNED -	REVISED -
	DRAWN -	REVISED -
	CHECKED -	REVISED -
PLOT DATE = 9/11/2024	DATE -	REVISED -

**STATE OF ILLINOIS
 DEPARTMENT OF TRANSPORTATION**

I-72 PLANS

SCALE: 1"=50' SHEET 13 OF 14 SHEETS STA. 267+00.00 R3 TO STA. 297+00.00 R3

F.A.I RTE.	SECTION	COUNTY	TOTAL SHEETS	SHEET NO.
I-72	(75-6)CJS	PIKE	19	13
CONTRACT NO. 72878				
ILLINOIS FED. AID PROJECT				



MODEL: EXCL6 - Plans Double-16 (Sheet)
 FILE NAME: c:\p\work\pwr\caraballo\0832459\06 72878 Plan Sheet.dgn

USER NAME = frank.caraballo	DESIGNED -	REVISED -
	DRAWN -	REVISED -
	CHECKED -	REVISED -
PLOT DATE = 9/11/2024	DATE -	REVISED -

**STATE OF ILLINOIS
 DEPARTMENT OF TRANSPORTATION**

I-72 PLANS

SCALE: 1"=50' SHEET 14 OF 14 SHEETS STA. 297+00.00 R3 TO STA. 327+00.00 R3

F.A.I RTE.	SECTION	COUNTY	TOTAL SHEETS	SHEET NO.
I-72	(75-6)CJS	PIKE	19	14
CONTRACT NO. 72878				
ILLINOIS FED. AID PROJECT				

MODEL: EXCL6 - Plans Single (Sheet)
 FILE NAME: c:\p\work\caraballo\0832459\06 72878 Plan Sheet.dgn



STATION EQUATION
 STA 325+65.92 BK =
 STA 522+63.36 AH

STATION EQUATION
 STA 325+65.92 BK =
 STA 23+31.87 AH

WB MATCHLINE STA. 522+63.36
 EB MATCHLINE STA. 23+31.87

MATCHLINE STA. 537+63.00

MATCHLINE STA. 38+62.00

USER NAME = frank.caraballo	DESIGNED -	REVISED -
	DRAWN -	REVISED -
	CHECKED -	REVISED -
PLOT DATE = 9/11/2024	DATE -	REVISED -

**STATE OF ILLINOIS
 DEPARTMENT OF TRANSPORTATION**

I-72 PLANS

SCALE: 1"=50' SHEET 15 OF 14 SHEETS STA. 522+63.36 TO STA. 537+63.36

F.A.I RTE.	SECTION	COUNTY	TOTAL SHEETS	SHEET NO.
I-72	(75-6)CJS	PIKE	19	15
CONTRACT NO. 72878				
ILLINOIS FED. AID PROJECT				

EX CURVE
 PI STA = 545+64.56
 $\Delta = 33^{\circ}24'37''$ (LT)
 $D = 00^{\circ}45'00''$
 $R = 7,639.44'$
 $T = 2,292.69'$
 $L = 4454.71'$
 $E = 336.62'$
 $e =$
 PC STA = 522+71.87
 PT STA = 567+26.58

PR JOINT FILLING
 EOP's & CENTERLINE



EX CURVE
 PI STA = 51+33.45
 $\Delta = 25^{\circ}42'52''$ (LT)
 $D = 01^{\circ}00'00''$
 $R = 5,729.59'$
 $T = 1,307.75'$
 $L = 2571.45'$
 $E = 147.35'$
 $e =$
 PC STA = 38+25.70
 PT STA = 63+97.15

PR JOINT FILLING
 EOP's & CENTERLINE

BRIDGE OMISSION

BRIDGE OMISSION

MODEL: EXCL6 - Plans Single-1 [Sheet]
 FILE NAME: c:\p\work\caraballo\0832459\06 72878 Plan Sheet.dgn

USER NAME = frank.caraballo	DESIGNED -	REVISED -
	DRAWN -	REVISED -
	CHECKED -	REVISED -
PLOT DATE = 9/11/2024	DATE -	REVISED -

STATE OF ILLINOIS
 DEPARTMENT OF TRANSPORTATION

I-72 PLANS

SCALE: 1"=50' SHEET 16 OF 14 SHEETS STA. 537+63.36 TO STA. 552+63.36

F.A.I RTE.	SECTION	COUNTY	TOTAL SHEETS	SHEET NO.
I-72	(75-6)CJS	PIKE	19	16
CONTRACT NO. 72878				
ILLINOIS FED. AID PROJECT				

MODEL: EXCL6 - Plans Single-2 (Sheet)
 FILE NAME: c:\p\work\caraballo\00032459\06 72878 Plan Sheet.dgn

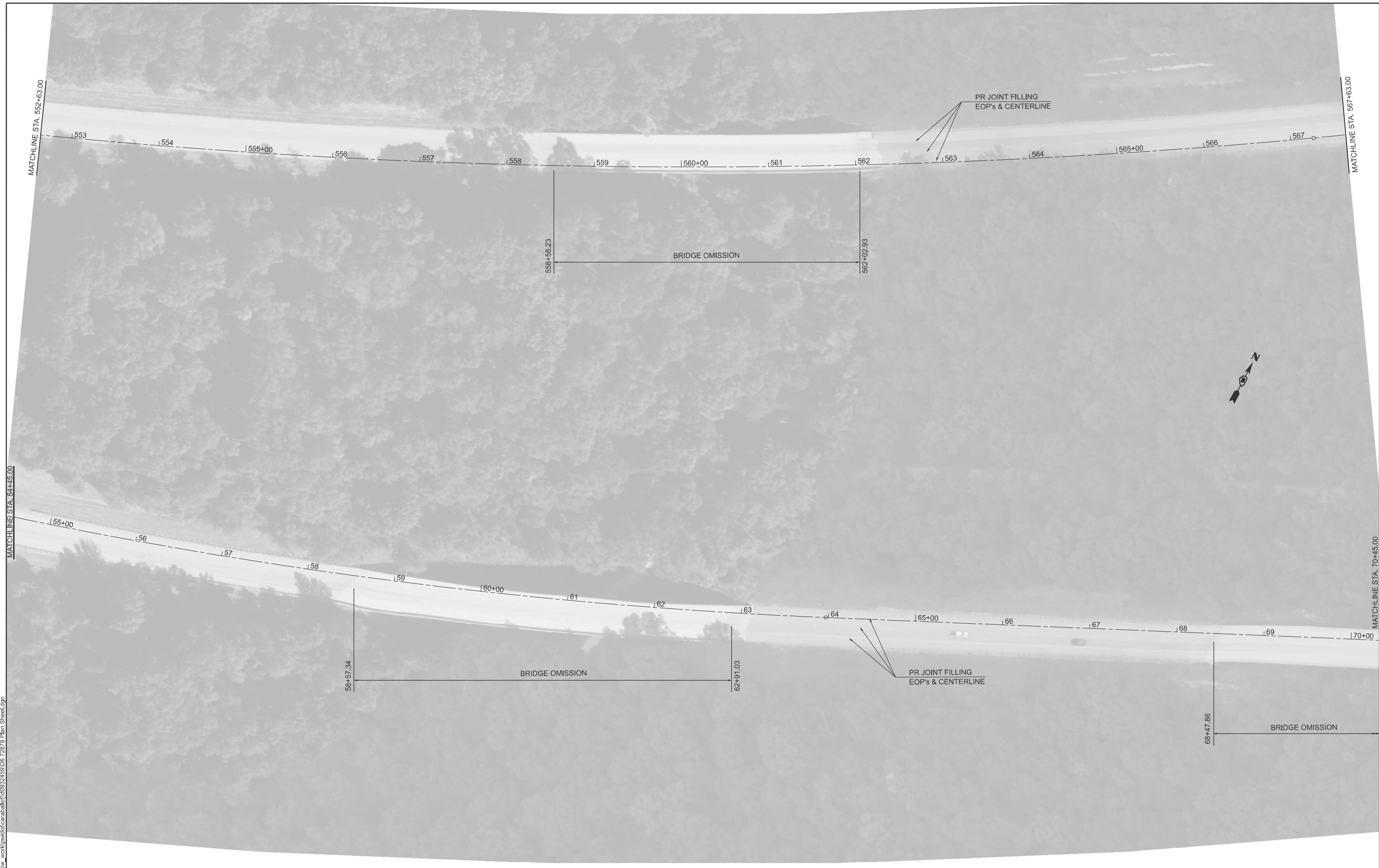

USER NAME = frank.caraballo	DESIGNED -	REVISED -
	DRAWN -	REVISED -
	CHECKED -	REVISED -
PLOT DATE = 9/12/2024	DATE -	REVISED -

**STATE OF ILLINOIS
 DEPARTMENT OF TRANSPORTATION**

I-72 PLANS			
SCALE: 1"=50'	SHEET 17	OF 14 SHEETS	STA. 552+63.34 TO STA. 567+63.34

F.A.I RTE.	SECTION	COUNTY	TOTAL SHEETS	SHEET NO.
I-72	(75-6)CJS	PIKE	19	17
CONTRACT NO. 72878				
ILLINOIS FED. AID PROJECT				

MODEL: EXCL6 - Plans_Single-3 [Sheet]
 FILE NAME: c:\p\work\caraballo\0832459\06 72878 Plan_Sheet.dgn



USER NAME = frank.caraballo	DESIGNED -	REVISED -
	DRAWN -	REVISED -
	CHECKED -	REVISED -
PLOT DATE = 9/12/2024	DATE -	REVISED -

**STATE OF ILLINOIS
 DEPARTMENT OF TRANSPORTATION**

I-72 PLANS			
SCALE: 1"=50'	SHEET 18	OF 14 SHEETS	STA. 567+63.34 TO STA. 582+63.34

F.A.I RTE.	SECTION	COUNTY	TOTAL SHEETS	SHEET NO.
I-72	(75-6)CJS	PIKE	19	18
CONTRACT NO. 72878				
ILLINOIS FED. AID PROJECT				

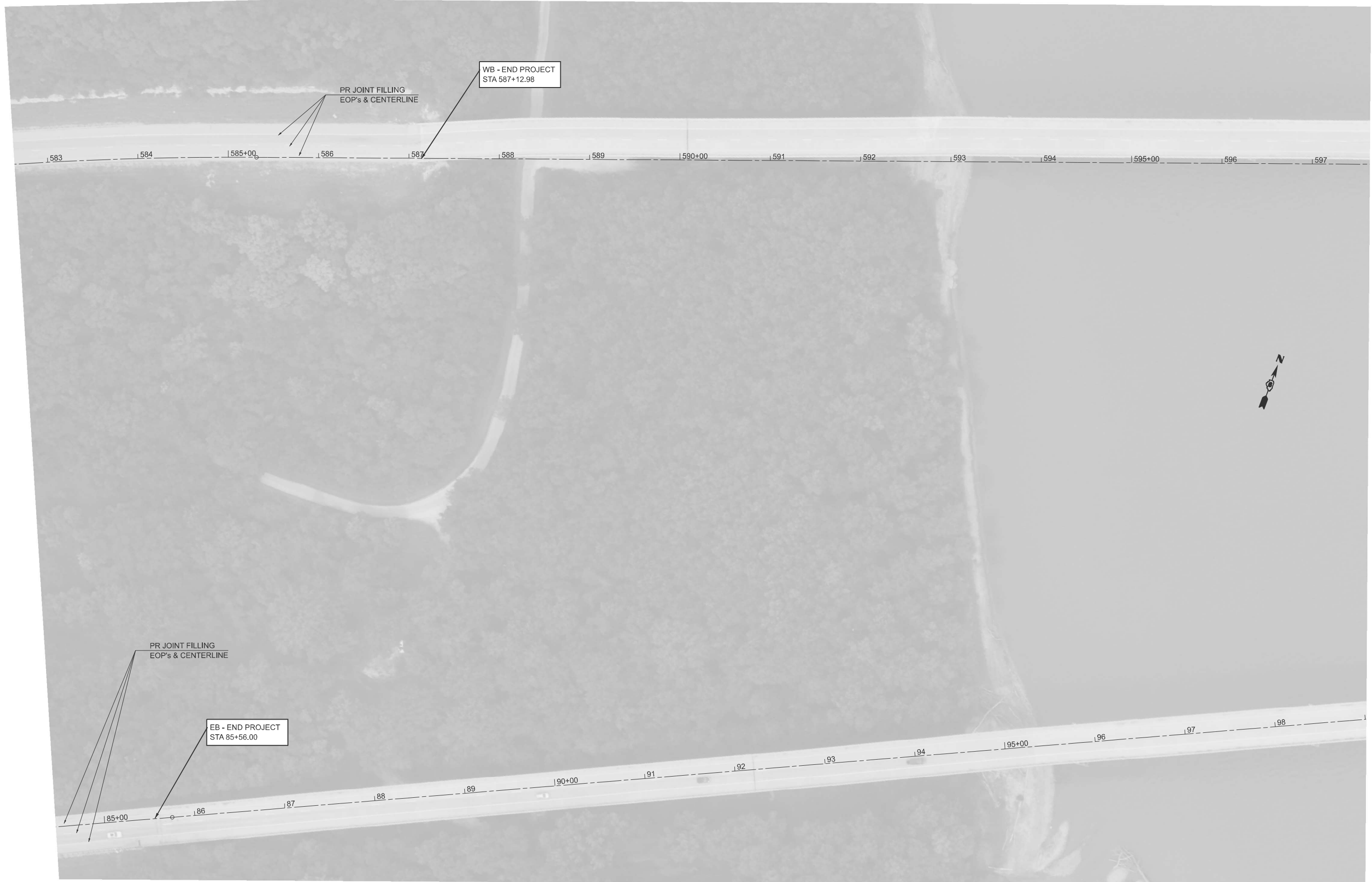

MODEL: EXCL6 - Plans Single-4 (Sheet)
 FILE NAME: c:\p\work\caraballo\0032459\06 72878 Plan Sheet.dgn

USER NAME = frank.caraballo	DESIGNED -	REVISED -
	DRAWN -	REVISED -
	CHECKED -	REVISED -
PLOT DATE = 9/11/2024	DATE -	REVISED -

STATE OF ILLINOIS
DEPARTMENT OF TRANSPORTATION

I-72 PLANS			
SCALE: 1"=50'	SHEET 19	OF 14 SHEETS	STA. 582+63.34 TO STA. 597+63.34

F.A.I RTE. I-72	SECTION (75-6)CJS	COUNTY PIKE	TOTAL SHEETS 19	SHEET NO. 19
CONTRACT NO. 72878				
ILLINOIS FED. AID PROJECT				