

F.A.U. RTE.	SECTION	COUNTY	TOTAL SHEETS	SHEET NO.
379	(118 & 119)MRK	KENDALL	19	1
		ILLINOIS	CONTRACT NO. 66P60	

INDEX OF SHEETS

- 1 COVER SHEET
- 2 GENERAL NOTES
- 3-5 SUMMARY OF QUANTITIES
- 6 8 TYPICAL SECTIONS
- 9-13 SCHEDULES
- 14 PROJECT MAP
- 13-19 DETAILS

HIGHWAY STANDARDS

- 000001-08 STANDARD SYMBOLS, ABBREVIATIONS AND PATTERNS
- 001006 DECIMAL OF AN INCH AND OF A FOOT
- 406201-01 MAILBOX TURNOUT
- 667101-02 PERMANENT SURVEY MARKERS
- 701001-02 OFF-ROAD OPERATIONS 2L, 2W, MORE THAN 15' AWAY
- 701006-05 OFF-ROAD OPERATIONS 2L, 2W, 15' TO 24" FROM PAVEMENT EDGE
- 701011-04 OFF-ROAD MOVING OPERATIONS 2L, 2W, DAY ONLY
- 701201-05 LANE CLOSURE, 2L, 2W, DAY ONLY, FOR SPEEDS ≥ 45 MPH
- 701306-04 LANE CLOSURE, 2L, 2W, SLOW MOVING OPERATIONS DAY ONLY, FOR SPEEDS ≥ 45 MPH
- 701311-03 LANE CLOSURE, 2L, 2W, MOVING OPERATIONS - DAY ONLY
- 701901-10 TRAFFIC CONTROL DEVICES
- 780001-05 TYPICAL PAVEMENT MARKINGS
- 781001-04 TYPICAL APPLICATIONS RAISED REFLECTIVE PAVEMENT MARKERS

**PROPOSED
HIGHWAY PLANS**

**FAU ROUTE 379 (IL 126)
SECTION (118&119)MRK,RS
PROJECT
CENTERLINE MILLING & RESURFACING
& INTERMEDIATE RESURFACING
KENDALL COUNTY**

C-93-115-24

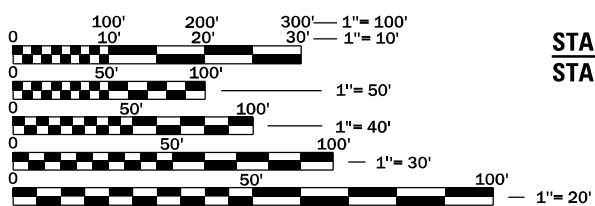
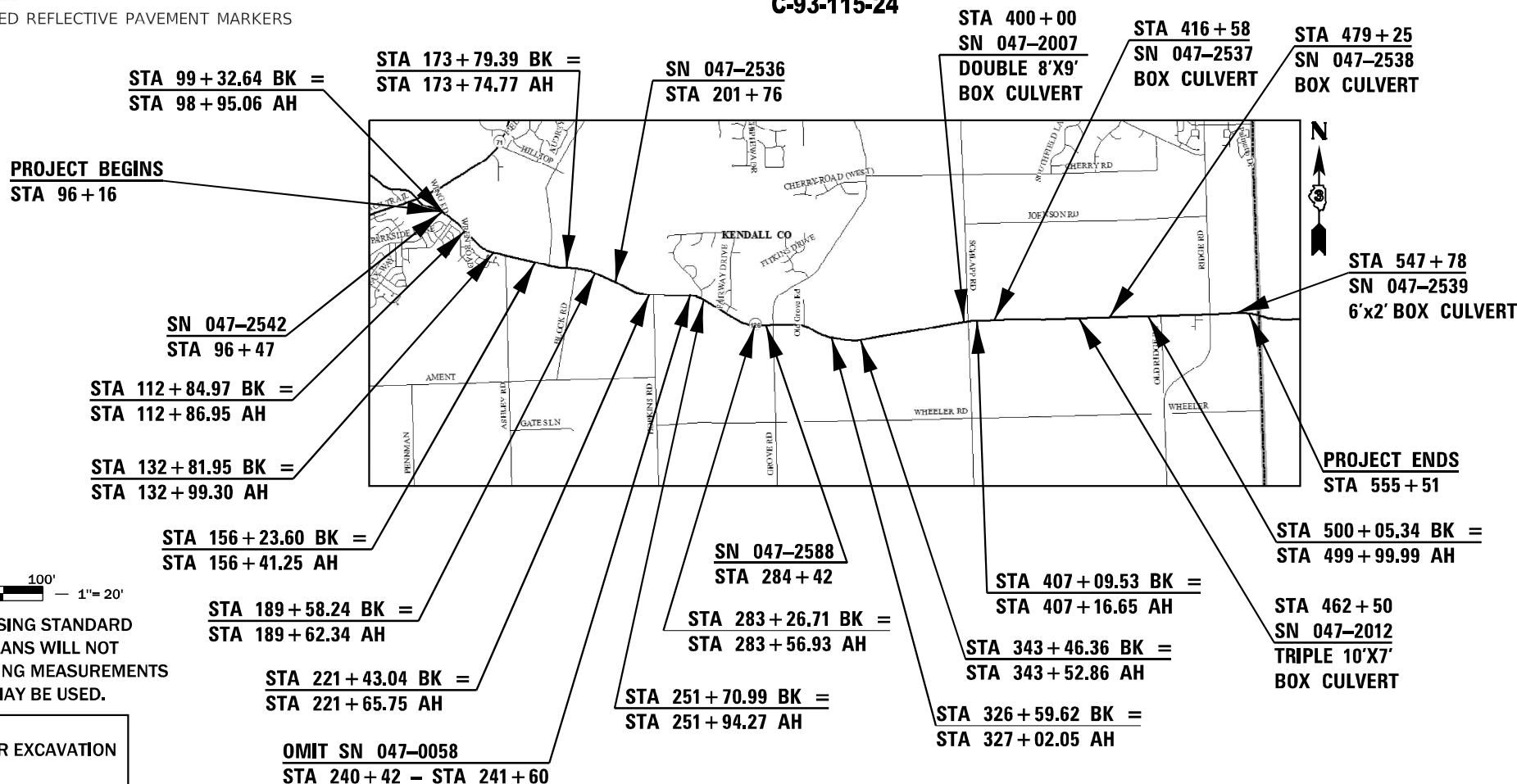
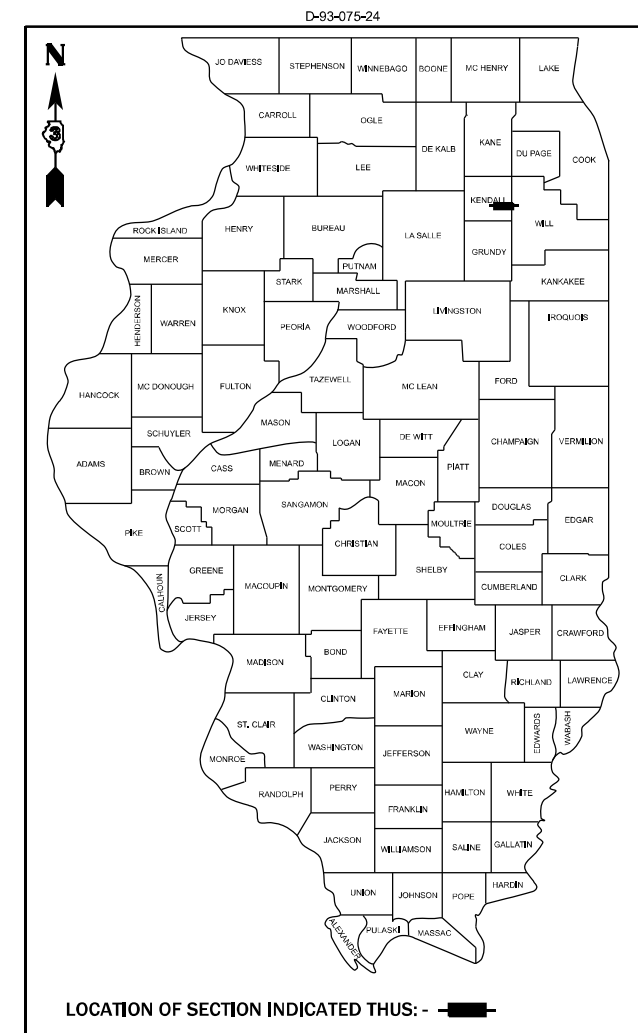

FULL SIZE PLANS HAVE BEEN PREPARED USING STANDARD ENGINEERING SCALES. REDUCED SIZED PLANS WILL NOT CONFORM TO STANDARD SCALES. IN MAKING MEASUREMENTS ON REDUCED PLANS, THE ABOVE SCALES MAY BE USED.

J.U.L.I.E.
JOINT UTILITY LOCATION INFORMATION FOR EXCAVATION
1-800-892-0123
OR 811

PROJECT ENGINEER: NICHOLAS SPENCE, P.E.
UNIT CHIEF: BRANDON CRISS
DISTRICT 3 NO. (815) 434-6131
CONTRACT NO. 66P60

GROSS LENGTH = 45,810 FT. = 8.68 MILES
NET LENGTH = 36,841 FT. = 6.98 MILES

IL 126 - MINOR ARTERIAL
2023 ADT = 7800
P.V. = 92.0% S.U. = 3.5% M.U. = 4.5%

STATE OF ILLINOIS
DEPARTMENT OF TRANSPORTATION

SUBMITTED November 1, 2024

Trisha Thompson
REGIONAL ENGINEER

December 6, 2024

Scott A. Elk
ENGINEER OF DESIGN AND ENVIRONMENT

December 6, 2024

James J. ...
DIRECTOR OF HIGHWAYS PROJECT IMPLEMENTATION

**PRINTED BY THE AUTHORITY
OF THE STATE OF ILLINOIS**

GENERAL NOTES

THE HMA SURFACE OF ALL MAILBOX TURNOUTS, PRIVATE ENTRANCES, COMMERCIAL ENTRANCES, AND SIDE ROADS SHALL BE MADE NEATLY, IN A WORKMANLIKE MANNER, AND SHALL ACCURATELY CONFORM TO THE SHAPES AND DIMENSIONS SHOWN ON THE PLAN DETAILS. IF REQUIRED BY THE ENGINEER, THE CONTRACTOR SHALL SAW CUT THE HMA SURFACE TO CONFORM TO THE SHAPES AND DIMENSIONS SHOWN ON THE PLAN DETAILS. THIS WORK WILL BE INCLUDED IN THE COST OF THE HMA SURFACE.

EXCEPT AS NOTED ON THE PLANS, PAVEMENT GRADES SHOWN ARE AT THE TOP OF PAVEMENT SURFACES.

THE ENGINEER WILL BE THE SOLE JUDGE CONCERNING CURING TIME FOR THE VARIOUS HMA LIFTS.

ALL EXCAVATED MATERIAL, WHICH INCLUDES DIGGING OR GRADING OF ANY SOIL OR FILL MATERIAL, WITH THE EXCEPTION OF AGGREGATE FILLS, MUST BE INCORPORATED WITHIN THE IDOT RIGHT OF WAY.

ON EXISTING PAVEMENT WHICH MAY BE SUPERELEVATED, THE NEW HMA PAVEMENT SHALL BE BUILT WITH THE SAME SUPERELEVATION UNLESS NEW SUPERELEVATION RATES ARE GIVEN ON THE PLANS.

THE FOLLOWING RATES OF APPLICATION HAVE BEEN USED IN CALCULATING PLAN QUANTITIES:

GRANULAR MATERIALS	2.05	TONS / CU YD
HMA RESURFACING	112	LBS / SQ YD / IN
SHORT TERM PAVEMENT MARKING	4	FT /40 FT OF APPLICATION
MIX FOR CRACKS, JTS & FLGWYS	0.0003	TONS / SQ YD

ADDITIONAL CONSTRUCTION PROJECTS MAY BE UNDER CONTRACT WITHIN OR NEAR THE LIMITS OF THIS PROJECT WHEN IT IS IN FORCE. THE CONTRACTOR FOR THIS PROJECT SHALL COOPERATE WITH THE CONTRACTORS ON THE OTHER PROJECTS ACCORDING TO ARTICLE 105.08 OF THE STANDARD SPECIFICATIONS. CONTRACTS ANTICIPATED TO BE IN THE VICINITY OF THIS CONTRACT ARE:

THE CONTRACTOR'S ATTENTION IS DIRECTED TO THE PRESENCE OF DEPARTMENT-OWNED UNDERGROUND ELECTRICAL CABLE WITHIN THE LIMITS OF THE PROPOSED IMPROVEMENT. THE CONTRACTOR SHALL REQUEST THE ILLINOIS DEPARTMENT OF TRANSPORTATION IN OTTAWA (815-434-8417) TO LOCATE THE UNDERGROUND FACILITIES, PROVIDING A MINIMUM OF 72 HOURS NOTICE. THE DEPARTMENT IS NOT A MEMBER OF THE JOINT UTILITY LOCATING INFORMATION FOR EXCAVATORS (JULIE) SYSTEM.

ALL DAMAGE TO DEPARTMENT OWNED UNDERGROUND FACILITIES, CAUSED BY THE CONTRACTOR SHALL BE REPAIRED TO THE SATISFACTION OF THE ENGINEER AND AT NO EXPENSE TO THE DEPARTMENT. THIS SHALL INCLUDE ALL TEMPORARY REPAIRS REQUIRED TO KEEP THE FACILITY OPERATIONAL WHILE MATERIAL IS BEING OBTAINED TO MAKE PERMANENT REPAIRS. SPLICING OF ELECTRIC CABLE WILL NOT BE ALLOWED. ELECTRIC CABLE SHALL BE REPLACED FROM POLE TO POLE OR CONTROLLER.

MEMBERS OF JULIE KNOWN TO BE WITHIN THE LIMITS OF THE IMPROVEMENT ARE:

NON-MEMBERS OF JULIE KNOWN TO BE WITHIN THE LIMITS OF THE IMPROVEMENT ARE:

COMMITMENTS:

NONE

HMA MIXTURE REQUIREMENT TABLE			
LOCATIONS:	ENTIRE PROJECT	ENTIRE PROJECT	ENTIRE PROJECT
MIXTURE USE(S):	HMA	HMA	HMA
	INTERMITTENT FULL WIDTH PAVING	PARTIAL DEPTH LONG. PATCH	INCIDENTAL
BINDER GRADE (PG):	PG 64-22	PG 64-22	PG 64-22
DESIGN AIR VOIDS:	4.0% @ N70	4.0% @ N70	4.0% @ N70
MIXTURE COMPOSITION:	IL 9.5	IL 9.5	IL 9.5
(MIXTURE GRADATION)			
FRICTION AGGREGATE:	MIXTURE D	MIXTURE D	MIXTURE D
MIXTURE WEIGHT:	112.0 LB/SY/IN	112.0 LB/SY/IN	112.0 LB/SY/IN
QUALITY MANAGEMENT PROGRAM:	QCQA	QCQA	QCQA
SUBLOT SIZE:	N/A	N/A	N/A
DENSITY TEST METHOD:	CORES/NUCLEAR	CORES/NUCLEAR	SATISFACTION OF ENGINEER
MATERIAL TRANSFER DEVICE (REQUIRED):	YES	NO	NO

STATE OF ILLINOIS
DEPARTMENT OF TRANSPORTATION
DISTRICT THREE
AS BUILT INFORMATION

SUPERVISING CONSTRUCTION FIELD ENGINEER

RESIDENT ENGINEER / TECHNICIAN

START & END DATES
OF CONSTRUCTION: _____

INSPECTORS: _____

MODEL: GENERAL NOTES-1 [Sheet]
FILE NAME: c:\p\work\wtd\brandon.criess@illinois.gov\0902551\0366P60_Sheets.dgn

USER NAME = brandon.criess	DESIGNED -	REVISED -
	DRAWN -	REVISED -
	CHECKED -	REVISED -
PLOT DATE = 11/1/2024	DATE -	REVISED -

**STATE OF ILLINOIS
DEPARTMENT OF TRANSPORTATION**

GENERAL NOTES

SCALE: SHEET 1 OF 1 SHEETS STA. TO STA.

F.A.U. RTE.	SECTION	COUNTY	TOTAL SHEETS	SHEET NO.
379	(118 & 119)J.MRK	KENDALL	19	2
CONTRACT NO. 66P60				
ILLINOIS FED. AID PROJECT				

MODEL - SUMMARY OF QUANTITIES - 1 [Sheet]
 FILE NAME: c:\pwr_work\kwid\brandon.cris@illinois.gov\092651\0368P60_Sheets.dgn

CODE NO.	ITEM	UNIT	TOTAL QUANTITY	CONSTR. CODE	
				100% STATE KENDALL	
				ROADWAY 0005	URBAN
40600290	BITUMINOUS MATERIALS (TACK COAT)	POUND	13,664	13,664	
40600370	LONGITUDINAL JOINT SEALANT	FOOT	6474	6474	
40600400	MIXTURE FOR CRACKS, JOINTS, AND FLANGEWAYS	TON	6	6	
40600405	MATERIAL TRANSFER DEVICE	TON	1861	1861	
40600990	TEMPORARY RAMP	SQ YD	140.6	140.6	
40604062	HOT-MIX ASPHALT SURFACE COURSE, IL-9.5, MIX "D", N70	TON	1861	1861	
40800050	INCIDENTAL HOT-MIX ASPHALT SURFACING	TON	89	89	
44000155	HOT-MIX ASPHALT SURFACE REMOVAL, 1 1/2"	SQ YD	23221	23221	
64200108	SHOULDER RUMBLE STRIPS, 8 INCH	FOOT	5987	5987	
67100100	MOBILIZATION	L SUM	1	1	
70100450	TRAFFIC CONTROL AND PROTECTION, STANDARD 701201	L SUM	1	1	
70100460	TRAFFIC CONTROL AND PROTECTION, STANDARD 701306	L SUM	1	1	
70300100	SHORT TERM PAVEMENT MARKING	FOOT	7391	7391	
70300150	SHORT TERM PAVEMENT MARKING REMOVAL	SQ FT	2463	2463	

USER NAME = brandon.cris	DESIGNED -	REVISED -
	DRAWN -	REVISED -
	CHECKED -	REVISED -
PLOT DATE = 11/1/2024	DATE -	REVISED -

**STATE OF ILLINOIS
 DEPARTMENT OF TRANSPORTATION**

SUMMARY OF QUANTITIES

SCALE: SHEET 1 OF 3 SHEETS STA. TO STA.

F A U RTE.	SECTION	COUNTY	TOTAL SHEETS	SHEET NO.
379	(118 & 119).MRK	KENDALL	19	3
CONTRACT NO. 66P60				
ILLINOIS FED. AID PROJECT				

MODEL - SUMMARY OF QUANTITIES - 2 (Sheet)
 FILE NAME: c:\p\work\p66666666\103666666\666666666\666666666.dgn

CODE NO.	ITEM	UNIT	TOTAL QUANTITY	CONSTR. CODE	
				100% STATE KENDALL	
				ROADWAY 0005	URBAN
70300211	TEMPORARY PAVEMENT MARKING LETTERS AND SYMBOLS - PAINT	SQ FT	188	188	
70300221	TEMPORARY PAVEMENT MARKING - LINE 4"- PAINT	FOOT	39,332	39,332	
70300241	TEMPORARY PAVEMENT MARKING - LINE 6"- PAINT	FOOT	6384	6384	
70300251	TEMPORARY PAVEMENT MARKING - LINE 8"- PAINT	FOOT	1072	1072	
70300261	TEMPORARY PAVEMENT MARKING - LINE 12"- PAINT	FOOT	497	497	
* 78004600	PREFORMED PLASTIC PAVEMENT MARKING, TYPE D - STANDARD - LETTERS AND SYMBOLS	SQ FT	188	188	
* 78004640	PREFORMED PLASTIC PAVEMENT MARKING, TYPE D - STANDARD - LINE 8"	FOOT	1072	1072	
* 78009000	MODIFIED URETHANE PAVEMENT MARKING - LETTERS AND SYMBOLS	SQ FT	1060	1060	
* 78009004	MODIFIED URETHANE PAVEMENT MARKING - LINE 4"	FOOT	301,398	301,398	
* 78009006	MODIFIED URETHANE PAVEMENT MARKING - LINE 6"	FOOT	13,269	13,269	
* 78009008	MODIFIED URETHANE PAVEMENT MARKING - LINE 8"	FOOT	6583	6583	
* 78009012	MODIFIED URETHANE PAVEMENT MARKING - LINE 12"	FOOT	3350	3350	
* 78009024	MODIFIED URETHANE PAVEMENT MARKING - LINE 24"	FOOT	170	170	
* 78011000	GROOVING FOR RECESSED PAVEMENT MARKING, LETTERS AND SYMBOLS	SQ FT	188	188	

*= SPECIALTY ITEM

USER NAME = brandon.criss	DESIGNED -	REVISED -	STATE OF ILLINOIS DEPARTMENT OF TRANSPORTATION	SUMMARY OF QUANTITIES				FAU RTE.	SECTION	COUNTY	TOTAL SHEETS	SHEET NO.
	DRAWN -	REVISED -		379	(118 & 119)LMRK	KENDALL	19	4				
	CHECKED -	REVISED -						CONTRACT NO. 66P60				
PLOT DATE = 11/1/2024	DATE -	REVISED -		SCALE:	SHEET 2	OF 3	SHEETS	STA.	TO STA.	ILLINOIS FED. AID PROJECT		

MODEL - SUMMARY OF QUANTITIES - 3 [Sheet]
 FILE NAME: c:\pw_work\kwid\brandon.crisis@illinois.gov\092651\0366P60_Sheets.dgn

CODE NO.	ITEM	UNIT	TOTAL QUANTITY	CONSTR. CODE
				100% STATE KENDALL
				ROADWAY 0005 URBAN
* 78011045	GROOVING FOR RECESSED PAVEMENT MARKING 9"	FOOT	1072	1072
* 78100100	RAISED REFLECTIVE PAVEMENT MARKER	EACH	1044	1044
78300200	RAISED REFLECTIVE PAVEMENT MARKER REMOVAL	EACH	1044	1044
X4405020	LONGITUDINAL PARTIAL DEPTH REMOVAL 2"	FOOT	32140	32140
X4420900	LONGITUDINAL PARTIAL DEPTH PATCHING	TON	801	801
Z0030850	TEMPORARY INFORMATION SIGNING	SQ FT	42	42

*= SPECIALTY ITEM

USER NAME = brandon.crisis	DESIGNED -	REVISED -	STATE OF ILLINOIS DEPARTMENT OF TRANSPORTATION	SUMMARY OF QUANTITIES			F.A.U. RTE.	SECTION	COUNTY	TOTAL SHEETS	SHEET NO.
	DRAWN -	REVISED -		379	(118 & 119)LMRK	KENDALL	19	5			
	CHECKED -	REVISED -		CONTRACT NO. 66P60							
PLOT DATE = 11/1/2024	DATE -	REVISED -		SCALE:	SHEET 3	OF 3 SHEETS	STA.	TO STA.	ILLINOIS FED. AID PROJECT		

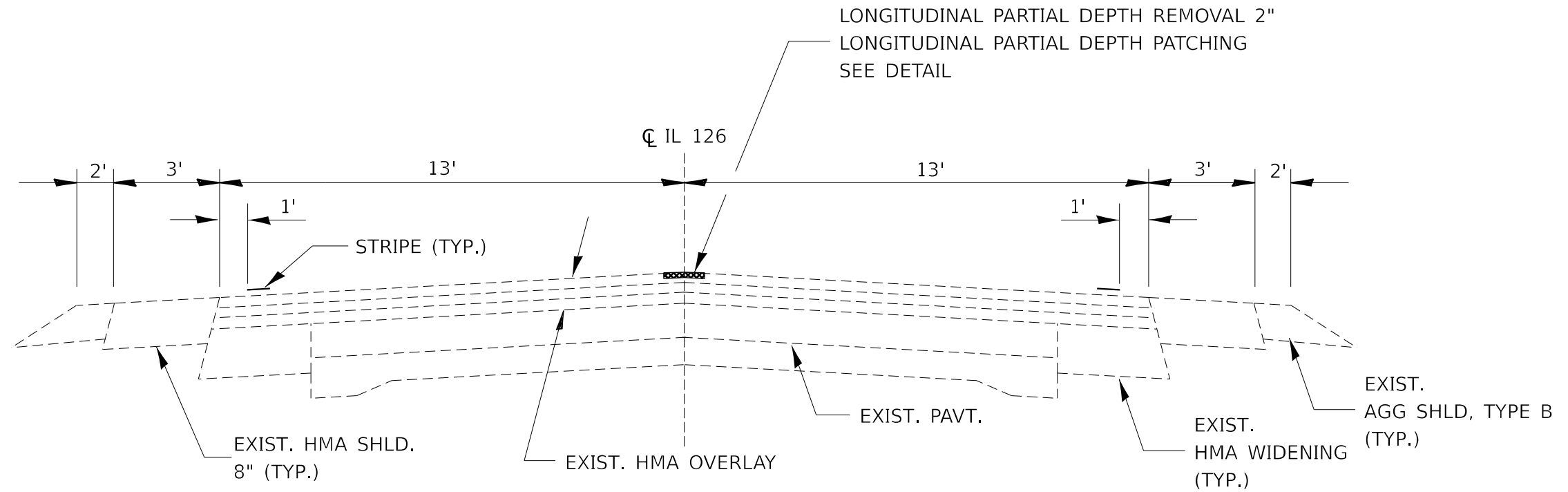

PROPOSED TYPICAL SECTION 1

- STA. 148+40 TO STA. 156+23.60
- STA. 156+41.25 TO STA. 173+79.39
- STA. 173+74.77 TO STA. 189+58.24
- STA. 189+62.34 TO STA. 221+43.04
- STA. 221+65.75 TO STA. 240+42
- STA. 271+77 TO STA. 283+26.71
- STA. 283+56.93 TO STA. 284+21
- STA. 301+95 TO STA. 326+59.62
- STA. 327+02.05 TO STA. 343+46.36
- STA. 343+52.86 TO STA. 397+98
- STA. 408+05 TO STA. 500+05.34
- STA. 499+99.99 TO STA. 503+00
- STA. 510+93 TO STA. 524+90
- STA. 542+38 TO STA. 555+51

MODEL: TYPICAL SECTION-1 (Sheet)
FILE NAME: c:\p\work\66666\brandon.criss@illinois.gov\0902551\0366P60_Sheets.dgn

USER NAME = brandon.criss	DESIGNED -	REVISED -
	DRAWN -	REVISED -
	CHECKED -	REVISED -
PLOT DATE = 11/1/2024	DATE -	REVISED -

**STATE OF ILLINOIS
DEPARTMENT OF TRANSPORTATION**

TYPICAL SECTIONS

SCALE: SHEET 1 OF 3 SHEETS STA. TO STA.

F.A.U. RTE.	SECTION	COUNTY	TOTAL SHEETS	SHEET NO.
379	(118 & 119)J.MRK	KENDALL	19	6
CONTRACT NO. 66P60				
ILLINOIS FED. AID PROJECT				

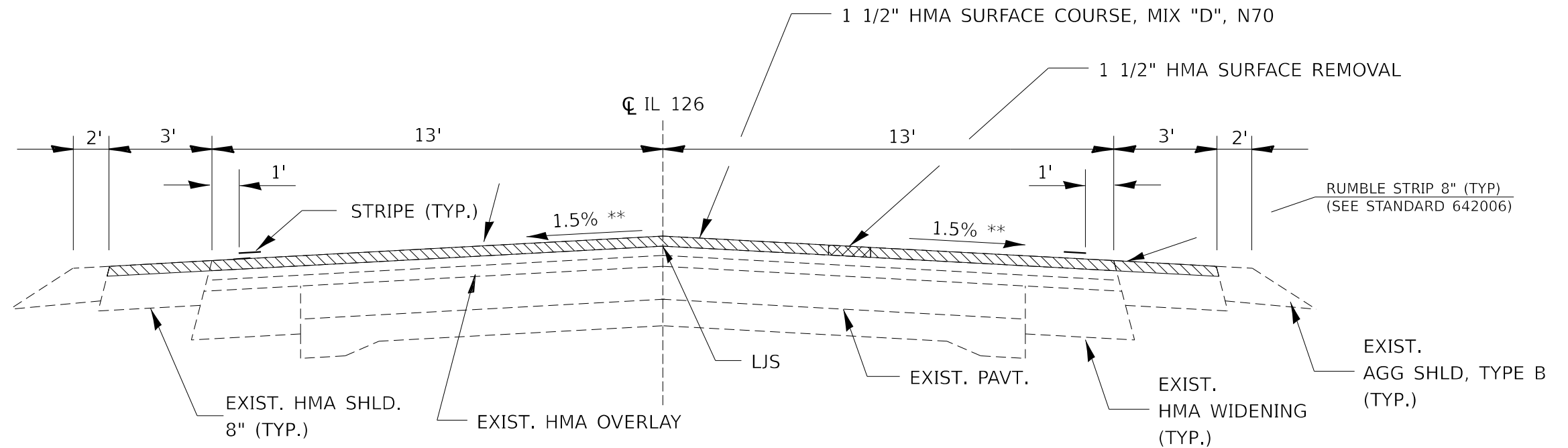

PROPOSED TYPICAL SECTION 4

** WHEN SUPER ELEVATION PRESENT MATCH EXISTING SLOPE

STA. 110+53 TO STA. 112+84.97 ***
 STA. 241+60 TO STA. 242+50
 STA. 254+70 TO STA. 258+43
 ***WILL NOT HAVE RUMBLE STRIP

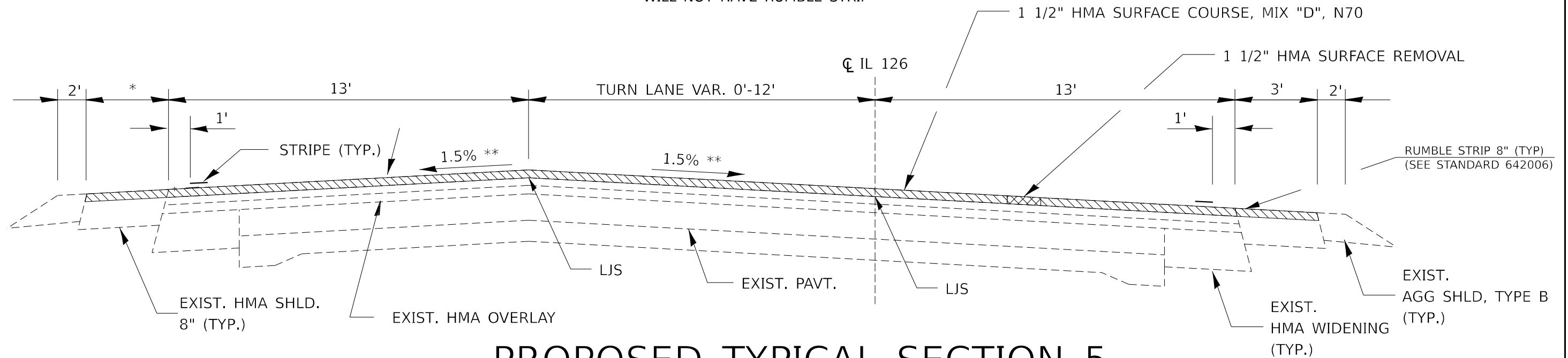

PROPOSED TYPICAL SECTION 5

* LT SHOULDER VAR. 3' TO 12'

** WHEN SUPER ELEVATION PRESENT MATCH EXISTING SLOPE

STA. 242+50 TO STA. 251+70.99
 STA. 251+94.27 TO STA. 254+70
 STA. 258+43 TO STA. 271+77

MODEL: TYPICAL SECTION-3 (Sheet)
 FILE NAME: c:\p\work\brandon.criss@illinois.gov\092551\0366P60_Sheets.dgn

USER NAME = brandon.criss	DESIGNED -	REVISED -
	DRAWN -	REVISED -
	CHECKED -	REVISED -
PLOT DATE = 11/1/2024	DATE -	REVISED -

STATE OF ILLINOIS
 DEPARTMENT OF TRANSPORTATION

TYPICAL SECTIONS

SCALE: SHEET 3 OF 3 SHEETS STA. TO STA.

F.A.U. RTE.	SECTION	COUNTY	TOTAL SHEETS	SHEET NO.
379	(118 & 119)J.MRK	KENDALL	19	8
CONTRACT NO. 66P60				
ILLINOIS FED. AID PROJECT				

PAVEMENT REMOVAL & REPLACEMENT SCHEDULE

LOCATION	DESCRIPTION	LENGTH	LNG PARTIAL DEPTH REM 2"	HMA SURF REMOVAL 1.5"	LNG PARTIAL DEPTH PATCHING	HMA SC IL 9.5, MIX D, N70, 1.5"	LONG JOINT SEAL	RUMBLE STRIPS 8"	BIT MTLs TACK COAT	MIX FOR CR, JTS, FLANGEWYS	TEMP RAMP
STA TO STA		FOOT	FOOT	SQ YD	TON	TON	FOOT	FOOT	POUND	TON	SQ YD
IL 126 KENDALL COUNTY											
96+16.00 TO 99+32.64	FULL PAVING	317		1325		111	556		596	0.4	14.4
EQ. 99+32.64 BK = 98+95.06											
98+95.06 TO 112+84.97	FULL PAVING	1390		7417		623	3048		3338	2.2	14.4
EQ. 112+84.97 BK = 112+86.95											
112+86.95 TO 132+81.95	OMIT										
EQ. 132+81.95 BK = 132+99.30											
132+99.30 TO 148+40.00	OMIT										
148+40.00 TO 156+23.60	CENTERLINE	784	784		20				78	0.1	
EQ. 156+23.60 BK = 156+41.25											
156+41.25 TO 173+79.39	CENTERLINE	1738	1738		43				174	0.2	
EQ. 173+79.39 BK = 173+74.77											
173+74.77 TO 189+58.24	CENTERLINE	1583	1583		39				158	0.2	
EQ. 189+58.24 BK = 189+62.34											
189+62.34 TO 221+43.04	CENTERLINE	3181	3181		79				318	0.3	
EQ. 221+43.04 BK = 221+65.75											
221+65.75 TO 240+42.00	CENTERLINE	1876	1876		47				188	0.2	
240+42.00 TO 241+60.00	SN 047-0058										
241+60.00 TO 242+50.00	FULL PAVING	90		360		30	90	180	162	0.1	14.4
242+50.00 TO 251+70.99	FULL PAVING	921		4421		371	1778	1842	1990	0.1	
EQ. 251+70.99 BK = 251+94.27											
251+94.27 TO 271+77.00	FULL PAVING	1983		8646		726	1002	3965	3891	0.2	14.4
271+77.00 TO 283+26.71	CENTERLINE	1150	1150		29				115	0.1	
EQ. 283+26.71 BK = 283+56.93											
283+56.93 TO 284+21.00	CENTERLINE	64	64		2				6	0.1	
284+21.00 TO 301+95.00	OMIT										
301+95.00 TO 326+59.62	CENTERLINE	2465	2465		61				246	0.2	
EQ. 326+59.62 BK = 327+02.05											
327+02.05 TO 343+46.36	CENTERLINE	1644	1644		41				164	0.2	
EQ. 343+46.36 BK = 343+52.86											
343+52.86 TO 397+98.00	CENTERLINE	5445	5445		136				545	0.4	
397+98.00 TO 407+09.53	OMIT										
EQ. 407+09.53 BK = 407+16.65											
407+16.65 TO 408+05.00	OMIT										
408+05.00 TO 500+05.34	CENTERLINE	9200	9200		229				920	0.7	
EQ. 500+05.34 BK = 499+99.99											
499+99.99 TO 503+00.00	CENTERLINE	300	300		7				30	0.1	
503+00.00 TO 510+93.00	OMIT										
510+93.00 TO 524+90.00	CENTERLINE	1397	1397		35				140	0.1	
524+90.00 TO 542+38.00	OMIT										
542+38.00 TO 555+51.00	CENTERLINE	1313	1313		33				131	0.1	
TOTALS		36841	32140	22169	801	1861	6474	5987	13190	6.0	57.6

MODEL: SCHEDULES-1 [Sheet]
FILE NAME: c:\p\work\brandon.crisis@illinois.gov\0902551\0366P60_Sheets.dgn

USER NAME = brandon.crisis	DESIGNED -	REVISED -
	DRAWN -	REVISED -
	CHECKED -	REVISED -
PLOT DATE = 12/4/2024	DATE -	REVISED -

**STATE OF ILLINOIS
DEPARTMENT OF TRANSPORTATION**

SCHEDULES			
SCALE:	SHEET 1	OF 5 SHEETS	STA. TO STA.

F.A.U. RTE. 379	SECTION (118 & 119)J.MRK	COUNTY KENDALL	TOTAL SHEETS 19	SHEET NO. 9
CONTRACT NO. 66P60				
ILLINOIS FED. AID PROJECT				

PAVEMENT MARKING REMOVAL & REPLACEMENT SCHEDULE

LOCATION	PASSING / NO PASSING		LENGTH	MODIFIED URETHANE (2 APPLICATIONS)								PREF PL PVT MKING TY D		GROOVING FOR RCSD PVT MRKG		SHORT TERM PVT MKING	SHORT TERM PVT MKING REMOVAL	RAISED REF PVT MKR (CRYSTAL)	RAISED REF PVT MKR (AMBER)	RAISED REF PVT MKR
				4"	4"	6"	8"	12"	24"	LTRS & SYM	8"	LTRS & SYM	9"	LTRS & SYM						
				WH	YW	YW	WH	YW	WH		WH				SYM					
STA TO STA	EB	WB	FOOT	FOOT	FOOT	FOOT	FOOT	FOOT	FOOT	FOOT	SQ FT	FOOT	SQ FT	FOOT	SQ FT	EACH	EACH	EACH		
IL 126 KENDALL COUNTY																				
96+16 TO 99+32.64	NO PASSING	NO PASSING	317	1267	2228				91			15		15		63	21		16	16
STA. FQ. 99+32.64 BK = 98+95.06 AH																				
98+95.06 TO 112+84.97	NO PASSING	NO PASSING	1390	5560	7852				460			556	94	556	94	278	93	12	64	76
STA. EQ. 112+84.97 BK = 112+86.95 AH																				
112+86.95 TO 132+81.95	NO PASSING	NO PASSING	1995	7980	11892				1235	577	187									
STA. EQ. 132+81.95 BK = 132+99.3 AH																				
132+99.30 TO 148+40	NO PASSING	NO PASSING	1541	6163	10044				1215	396	187									
148+40 TO 155+95	PASSING	NO PASSING	755	3020	1510			378							151	50		19	19	
155+95 TO 156+23.60	PASSING	PASSING	29	114				14							6	2		1	1	
STA. EQ. 156+23.6 BK = 156+41.25 AH																				
156+41.25 TO 158+08	PASSING	PASSING	167	667				83							33	11		4	4	
158+08 TO 164+11	NO PASSING	PASSING	603	2412	1206			302							121	40		15	15	
164+11 TO 170+20	PASSING	PASSING	609	2436				305							122	41		15	15	
170+20 TO 173+13	PASSING	NO PASSING	293	1172	586			147							59	20		7	7	
173+13 TO 173+79.39	NO PASSING	NO PASSING	66	266	266										13	4		2	2	
STA. EQ. 173+79.39 BK = 173+74.77 AH																				
173+74.77 TO 177+12	NO PASSING	NO PASSING	337	1349	1349										67	22		8	8	
177+12 TO 183+61	NO PASSING	PASSING	649	2596	1298			325							130	43		16	16	
183+61 TO 186+88	NO PASSING	NO PASSING	327	1308	1308										65	22		8	8	
186+88 TO 189+58.24	PASSING	NO PASSING	270	1081	540			135							54	18		7	7	
STA. EQ. 189+58.24 BK = 189+62.34 AH																				
189+62.34 TO 195+44	PASSING	NO PASSING	582	2327	1163			291							116	39		15	15	
195+44 TO 204+46	PASSING	PASSING	902	3608				451							180	60		23	23	
204+46 TO 214+50	NO PASSING	PASSING	1004	4016	2008			502							201	67		25	25	
214+50 TO 221+43.04	NO PASSING	NO PASSING	693	2772	2772										139	46		17	17	
STA. EQ. 221+43.04 BK = 221+65.75 AH																				
221+65.75 TO 225+40	NO PASSING	NO PASSING	374	1497	1497										75	25		9	9	
225+40 TO 236+65	PASSING	NO PASSING	1125	4500	2250			563							225	75		28	28	
236+65 TO 237+47	PASSING	PASSING	82	328				41							16	5		2	2	
237+47 TO 240+42	NO PASSING	PASSING	295	1180	590			148							59	20		7	7	
240+42 TO 241+60	NO PASSING	PASSING	118	472	236			59							24	8				
241+60 TO 242+50	NO PASSING	PASSING	90	360	180			45							18	6		2	2	
242+50 TO 251+70.99	NO PASSING	NO PASSING	921	3684	5844					282		228	47	228	47	184	61	5	47	52
SUBTOTALS			15533	62135	56619	3789	2450	1806	0	374	799	141	799	141	2399	799	17	357	374	

MODEL: SCHEDULES-2 (Sheet)
FILE NAME: c:\p\work\brandon.crisss@illinois.gov\0902551\0366P60_Sheets.dgn

USER NAME = brandon.crisss	DESIGNED -	REVISED -
	DRAWN -	REVISED -
	CHECKED -	REVISED -
PLOT DATE = 12/4/2024	DATE -	REVISED -

**STATE OF ILLINOIS
DEPARTMENT OF TRANSPORTATION**

SCHEDULES			
SCALE:	SHEET 2	OF 5 SHEETS	STA. TO STA.

F.A.U. RTE.	SECTION	COUNTY	TOTAL SHEETS	SHEET NO.
379	(118 & 119)JL.MRK	KENDALL	19	10
CONTRACT NO. 66P60				
ILLINOIS FED. AID PROJECT				

PAVEMENT MARKING REMOVAL & REPLACEMENT SCHEDULE CONT.

LOCATION	PASSING / NO PASSING		LENGTH	MODIFIED URETHANE (2 APPLICATIONS)								PREF PL PVT MKING TY D		GROOVING FOR RCSD PVT MRKG		SHORT TERM PVT MKING	SHORT TERM PVT MKING REMOVAL	RAISED REF PVT MKR (CRYSTAL)	RAISED REF PVT MKR (AMBER)	RAISED REF PVT MKR REMOVAL	
				4"	4"	6"	8"	12"	24"	LTRS & SYM	8"	LTRS & SYM	9"	LTRS & SYM							
				WH	YW	YW	WH	YW	WH	SYM	WH	SYM									
STA	TO	STA	EB	WB	FOOT	FOOT	FOOT	FOOT	FOOT	FOOT	SQ FT	FOOT	SQ FT			FOOT	SQ FT	EACH	EACH	EACH	
IL 126 KENDALL COUNTY																					
STA. EQ. 251+70.99 BK = 251+94.27 AH																					
251+94.27	TO	271+77	NO PASSING	NO PASSING	1983	7931	12116			484			273	47	273	47	397	132	5	90	95
271+77	TO	283+26.71	NO PASSING	NO PASSING	1150	4599	4599										230	77		29	29
STA. EQ. 283+26.71 BK = 283+56.93 AH																					
283+56.93	TO	284+21	NO PASSING	NO PASSING	64	256	256										13	4		2	2
284+21	TO	301+95	NO PASSING	NO PASSING	1774	7096	11248			2437	494	374									
301+95	TO	312+92	NO PASSING	NO PASSING	1097	4388	4388										219	73		27	27
312+92	TO	323+08	PASSING	NO PASSING	1016	4064	2032	508									203	68		25	25
323+08	TO	326+59.62	PASSING	PASSING	352	1406		176									70	23		9	9
STA. EQ. 326+59.62 BK = 327+02.05 AH																					
327+02.05	TO	343+46.36	PASSING	PASSING	1644	6577		822									329	110		41	41
STA. EQ. 343+46.36 BK = 343+52.86 AH																					
343+52.86	TO	397+98	PASSING	PASSING	5445	21781		2723									1089	363		136	136
397+98	TO	407+09.53	PASSING	PASSING	912	3646		456													
STA. EQ. 407+09.53 BK = 407+16.65 AH																					
407+16.65	TO	408+05	PASSING	PASSING	88	353		44													
408+05	TO	494+20	PASSING	PASSING	8615	34460		4308									1723	574		215	215
494+20	TO	500+05.34	NO PASSING	PASSING	585	2341	1171	293									117	39		15	15
STA. EQ. 500+05.34 BK = 499+99.99 AH																					
499+99.99	TO	503+00	NO PASSING	PASSING	300	1200	600	150									60	20		8	8
503+00	TO	510+93	NO PASSING	NO PASSING	793	3172	3172														
510+93	TO	524+90	NO PASSING	NO PASSING	1397	5588	5588										279	93		35	35
524+90	TO	542+38	NO PASSING	NO PASSING	1748	6992	11120		1696	566	170	312									
542+38	TO	555+51	NO PASSING	NO PASSING	1313	5252	5252										263	88		33	33
SUBTOTALS					30276	121102	61542	9480	4133	1544	170	686	273	47	273	47	4992	1664	5	665	670
TOTALS					45809	183237	118161	13269	6583	3350	170	1060	1072	188	1072	188	7391	2463	22	1022	1044

SIDEROADS AND ENTRANCES SCHEDULE

STATION	NAME	SIDE	MATERIAL	HMA SURF REM 1.5"	INCIDENTAL HMA SURF	BIT MATL (TACK COAT)	TEMP RAMP
				SQ YD	TON	POUND	SQ YD
97+75	CE	LT	HMA	42	4	19	
99+42	CE/MBTO	LT	HMA/BRICK	56	5	25	
103+41	PRAIRIE CROSSING DR	RT	HMA	270	23	122	31
249+30	CLUBHOUSE DR	LT	HMA	420	35	189	33
265+78	FAIRWAY DR	LT	HMA	237	20	107	19
270+15	FE	RT	AGG				
270+32	CE	LT	HMA	27	2	12	
TOTALS				1052	89	474	83

MODEL: SCHEDULES-3 [Sheet]
FILE NAME: c:\p\work\brandon.crisis@illinois.gov\0902551\0366P60_Sheets.dgn

USER NAME = brandon.crisis	DESIGNED -	REVISED -
	DRAWN -	REVISED -
	CHECKED -	REVISED -
PLOT DATE = 12/4/2024	DATE -	REVISED -

**STATE OF ILLINOIS
DEPARTMENT OF TRANSPORTATION**

SCHEDULES

SCALE: SHEET 3 OF 5 SHEETS STA. TO STA.

F.A.U. RTE.	SECTION	COUNTY	TOTAL SHEETS	SHEET NO.
379	(118 & 119)J.MRK	KENDALL	19	11
CONTRACT NO. 66P60				
ILLINOIS FED. AID PROJECT				

II 126 PERMANENT SURVEY MARKER

GPS NUMBER	DESCRIPTION	APPROXIMATE LOCATION	EXISTING MONUMENT TYPE	PROPOSED MONUMENT TYPE	MONUMENT RECORD TO BE RECORDED	RESPONSIBILITY
126953	SW CORNER SECTION 11, T36N, R8E, 3RD PM	1 MILE EAST OF SCHLAPP RD	MAG NAIL	TYPE 1	YES	2
126952	N QTR CORNER SECTION 14, T36N, R8E, 3RD PM	1/2 MILE WEST OF OLD RIDGE RD	MAG NAIL	TYPE 1	YES	2

ONLY THE ORIGINAL SCOPE OF THIS JOB HAS BEEN SEARCHED FOR MONUMENTS. R.E. MUST INFORM PLATS AND PLANS TO SEARCH FOR ADDITIONAL MONUMENTS PRIOR TO MILLING IF ADDENDUMS HAVE BEEN ADDED TO THIS JOB.

R.E. WILL INFORM PLATS AND PLANS WHEN SURFACE IS TO BE MILLED FOR THE PURPOSE OF LOCATING ANY BURIED MONUMENTS.

UNKNOWN MONUMENTS MAY EXIST. IF AN UNLISTED MONUMENT IS FOUND, R.E. IS REQUIRED TO PROTECT THE MONUMENT FROM DAMAGE UNTIL A PLATS AND PLANS LAND SURVEYOR CAN DOCUMENT THE MONUMENT. PLATS AND PLANS WILL RESET SUCH MONUMENTS IN KIND FOLLOWING CONSTRUCTION.

UPON PAVING COMPLETION, R.E. WILL DIRECT PLATS AND PLANS TO STAKE THE TYPE 1 PSM CORING LOCATIONS.

TYPE 1 TOTALS ARE SUBJECT TO CHANGE BASED ON THE RESULTS OF THE MILLED ROAD MONUMENTS SEARCH.

NOTE: FOR BIDDING PURPOSES, NO CONTRACTED LAND SURVEYING SERVICES WILL BE REQUIRED FOR SETTING THE LISTED PERMANENT SURVEY MARKERS. PLATS AND PLANS WILL PREPARE THE REQUIRED MONUMENT RECORDS.

RESPONSIBILITY:

- 1) RESIDENT TO RE-ESTABLISH MONUMENT (PAY ITEM REQUIRED. PERMANENT SURVEY MARKER, TYPE 1)
- 2) PLATS AND PLANS TO RE-ESTABLISH MONUMENT
- 3) RESIDENT TO INSTALL VAULT OVER STONE MONUMENT PER SPECIAL PROVISION

MODEL: SCHEDULES-5 (Sheet)
FILE NAME: c:\p\work\brandon\brandon.criss@illinois.gov\0902551\0366P60_Sheets.dgn

USER NAME = brandon.criss	DESIGNED -	REVISED -
	DRAWN -	REVISED -
	CHECKED -	REVISED -
PLOT DATE = 11/1/2024	DATE -	REVISED -

**STATE OF ILLINOIS
DEPARTMENT OF TRANSPORTATION**

SCHEDULES

SCALE: SHEET 4 OF 5 SHEETS STA. TO STA.

F.A.U RTE.	SECTION	COUNTY	TOTAL SHEETS	SHEET NO.
379	(118 & 119)J.MRK	KENDALL	19	12
CONTRACT NO. 66P60				
ILLINOIS FED. AID PROJECT				

TEMPORARY PAVEMENT MARKING SCHEDULE											
LOCATION			PASSING /NO PASSING		LENGTH	TEMPORARY					LTRS & SYM
						4"		6"	8"	12"	
						WH	YW	YW	WH	YW	
STA	TO	STA	EB	WB	FOOT	FOOT	FOOT	FOOT	FOOT	FOOT	SQ FT
IL 126 KENDALL COUNTY											
96+16.00	TO	99+32.64	NO PASSING	NO PASSING	317	633	557		15	91	
STA. EQ. 99+32.64 BK = 98+95.06 AH											
98+95.06	TO	112+84.97	NO PASSING	NO PASSING	1390	2690	4002		556	23	94
STA. EQ. 112+84.97 BK = 112+86.95 AH											
112+86.95	TO	132+81.95	OMIT	OMIT							
STA. EQ. 132+81.95 BK = 132+99.3 AH											
132+99.30	TO	148+40.00	OMIT	OMIT							
148+40.00	TO	155+95.00	PASSING	NO PASSING	755		755	189			
155+95.00	TO	156+23.60	PASSING	PASSING	29			/			
STA. EQ. 156+23.6 BK = 156+41.25 AH											
156+41.25	TO	158+08.00	PASSING	PASSING	167			42			
158+08.00	TO	164+11.00	NO PASSING	PASSING	603		603	151			
164+11.00	TO	170+20.00	PASSING	PASSING	609			152			
170+20.00	TO	173+13.00	PASSING	NO PASSING	293		293	73			
173+13.00	TO	173+79.39	NO PASSING	NO PASSING	66		133				
STA. EQ. 173+79.39 BK = 173+74.77 AH											
173+74.77	TO	177+12.00	NO PASSING	NO PASSING	337			674			
177+12.00	TO	183+61.00	NO PASSING	PASSING	649		649	162			
183+61.00	TO	186+88.00	NO PASSING	NO PASSING	327		654				
186+88.00	TO	189+58.24	PASSING	NO PASSING	270		270	68			
STA. EQ. 189+58.24 BK = 189+62.34 AH											
189+62.34	TO	195+44.00	PASSING	NO PASSING	582		582	145			
195+44.00	TO	204+46.00	PASSING	PASSING	902			226			
204+46.00	TO	214+50.00	NO PASSING	PASSING	1004		1004	251			
214+50.00	TO	221+43.04	NO PASSING	NO PASSING	693		1386				
STA. EQ. 221+43.04 BK = 221+65.75 AH											
221+65.75	TO	225+40.00	NO PASSING	NO PASSING	374		749				
225+40.00	TO	236+65.00	PASSING	NO PASSING	1125		1125	281			
236+65.00	TO	237+47.00	PASSING	PASSING	82			21			
237+47.00	TO	240+42.00	NO PASSING	PASSING	295		295	74			
240+42.00	TO	241+60.00	NO PASSING	PASSING	118		118	30			
241+60.00	TO	242+50.00	NO PASSING	PASSING	90	180	90	23			
242+50.00	TO	251+70.99	NO PASSING	NO PASSING	921	1662	1461		228	141	47
STA. EQ. 251+70.99 BK = 251+94.27 AH											
251+94.27	TO	271+77.00	NO PASSING	NO PASSING	1983	3795	3029		273	242	47
271+77.00	TO	283+26.71	NO PASSING	NO PASSING	1150		2299				
STA. EQ. 283+26.71 BK = 283+56.93 AH											
283+56.93	TO	284+21.00	NO PASSING	NO PASSING	64		128				
284+21.00	TO	301+95.00									
301+95.00	TO	312+92.00	NO PASSING	NO PASSING	1097		2194				
312+92.00	TO	323+08.00	PASSING	NO PASSING	1016		1016	254			
323+08.00	TO	326+59.62	PASSING	PASSING	352			88			
STA. EQ. 326+59.62 BK = 327+02.05 AH											
327+02.05	TO	343+46.36	PASSING	PASSING	1644			411			
STA. EQ. 343+46.36 BK = 343+52.86 AH											
343+52.86	TO	397+98.00	PASSING	PASSING	5445			1361			
397+98.00	TO	407+09.53	OMIT	OMIT							
STA. EQ. 407+09.53 BK = 407+16.65 AH											
407+16.65	TO	408+05.00	OMIT	OMIT							
408+05.00	TO	494+20.00	PASSING	PASSING	8615			2154			
494+20.00	TO	500+05.34	NO PASSING	PASSING	585		585	146			
STA. EQ. 500+05.34 BK = 499+99.99 AH											
499+99.99	TO	503+00.00	NO PASSING	PASSING	300		300	75			
503+00.00	TO	510+93.00	OMIT	OMIT							
510+93.00	TO	524+90.00	NO PASSING	NO PASSING	1397		2794				
524+90.00	TO	542+38.00	OMIT	OMIT							
542+38.00	TO	555+51.00	NO PASSING	NO PASSING	1313		2626				
TOTALS					36959	8960	30372	6384	1072	497	188

MODEL: SCHEDULES-4 (Sheet)
 FILE NAME: c:\p\work\brandon.crisis@illinois.gov\0902551\0366P60_Sheets.dgn

USER NAME = brandon.crisis	DESIGNED -	REVISED -
	DRAWN -	REVISED -
	CHECKED -	REVISED -
PLOT DATE = 12/4/2024	DATE -	REVISED -

STATE OF ILLINOIS
DEPARTMENT OF TRANSPORTATION

SCHEDULES			
SCALE:	SHEET 5	OF 5 SHEETS	STA. TO STA.

F.A.U. RTE.	SECTION	COUNTY	TOTAL SHEETS	SHEET NO.
379	(118 & 119)J.MRK	KENDALL	19	13
CONTRACT NO. 66P60				
ILLINOIS FED. AID PROJECT				



PROJECT BEGINS
STA 96+16

SN 047-2542
STA 96+47

STA 112+84.97 BK =
STA 112+86.95 AH

STA 156+23.60 BK =
STA 156+41.25 AH

EX CURVE
PI STA = 168+96.49
Δ = 09°15'49" (LT)
D = 00°57'26"
R = 5,986.35'
T = 485.00'
L = 967.89'
E = 19.61'
e =
PC STA = 164+11.49
PT STA = 173+79.38

EX CURVE
PI STA = 184+78.36
Δ = 21°32'55" (RT)
D = 02°13'06"
R = 2,582.78'
T = 491.49'
L = 971.37'
E = 46.35'
e =
PC STA = 179+86.86
PT STA = 189+58.23

STA 189+58.24 BK =
STA 189+62.34 AH

STA 221+43.04 BK =
STA 221+65.75 AH

CLUBHOUSE DR
STA 249+30

STA 251+70.99 BK =
STA 251+94.27 AH

FAIRWAY DR
STA 265+78

STA 283+26.71 BK =
STA 283+56.93 AH

SN 047-2588
STA 284+42

STA 400+00
SN 047-2007
DOUBLE 8'X9'
BOX CULVERT

OLD GROVE RD
STA 309+75

EX CURVE
PI STA = 404+03.52
Δ = 08°10'55" (RT)
D = 01°20'05"
R = 4,292.94'
T = 307.04'
L = 613.04'
E = 10.97'
e =
PC STA = 400+96.48
PT STA = 407+09.52

STA 416+58
SN 047-2537
BOX CULVERT

STA 462+50
SN 047-2012
TRIPLE 10'X7'
BOX CULVERT

STA 479+25
SN 047-2538
BOX CULVERT

EX CURVE
PI STA = 505+00.00
Δ = 00°42'32" (LT)
D = 00°04'15"
R = 80,838.31'
T = 500.00'
L = 999.99'
E = 1.55'
e =
PC STA = 500+00.00
PT STA = 509+99.98

EX CURVE
PI STA = 553+94.90
Δ = 16°05'23" (RT)
D = 01°31'43"
R = 3,748.49'
T = 529.80'
L = 1052.64'
E = 37.26'
e =
PC STA = 548+65.10
PT STA = 559+17.74

PROJECT ENDS
STA 555+51

EX CURVE
PI STA = 95+23.34
Δ = 20°41'40" (RT)
D = 02°30'01"
R = 2,291.64'
T = 418.41'
L = 827.70'
E = 37.88'
e =
PC STA = 91+04.93
PT STA = 99+32.63

WING RD
STA 95+36

IL 126

MINKLER RD
STA 163+80

SCHLAPP RD
STA 401+77

RIDGE ROAD NORTH
STA 533+48

STA 99+32.64 BK =
STA 98+95.06 AH

PRAIRE CROSSING DR
STA 103+40

IL 126

STA 407+09.53 BK =
STA 407+16.65 AH

EX CURVE
PI STA = 107+58.91
Δ = 08°34'17" (RT)
D = 00°48'47"
R = 7,045.93'
T = 528.01'
L = 1054.06'
E = 19.76'
e =
PC STA = 102+30.89
PT STA = 112+84.95

ASHLEY RD
STA 139+67

HOPKINS RD
STA 223+60

GROVE RD
STA 293+15

STA 343+46.36 BK =
STA 343+52.86 AH

EX CURVE
PI STA = 338+52.01
Δ = 19°44'28" (LT)
D = 01°58'36"
R = 2,898.52'
T = 504.34'
L = 998.68'
E = 43.55'
e =
PC STA = 333+47.67
PT STA = 343+46.35

STA 547+78
SN 047-2539
6'x2' BOX CULVERT

PENNMAN RD
STA 119+00

STA 132+81.95 BK =
STA 132+99.30 AH

EX CURVE
PI STA = 216+44.22
Δ = 24°18'42" (LT)
D = 02°23'59"
R = 2,387.59'
T = 514.29'
L = 1013.10'
E = 54.76'
e =
PC STA = 211+29.93
PT STA = 221+43.03

EX CURVE
PI STA = 278+38.99
Δ = 32°00'43" (LT)
D = 03°11'38"
R = 1,793.99'
T = 514.62'
L = 1002.33'
E = 72.35'
e =
PC STA = 273+24.37
PT STA = 283+26.70

STA 326+59.62 BK =
STA 327+02.05 AH

EX CURVE
PI STA = 309+70.19
Δ = 31°46'55" (RT)
D = 03°25'11"
R = 1,675.50'
T = 476.99'
L = 929.40'
E = 66.57'
e =
PC STA = 304+93.20
PT STA = 314+22.60

EX CURVE
PI STA = 321+27.61
Δ = 20°57'08" (LT)
D = 02°09'22"
R = 2,657.26'
T = 491.35'
L = 971.72'
E = 45.05'
e =
PC STA = 316+36.26
PT STA = 326+07.99

OLD RIDGE RD
STA 507+10

EX CURVE
PI STA = 128+00.00
Δ = 32°16'11" (LT)
D = 03°15'23"
R = 1,759.45'
T = 509.00'
L = 990.95'
E = 72.15'
e =
PC STA = 122+91.00
PT STA = 132+81.94

STA 173+79.39 BK =
STA 173+74.77 AH

SN 047-2536
STA 201+76

OMIT SN 047-0058
STA 240+42 TO- STA 241+60

MODEL: PROJECT LAYOUT (Sheet)
FILE NAME: c:\pwworking\brandon.crisis@illinois.gov\0902551\0366P60_Sheets.dgn

USER NAME = brandon.crisis	DESIGNED -	REVISED -
	DRAWN -	REVISED -
	CHECKED -	REVISED -
PLOT DATE = 11/1/2024	DATE -	REVISED -

STATE OF ILLINOIS
DEPARTMENT OF TRANSPORTATION

PROJECT LAYOUT MAP

SCALE: SHEET 1 OF 1 SHEETS STA. TO STA.

F.A.U. RTE.	SECTION	COUNTY	TOTAL SHEETS	SHEET NO.
379	(118 & 119)J.MRK	KENDALL	19	14
CONTRACT NO. 66P60				
ILLINOIS FED. AID PROJECT				

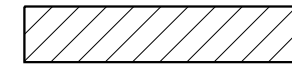
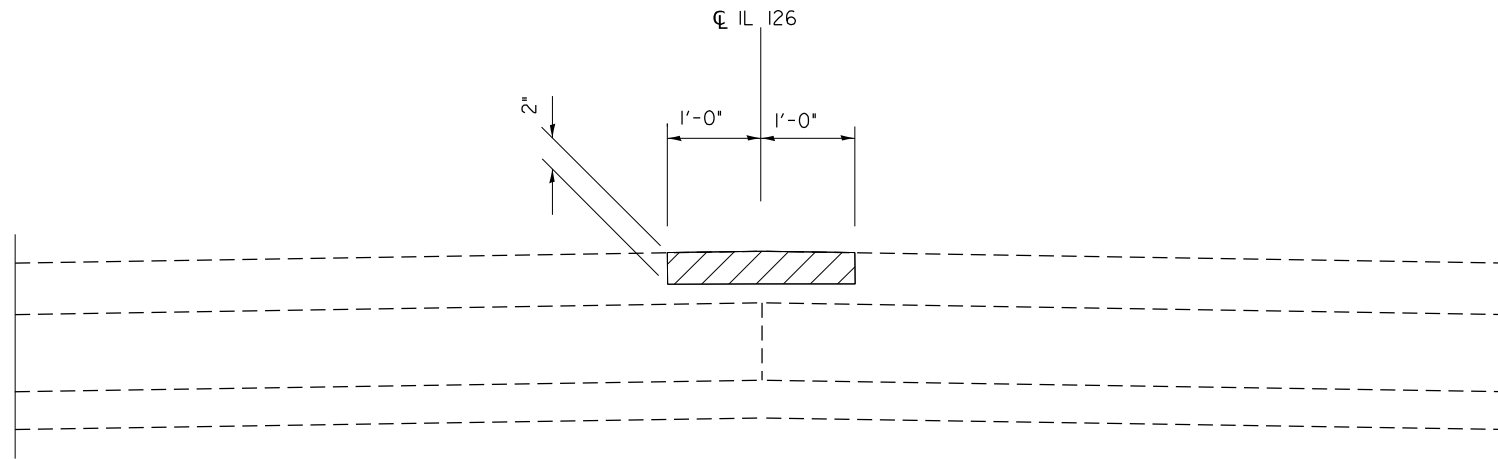

LONGITUDINAL PARTIAL DEPTH REMOVAL 2"



LONGITUDINAL PARTIAL DEPTH PATCHING

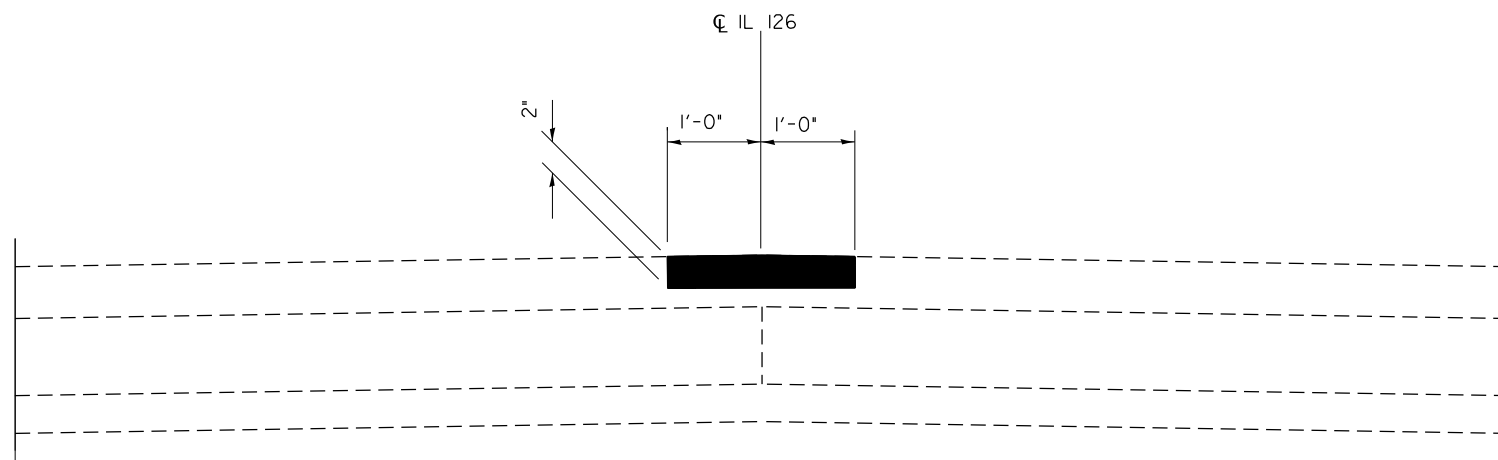

NOTES

- 1) RESURFACING SHALL BE LOCATED AT THE CENTERLINE OF PAVEMENT JOINT. ACTUAL LOCATIONS SHALL BE FIELD DETERMINED BY THE ENGINEER PRIOR TO THE CONTRACTOR BEGINNING HIS/HER CONSTRUCTION OPERATIONS.
- 2) OFFSET OF THE PERMANENT CENTERLINE PAVEMENT STRIPING SHALL BE FIELD DETERMINED BY THE ENGINEER. TEMPORARY PAVEMENT MARKING SHALL BE PLACED AT THE SAME LOCATION AS THE PROPOSED PERMANENT PAVEMENT MARKING.
- 3) AFTER MILLING, AND PRIOR TO PLACING THE HMA MIXTURE, AREAS WITH SIGNIFICANT ADDITIONAL DETERIORATION ALONG THE CENTERLINE SHALL BE PREFILLED WITH MIXTURES FOR CRACK, JOINTS AND FLANGWAYS AND COMPACTED TO THE SATISFACTION OF THE ENGINEER

MODEL: DETAILS-6 (Sheet)
FILE NAME: c:\p\work\brandon.criss@illinois.gov\092551\0366P60_Sheets.dgn

USER NAME = brandon.criss	DESIGNED -	REVISED -
	DRAWN -	REVISED -
	CHECKED -	REVISED -
PLOT DATE = 11/1/2024	DATE -	REVISED -

**STATE OF ILLINOIS
DEPARTMENT OF TRANSPORTATION**

DETAILS

SCALE: SHEET 1 OF 5 SHEETS STA. TO STA.

F.A.U. RTE.	SECTION	COUNTY	TOTAL SHEETS	SHEET NO.
379	(118 & 119)J.MRK	KENDALL	19	15
ILLINOIS FED. AID PROJECT			CONTRACT NO. 66P60	

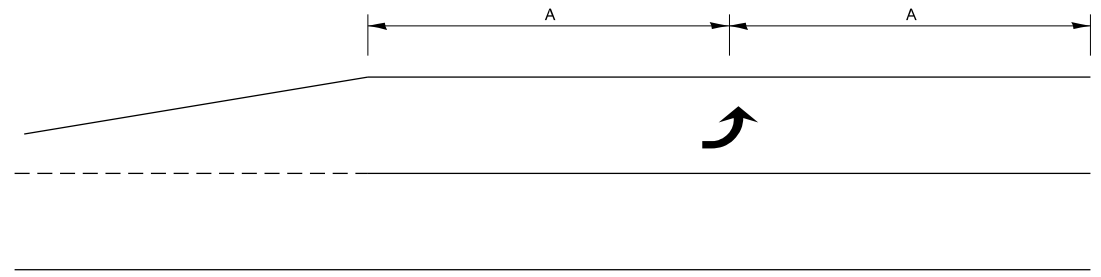

99' AND UNDER

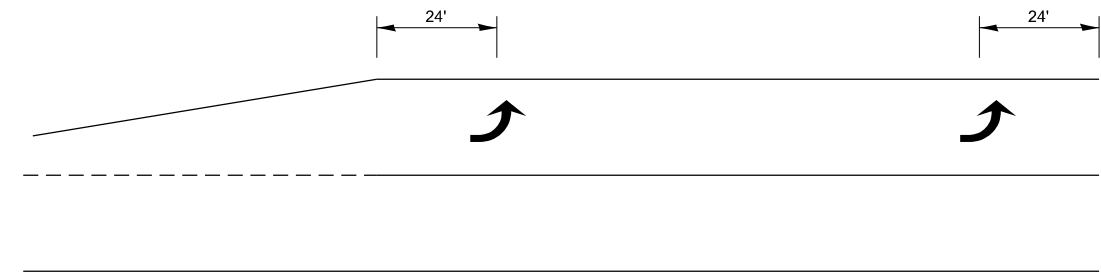

100' TO 149'

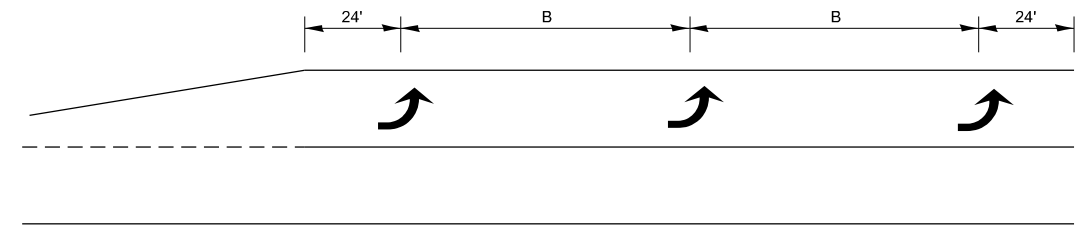

150' AND LONGER

**TYPICAL PLACEMENT OF ARROWS
IN TURN LANES**

MODEL: DETAILS-3 (Sheet)
FILE NAME: c:\p\work\brandon.criss@illinois.gov\092651\0366P60_Sheets.dgn

USER NAME = brandon.criss	DESIGNED -	REVISED -
	DRAWN -	REVISED -
	CHECKED -	REVISED -
PLOT DATE = 11/1/2024	DATE -	REVISED -

**STATE OF ILLINOIS
DEPARTMENT OF TRANSPORTATION**

DETAILS

SCALE: SHEET 2 OF 5 SHEETS STA. TO STA.

F.A.U. RTE.	SECTION	COUNTY	TOTAL SHEETS	SHEET NO.
379	(118 & 119)J.MRK	KENDALL	19	16
CONTRACT NO. 66P60				
ILLINOIS FED. AID PROJECT				

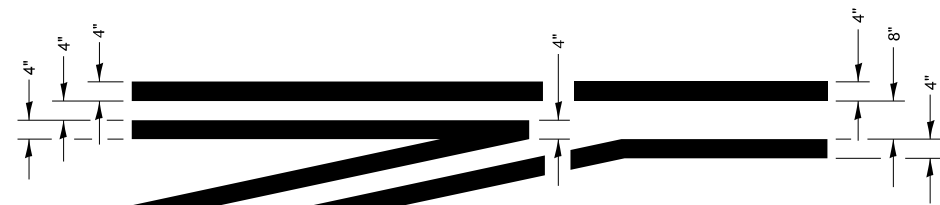

**LEFT TURN LANE
TYPICAL APPLICATION**

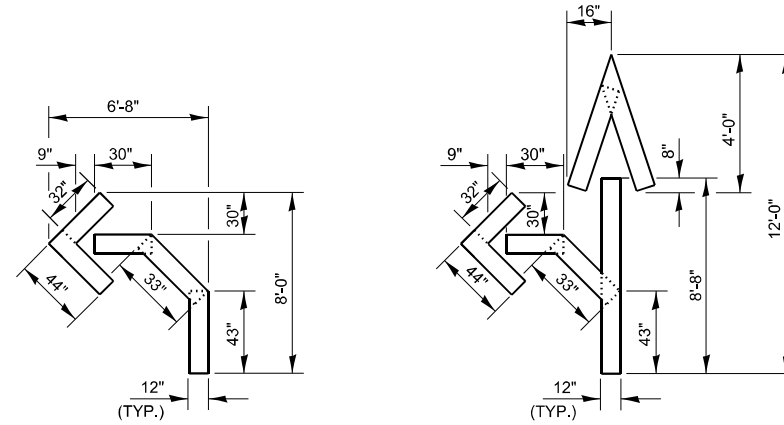

QUANTITY
12" LINE = 16 LIN FT
OR 4" LINE = 48 LIN FT

QUANTITY
12" LINE = 29 LIN FT
OR 4" LINE = 87 LIN FT

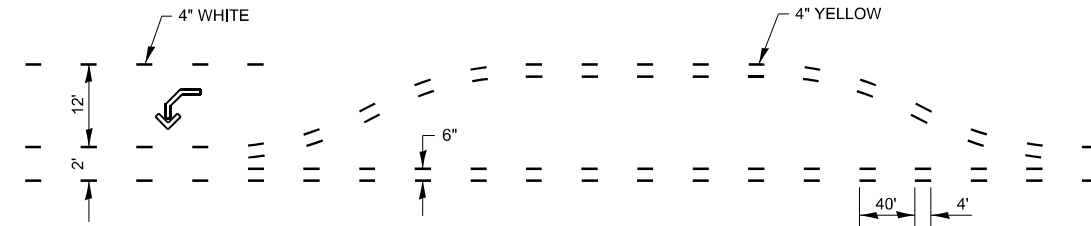

**SHORT-TERM PAVEMENT MARKING
FOR MEDIANS AND ARROWS**

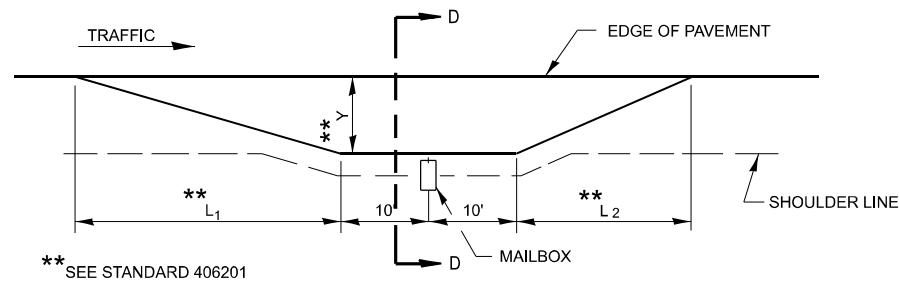

** SEE STANDARD 406201

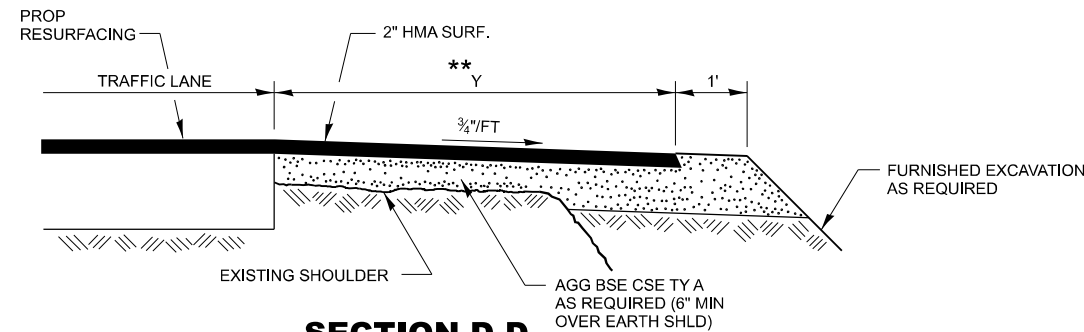

SECTION D-D

RURAL MAILBOX TURNOUT DETAILS

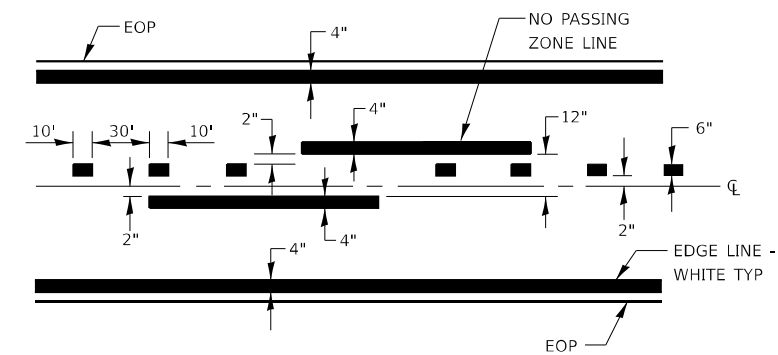

CENTERLINE & NO PASSING
ZONE LINES - YELLOW

PAVEMENT MARKING

MODEL: DETAILS-2 (Sheet)
FILE NAME: c:\p\work\brandon.crisss@illinois.gov\092551\0366P60_Sheets.dgn

USER NAME = brandon.crisss	DESIGNED -	REVISED -
	DRAWN -	REVISED -
	CHECKED -	REVISED -
PLOT DATE = 11/1/2024	DATE -	REVISED -

STATE OF ILLINOIS
DEPARTMENT OF TRANSPORTATION

DETAILS			
SCALE:	SHEET 3	OF 5 SHEETS	STA. TO STA.

F.A.U. RTE.	SECTION	COUNTY	TOTAL SHEETS	SHEET NO.
379	(118 & 119)J.MRK	KENDALL	19	17
CONTRACT NO. 66P60				
ILLINOIS FED. AID PROJECT				

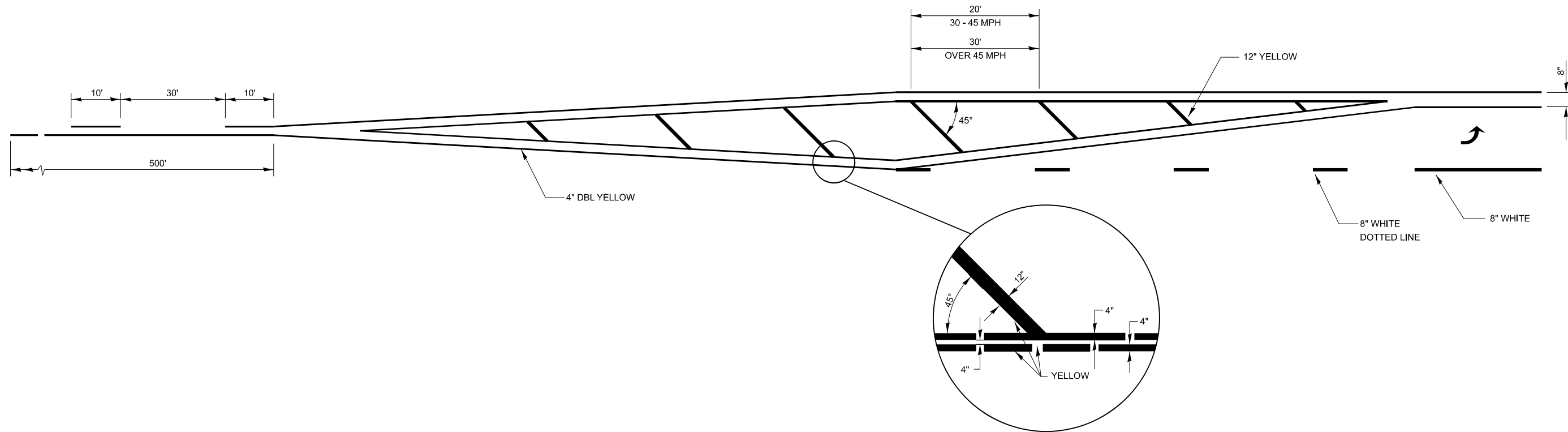

LEFT TURN LANE WITH APPROACH MEDIAN

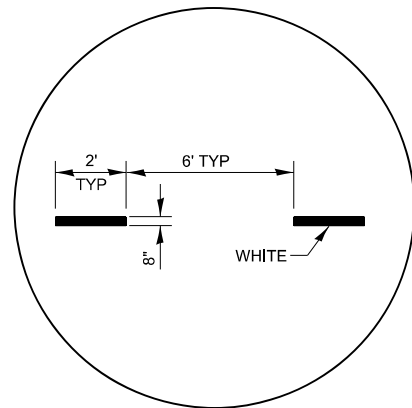

ADVANCE AND INTERSECTION LANE DIVIDER LINES

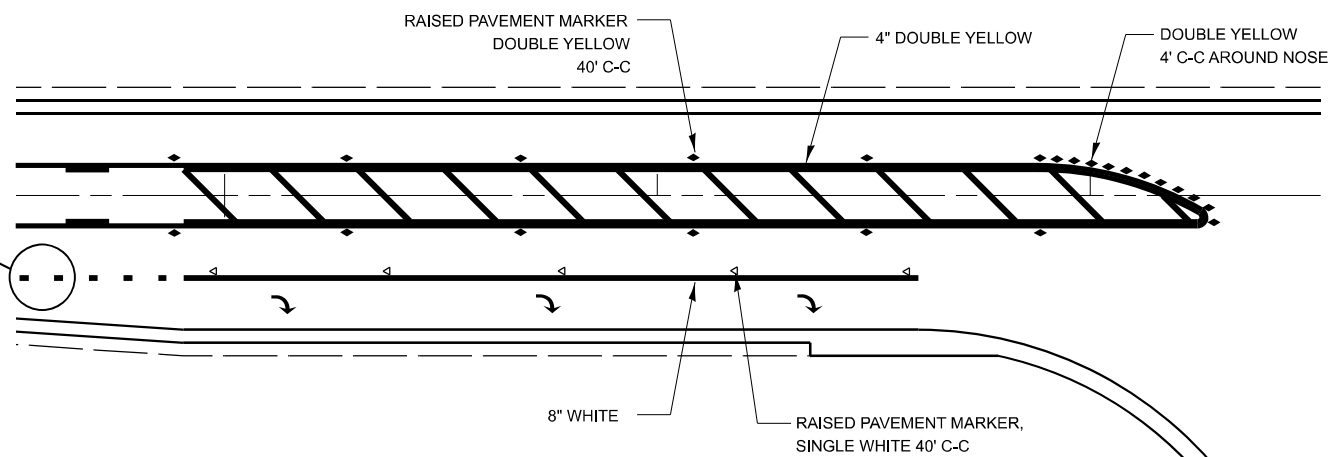

RAISED REFLECTIVE AND PAVEMENT MARKERS @ RIGHT TURN LANE

URBAN PAVEMENT MARKING

MODEL: DETAIL S-4 (Sheet)
 FILE NAME: c:\p\work\brandon.crisss@illinois.gov\092551\0366P60_Sheets.dgn

USER NAME = brandon.crisss	DESIGNED -	REVISED -
	DRAWN -	REVISED -
	CHECKED -	REVISED -
PLOT DATE = 11/1/2024	DATE -	REVISED -

STATE OF ILLINOIS
 DEPARTMENT OF TRANSPORTATION

DETAILS

SCALE: SHEET 4 OF 5 SHEETS STA. TO STA.

F.A.U. RTE. 379	SECTION (118 & 119)J.MRK	COUNTY KENDALL	TOTAL SHEETS 19	SHEET NO. 18
CONTRACT NO. 66P60				
ILLINOIS FED. AID PROJECT				

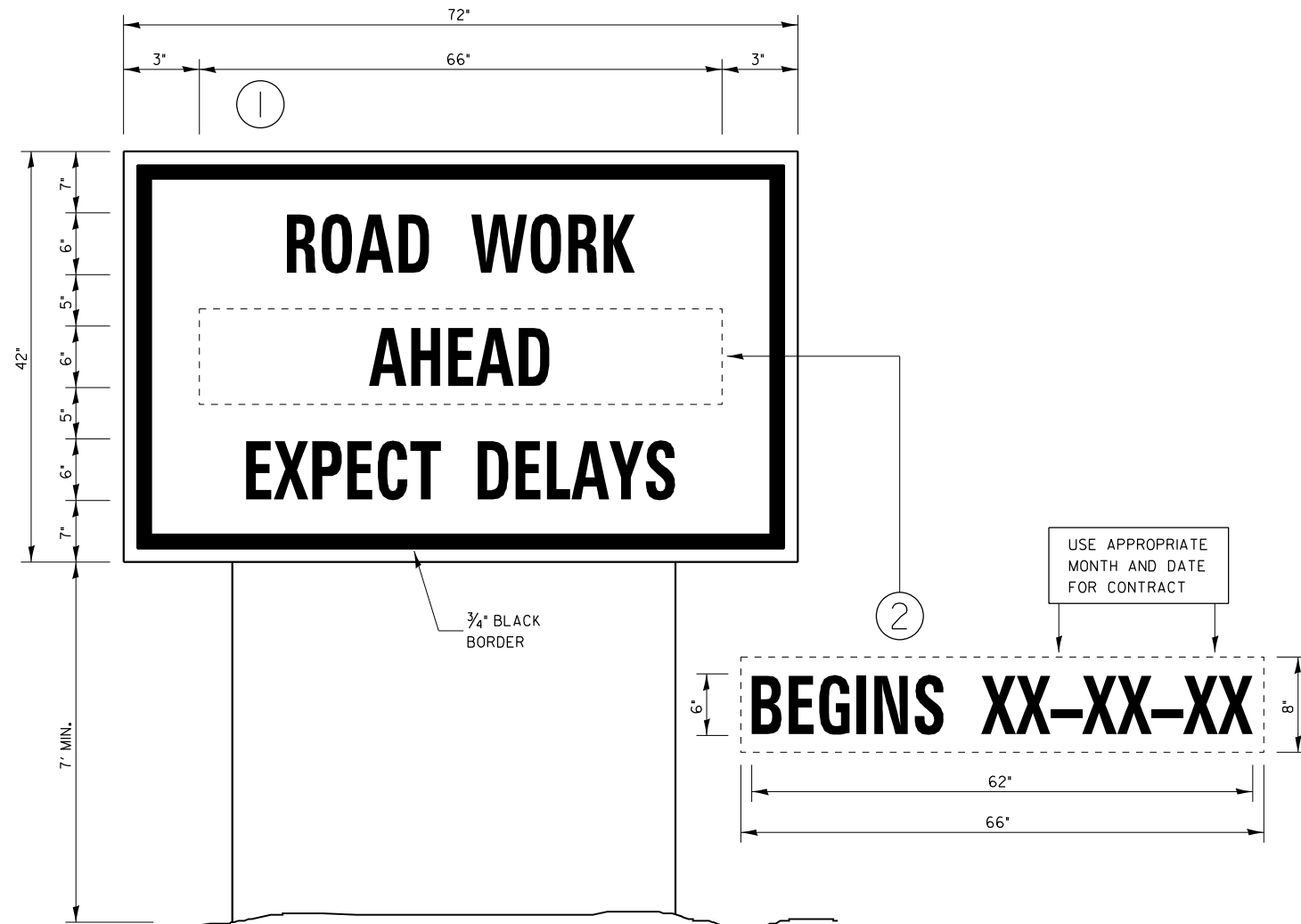

TEMPORARY INFORMATION SIGNING

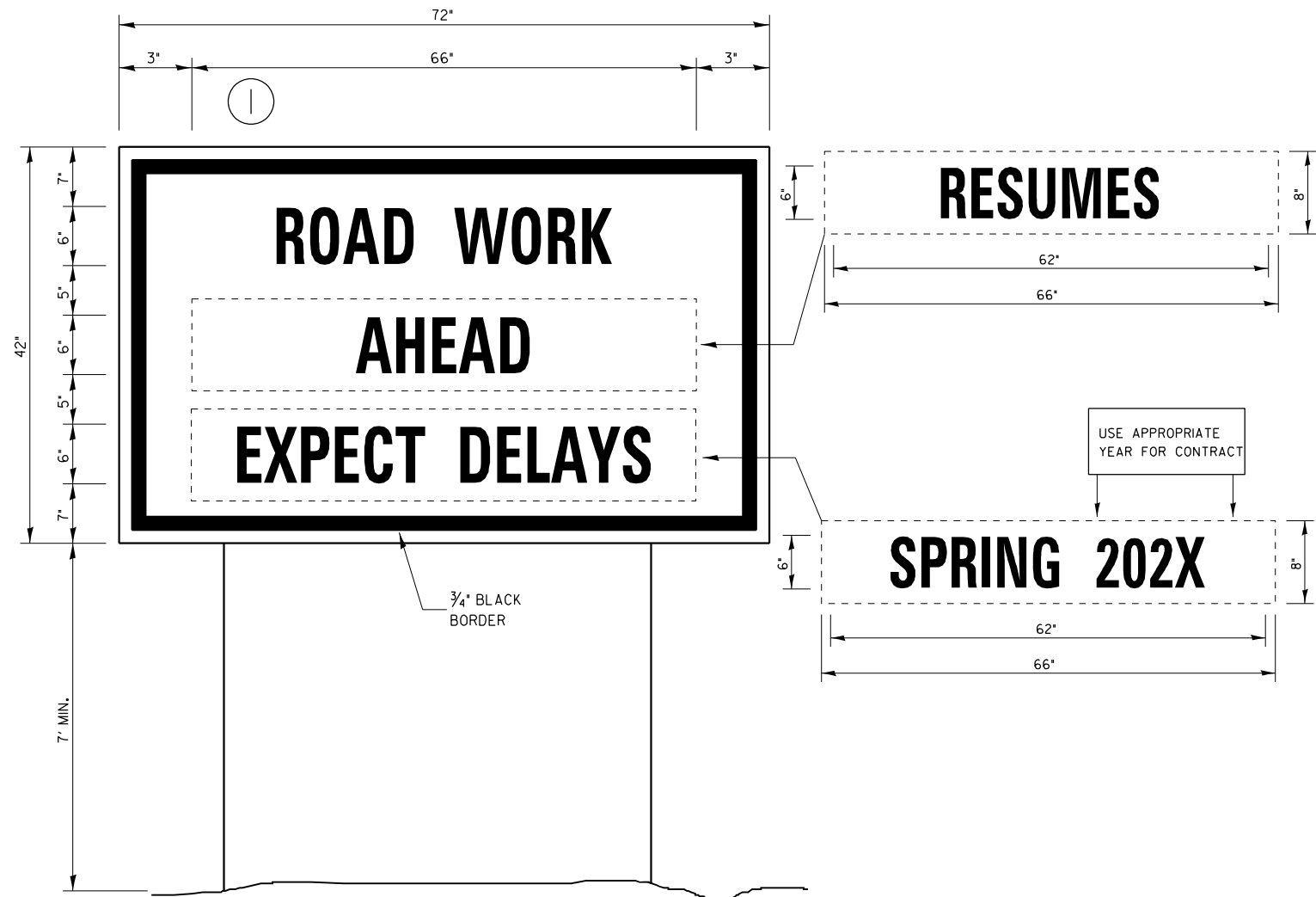

WINTER SHUT DOWN SIGNING

NOTES:

1. USE 6" D BLACK LETTERING ON FLOURESENT ORANGE BACKGROUND.
2. ERECT SIGNS AT LOCATIONS IN ADVANCE OF THE "ROAD CONSTRUCTION AHEAD" SIGNS AS DIRECTED BY THE ENGINEER.
3. ERECT SIGN ① WITH INSTALLED PANEL ② A MINIMUM OF ONE WEEK PRIOR TO THE START OF THE LANE CLOSURE.
4. REMOVE PANEL ② ON THAT DATE.
5. SEE SPECIAL PROVISION "TEMPORARY INFORMATION SIGNING" FOR ADDITIONAL INFORMATION.
6. WILL BE PAID FOR PER SQ FT AS "TEMPORARY INFORMATION SIGNING". EACH SIGN = 2150 FT AND THE DATE PANEL ② WILL NOT BE MEASURED SEPARATELY FOR PAYMENT.

MODEL: DETAILS-1 (Sheet)
FILE NAME: c:\p\work\brandon.criess@illinois.gov\092551\0366P60_Sheets.dgn

USER NAME = brandon.criess	DESIGNED -	REVISED -
	DRAWN -	REVISED -
	CHECKED -	REVISED -
PLOT DATE = 11/1/2024	DATE -	REVISED -

**STATE OF ILLINOIS
DEPARTMENT OF TRANSPORTATION**

DETAILS

SCALE: SHEET 5 OF 5 SHEETS STA. TO STA.

F.A.U RTE.	SECTION	COUNTY	TOTAL SHEETS	SHEET NO.
379	(118 & 119)J.MRK	KENDALL	19	19
CONTRACT NO. 66P60				
ILLINOIS FED. AID PROJECT				