

F.A. RTE.	SECTION	COUNTY	TOTAL SHEETS	SHEET NO.
*	38 RS-4	COOK	36	21
STA.	TO STA.			
FED. ROAD DIST. NO.	ILLINOIS FED. AID PROJECT			
* F.A.P. 343 F.A.U. 1273			CONTRACT NO. 60814	

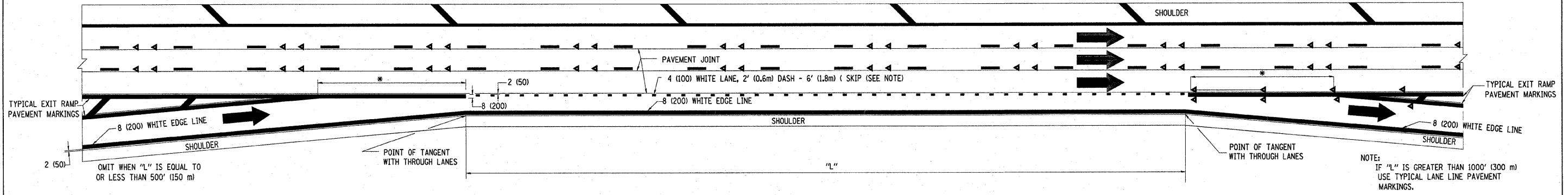

**TYPICAL ENTRANCE/EXIT RAMP COMBINATION PAVEMENT MARKINGS**

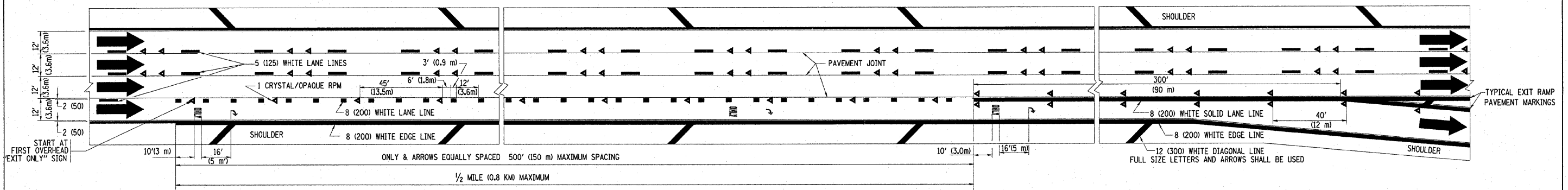

**TYPICAL EXIT ONLY LANE PAVEMENT MARKINGS**

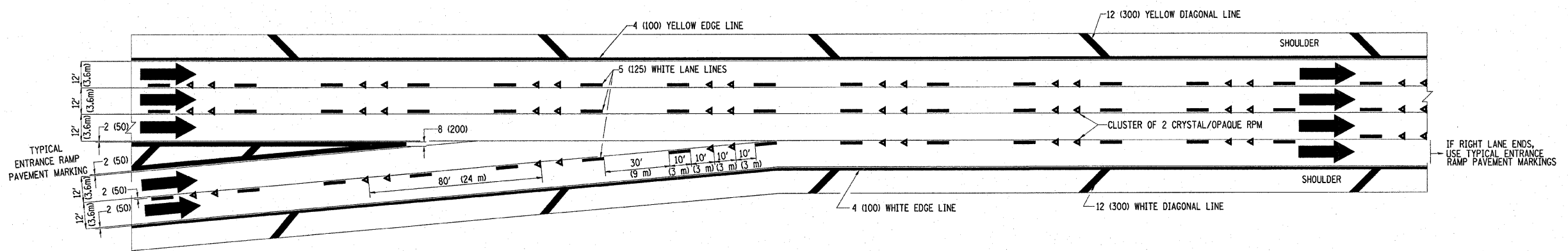

**TYPICAL TWO LANE ENTRANCE RAMP PAVEMENT MARKINGS**

REVISIONS	
NAME	DATE
DWS	1/90
DWS	5/91
SPB	1/07

ILLINOIS DEPARTMENT OF TRANSPORTATION

**MULTI-LANE FREEWAY PAVEMENT MARKING DETAILS**

SCALE: NONE  
DATE: 10/10/2007

DRAWN BY: C.A.D.D.  
CHECKED BY:  
TC12 SHEET 2 OF 2  
REVISION DATE: 01/01/07

PLOT DATE = 10/10/2007  
FILE NAME = 522913.DWG  
PLOT SCALE = 522913 / IN.  
USER NAME = atedpa