

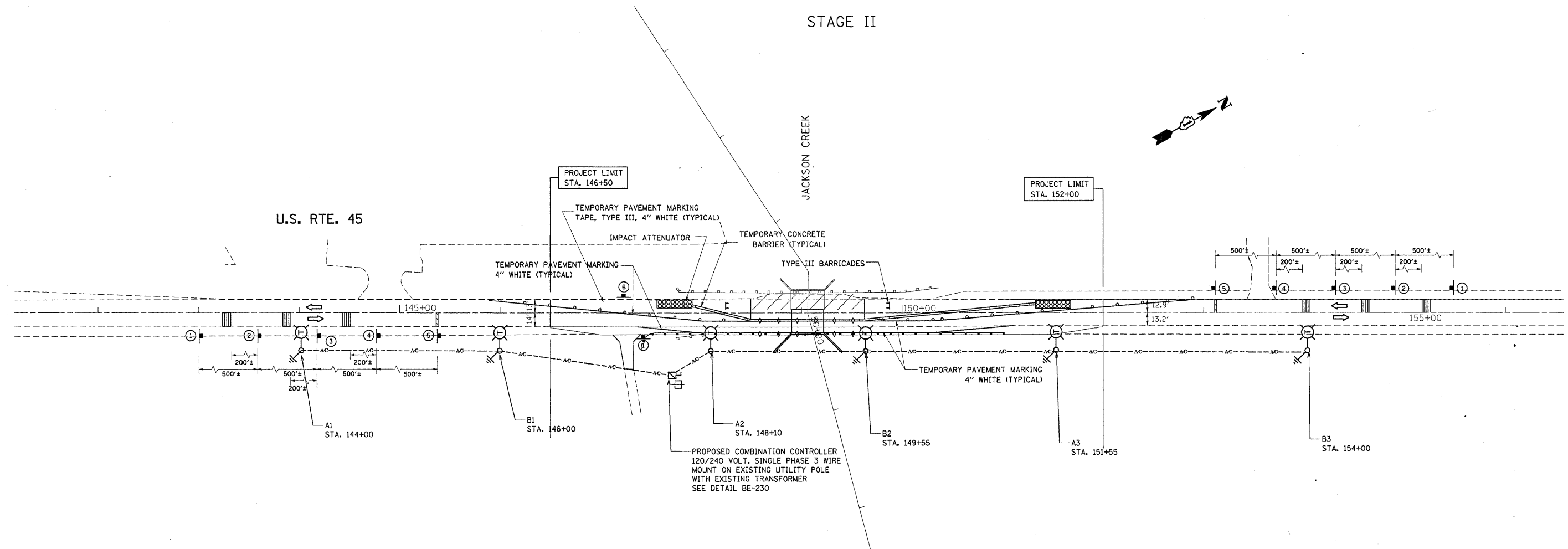

STAGE II

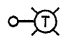
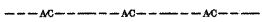

LEGEND

- 

TEMPORARY LIGHTING UNIT
47.5 FT. MOUNTING HEIGHT, 15 FT. MAST ARM
400 WATT, 120 VOLT LUMINAIRE WITH PHOTOCELL
ON EACH LUMINAIRE
- 

AERIAL CABLE, 3-1/2"-#4, ALUMINUM, WITH MESSENGER WIRE
- 

GROUND ROD, 5/8" DIAMETER X 10 FT.
- 

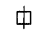
COMBINATION TRAFFIC/LIGHTING CONTROLLER,
120/240 VOLT, SINGLE PHASE 3 WIRE
MOUNTED ON COMED UTILITY POLE
- 

EXISTING UTILITY TRANSFORMER, POLE MOUNTED

FILE NAME = c:\Projects\p135202\Lighting.dgn	USER NAME = lszekr-f	DESIGNED -	REVISED -	STATE OF ILLINOIS DEPARTMENT OF TRANSPORTATION	TEMPORARY LIGHTING PLAN		F.A.P. RTE.	SECTION	COUNTY	TOTAL SHEETS	SHEET NO.
	PLOT SCALE = 50.0000' / IN.	DRAWN -	REVISED -		U.S. RTE. 45 OVER JACKSON CREEK - S.N. 099-4649		330	104B-3-BR	WILL	42	17
PLOT DATE = 10/30/2007	CHECKED -	REVISED -	SCALE: SHEET NO. OF SHEETS STA. TO STA.		CONTRACT NO. 60880						
	DATE -	REVISED -	FED. ROAD DIST. NO. 1 ILLINOIS FED. AID PROJECT								