

F.A.P. RTE.	SECTION	COUNTY	TOTAL SHEETS	SHEET NO.
374	211-K-V-X-B	COOK	38	1

CONTRACT NO. 60C20  
38+2=40

STATE OF ILLINOIS  
DEPARTMENT OF TRANSPORTATION  
DIVISION OF HIGHWAYS

# PROPOSED HIGHWAY PLANS

F.A.P. ROUTE 374: MILWAUKEE AVE. (IL. RTE. 21)  
OVER UNION PACIFIC RAILROAD  
STRUCTURE NO.: 016-0243  
SECTION: 211-K-V-X-B  
BRIDGE DECK REPLACEMENT

COOK COUNTY  
C-91-164-07

D-91-164-07

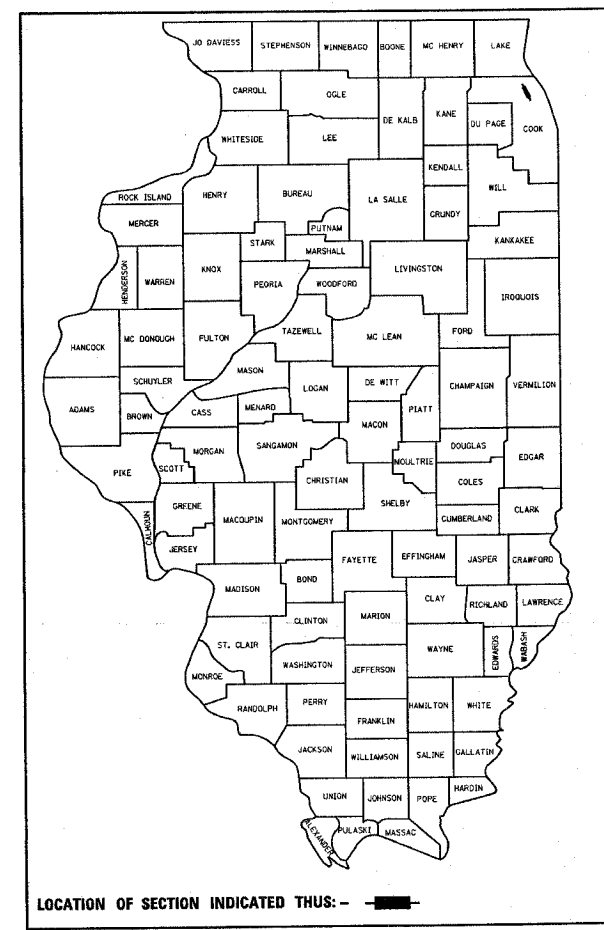

LOCATION OF SECTION INDICATED THUS: —

FOR INDEX OF SHEETS, SEE SHEET NO. 2

PROJECT LOCATED IN  
THE VILLAGE OF GLENVIEW

LOCATION OF PROJECT  
MILWAUKEE AVE. (IL. RTE. 21)  
OVER UNION PACIFIC RAILROAD

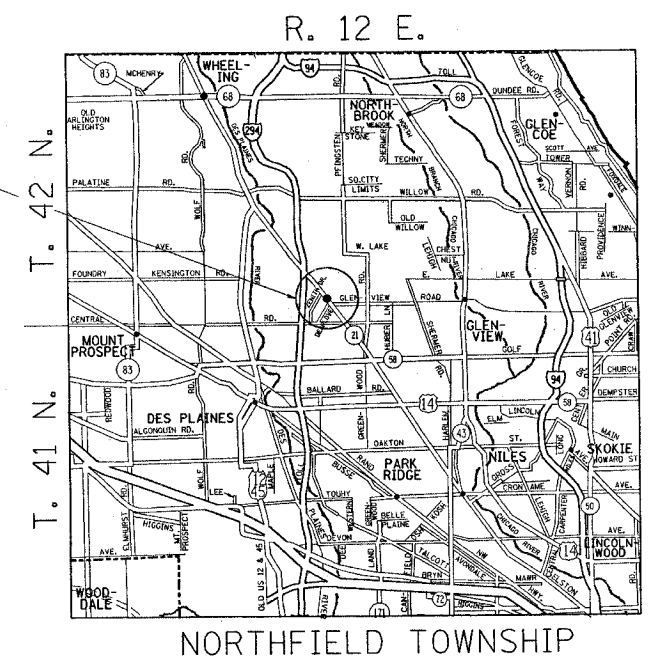

NORTHFIELD TOWNSHIP

TRAFFIC DATA  
2005 ADT = 41,800  
POSTED SPEED = 45 MPH

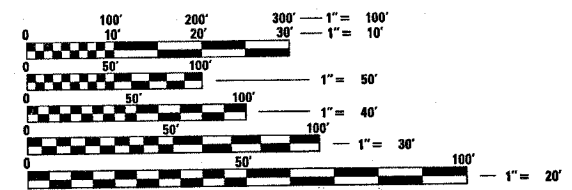

FULL SIZE PLANS HAVE BEEN PREPARED USING STANDARD ENGINEERING SCALES. REDUCED SIZED PLANS WILL NOT CONFORM TO STANDARD SCALES. IN MAKING MEASUREMENTS ON REDUCED PLANS, THE ABOVE SCALES MAY BE USED.

J.U.L.I.E.  
JOINT UTILITY LOCATION INFORMATION FOR EXCAVATION  
1-800-892-0123

GROSS & NET LENGTH OF PROJECT = 1341 FEET = 0.25 MILE

STATE OF ILLINOIS  
DEPARTMENT OF TRANSPORTATION  
DIVISION OF HIGHWAYS

SUBMITTED July 19 2007  
Diane O'Keefe  
DEPUTY DIRECTOR OF HIGHWAYS, REGION ENGINEER

August 17 2007  
Eric E. Stara  
ENGINEER OF DESIGN AND ENVIRONMENT

August 17 2007  
Milton R. Sosa P.E.  
DIRECTOR OF HIGHWAYS, CHIEF ENGINEER

PRINTED BY THE AUTHORITY  
OF THE STATE OF ILLINOIS

DISTRICT ONE - PLAN PREPARATION ENGINEER - KEN ENG/J. CHANG (847) 705-4432