

F.A.P. RTE.	SECTION	COUNTY	TOTAL SHEETS	SHEET NO.
374	211-K-V-X-B	COOK	38	10
STA. TO STA.		ILLINOIS FED. AID PROJECT		
FED. ROAD DIST. NO.		CONTRACT NO. 60C20		

### TRAFFIC SIGNAL LEGEND

	PROPOSED	EXISTING		PROPOSED	EXISTING
CONTROLLER CABINET			EMERGENCY VEHICLE SYSTEM DETECTOR		
RAILROAD CONTROL CABINET			CONFIRMATION BEACON		
SERVICE INSTALLATION, (P) POLE OR (G) GROUND MOUNT			JUNCTION BOX		
TELEPHONE CONNECTION			HANDHOLE		
SIGNAL HEAD			HEAVY DUTY HANDHOLE		
SIGNAL HEAD WITH BACKPLATE			DOUBLE HANDHOLE		
SIGNAL HEAD OPTICALLY PROGRAMMED			G.S. CONDUIT IN TRENCH OR PUSHED		
SIGNAL HEAD PEDESTRIAN			COMMON TRENCH		
SIGNAL POST			UNIT DUCT		
WOOD POLE			PEDESTRIAN PUSHBUTTON DETECTOR		
STEEL MAST ARM ASSEMBLY AND POLE			DETECTOR LOOP, TYPE I		
ALUMINUM MAST ARM ASSEMBLY AND POLE			PREFORMED DETECTOR LOOP		
STEEL COMBINATION MAST ARM ASSEMBLY AND POLE WITH LUMINAIRE			UNINTERRUPTABLE POWER SUPPLY		

① CONTRACTOR TO INSTALL THE WIRELESS INTERCONNECT ANTENNA ON THE TOP OF THE EXISTING MAST ARM POLE.

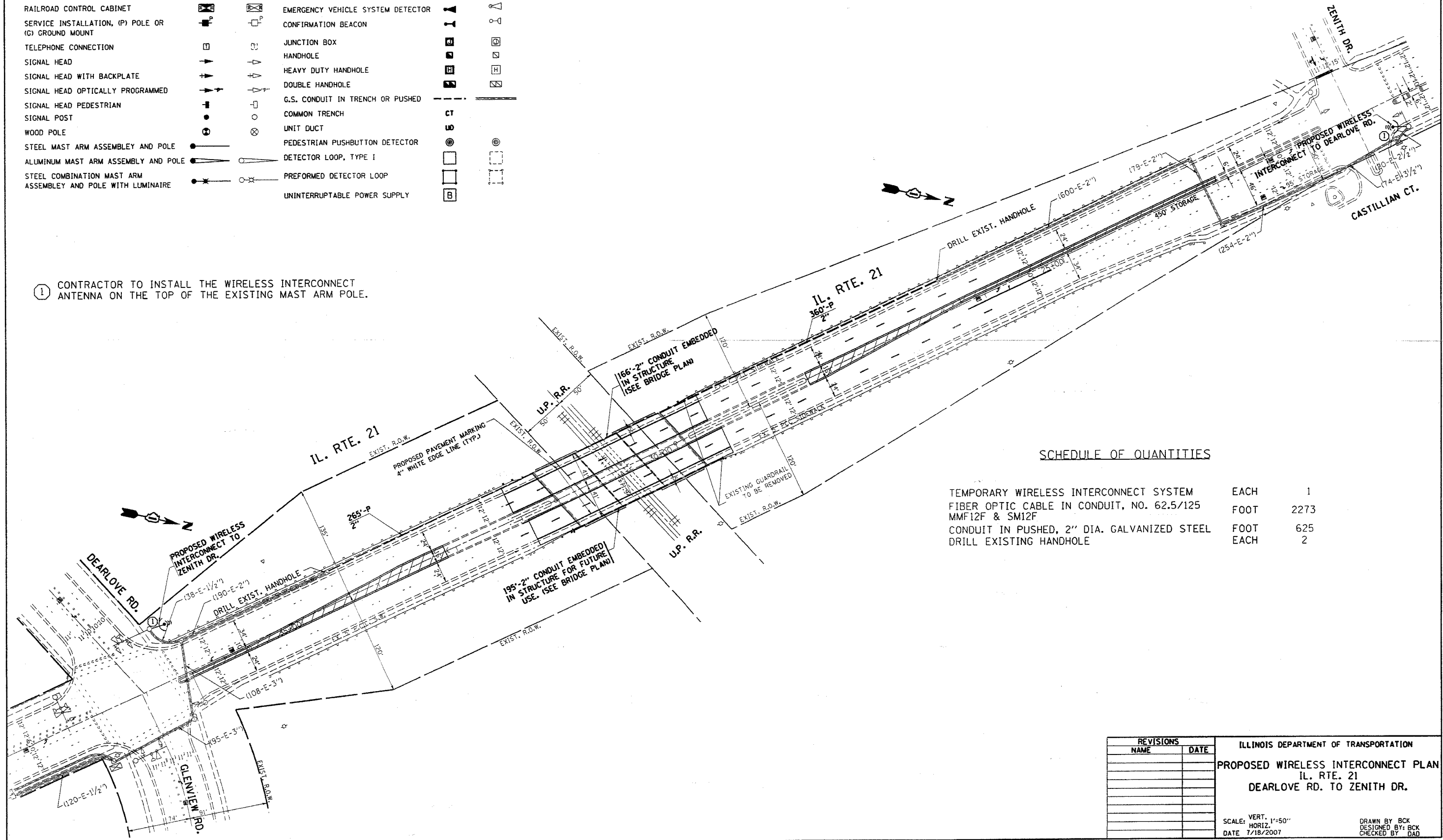

### SCHEDULE OF QUANTITIES

TEMPORARY WIRELESS INTERCONNECT SYSTEM	EACH	1
FIBER OPTIC CABLE IN CONDUIT, NO. 62.5/125 MMF12F & SM12F	FOOT	2273
CONDUIT IN PUSHED, 2" DIA. GALVANIZED STEEL	FOOT	625
DRILL EXISTING HANDHOLE	EACH	2

REVISIONS	
NAME	DATE

ILLINOIS DEPARTMENT OF TRANSPORTATION  
**PROPOSED WIRELESS INTERCONNECT PLAN**  
 IL. RTE. 21  
 DEARLOVE RD. TO ZENITH DR.

SCALE: VERT. 1"=50"  
 HORIZ. 1"=50"  
 DATE 7/18/2007

DRAWN BY BCK  
 DESIGNED BY BCK  
 CHECKED BY DAD