

IL. 19 (IRVING PARK RD.)

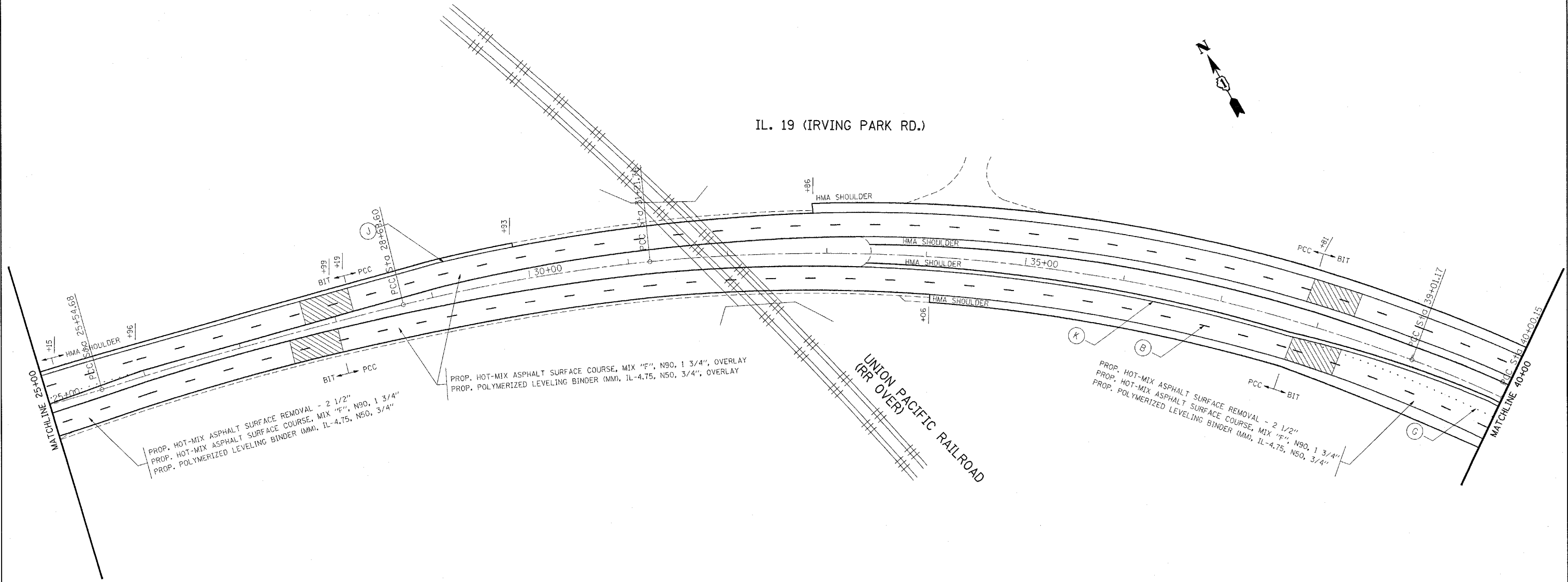

- (A) 6" WHITE - TURN LANE LINE (TYP.)
- (B) 4" WHITE - SKIP-DASH LINE (TYP.) (10' LINE/30' SPACE)
- (C) 8' WHITE - LETTERS & SYMBOLS (TYP.) (LEFT TURN ONLY, RIGHT TURN ONLY)
- (D) 24" SOLID WHITE - STOP LINES (TYP.)
- (E) 6" WHITE - CROSSWALK LINE (TYP.) (2 @ 6' C-C)
- (F) 4" YELLOW - DOUBLE YELLOW PAINTED MEDIAN (TYP.) (2 @ 11" C-C)
- (G) 6" WHITE - DOTTED LINE (TYP.) (2' LINE/6' SPACE)
- (H) 8" WHITE - PAINTED MEDIAN (TYP.)
- (I) 12" WHITE - 45° DIAGONAL (75' C-C OR MINIMUM OF 5)

FILE NAME =
 c:\projects\123887\sh_rdw.dgn

USER NAME = qureshiya
 PLOT SCALE = 50.0000 "/ IN.
 PLOT DATE = 11/5/2007

DESIGNED -
 DRAWN -
 CHECKED -
 DATE -

REVISED -
 REVISED -
 REVISED -
 REVISED -

STATE OF ILLINOIS
 DEPARTMENT OF TRANSPORTATION

SCALE: SHEET NO. OF SHEETS STA. 25+00 TO STA. 40+00

F.A.P. RTE.	SECTION	COUNTY	TOTAL SHEETS	SHEET NO.
345	3058 (A,B,C) RS-1	COOK	51	20
CONTRACT NO. 60C52				
FED. ROAD DIST. NO. ILLINOIS FED. AID PROJECT				