

FOR INDEX OF SHEETS, SEE SHEET NO. 2

FUNCTIONAL CLASSIFICATION: OTHER PRINCIPAL ARTERIAL  
 ADT: 22,500 (2005), 28,620 (2021)  
 DESIGN SPEED LIMIT: 40 MPH  
 POSTED SPEED LIMIT: 40 MPH

**SCOPE OF WORK**

THE BRIDGE SUPERSTRUCTURE WILL HAVE REPAIRS TO THE DECK AND TO THE JOINTS. THE OVERLAY WILL BE REMOVED AND REPLACED.

IMPROVEMENTS LOCATED IN THE TOWN OF LOCKPORT,  
 WILL COUNTY

STATE OF ILLINOIS  
 DEPARTMENT OF TRANSPORTATION  
 DIVISION OF HIGHWAYS  
**PROPOSED  
 HIGHWAY PLANS**

F.A.P. RTE. 351 / IL. RTE. 7  
 SECTION: 2007-025-I

IL. RTE. 7 OVER DES PLAINES RIVER, SANITARY & SHIP CANAL & A.T. & S.F. R.R.  
 S.N. 099-0185  
**BRIDGE DECK REPAIR & OVERLAY**  
**WILL COUNTY**  
 C-91-278-07

R 10 E

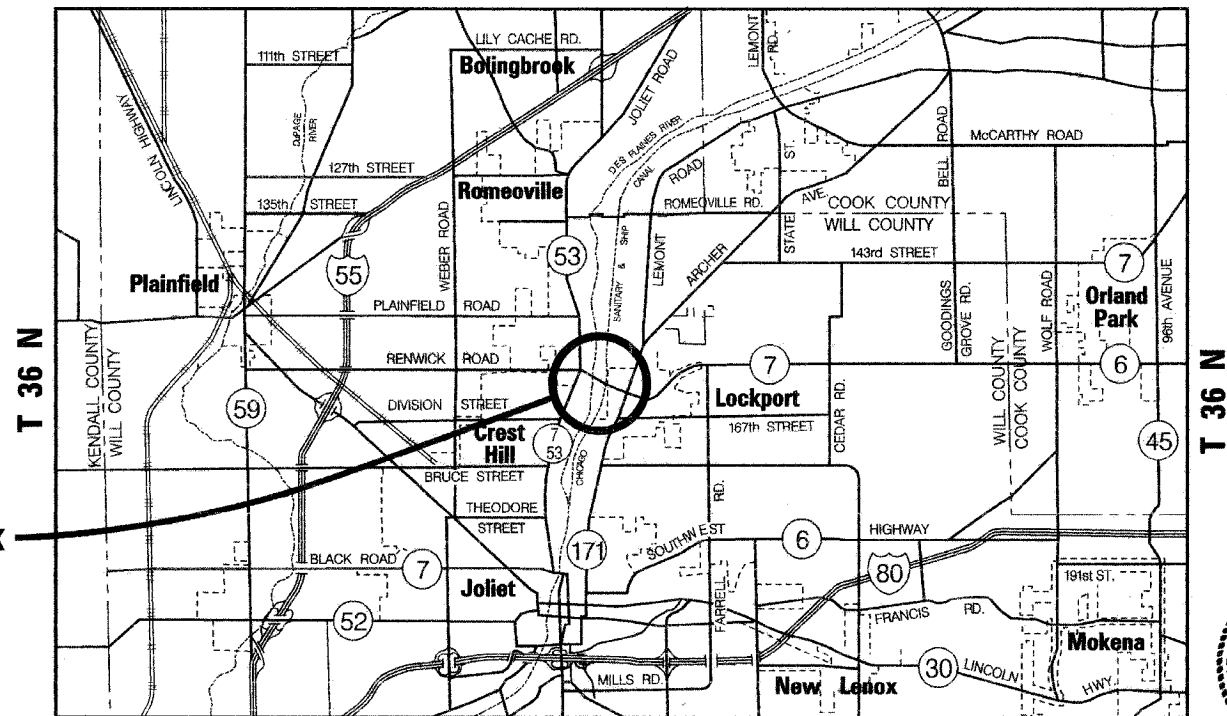

**LOCATION MAP**  
 NOT TO SCALE

LOCATION OF WORK  
 IL. RTE. 7  
 S.N. 099-0185

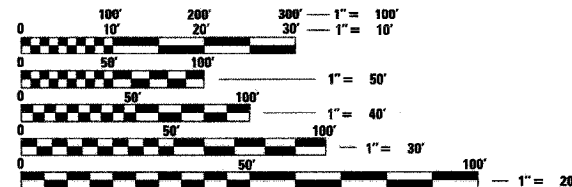

FULL SIZE PLANS HAVE BEEN PREPARED USING STANDARD ENGINEERING SCALES. REDUCED SIZED PLANS WILL NOT CONFORM TO STANDARD SCALES. IN MAKING MEASUREMENTS ON REDUCED PLANS, THE ABOVE SCALES MAY BE USED.

J.U.L.I.E.  
 JOINT UTILITY LOCATION INFORMATION FOR EXCAVATION  
 1-800-892-0123  
 C.U.A.N.  
 CHICAGO UTILITY ALERT NETWORK  
 1-312-744-7000

CONTRACT NO. 60C93

GROSS & NET LENGTH = 3,173 FT. = 0.60 MILES

F.A.P. RTE.	SECTION	COUNTY	TOTAL SHEETS	SHEET NO.
351	2007-025-I	WILL	18	1
STA.	TO STA.			
FED. ROAD DIST. NO.	ILLINOIS	FED. AID PROJECT		

CONTRACT NO. 60C93

D-91-278-07

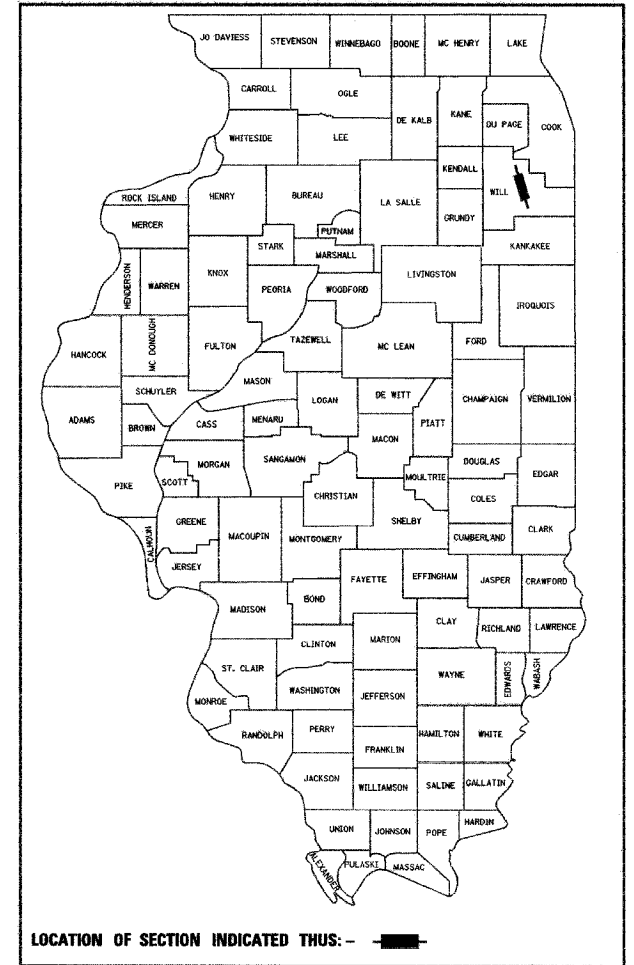

LOCATION OF SECTION INDICATED THUS: -



Bhadresh N. Shah  
 BHADRESH N. SHAH  
 LICENSED STRUCTURAL ENGINEER  
 STATE OF ILLINOIS LIC. No. 081-004476  
 EXPIRES: 11-30-08



CHRISTIAN-ROGE & ASSOCIATES, INC.  
 ENGINEERS / PLANNERS / SURVEYORS  
 211 W. WACKER DRIVE CHICAGO, IL. 60606  
 TELEPHONE: 312-372-2023

STATE OF ILLINOIS  
 DEPARTMENT OF TRANSPORTATION  
 DIVISION OF HIGHWAYS

SUBMITTED October 25 20 07

Biane O'Keefe  
 DEPUTY DIRECTOR OF HIGHWAYS, REGION ENGINEER  
 December 7, 20 07

Eric E. Haral  
 INTERIM ENGINEER OF DESIGN AND ENVIRONMENT  
 December 7, 20 07

Christine M. Reed  
 DIRECTOR OF HIGHWAYS, CHIEF ENGINEER

PRINTED BY THE AUTHORITY  
 OF THE STATE OF ILLINOIS

DISTRICT ONE - DESIGN PLAN PREPARATION ENGINEER:  
 J. DOMINGUEZ / RAGHUPATI SINHA (847) 705-4209

F.A.P. RTE.	SECTION	COUNTY	TOTAL SHEETS	SHEET NO.
351	2007-025-1	WILL	18	2
STA.		TO STA.		
FED. ROAD DIST. NO.	ILLINOIS	FED. AID PROJECT		

**CONTRACT NO. 60C93**

INDEX OF SHEETS

SHEET NO.	DESCRIPTION
1	COVER SHEET
2	INDEX OF SHEETS, LIST OF STATE STANDARDS, GENERAL NOTES, TRAFFIC CONTROL AND PROTECTION NOTES & RECOMMENDATIONS FOR LATEX CONCRETE OVERLAY PLACEMENT
3	SUMMARY OF QUANTITIES
4	PAVEMENT MARKING PLAN IL. RTE. 7
5	DETOUR PLAN
6	DETOUR PLAN - DETAILS 1
7	DETOUR PLAN - DETAILS 2
	<u>S.N. 099-0185</u>
8	GENERAL PLAN & ELEVATION
9	GENERAL PLAN & ELEVATION
10	DECK CONCRETE PATCHING
11	DECK CONCRETE PATCHING
12	DECK CONCRETE PATCHING
13	JOINT RESEALING DETAILS
14	TYPICAL APPLICATIONS RAISED REFLECTIVE PAVEMENT MARKERS (SNOW-PLOW RESISTANT) (TC11)
15	DISTRICT ONE TYPICAL PAVEMENT MARKINGS (TC13)
16	TEMPORARY INFORMATION SIGNING
17	PAVEMENT MARKING LETTERS AND SYMBOLS FOR TRAFFIC STAGING (TC16)
18	TYPICAL MARKING FOR CLOSING STATE HIGHWAYS (TC 21)

LIST OF STATE STANDARDS

STANDARD NO.	DESCRIPTION
000001-05	STANDARD SYMBOLS, ABBREVIATIONS AND PATTERNS
<u>701901</u>	TRAFFIC CONTROL DEVICES

GENERAL NOTES

1. THESE PLANS HAVE BEEN PREPARED FROM NOTES RECEIVED FROM I.D.O.T. FIELD MAINTENANCE ENGINEERS.
2. THE RESIDENT ENGINEER SHALL CONTACT THE AREA TECHNICIAN TWO (2) WEEKS PRIOR TO THE PLACEMENT OF PERMANENT PAVEMENT MARKINGS.
3. ALL PAVEMENT MARKINGS AND RAISED REFLECTORS AFFECTED BY THE BRIDGE REPAIRS SHALL BE REPLACED. NOMINAL QUANTITIES HAVE BEEN INCLUDED IN THE CONTRACT FOR THIS WORK.
4. THE CONTRACTOR WILL NOT BE ALLOWED TO SET UP A YARD OR FIELD OFFICE ON STATE PROPERTY WITHOUT WRITTEN PERMISSION FROM THE DEPARTMENT.
5. DO NOT SCALE THESE PLANS FOR CONSTRUCTION PURPOSES.
6. WHEN ARTIFICIAL LIGHTING IS UTILIZED IN NIGHT OPERATIONS, THE CONTRACTOR MUST EXERCISE THE UTMOST PRECAUTIONS IN PREVENTIVE ADVERSE VISIBILITY TO THE MOTORING PUBLIC AND TO THE ADJOINING RESIDENTIAL AREAS.
7. PLAN DIMENSIONS AND DETAILS RELATIVE TO EXISTING PLANS ARE SUBJECT TO ROUTINE VARIATIONS. THE CONTRACTOR SHALL FIELD VERIFY EXISTING DIMENSIONS AND DETAILS AFFECTING NEW CONSTRUCTION AND MAKE NECESSARY APPROVED ADJUSTMENTS PRIOR TO CONSTRUCTION OR ORDERING OF MATERIALS. SUCH VARIATIONS SHALL NOT BE CAUSE FOR ADDITIONAL COMPENSATION FOR A CHANGE IN SCOPE OF THE WORK, HOWEVER, THE CONTRACTOR WILL BE PAID FOR THE QUANTITY ACTUALLY FURNISHED BASED UPON THE UNIT PRICE BID FOR THE WORK.

TRAFFIC CONTROL AND PROTECTION NOTES

1. THE RESIDENT ENGINEER SHALL CONTACT THE TRAFFIC CONTROL SUPERVISOR AT (847) 705-4470 AT LEAST 72 HOURS PRIOR TO INSTALLATION OF THE TEMPORARY TRAFFIC CONTROL DEVICES.
2. THE CONTRACTOR SHALL NOTIFY THE CITY OF LOCKPORT, THE CITY OF JOLIET AND THE CITY OF CREST HILL ONE WEEK PRIOR TO THE SET-UP OF THE DETOUR.
3. THE TRAFFIC CONTROL DEVICES AND MEASURES AS SHOWN ON THE PLANS, THE APPROPRIATE STANDARDS AND/OR THOSE DEEMED NECESSARY SHALL BE INCLUDED IN THE PAY ITEM FOR "TRAFFIC CONTROL AND PROTECTION FOR TEMPORARY DETOUR."
4. THE TEMPORARY INFORMATION SIGNING AND CHANGEABLE MESSAGE SIGN SHALL BE PLACED PRIOR TO THE DETOUR SIGNING.
5. THE LANE CLOSURES AND TEMPORARY PAVEMENT MARKINGS SHALL BE SET-UP AFTER THE DETOUR SIGNING HAS BEEN INSTALLED.

SCOPE OF WORK:

1. REMOVE THE EXISTING 2 1/2" MICROSILICA CONCRETE OVERLAY AND HYDRO-SCARIFY AN ADDITIONAL 1/2" OF THE CONCRETE DECK SLAB
2. MARK AREAS OF FULL DEPTH REMOVAL AND PERFORM FULL DEPTH DECK PATCHING.
3. PERFORM REPAIRS TO PARAPETS
4. REPLACE EXISTING PREFORMED JOINT SEALER AT THE EAST ABUTMENT WITH A SILICONE JOINT SEALER 2 3/4". RE-USE EXISTING STEEL ARMOR
5. PLACE A 3" LATEX CONCRETE OVERLAY
6. PATCH EAST APPROACH SLAB APPROXIMATELY 2 FEET ADJACENT TO THE PREFORMED EXPANSION JOINT WITH CONCRETE

RECOMMENDATIONS FOR LATEX CONCRETE OVERLAY PLACEMENT:

1. A 4" SLUMP IS PREFERED FOR THE LATEX CONCRETE OVERLAY.
2. USE CONVEYORS TO PLACE THE LATEX CONCRETE OVERLAY.
3. IF THE USE OF CONVEYORS ARE NOT POSSIBLE WHEN PLACING THE LATEX CONCRETE OVERLAY THEN USE THE DIRECT TRUCKING METHOD.
4. THE PUMPING METHOD FOR PLACING THE LATEX CONCRETE OVERLAY IS NOT ALLOWED.
5. USE COMPLETE LANE CLOSURE DURING PLACEMENT OF THE LATEX CONCRETE OVERLAY

REVISIONS	
NAME	DATE

ILLINOIS DEPARTMENT OF TRANSPORTATION

INDEX OF SHEETS,  
LIST OF STATE STANDARDS, GENERAL NOTES,  
TRAFFIC CONTROL AND PROTECTION NOTES &  
RECOMMENDATIONS FOR LATEX CONCRETE  
OVERLAY PLACEMENT  
IL. RTE. 7

SCALE: NONE  
DATE: OCTOBER 26, 2007

DRAWN BY: D.L./F.M.  
CHECKED BY: B.N.S./S.J.P.

**CHRISTIAN-ROGE & ASSOC., INC.**  
CHICAGO ILLINOIS

Rev.



F.A.P. RTE.	SECTION	COUNTY	TOTAL SHEETS	SHEET NO.
351	2007-025-I	WILL	18	4
STA.		TO STA.		
FED. ROAD DIST. NO.	ILLINOIS	FED. AID PROJECT		

**CONTRACT NO. 60C93**

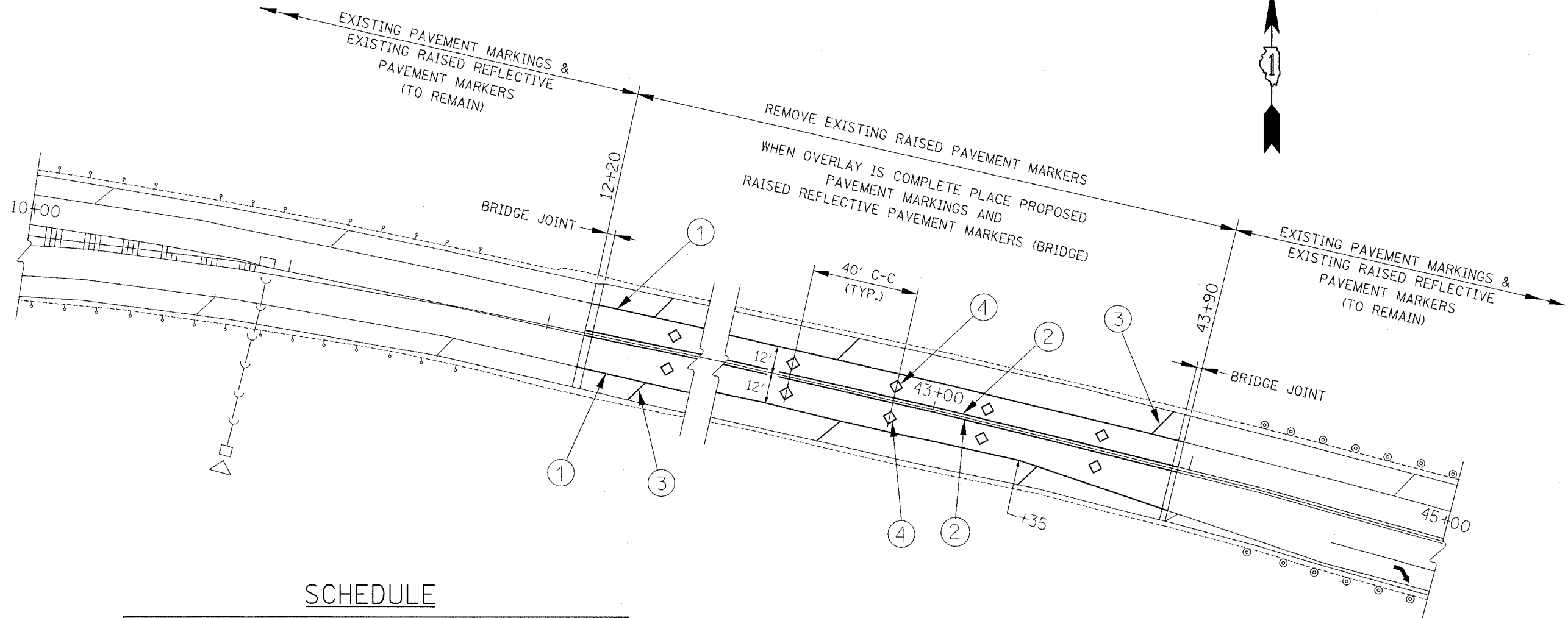

**SCHEDULE**

PROPOSED PAVEMENT MARKING		
DESCRIPTION	UNIT	QUANTITY
RAISED REFLECTIVE PAVEMENT MARKERS 2 - WAY AMBER	EACH	160
EPOXY PAVEMENT MARKING, 4" 2 - WHITE LINES	FOOT	6,340
EPOXY PAVEMENT MARKING, 4" 2 - YELLOW LINES	FOOT	6,340
EPOXY PAVEMENT MARKING, 12" 45° DIAGONALS	FOOT	1,246

**NOTE:**  
ALL PAVEMENT MARKINGS SHALL BE EPOXY.

**LEGEND**

- ① 4" WHITE EDGE LINE
- ② 2 - 4" YELLOW EDGE LINE @ 11" C-C
- ③ 12" WHITE DIAGONAL @ 75' C-C
- ④ RAISED REFLECTIVE PAVEMENT MARKERS (BRIDGE)  
2 - 2 WAY AMBER @ 40' C-C

REVISIONS	
NAME	DATE

ILLINOIS DEPARTMENT OF TRANSPORTATION

**PAVEMENT MARKING PLAN  
IL. RTE. 7**

SCALE: NONE  
DATE: OCTOBER 26, 2007

DRAWN BY: D.L./F.M.  
CHECKED BY: B.N.S./S.J.P.

**CHRISTIAN-ROGE & ASSOC., INC.**  
CHICAGO ILLINOIS

ILLINOIS DEPARTMENT OF TRANSPORTATION

F.A.P. RTE.	SECTION	COUNTY	TOTAL SHEETS	SHEET NO.
351	2007-025-I	WILL	18	5
STA.		TO STA.		
FED. ROAD DIST. NO.		ILLINOIS	FED. AID PROJECT	

**CONTRACT NO. 60C93**



- |                          |                          |                            |                            |                       |                          |
|--------------------------|--------------------------|----------------------------|----------------------------|-----------------------|--------------------------|
| <br>C24-14<br>(48 x 48)  | <br>C24-13<br>(48 x 48)  | <br>C24-12<br>(48 x 48)    |                            |                       |                          |
| <br>M1-1100<br>(24 x 24) | <br>M3-2<br>(21 x 9)     | <br>M3-4<br>(21 x 9)       |                            |                       |                          |
| <br>M4-8<br>(24 x 12)    | <br>M4-8a<br>(24 x 18)   | <br>M4-110(R)<br>(48 x 18) | <br>M4-110(L)<br>(48 x 18) |                       |                          |
| <br>M5-1(R)<br>(21 x 15) | <br>M5-1(L)<br>(21 x 15) | <br>M6-1(R)<br>(21 x 15)   | <br>M6-1(L)<br>(21 x 15)   | <br>M6-3<br>(21 x 15) | <br>M6-2(R)<br>(21 x 15) |
| <br>R3-7(R)<br>(30 x 30) | <br>R11-2<br>(48 x 30)   | <br>R11-4<br>(60 x 30)     | <br>W21-1102<br>(60 x 30)  |                       |                          |

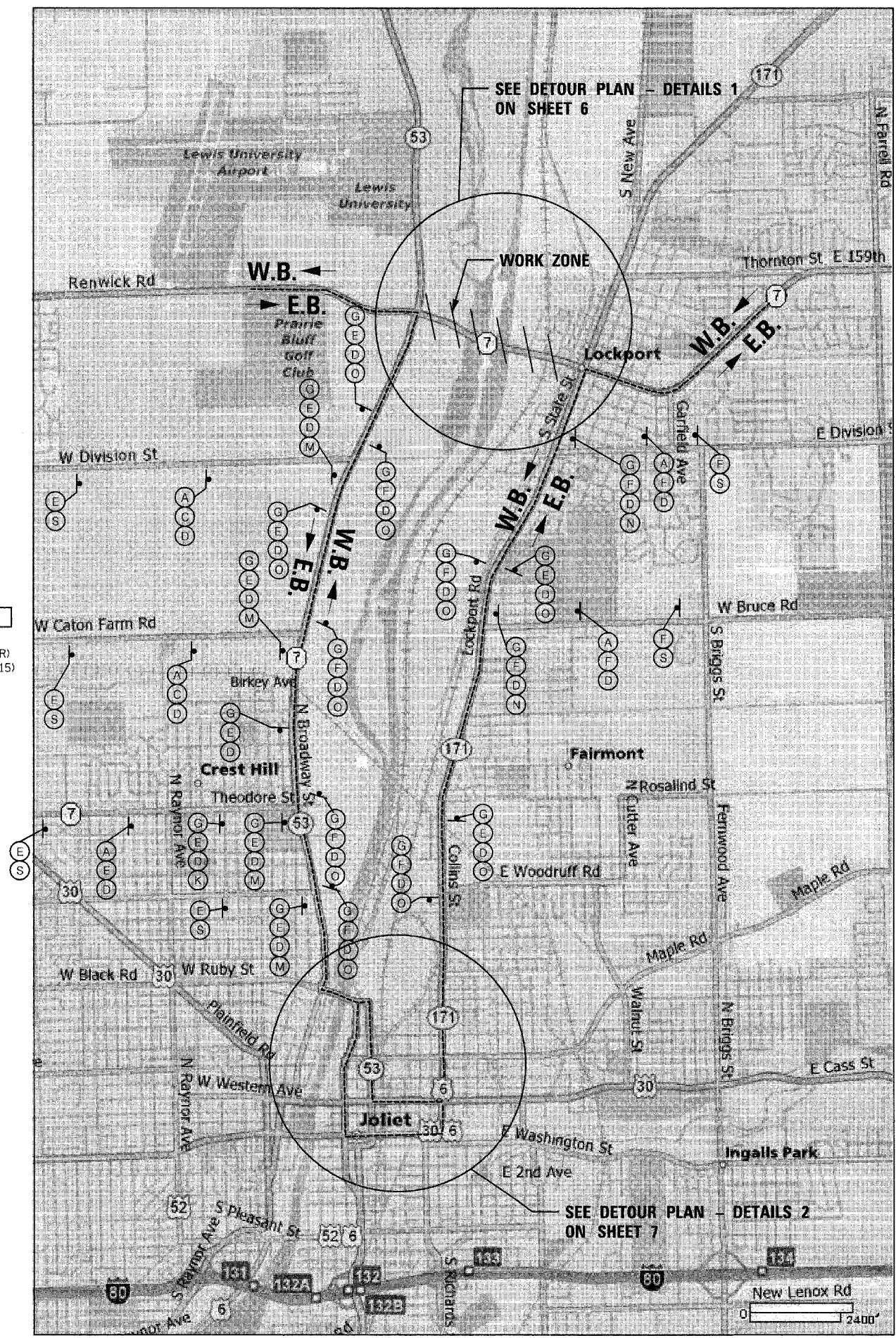

- NOTES:**
- ALL DIMENSIONS ARE SHOWN IN INCHES.
  - ALL DETOUR SIGNS ARE TO BE INCLUDED IN THE COST OF "TRAFFIC CONTROL AND PROTECTION FOR TEMPORARY DETOUR" EXCEPT FOR SIGN (S). SIGN (S) IS PAID FOR AS "TEMPORARY INFORMATION SIGNING."
  - ONE VARIABLE MESSAGE SIGN SHALL BE PLACED ON THE WEST APPROACH AND ONE ON THE EAST APPROACH OF THE BRIDGE AT LEAST ONE (1) MONTH PRIOR TO THE CLOSING OF THE BRIDGE.

ILLINOIS DEPARTMENT OF TRANSPORTATION

**DETOUR PLAN  
IL. RTE. 7**

REVISIONS	
NAME	DATE

SCALE: NONE  
DATE: NOVEMBER 13, 2007  
DRAWN BY: D.L./F.M.  
CHECKED BY: B.N.S./S.J.P.  
**CHRISTIAN-ROGE & ASSOC., INC.**  
CHICAGO ILLINOIS

11/13/2007 11:28:45 AM



F.A.P. RTE.	SECTION	COUNTY	TOTAL SHEETS	SHEET NO.
351	2007-025-I	WILL	18	6
STA.		TO STA.		
FED. ROAD DIST. NO.		ILLINOIS	FED. AID PROJECT	

**CONTRACT NO. 60C93**

NORTHWIND CONCRETE PRODUCTS  
 LOCKPORT SHOP REPAIR FACILITY  
 LOCKPORT POWERHOUSE MWRDGC  
 ROCKS, ETC.



**SCHEDULE**

PAVEMENT MARKING TAPE, TYPE III 4"	
LOCATION	LENGTH
CANAL STREET	100'
IL. RTE. 53 - N.B. RT. TURN	300'
IL. RTE. 53 - S.B. LT. TURN	250'
<b>TOTAL</b>	<b>650'</b>

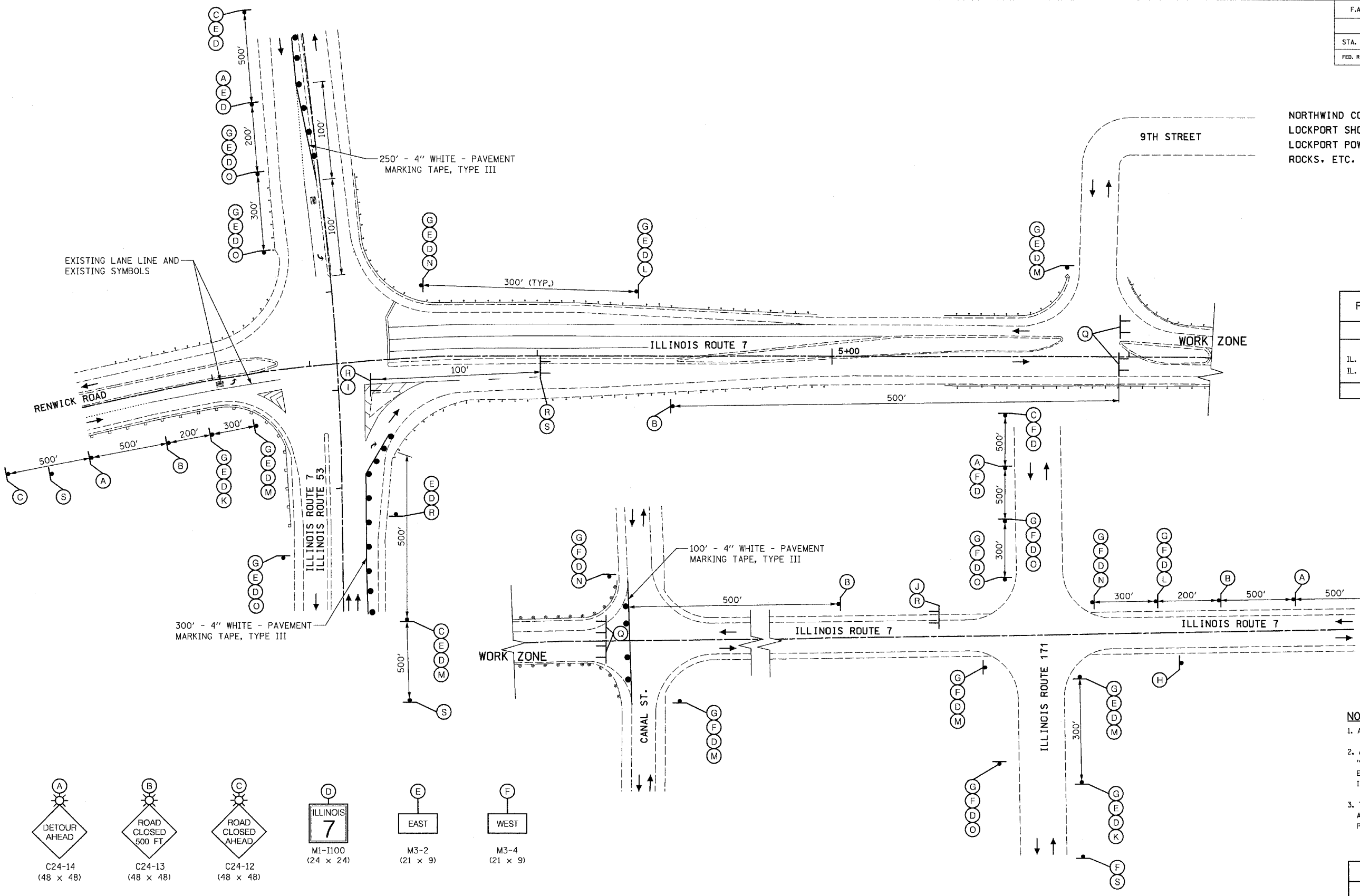

**LEGEND**

- TYPE III BARRICADES
- TEMPORARY SIGN
- TRAFFIC DIRECTION
- DRUMS/BARRICADES TYPE II WITH STEADY-BURN LIGHTS @ 25' C-C

**NOTES:**

1. ALL DIMENSIONS ARE SHOWN IN INCHES.
2. ALL DETOUR SIGNS ARE TO BE INCLUDED IN THE COST OF "TRAFFIC CONTROL AND PROTECTION FOR TEMPORARY DETOUR" EXCEPT FOR SIGN (S). SIGN (S) IS PAID FOR AS "TEMPORARY INFORMATION SIGNING."
3. THE TRAFFIC CONTROL AND PROTECTION AT ILLINOIS ROUTE 7 AND ILLINOIS ROUTE 53 SHALL BE INCLUDED IN THE LUMP SUM PRICE FOR "TEMPORARY CONTROL AND PROTECTION FOR DETOUR".

 C24-14 (48 x 48)	 C24-13 (48 x 48)	 C24-12 (48 x 48)	 M1-I100 (24 x 24)	 M3-2 (21 x 9)	 M3-4 (21 x 9)
 M4-8 (24 x 12)	 M4-8a (24 x 18)	 M4-110(R) (48 x 18)	 M4-110(L) (48 x 18)	 M5-1(R) (21 x 15)	 M5-1(L) (21 x 15)
 M6-1(R) (21 x 15)	 M6-1(L) (21 x 15)	 M6-3 (21 x 15)	 R3-7(R) (30 x 30)	 R11-2 (48 x 30)	 R11-4 (60 x 30)
			 W21-I102 (60 x 30)		

REVISIONS	
NAME	DATE

ILLINOIS DEPARTMENT OF TRANSPORTATION

**DETOUR PLAN - DETAILS 1**  
IL. RTE. 7

SCALE: NONE  
 DATE: NOVEMBER 13, 2007

DRAWN BY: D.L./F.M.  
 CHECKED BY: B.N.S./S.J.P.

**CHRISTIAN-ROGE & ASSOC., INC.**  
CHICAGO ILLINOIS

F.A.P. RTE.	SECTION	COUNTY	TOTAL SHEETS	SHEET NO.
351	2007-025-I	WILL.	18	7
STA.		TO STA.		
FED. ROAD DIST. NO.	ILLINOIS	FED. AID PROJECT		

**CONTRACT NO. 60C93**



- A  
DETOUR AHEAD  
C24-14  
(48 x 48)
- B  
ROAD CLOSED 500 FT  
C24-13  
(48 x 48)
- C  
ROAD CLOSED AHEAD  
C24-12  
(48 x 48)
- D  
ILLINOIS 7  
M1-1100  
(24 x 24)
- E  
EAST  
M3-2  
(21 x 9)
- F  
WEST  
M3-4  
(21 x 9)
- G  
DETOUR  
M4-8  
(24 x 12)
- H  
END DETOUR  
M4-8a  
(24 x 18)
- I  
DETOUR  
M4-110(R)  
(48 x 18)
- J  
DETOUR  
M4-110(L)  
(48 x 18)
- K  
M5-1(R)  
(21 x 15)
- L  
M5-1(L)  
(21 x 15)
- M  
M6-1(R)  
(21 x 15)
- N  
M6-1(L)  
(21 x 15)
- O  
M6-3  
(21 x 15)
- T  
M6-2(R)  
(21 x 15)
- P  
RIGHT LANE MUST TURN RIGHT  
R3-7(R)  
(30 x 30)
- Q  
ROAD CLOSED  
R11-2  
(48 x 30)
- R  
ROAD CLOSED TO THRU TRAFFIC  
R11-4  
(60 x 30)
- S  
ILLINOIS ROUTE 7 BRIDGE OUT USE DETOUR  
W21-1102  
(60 x 30)

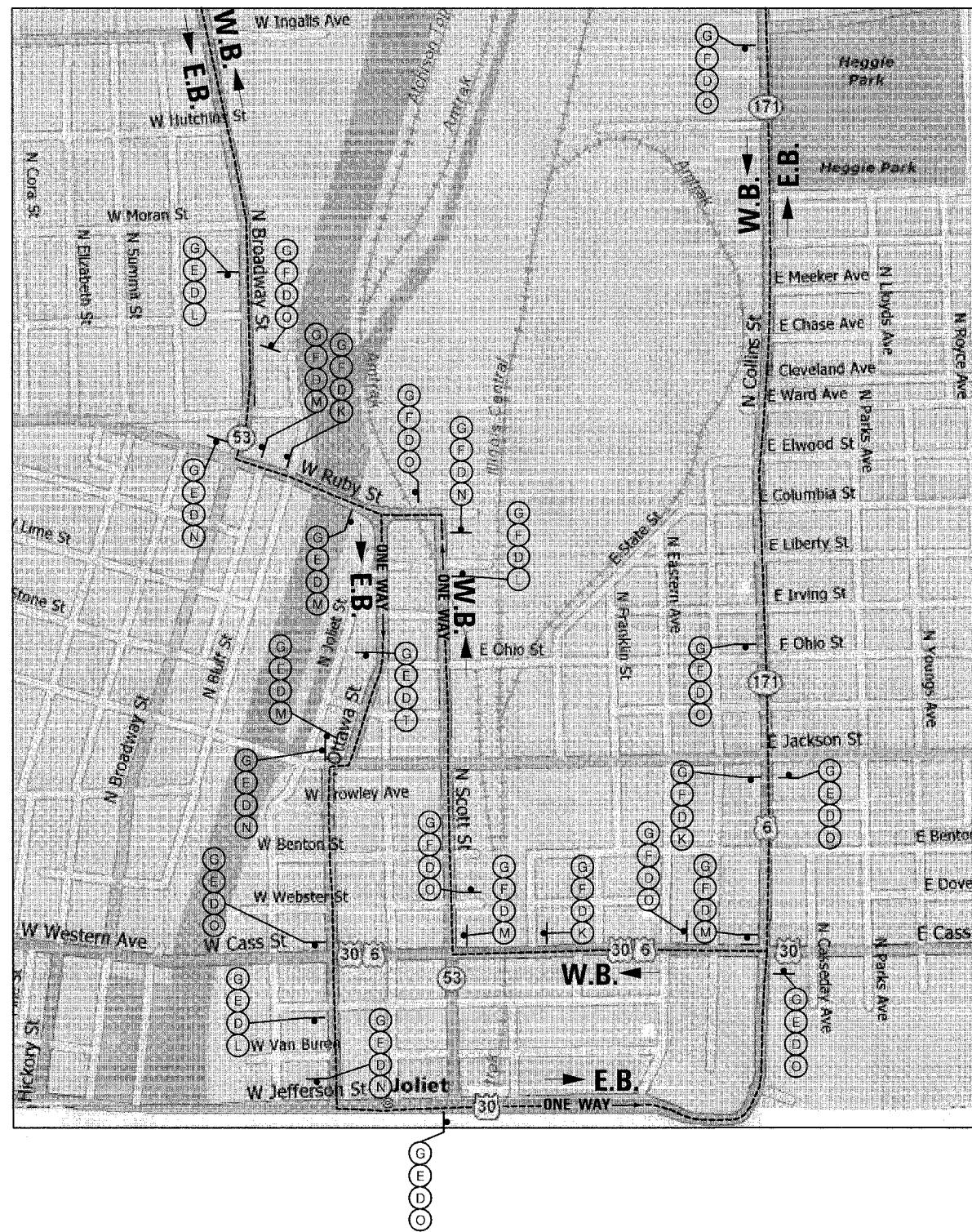

- NOTES:**
- ALL DIMENSIONS ARE SHOWN IN INCHES.
  - ALL DETOUR SIGNS ARE TO BE INCLUDED IN THE COST OF "TRAFFIC CONTROL AND PROTECTION FOR TEMPORARY DETOUR" EXCEPT FOR SIGN (S). SIGN (S) IS PAID FOR AS "TEMPORARY INFORMATION SIGNING."

REVISIONS	
NAME	DATE

ILLINOIS DEPARTMENT OF TRANSPORTATION

**DETOUR PLAN - DETAILS 2**  
IL. RTE. 7

SCALE: NONE  
DATE: NOVEMBER 13, 2007

DRAWN BY: D.L./F.M.  
CHECKED BY: B.N.S./S.J.P.

**CHRISTIAN-ROGE & ASSOC., INC.**  
CHICAGO ILLINOIS

11/13/2007 11:27:10 AM





F.A.P. RTE.	SECTION	COUNTY	TOTAL SHEETS	SHEET NO.
351	2007-025-I	WILL	18	9
STA.		TO STA.		
FED. ROAD DIST. NO.		ILLINOIS	FED. AID PROJECT	

**CONTRACT NO. 60C93**

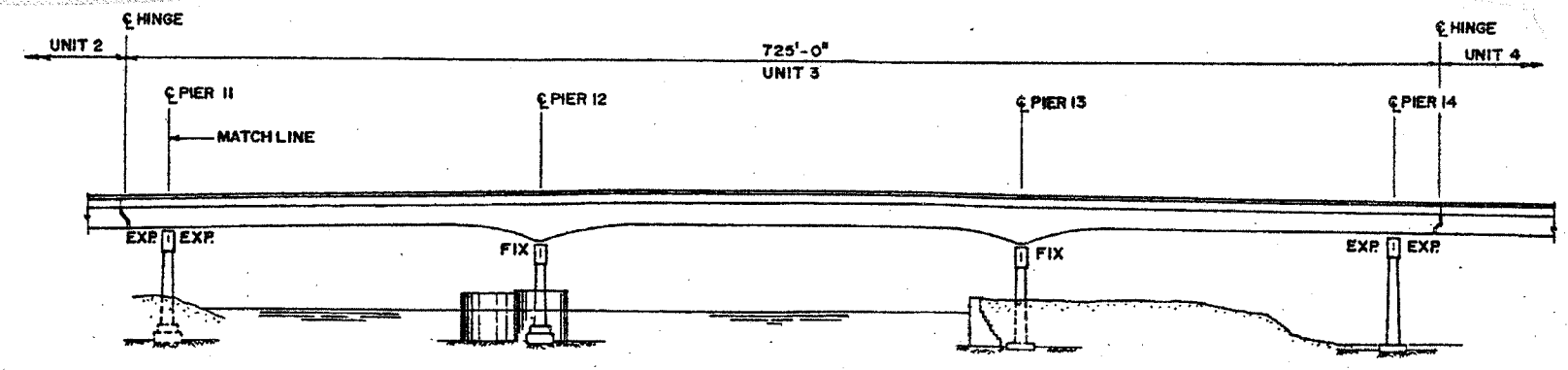

**ELEVATION**

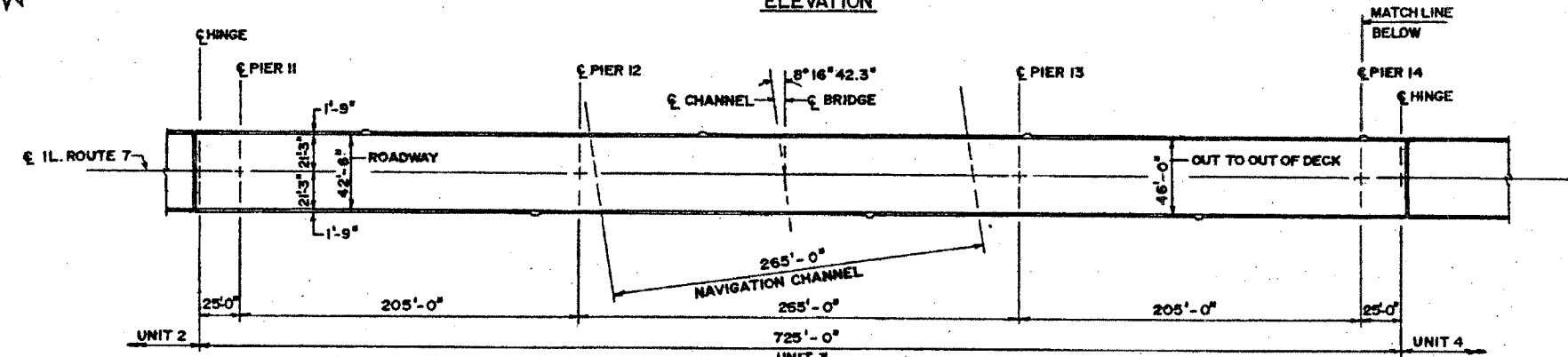

**PLAN**

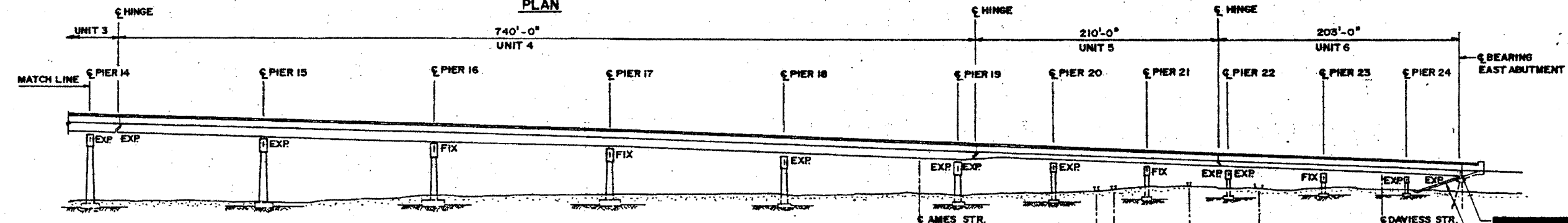

**ELEVATION**

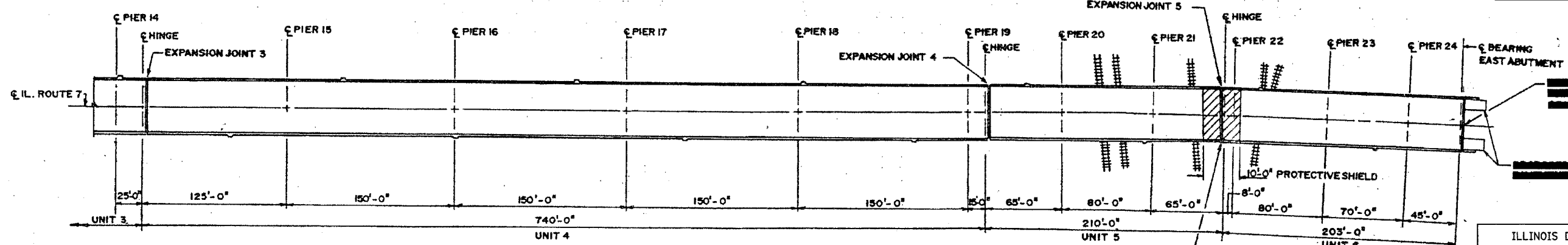

**PLAN**

REVISIONS	
NAME	DATE

ILLINOIS DEPARTMENT OF TRANSPORTATION  
 GENERAL PLAN & ELEVATION  
 IL. RTE. 7  
 OVER  
 DES PLAINES RIVER, RAILROAD  
 F.A.P. RTE. 351 SECTION: 2007-025-I  
 WILL COUNTY  
 STRUCTURE NO. 099-0185  
 SCALE: NONE DRAWN BY: D.L./F.M.  
 DATE: OCTOBER 26, 2007 CHECKED BY: B.N.S./S.J.P.  
**CHRISTIAN-ROGE & ASSOC., INC.**  
 CHICAGO ILLINOIS

PARAPET REPAIR:  
 (STRUCTURAL REPAIR OF CONCRETE LESS THAN 5")  
 SHEET 10 = 288 SF  
 SHEET 11 = 517 SF  
 SHEET 12 = 350 SF  
 TOTAL 1,155 SF

F.A.P. RTE.	SECTION	COUNTY	TOTAL SHEETS	SHEET NO.
351	2007-025-1	WILL	18	10
STA.		TO STA.		
FED. ROAD DIST. NO.		ILLINOIS	FED. AID PROJECT	

CONTRACT NO. 60C93

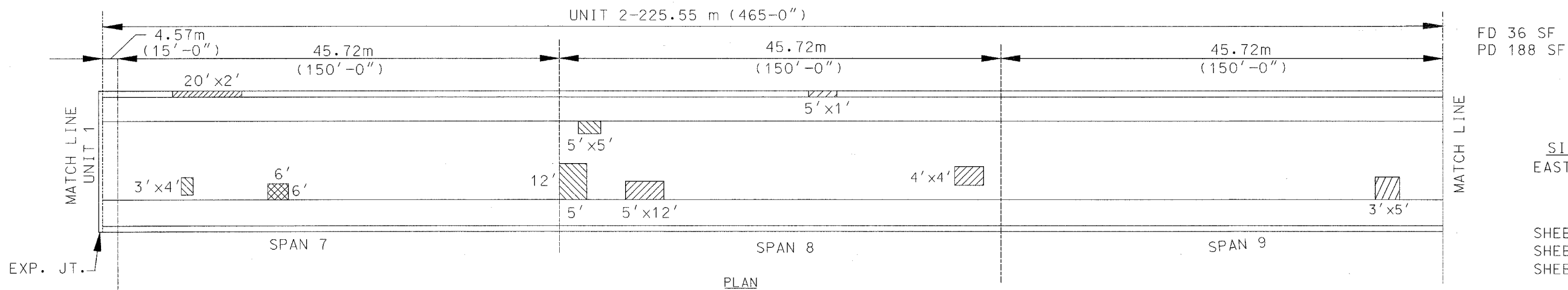
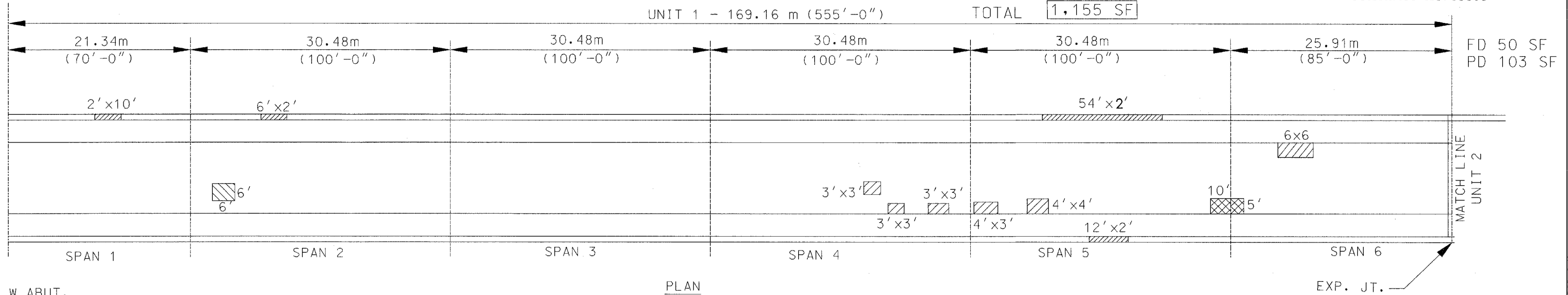

SILICON JOINT SEAL:  
 EAST ABUTMENT = 46 LF

FULL DEPTH PATCHES  
 SHEET 10 SUB-TOTAL = 211 SF  
 SHEET 11 SUB-TOTAL = 889 SF  
 SHEET 12 SUB-TOTAL = 410 SF

TOTAL 1,510 SF = 168 SY

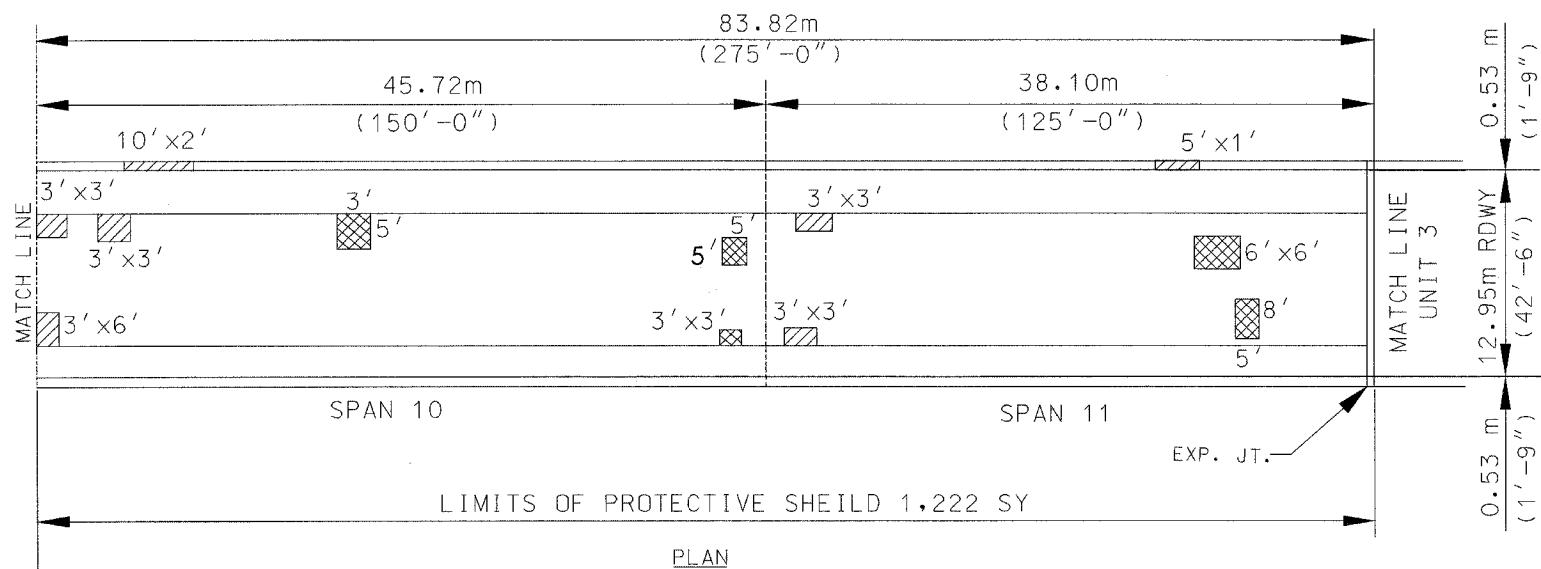

LEGEND:  
 \* PARTIAL DEPTH (PD) FD 125 SF PD 54 SF  
 \* FULL DEPTH (FD)  
 \* DECK SLAB PARTIAL DEPTH REPAIR PATCHES ARE SHOWN FOR INFORMATION ONLY

TOTAL AREA OF HYDRO SCARIFICATION AND LATEX CONCRETE OVERLAY 14,900 SY

PARTIAL DEPTH  
 SHEET 10 = 345 SF  
 SHEET 11 = 786 SF  
 SHEET 12 = 176 SF  
 TOTAL 1,307 SF = 146 SY

REVISIONS	
NAME	DATE

ILLINOIS DEPARTMENT OF TRANSPORTATION  
 DECK CONCRETE PATCHING  
 IL. RTE. 7  
 OVER  
 DES PLAINES RIVER, RAILROAD  
 F.A.P. RTE. 351 SECTION: 2007-025-1  
 WILL COUNTY  
 STRUCTURE NO. 099-0185

SCALE: NONE  
 DATE: OCTOBER 26, 2007  
 DRAWN BY: D.L./F.M.  
 CHECKED BY: B.N.S./S.J.P.

CHRISTIAN-ROGE & ASSOC., INC.  
 CHICAGO ILLINOIS

F.A.P. RTE.	SECTION	COUNTY	TOTAL SHEETS	SHEET NO.
351	2007-025-I	WILL	18	11
STA.		TO STA.		
FED. ROAD DIST. NO.		ILLINOIS	FED. AID PROJECT	

**CONTRACT NO. 60C93**

FD 399 SF  
PD 433 SF

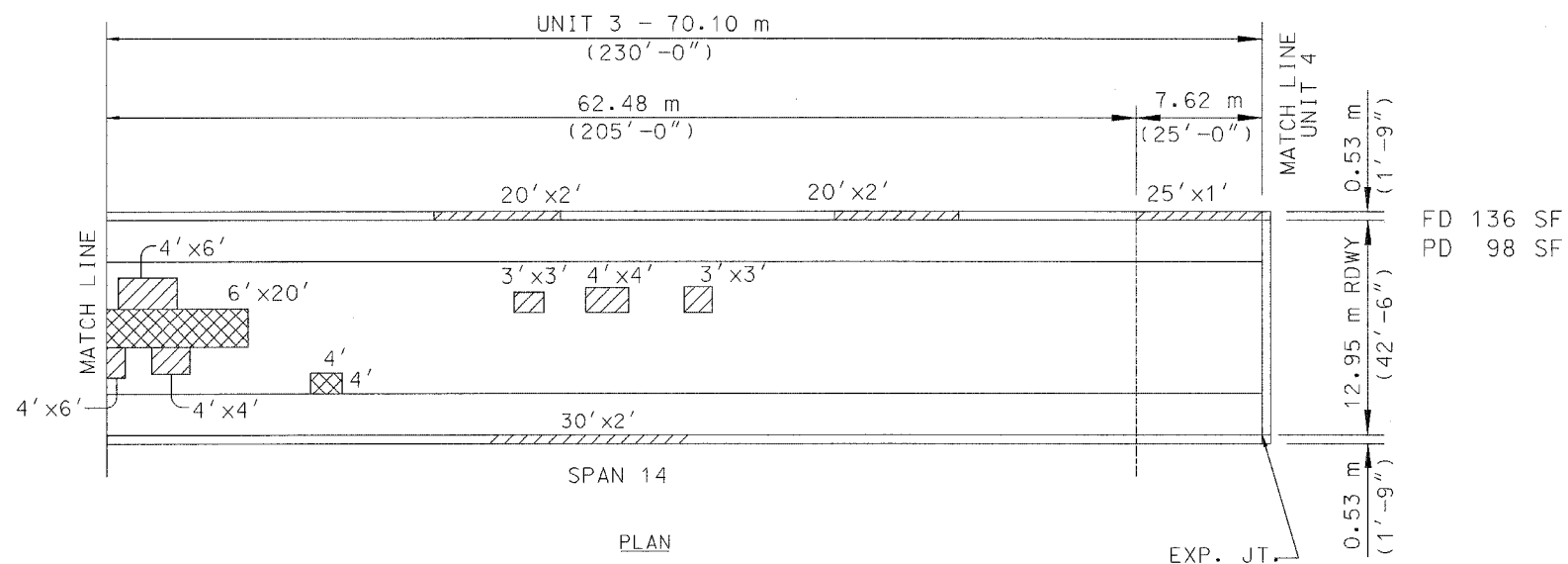
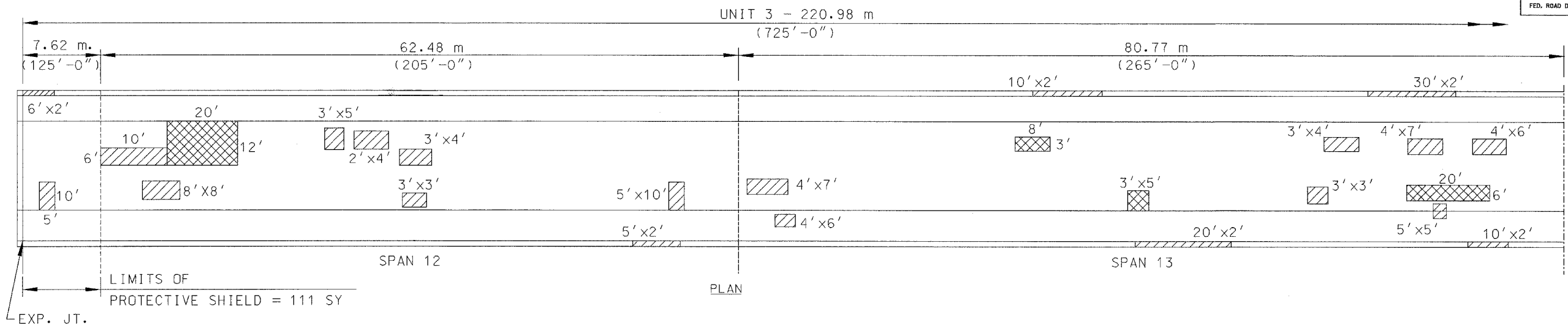

**LEGEND:**

- \* PARTIAL DEPTH (PD)
- \* FULL DEPTH (FD)

\* DECK SLAB PARTIAL DEPTH REPAIR PATCHES ARE SHOWN FOR INFORMATION ONLY

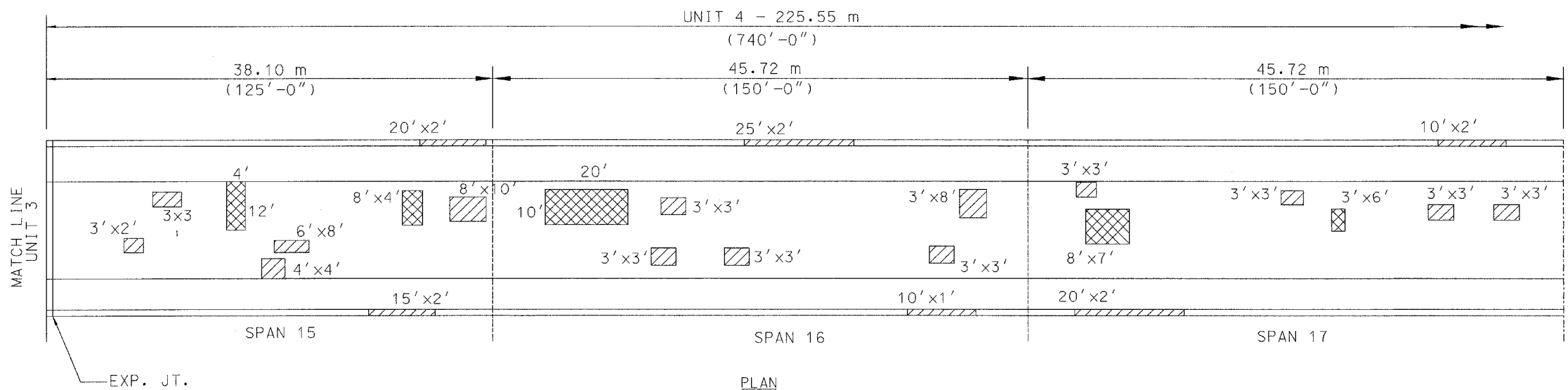

REVISIONS	
NAME	DATE

ILLINOIS DEPARTMENT OF TRANSPORTATION

DECK CONCRETE PATCHING  
IL. RTE. 7  
OVER  
DES PLAINES RIVER, RAILROAD  
F.A.P. RTE. 351 SECTION: 2007-025-I  
WILL COUNTY  
STRUCTURE NO. 099-0185

SCALE: NONE DRAWN BY: D.L./F.M.  
DATE: OCTOBER 26, 2007 CHECKED BY: B.N.S./S.J.P.

CHRISTIAN-ROGE & ASSOC., INC.  
CHICAGO ILLINOIS



F.A.P. RTE.	SECTION	COUNTY	TOTAL SHEETS	SHEET NO.
351	2007-025-I	WILL	18	13
STA.		TO STA.		
FED. ROAD DIST. NO.	ILLINOIS	FED. AID PROJECT		

**CONTRACT NO. 60C93**

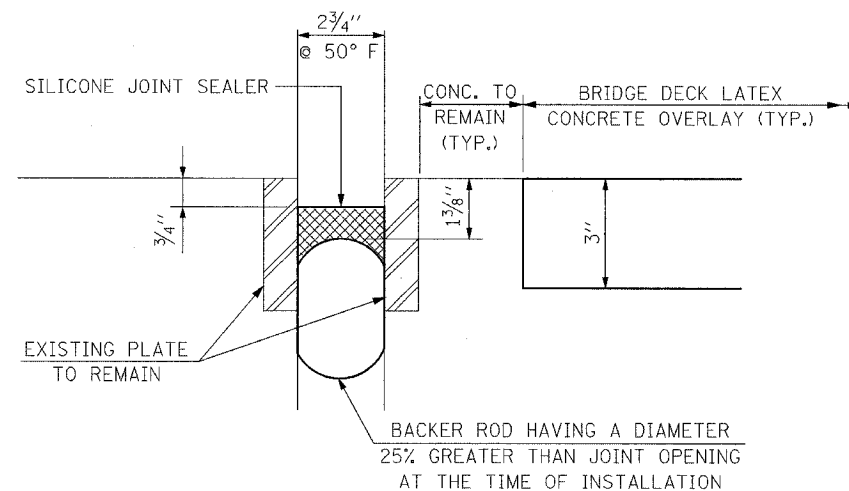

**PROPOSED SECTION**

**AT EAST ABUTMENT**

EXISTING PREFORMED JOINT SEAL-TRANVERSE EXPANSION JOINT-  
(TO BE REMOVED)

**NOTES:**

1. PLAN DIMENSIONS AND DETAILS RELATIVE TO EXISTING PLANS ARE SUBJECT TO ROUTINE VARIATIONS. THE CONTRACTOR SHALL FIELD VERIFY EXISTING DIMENSIONS AND DETAILS AFFECTING NEW CONSTRUCTION AND MAKE NECESSARY APPROVED ADJUSTMENTS PRIOR TO CONSTRUCTION OR ORDERING OF MATERIALS. SUCH VARIATIONS SHALL NOT BE CAUSE FOR ADDITIONAL COMPENSATION FOR A CHANGE IN SCOPE OF THE WORK, HOWEVER, THE CONTRACTOR WILL BE PAID FOR THE QUANTITY ACTUALLY FURNISHED BASED UPON THE UNIT PRICE BID FOR THE WORK.
2. COST FOR REMOVAL OF EXISTING JOINT IS INCLUDED IN THE COST OF SILICONE JOINT SEALER.

LOCATION	LENGTH OF SILICONE JOINT SEALER
EAST ABUTMENT	46'-0"

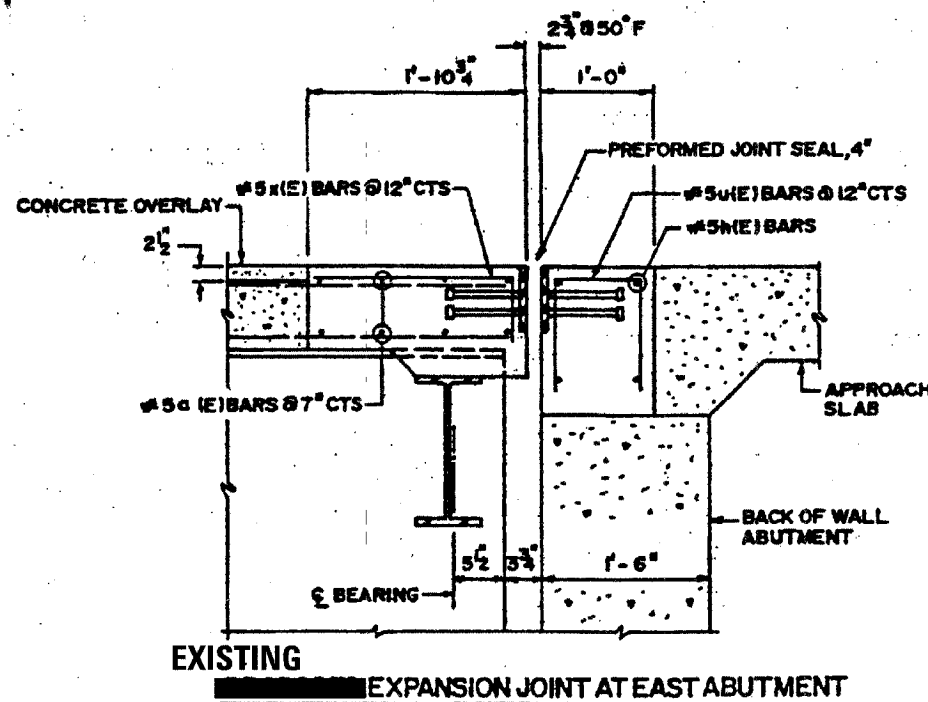

**EXISTING EXPANSION JOINT AT EAST ABUTMENT**

ILLINOIS DEPARTMENT OF TRANSPORTATION

JOINT RESEALING DETAILS

IL. RTE. 7

OVER

DES PLAINES RIVER, RAILROAD  
F.A.P. RTE. 351 SECTION: 2007-025-I  
WILL COUNTY  
STRUCTURE NO. 099-0185

SCALE: NONE  
DATE: OCTOBER 26, 2007

DRAWN BY: D.L./F.M.  
CHECKED BY: B.N.S./S.J.P.

CHRISTIAN-ROGE & ASSOC., INC.  
CHICAGO ILLINOIS

REVISIONS	
NAME	DATE



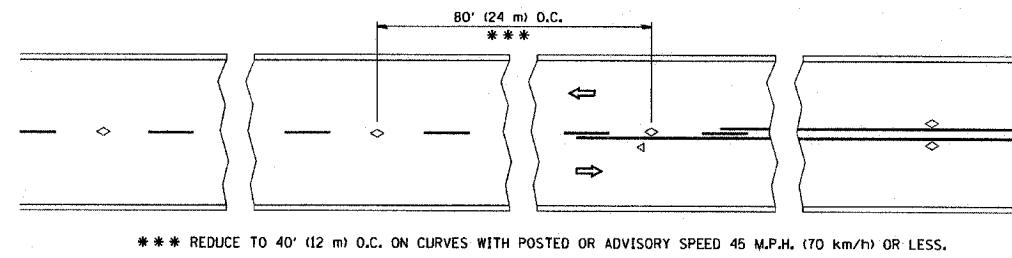

TWO-LANE/TWO-WAY

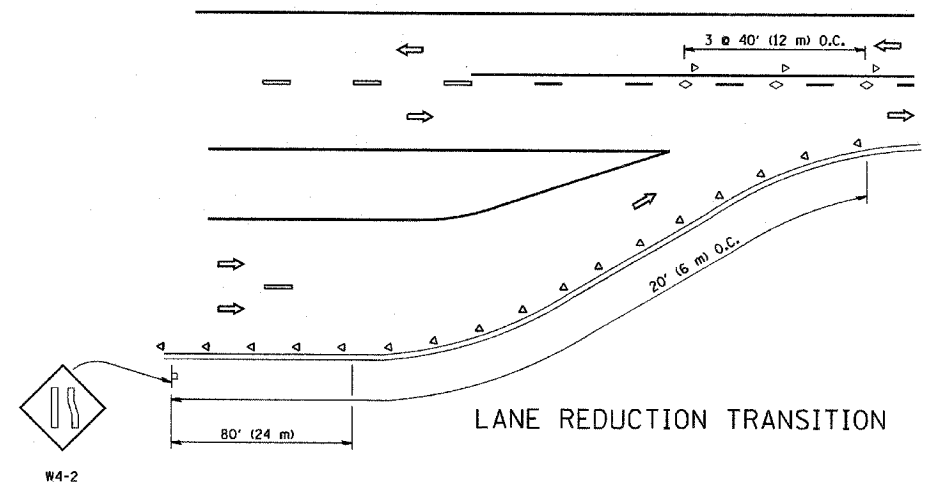

LANE REDUCTION TRANSITION

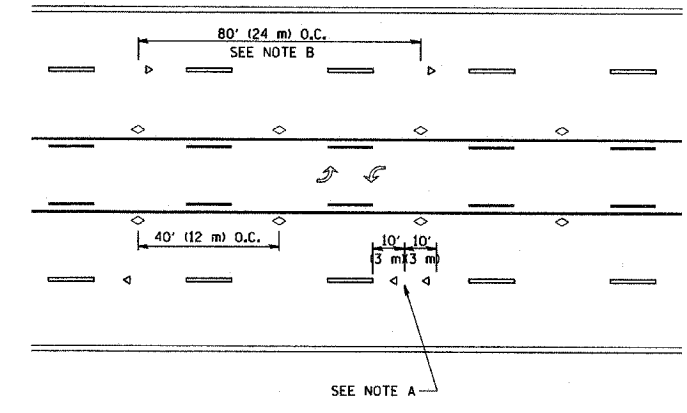

TWO-WAY LEFT TURN

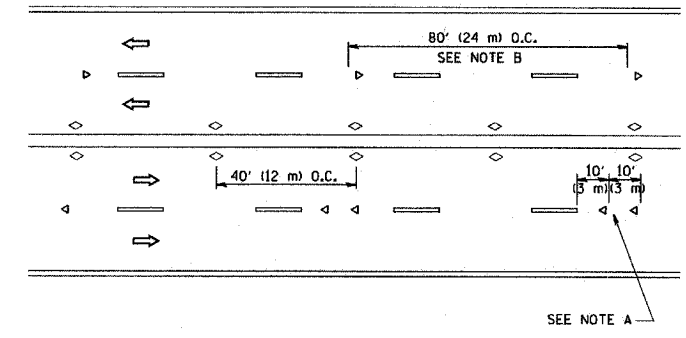

MULTI-LANE/UNDIVIDED

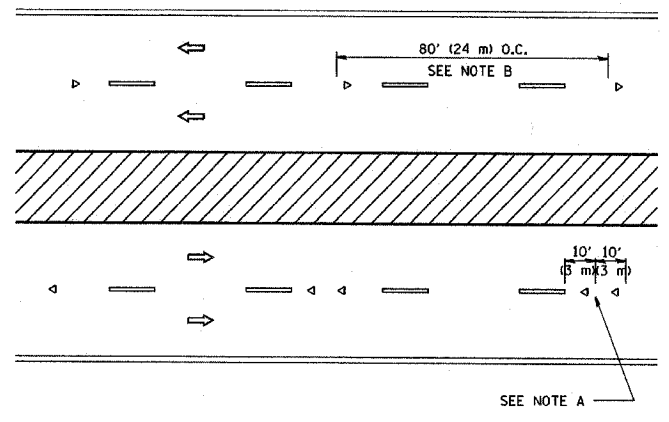

MULTI-LANE/DIVIDED

GENERAL NOTES

1. MARKERS USED WITH DASHED LINES SHALL BE CENTERED IN THE GAP BETWEEN SEGMENTS.
2. MARKERS USED ADJACENT TO SOLID LINES SHALL BE OFFSET 2 TO 3 (50 TO 75) TOWARD TRAFFIC AS SHOWN.
3. MARKERS THROUGH TANGENTS LESS THAN 500' (150 m) IN LENGTH BETWEEN CURVES SHALL BE INSTALLED AT THE LESSER OF THE TWO CURVE SPACINGS.

SYMBOLS

- YELLOW STRIPE
- WHITE STRIPE
- ◁ ONE-WAY AMBER MARKER
- ◁ ONE-WAY CRYSTAL MARKER (W/O)
- ◇ TWO-WAY AMBER MARKER

LANE MARKER NOTES

- A. USE DOUBLE LANE LINE MARKERS SPACED AS SHOWN.
- B. REDUCE TO 40' (12 m) O.C. ON CURVES WHERE ADVISORY SPEEDS ARE 10 M.P.H. (20 km/h) LOWER THAN POSTED SPEEDS.

DESIGN NOTES

1. DOUBLE LANE LINE MARKERS SHALL BE USED UNLESS SPECIFIED OTHERWISE.
2. EXCEPT AS SHOWN ON THE LANE REDUCTION TRANSITION AND FREEWAY EXIT RAMP DETAIL, MARKERS ARE NOT TO BE SPECIFIED ON RIGHT EDGE LINES.
3. THE EXACT MARKER LIMITS, SPACING, AND COLOR SHOULD BE INCLUDED IN THE PLANS.
4. MARKERS SHOULD NOT BE USED ALONGSIDE CURBS EXCEPT FOR EXTREMELY SHORT SECTIONS OF CURBS WHERE NOT MORE THAN TWO MARKERS WOULD BE INVOLVED.

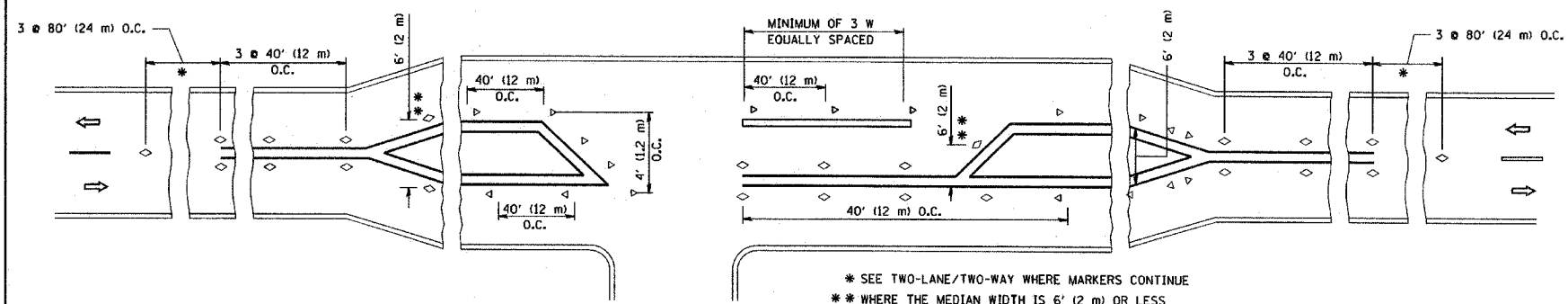

LEFT TURN

All dimensions are in millimeters (Inches) unless otherwise shown.

REVISIONS	
NAME	DATE
T. RAMMACHER	09-19-94
T. RAMMACHER	03-12-99
T. RAMMACHER	01-06-00

ILLINOIS DEPARTMENT OF TRANSPORTATION  
TYPICAL APPLICATIONS  
RAISED REFLECTIVE PAVEMENT  
MARKERS (SNOW-PLOW RESISTANT)

SCALE: NONE  
DATE: 1/17/2007

DRAWN BY CADD  
CHECKED BY  
TC-11

REVISION DATE: 01/06/00

DATE: 1/17/2007  
FILE NAME: 60C93000.dwg  
PLOT SCALE: 50/8000 / IN.  
USER NAME: jaygo

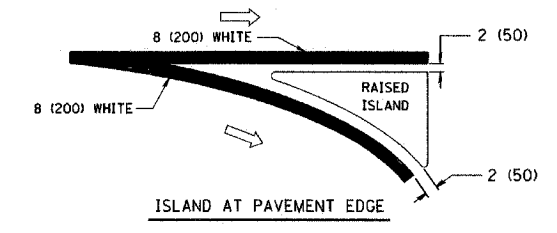
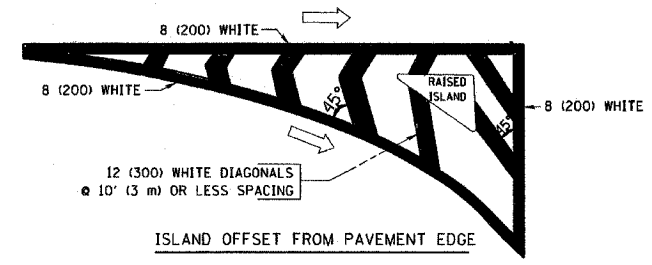
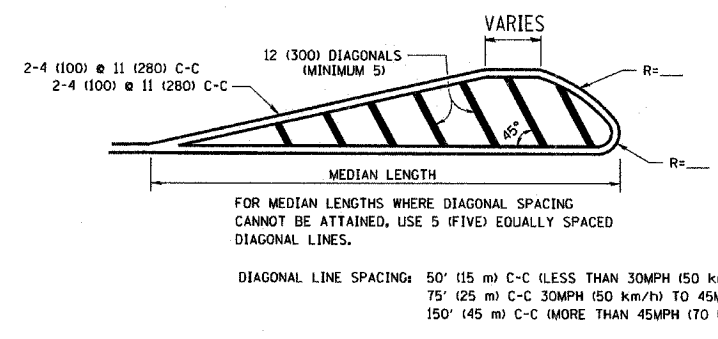
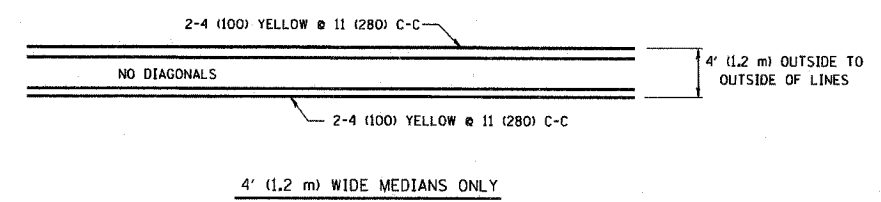
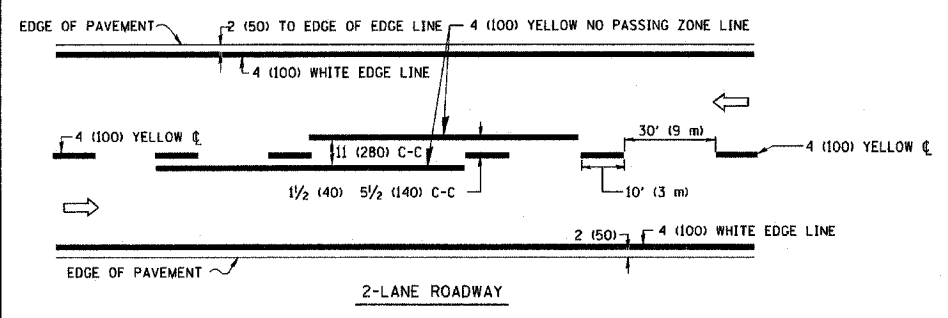

TYPICAL ISLAND MARKING

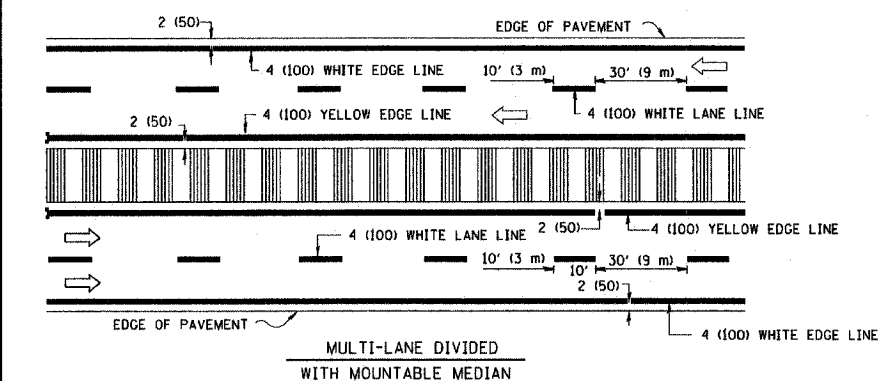
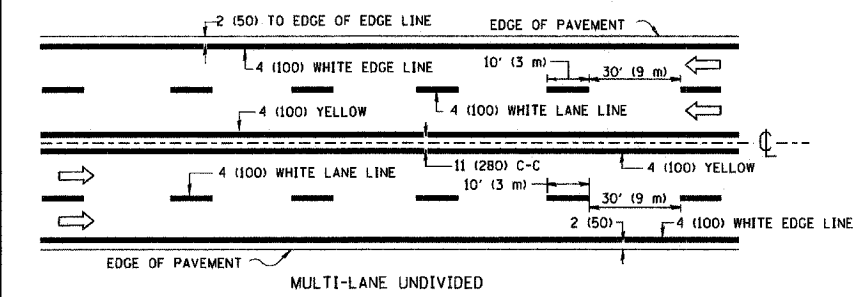

NOTE: MEDIANS WITH BARRIER CURB DO NOT REQUIRE AN EDGE LINE

TYPICAL LANE AND EDGE LINE MARKING

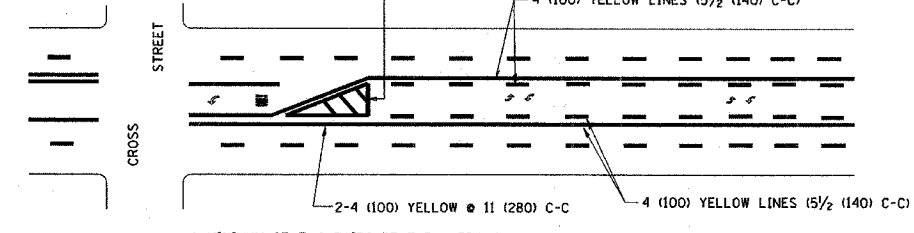

A MINIMUM OF TWO PAIRS OF TURN ARROWS SHALL BE USED, WHITE IN COLOR. ADDITIONAL PAIRS SHALL BE PLACED AT 200' (60 m) TO 300' (90 m) INTERVALS.

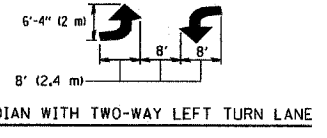

TYPICAL PAINTED MEDIAN MARKING

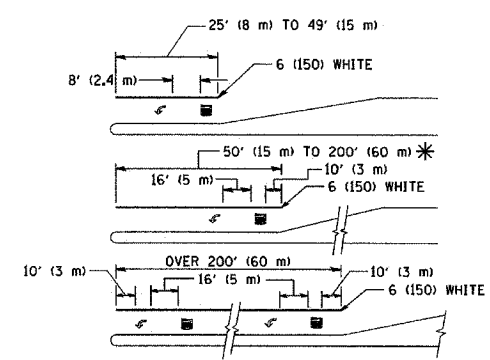

FULL SIZE LETTERS 8' (2.4 m) AND ARROWS SHALL BE USED. AREA = 15.6 SQ. FT. (1.5 m<sup>2</sup>); ONLY AREA = 20.8 SQ. FT. (1.9 m<sup>2</sup>). \* TURN LANES IN EXCESS OF 400' (120 m) IN LENGTH MAY HAVE AN ADDITIONAL SET OF ARROW - "ONLY" INSTALLED MIDWAY BETWEEN THE OTHER TWO SETS OF ARROW - "ONLY".

TYPICAL LEFT (OR RIGHT) TURN LANE

TYPE OF MARKING	WIDTH OF LINE	PATTERN	COLOR	SPACING / REMARKS
CENTERLINE ON 2 LANE PAVEMENT	4 (100)	SKIP-DASH	YELLOW	10' (3 m) LINE WITH 30' (9 m) SPACE
CENTERLINE ON MULTI-LANE UNDIVIDED PAVEMENT	2 @ 4 (100)	SOLID	YELLOW	11 (280) C-C
NO PASSING ZONE LINES: FOR ONE DIRECTION FOR BOTH DIRECTIONS	4 (100) 2 @ 4 (100)	SOLID SOLID	YELLOW YELLOW	5 1/2 (140) C-C FROM SKIP-DASH CENTERLINE 11 (280) C-C OMIT SKIP-DASH CENTERLINE BETWEEN
LANE LINES	4 (100) 5 (125) ON FREEWAYS	SKIP-DASH SKIP-DASH	WHITE WHITE	10' (3 m) LINE WITH 30' (9 m) SPACE
DOTTED LINES (EXTENSIONS OF CENTER, LANE OR TURN LANE MARKINGS)	SAME AS LINE BEING EXTENDED	SKIP-DASH	SAME AS LINE BEING EXTENDED	2' (600) LINE WITH 6' (1.8 m) SPACE
EDGE LINES	4 (100)	SOLID	YELLOW-LEFT WHITE-RIGHT	OUTLINE MOUNTABLE MEDIANS IN YELLOW; EDGE LINES ARE NOT USED NEXT TO BARRIER CURB
TURN LANE MARKINGS	6 (150) LINE; FULL SIZE LETTERS & SYMBOLS (8' (2.4m))	SOLID	WHITE	SEE TYPICAL TURN LANE MARKING DETAIL
TWO WAY LEFT TURN MARKING	2 @ 4 (100) EACH DIRECTION 8' (2.4m) LEFT ARROW	SKIP-DASH AND SOLID IN PAIRS	YELLOW WHITE	10' (3 m) LINE WITH 30' (9 m) SPACE FOR SKIP-DASH; 5 1/2 (140) C-C BETWEEN SOLID LINE AND SKIP-DASH LINE SEE TYPICAL TWO-WAY LEFT TURN MARKING DETAIL
CROSSWALK LINES (PEDESTRIAN) A. DIAGONALS (BIKE & EQUESTRIAN) B. LONGITUDINAL BARS (SCHOOL)	2 @ 6 (150) 12 (300) @ 45° 12 (300) @ 90°	SOLID SOLID SOLID	WHITE WHITE WHITE	NOT LESS THAN 6' (1.8 m) APART 2' (600) APART SEE TYPICAL CROSSWALK MARKING DETAILS.
STOP LINES	24 (600)	SOLID	WHITE	PLACE 4' (1.2 m) IN ADVANCE OF AND PARALLEL TO CROSSWALK, IF PRESENT. OTHERWISE, PLACE AT DESIRED STOPPING POINT, PARALLEL TO CROSSROAD CENTERLINE, WHERE POSSIBLE
PAINTED MEDIANS	2 @ 4 (100) WITH 12 (300) DIAGONALS @ 45° NO DIAGONALS USED FOR 4' (1.2 m) WIDE MEDIANS	SOLID	YELLOW: TWO WAY TRAFFIC WHITE: ONE WAY TRAFFIC	11 (280) C-C FOR THE DOUBLE LINE SEE TYPICAL PAINTED MEDIAN MARKING.
GORE MARKING AND CHANNELIZING LINES	8 (200) WITH 12 (300) DIAGONALS @ 45°	SOLID	WHITE	DIAGONALS: 15' (4.5 m) C-C (LESS THAN 30MPH (50 km/h)) 20' (6 m) C-C 30MPH (50 km/h) TO 45MPH (70 km/h) 30' (9 m) C-C (OVER 45MPH (70 km/h))
RAILROAD CROSSING	24 (600) TRANSVERSE LINES; "RR" IS 6' (1.8 m) LETTERS; 16 (400) LINE FOR "X"	SOLID	WHITE	SEE STATE STANDARD 78000 AREA OF: "R"=3.6 SQ. FT. (0.33 m <sup>2</sup> ) EACH "X"=54.0 SQ. FT. (5.0 m <sup>2</sup> )
SHOULDER DIAGONALS	12 (300) @ 45°	SOLID	WHITE - RIGHT YELLOW - LEFT	50' (15 m) C-C (LESS THAN 30MPH (50 km/h)) 75' (25 m) C-C (30 MPH (50 km/h) TO 45MPH (70 km/h)) 150' (45 m) C-C (OVER 45MPH (70 km/h))

FOR FURTHER DETAILS ON PAVEMENT MARKING REFER TO STANDARD SPECIFICATIONS FOR ROAD AND BRIDGE CONSTRUCTION AND STATE STANDARD 78000.

All dimensions are in millimeters (inches) unless otherwise shown.

REVISIONS	
NAME	DATE
EVERS	03-19-90
T. RAMMACHER	10-27-94
ALEX HOUSEH	10-09-96
ALEX HOUSEH	10-17-96
T. RAMMACHER	01-06-00

ILLINOIS DEPARTMENT OF TRANSPORTATION  
DISTRICT ONE  
TYPICAL PAVEMENT MARKINGS

SCALE: NONE  
DATE: 1/17/2007  
DRAWN BY: CADD  
CHECKED BY:  
TC-13  
REVISION DATE: 01/06/00

DATE: 1/17/2007  
FILE NAME: K:\ad\stev\ad\13.dgn  
PLOT SCALE: 80.0000 / 1 IN.  
USER NAME: legao

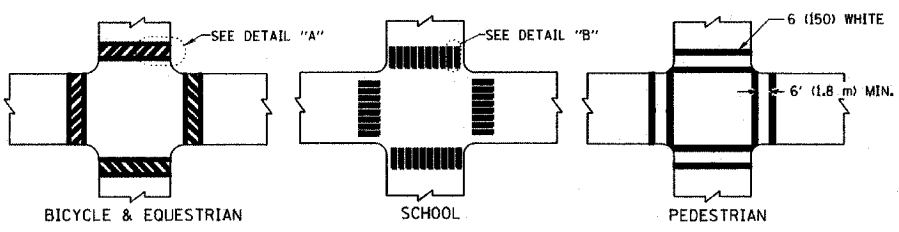

TYPICAL CROSSWALK MARKING

F.A. RTE.	SECTION	COUNTY	TOTAL SHEETS	SHEET NO.
351	2007-025-1	WILL	18	16
STA.		TO STA.		
FED. ROAD DIST. NO.	ILLINOIS	FED. AID PROJECT		
CONTRACT NO. 60C93				

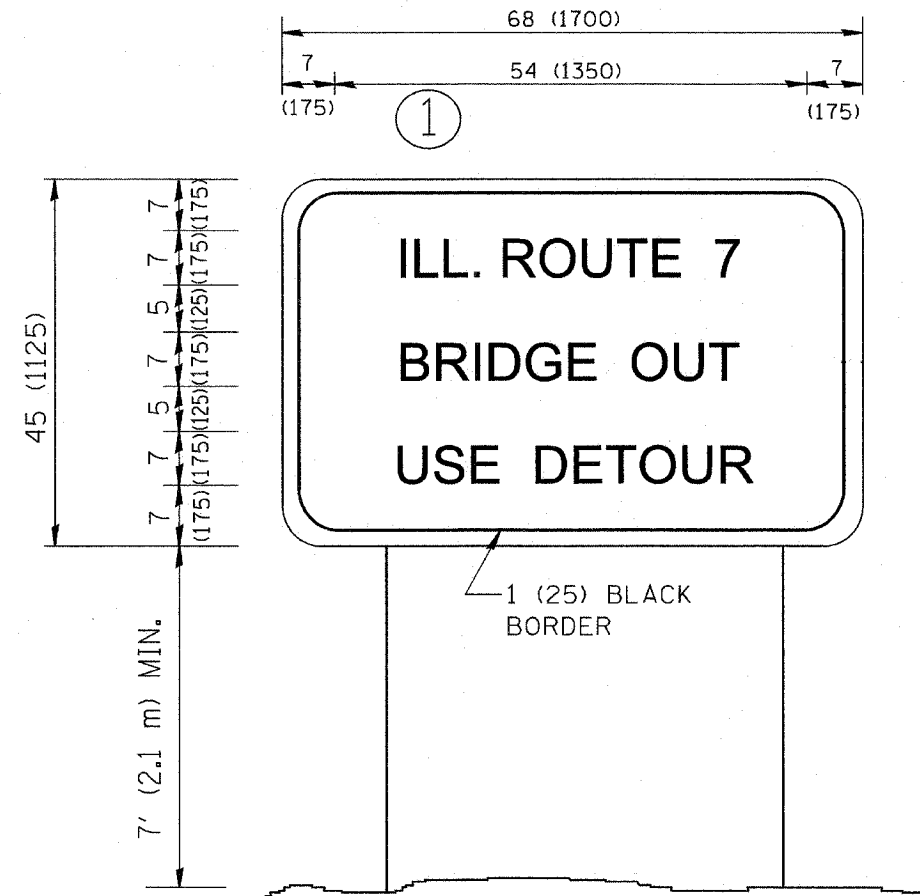

NOTES:

1. USE BLACK LETTERING ON ORANGE BACKGROUND.
2. ERECT SIGNS IN ADVANCE OF THE LOCATION FOR THE "ROAD CONSTRUCTION AHEAD" SIGN AT LOCATIONS AS DIRECTED BY THE ENGINEER.
3. SEE SPECIAL PROVISIONS FOR "TEMPORARY INFORMATION SIGNING" FOR ADDITIONAL INFORMATION.
4. ONE SIGN ASSEMBLY EQUALS 21.25 SQ. FT.
5. SHALL BE PAID FOR AS TEMPORARY INFORMATION SIGNING.

ALL DIMENSIONS ARE IN INCHES (MILLIMETERS)  
UNLESS OTHERWISE SHOWN.

REVISIONS	
NAME	DATE

ILLINOIS DEPARTMENT OF TRANSPORTATION  
TEMPORARY INFORMATION SIGNING

SCALE: NONE  
OCTOBER 26, 2007

DRAWN BY DESIGN  
CHECKED BY

PLT DATE = 2/6/2007  
PLT NAME = ...  
PLT SCALE = 1/8"=1'-0"  
USER NAME = bauerd

F.A. RTE.	SECTION	COUNTY	TOTAL SHEETS	SHEET NO.
351	2007-025-I	WILL	18	17
STA.		TO STA.		
FED. ROAD DIST. NO.		ILLINOIS	FED. AID PROJECT	

CONTRACT NO. 60C93

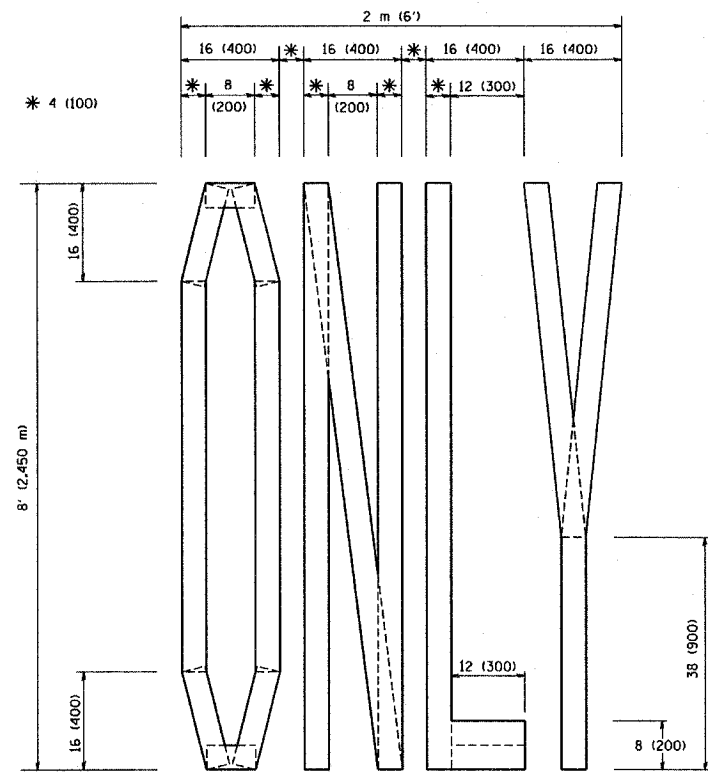

QUANTITY  
4 (100) LINE = 64.1 ft. (19.7 m)  
21.1 sq. ft. (1.97 sq. m)

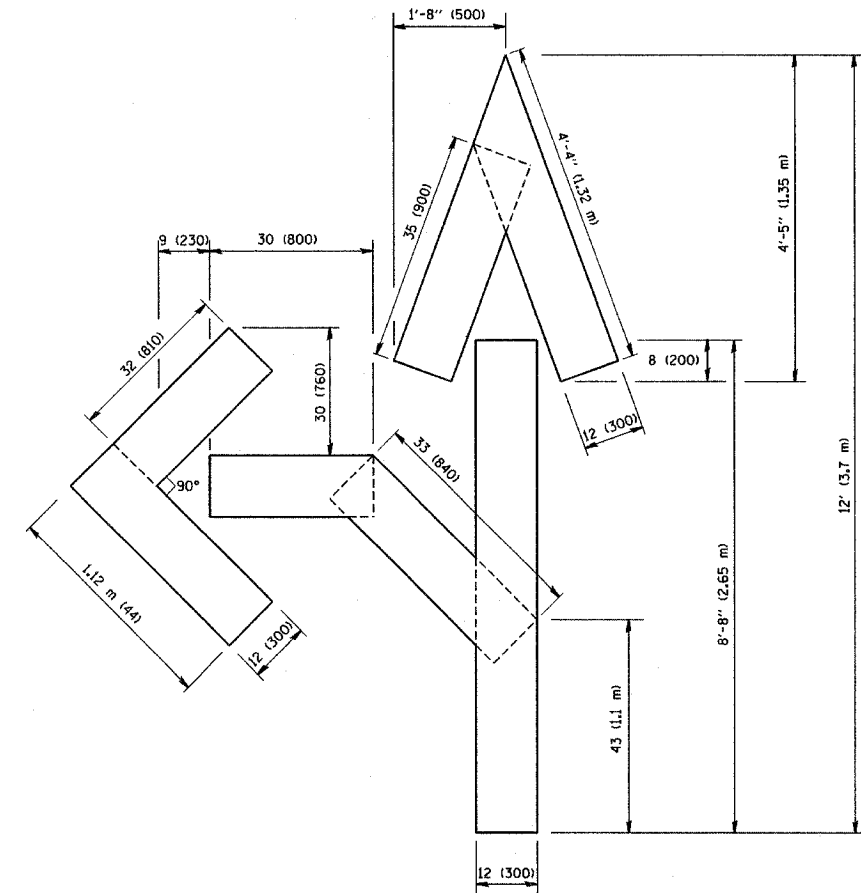

QUANTITY  
4 (100) LINE = 82.5 ft. (25.3 m)  
27.5 sq. ft. (2.53 sq. m)

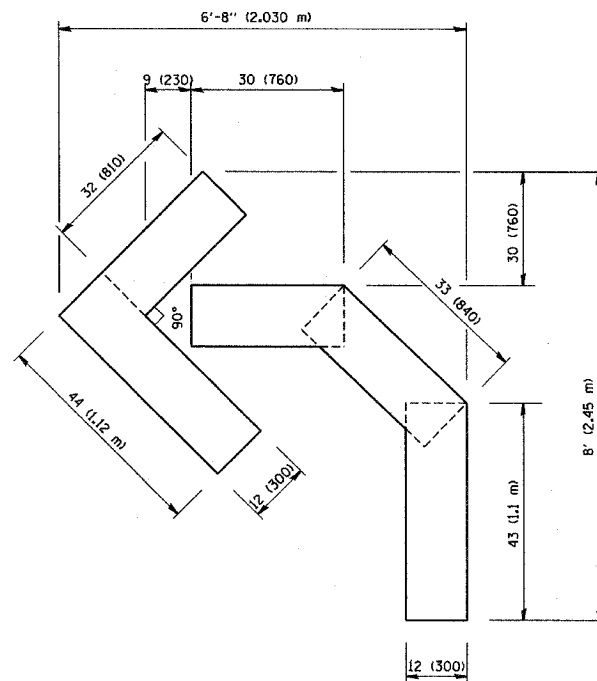

QUANTITY  
4 (100) LINE = 45.5 ft. (13.9 m)  
15.2 sq. ft. (1.39 sq. m)

All dimensions are in inches (millimeters) unless otherwise shown.

REVISIONS	
NAME	DATE
T. RAMMACHER	09/18/94
J. OBERLE	06/01/96
T. RAMMACHER	06/05/96
T. RAMMACHER	11/04/97
T. RAMMACHER	03/02/98
E. GOMEZ	08/28/00

ILLINOIS DEPARTMENT OF TRANSPORTATION

PAVEMENT MARKING  
LETTERS AND SYMBOLS  
FOR TRAFFIC STAGING

SCALE: NONE

DRAWN BY CADD

CHECKED BY

TC-16

CONTRACT NO. 60C93

**ROUTE MARKERS**

FOR U.S. ROUTES  
M1-40-2424

FOR ILLINOIS ROUTES  
M1-50-2424

R.R. UNMARKED ROUTES  
SPECIAL 24" x 18" VARIABLE  
4" BLACK LETTERS ON WHITE  
REFLECTIVE BACKGROUND

**ARROWS SIGNS**

M5-1L-2115

M5-1R-2115

M6-1L-2115

M6-1R-2115

M6-3-2115

**CARDINAL DIRECTION & DETOUR SIGNS**

NORTH M3-1-219

EAST M3-2-219

SOUTH M3-3-219

WEST M3-4-219

DETOUR M1-7-219

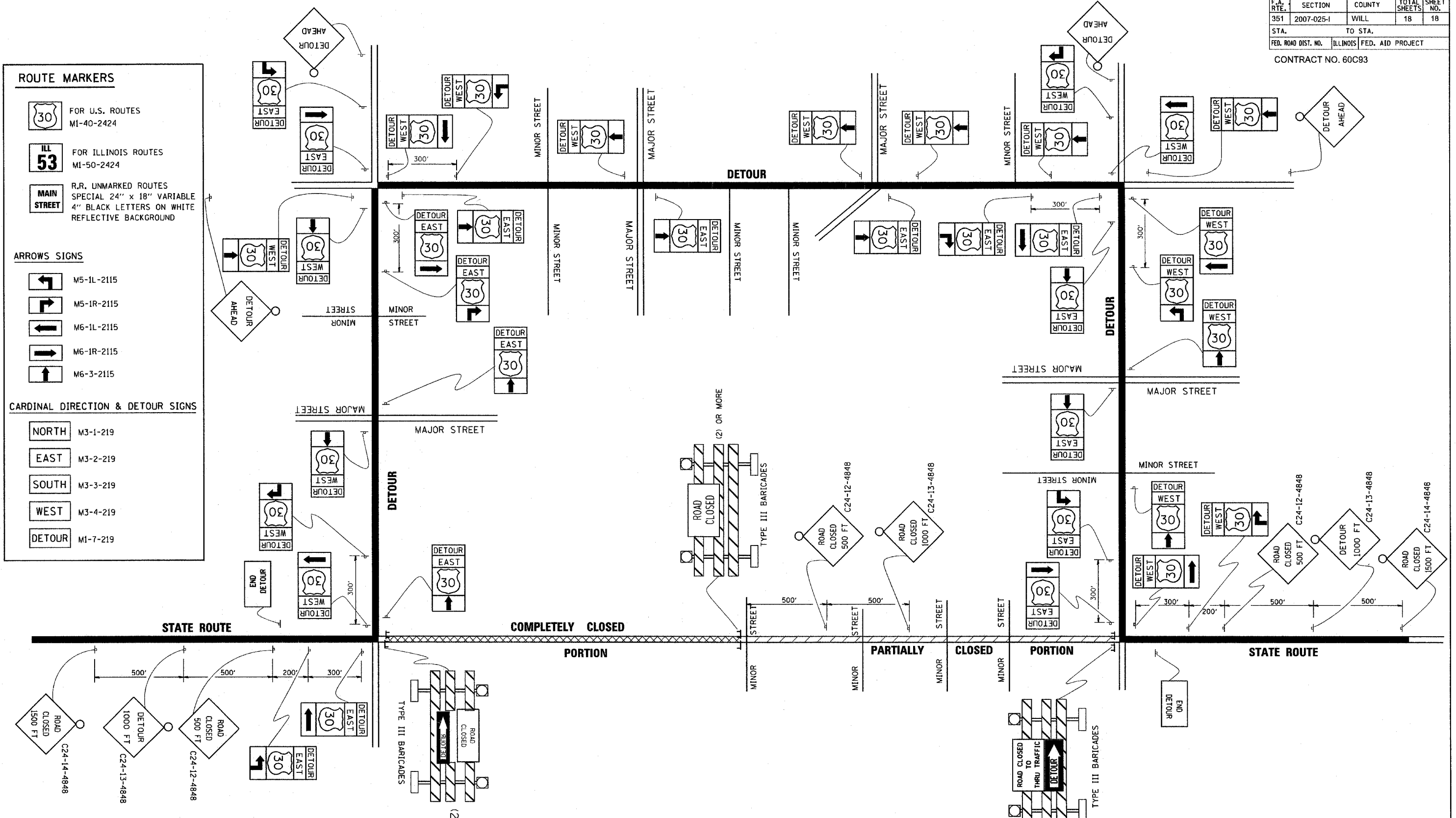

REVISIONS	
NAME	DATE
	10/18/02

ILLINOIS DEPARTMENT OF TRANSPORTATION

**TYPICAL MARKING FOR CLOSING STATE HIGHWAYS**

SCALE: NONE

DRAWN BY

CHECKED BY

TC-21

DATE: 8/7/2007  
 FILE NAME: 60C93.dwg  
 PLOT SCALE: 50:1  
 USER NAME: bauerdl