

F.A.U. RTE.	SECTION	COUNTY	TOTAL SHEETS	SHEET NO.
332	2007-037TS	COOK/WILL	34	26
STA.		TO STA.		
FED. ROAD DIST. NO.		ILLINOIS FED. AID PROJECT		

D-91-343-07

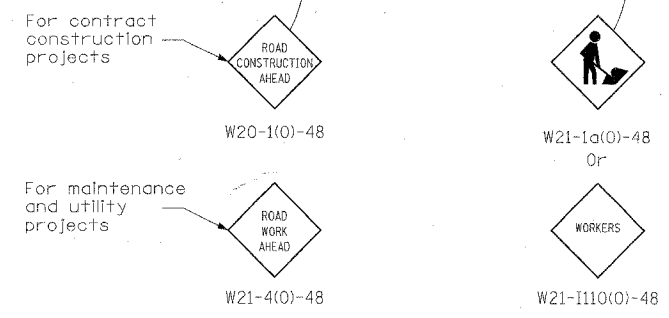
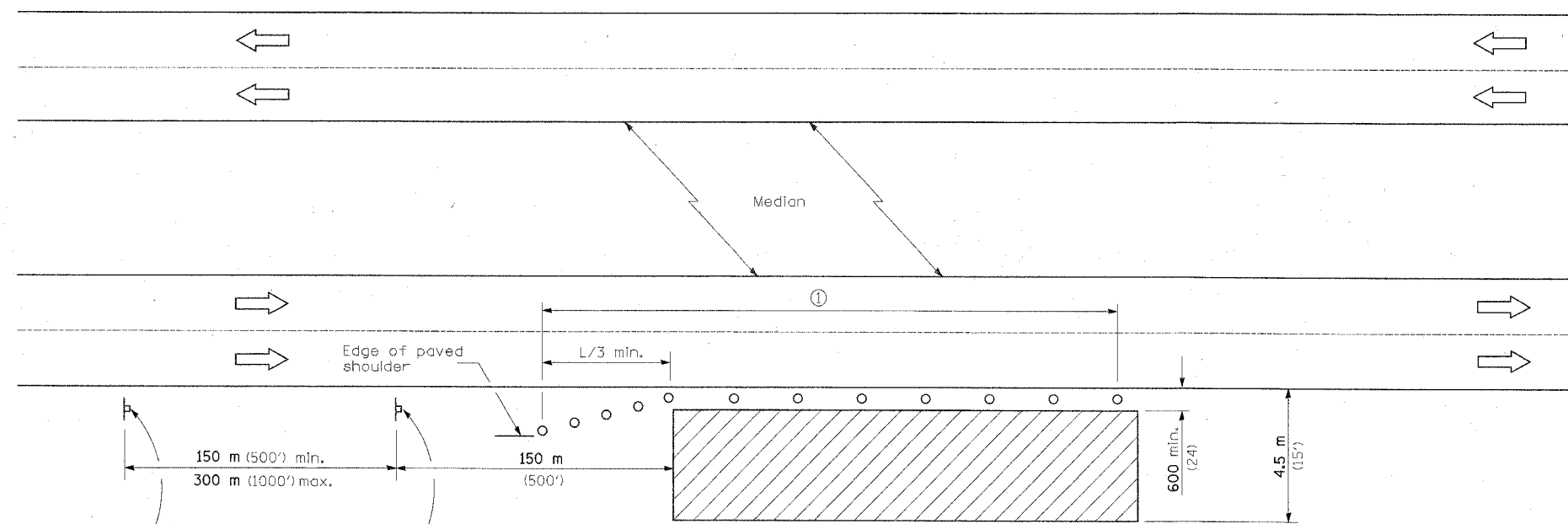

TYPICAL APPLICATIONS

- Utility operations
- Culvert extensions
- Side slope changes
- Guardrail installation and maintenance
- Delineator installation
- Landscaping operations
- Shoulder repair
- Sign installation and maintenance

SYMBOLS

- Work area
- Sign
- Cone, drum or barricade

① When the work operation exceeds one hour, cones, drums or barricades shall be placed at 8 m (25') centers for L/3 distance, and at 15 m (50') centers through the remainder of the work area.

GENERAL NOTES

This Standard is used where any vehicles, equipment, workers or their activities will encroach in the area 4.5 m (15') to 600 mm (24') from the edge of pavement.

Calculate L as follows:

SPEED LIMIT	FORMULAS	
70 km/h (40 mph) or less:	Metric $L = \frac{WS^2}{150}$	(English) $L = \frac{WS^2}{60}$
80 km/h (45 mph) or greater:	$L = 0.65(W)(S)$	$L = (W)(S)$

W = Width of offset in meters (feet).
S = Normal posted speed km/h (mph).

All dimensions are in millimeters (Inches) unless otherwise shown.

OFF-RD OPERATIONS, MULTILANE, 4.5 m (15') TO 600 mm (24') FROM PAVEMENT EDGE

STANDARD 701101-01

PLOT DATE = 11/26/07
FILE NAME = #FILE#
PLOT SCALE = #SCALE#
USER NAME = #P_NAME#

INFRASTRUCTURE ENGINEERING, INC.
33 W. MONROE ST. SUITE 1540
CHICAGO, IL 60603-5322
PHONE 312.425.9560
FAX 312.425.9564

REVISIONS	
NAME	DATE

ILLINOIS DEPARTMENT OF TRANSPORTATION

DISTRICT ONE
EXPRESSWAY LANE CLOSURE
DETAILS

SCALE: VERT. DATE 11/26/07
HORIZ. DATE 11/26/07

DRAWN BY BL
CHECKED BY ER/TC