

F.A. RTE.	SECTION	COUNTY	TOTAL SHEETS	SHEET NO.
347	(C&J) R-RS-2	DU PAGE	18	16
STA. TO STA.		FED. ROAD DIST. NO. ILLINOIS FED. AID PROJECT		

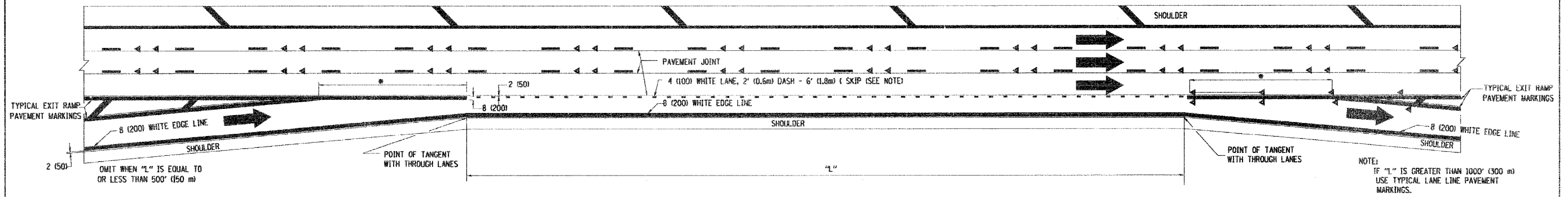

TYPICAL ENTRANCE/EXIT RAMP COMBINATION PAVEMENT MARKINGS

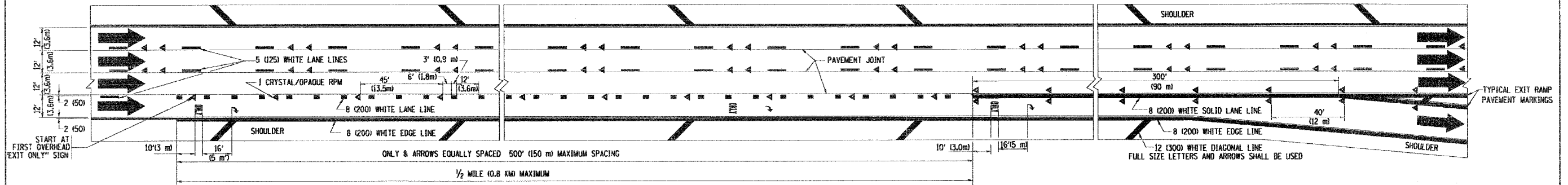

TYPICAL EXIT ONLY LANE PAVEMENT MARKINGS

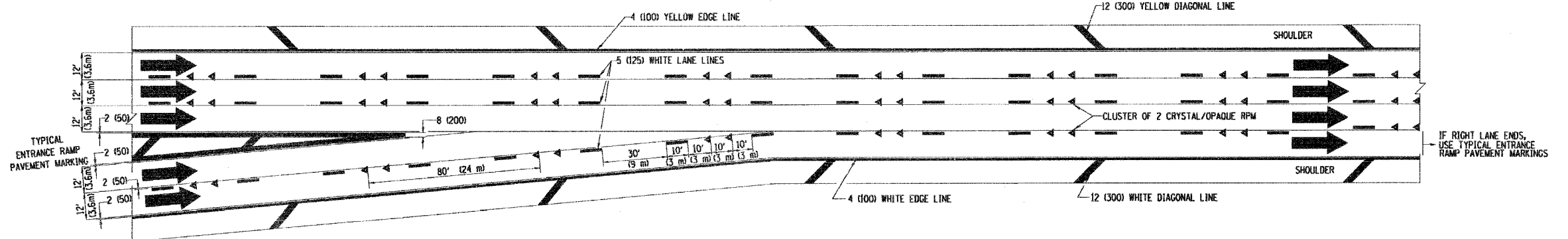

TYPICAL TWO LANE ENTRANCE RAMP PAVEMENT MARKINGS

REVISIONS	
NAME	DATE
DWS	1/30
DWS	5/31
SPB	1/07

ILLINOIS DEPARTMENT OF TRANSPORTATION
 MULTI-LANE FREEWAY
 PAVEMENT MARKING
 DETAILS
 SCALE: NONE
 DRAWN BY C.A.D.D.
 CHECKED BY
 TC12 SHEET 2 OF 2

PLOT DATE: 3/14/2007
 FILE NAME: K:\highway\hwy2.dgn
 PLOT SCALE: 0.8000 / 1x
 USER NAME: bauerd