

F.A.I. RTE.	SECTION	COUNTY	TOTAL SHEETS	SHEET NO.
90/94	2007-056 5G	COOK	30	8
STA. 20+00		TO STA. 35+00		
FED. ROAD DIST. NO.		ILLINOIS FED. AID PROJECT		

STAGE 1 CONSTRUCTION
 CONSTRUCT SIGNING FRAME FOUNDATION LOCATED IN MEDIAN BETWEEN EASTBOUND I-90/94 AND WESTBOUND I-90/94 AND PLACE TEMPORARY CONCRETE BARRIER.

STAGE 1 TRAFFIC
 CLOSE EB I 90/94 LANE CLOSEST TO INNER RAMP AS SHOWN IN THE PLANS BASED ON THE FOLLOWING STANDARDS:
 701400 APPROACH TO LANE CLOSURE, FREEWAY/EXPRESSWAY
 701402 LANE CLOSURE, FREEWAY/EXPRESSWAY, WITH BARRIER
 701411 LANE CLOSURE, MULTILANE, AT ENTRANCE OR EXITRAMP, FOR SPEEDS >= 45 MPH
 TC-17 TRAFFIC CONTROL DETAILS FOR FREEWAY SHOULDER CLOSURES PARTIAL RAMP CLOSURES

PLAN	DATE	BY
REVISIONS		
1. PLOTTED		
2. CHECKED		
3. APPROVED		
4. FILED		

PROFILE	DATE	BY
REVISIONS		
1. PLOTTED		
2. CHECKED		
3. APPROVED		
4. FILED		

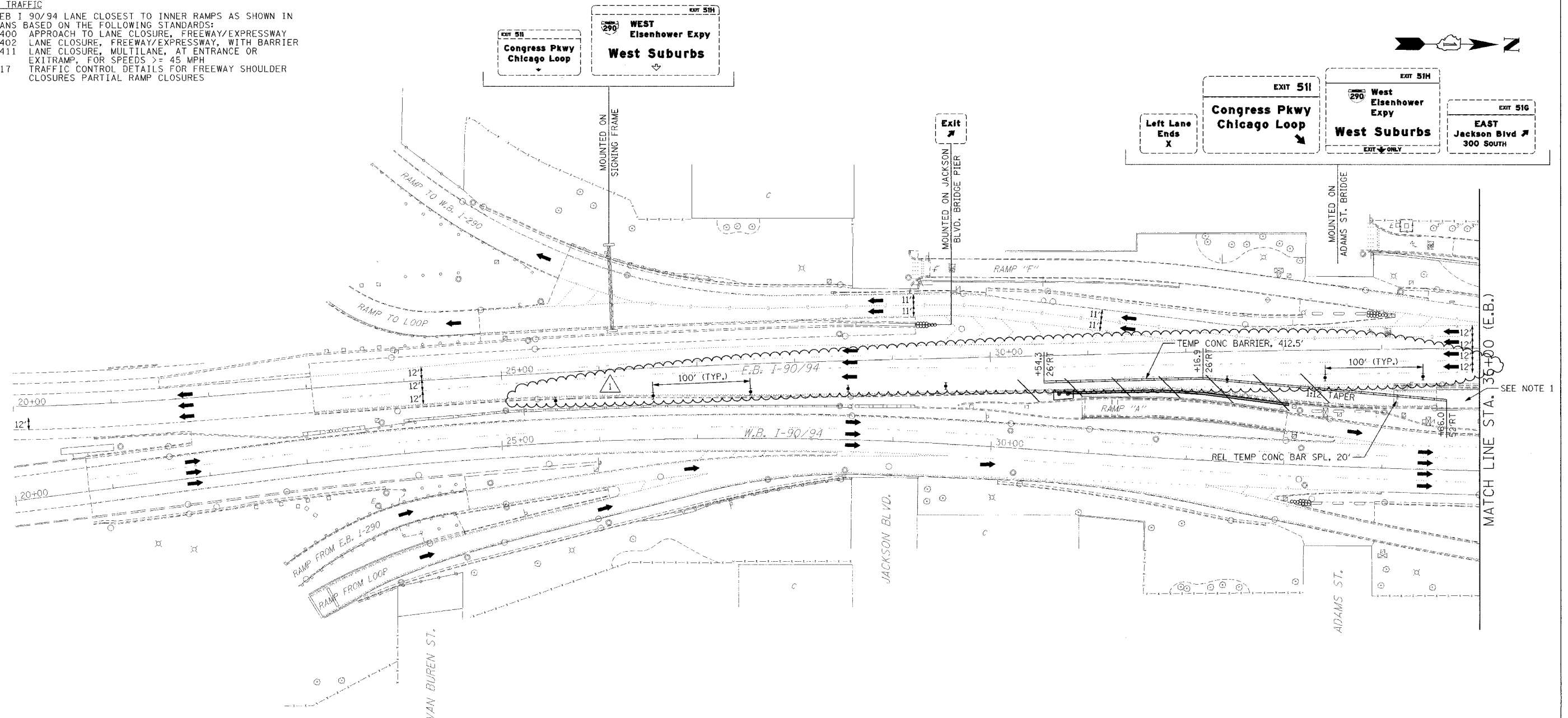

NOTES:
 1. THE ELEVATED PORTION OF RAMP 'C' HAS ALREADY BEEN REMOVED AND THE RETAINED EARTH PORTION IS ALL THAT REMAINS.

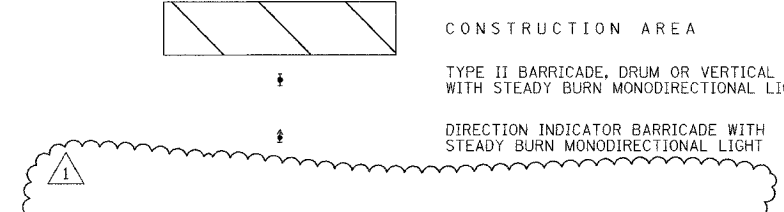

ILLINOIS DEPARTMENT OF TRANSPORTATION
MAINTENANCE OF TRAFFIC
 I-90/94 KENNEDY EXPRESSWAY
 STAGE 1
 STA. 20+00 TO STA. 35+00
 SCALE : 1" = 50'
 DATE : 10/31/07
 DRAWN BY : DLZ
 CHECKED BY : GB

ADDENDUM 1 - 1-3-08