

DATE	BY
REVISION	BY
PLANNED	BY
NOTED	BY
CHECKED	BY
DESIGNED	BY
FILE NAME	
NO.	

DATE	BY
REVISION	BY
PLANNED	BY
NOTED	BY
CHECKED	BY
DESIGNED	BY
FILE NAME	
NO.	

U.S. RTE. 45 (LA GRANGE RD.)

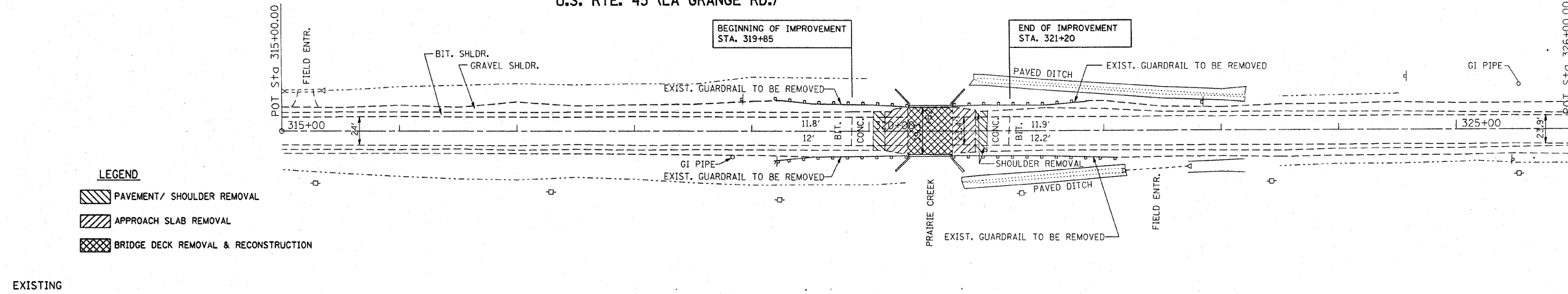

EXISTING

U.S. RTE. 45 (LA GRANGE RD.)

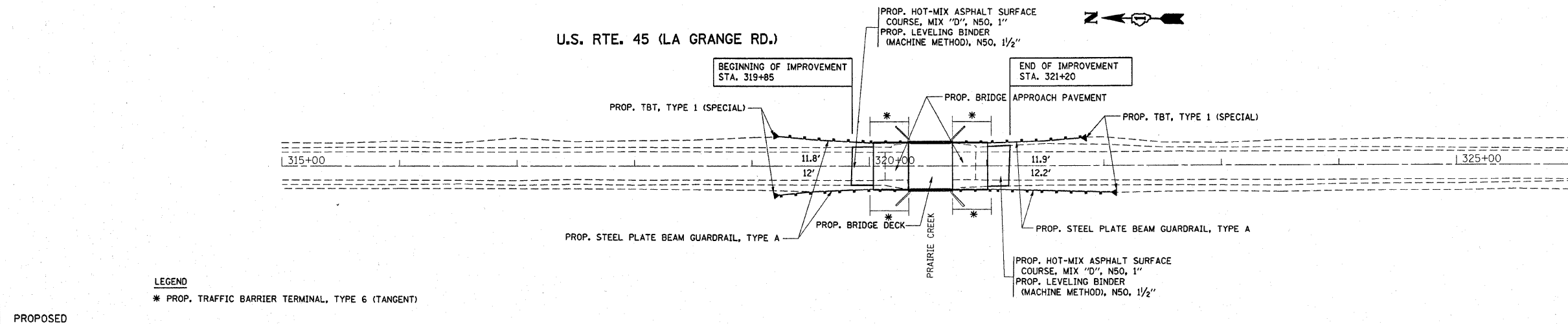

PROPOSED

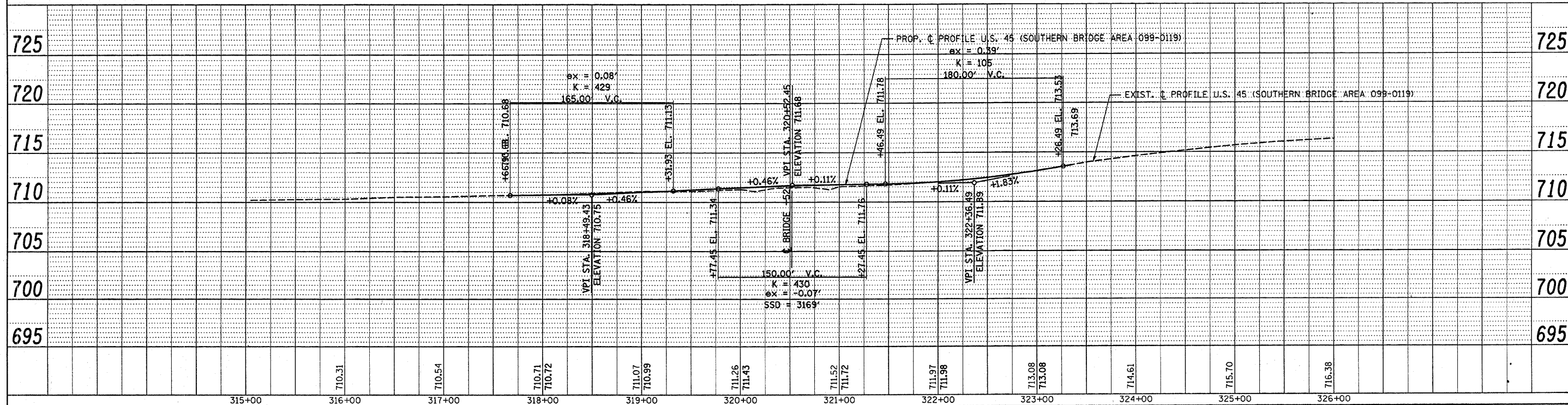

FILE NAME =	USER NAME = ulrshkd	DESIGNED -	REVISED -	STATE OF ILLINOIS DEPARTMENT OF TRANSPORTATION	EXISTING & PROPOSED ROADWAY PLAN U.S. RTE. 45 OVER PRAIRIE CREEK				F.A.P. RTE. 330	SECTION 105 B(1&2)R-1	COUNTY WILL	TOTAL SHEETS 33	SHEET NO. 8
PROJECT NO. =	DATE = 11/16/2007	DRAWN -	REVISED -		SCALE: 1"=50'	SHEET NO. OF SHEETS STA. TO STA.	SN:099-0119		CONTRACT NO. 60D50		FED. ROAD DIST. NO. 1 [ILLINOIS] FED. AID PROJECT		
DATE =		CHECKED -	REVISED -										
		DATE =	REVISED -										