

STATE OF ILLINOIS
DEPARTMENT OF TRANSPORTATION

ROUTE NO.	SECTION	COUNTY	SHEET NO.	SHEET NO.
FAP 330	105B-IR	WILL	33	25
FED. ROAD DIST. NO. 7	ILLINOIS	FED. AID PROJECT-		

SHEET NO. 7
9 SHEETS

Contract # 60D50

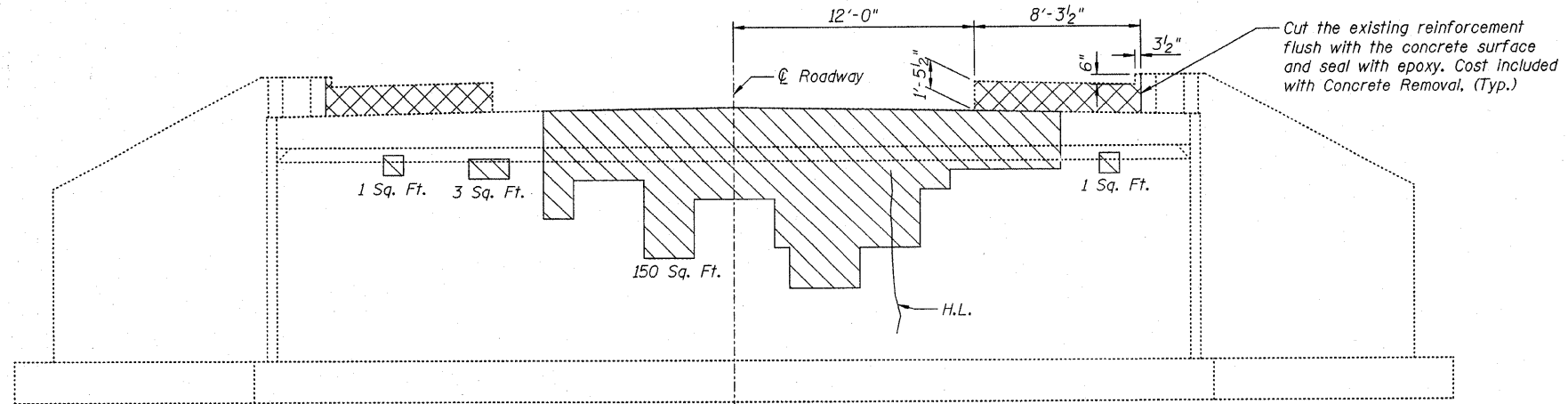

NORTH ABUTMENT - ELEVATION

Looking North

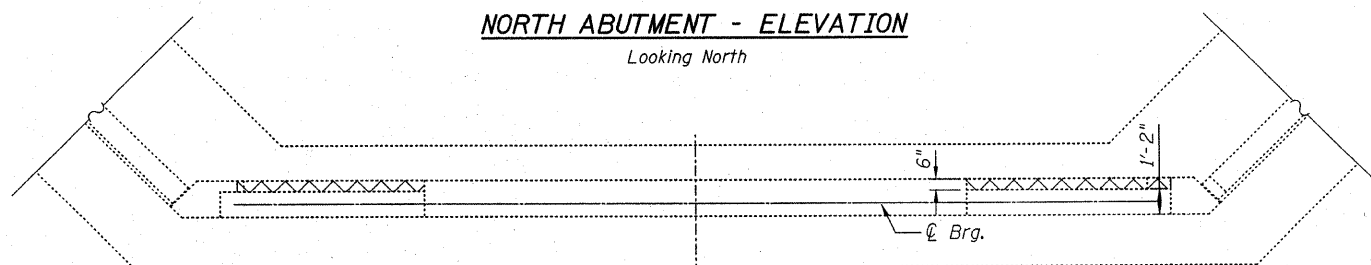

NORTH ABUTMENT - PLAN

LEGEND

	Structural Repair of Concrete
	Concrete Removal
	H.L. Hairline Crack - No Repairs

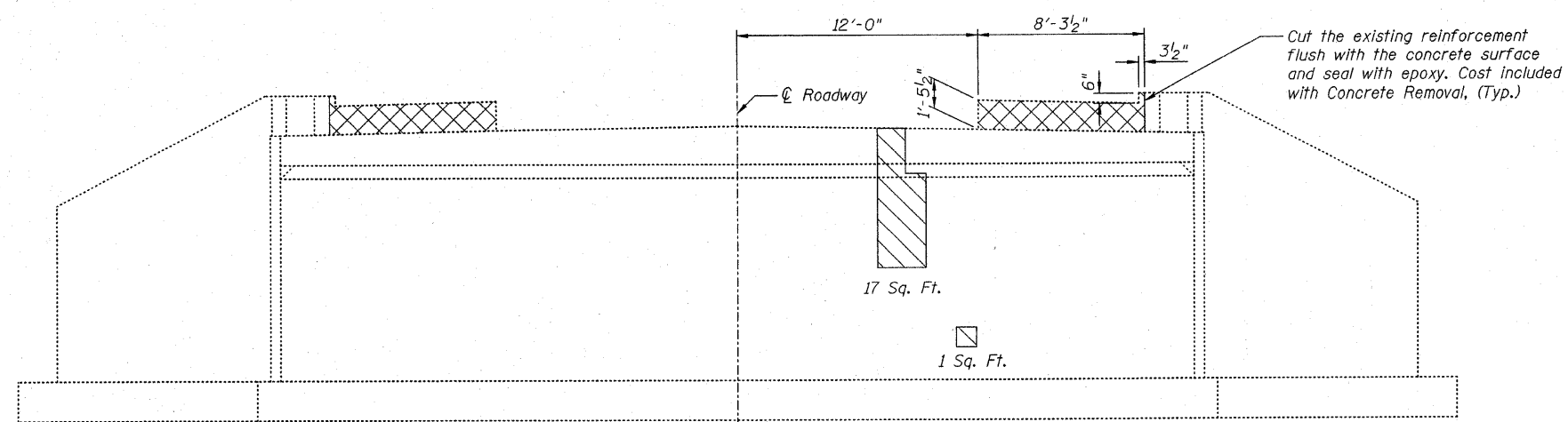

SOUTH ABUTMENT - ELEVATION

Looking South

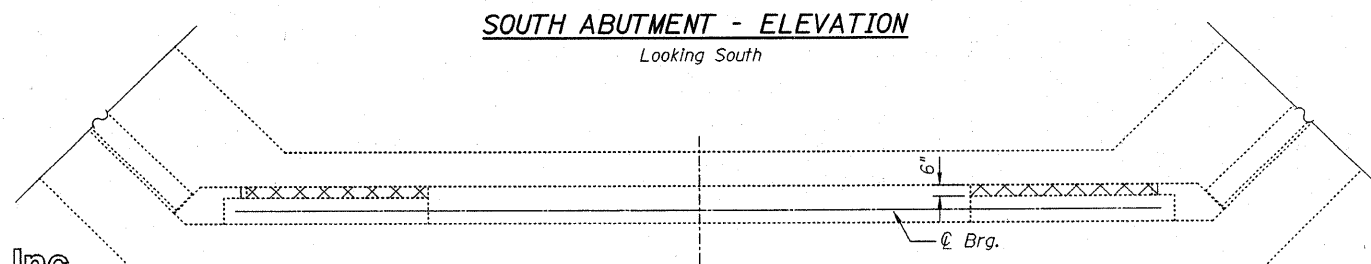

SOUTH ABUTMENT - PLAN

BILL OF MATERIAL

Item	Unit	Quantity
Structural Repair of Concrete (Depth Equal to or Less than 5")	Sq. Ft.	173
Concrete Removal	Cu. Yd.	0.9

Note:

Repairs of the existing Abutments shall include but not be limited to the areas shown. The actual areas to be determined by the engineer at the time of construction.

**CONCRETE REMOVAL
AND SUBSTRUCTURE REPAIR
US RTE 45 OVER PRAIRIE CREEK
F.A.P. RT. 330
SECTION 105B-IR
WILL COUNTY
STA. 320+52.00
S.N. 099-0119**

DESIGNED	B. Sauter
CHECKED	E. Mroczek
DRAWN	R. Danley
CHECKED	E. Mroczek

Ciorba Group, Inc.
CONSULTING ENGINEERS
5507 North Cumberland Avenue, Suite 402 Chicago, Illinois 60656
Tel. 773.775.4009 Fax 773.775.4014 Email chicago@ciorba.com

10/17/2007 rdanley nt:\proj\3329\3329_05\design\structural\ced\ahh\3329_05_07 Substructure Repair.sht