

ROUTE NO.	SECTION	COUNTY	TOTAL SHEETS	SHEET NO.
533	119R-2B	McHenry	64	37
FED. ROAD DIST.		ILLINOIS		FED. AID PROJECT-
Contract #62336				

SHEET NO. 2 OF 12 SHEETS

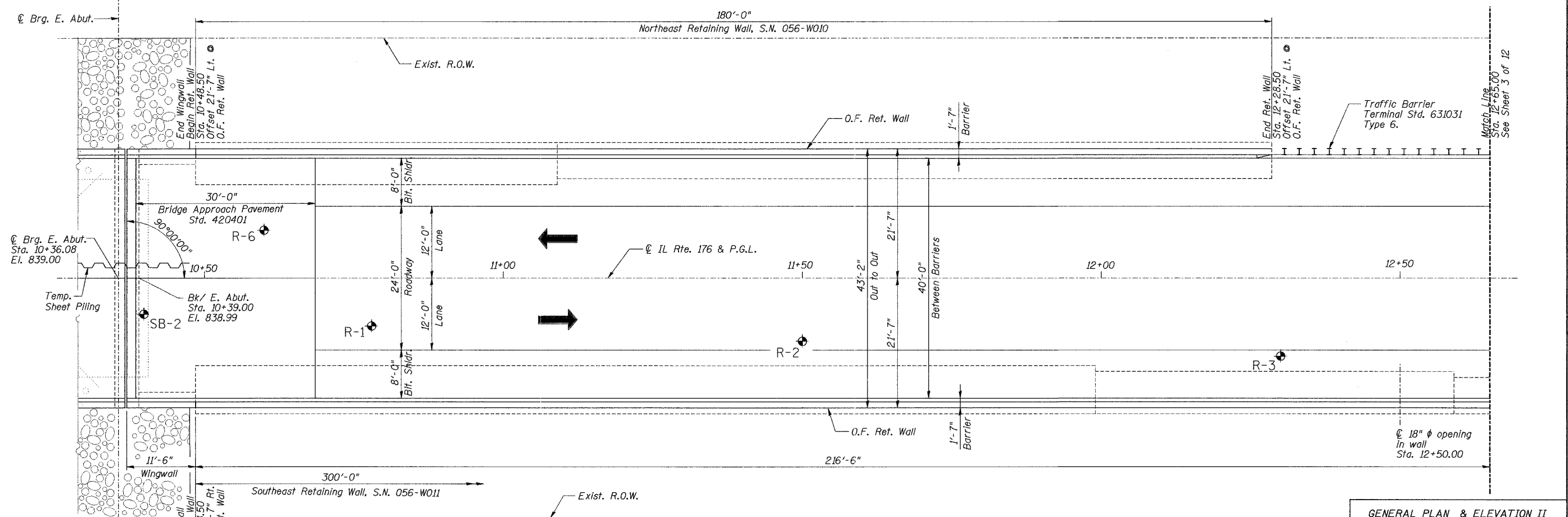
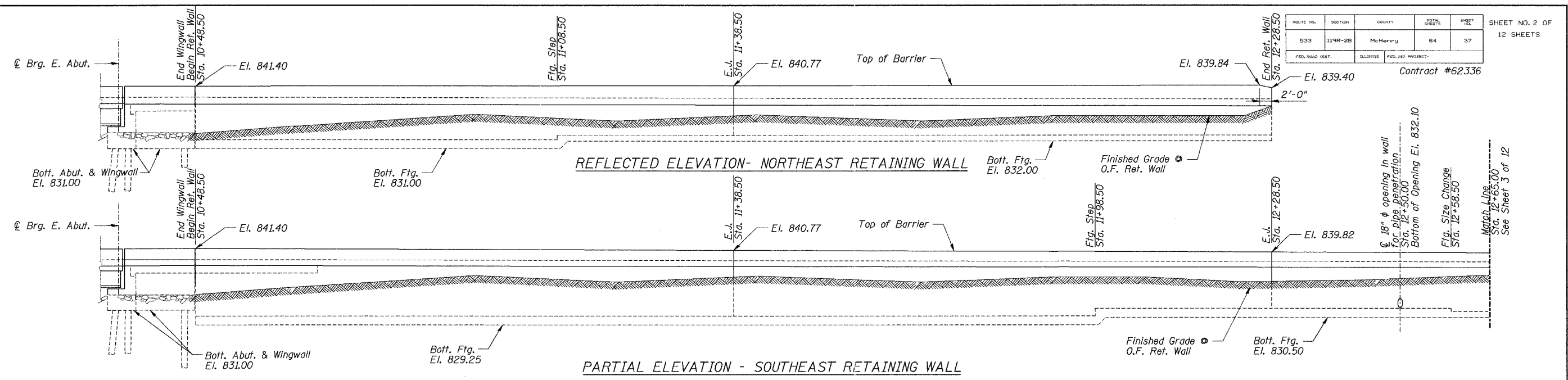

DESIGNED	S.D.H.
CHECKED	J.A.Z.
DRAWN	M.S.M.
CHECKED	S.D.H.

Notes:
 1. E.J. = Expansion Joint
 2. For Profile Grade, see Sheet 3 of 12.



- LEGEND**
- Stone Riprap, see Bridge Plans
 - R-2 - Soil Boring (For additional Soil Borings at Bridge, see Bridge Plans)

**GENERAL PLAN & ELEVATION II
 RETAINING WALLS**
 IL Route 176 over the Kishwaukee River
 F.A.P. RTE 533, SECTION 119R-2B
 McHENRY COUNTY
 STA. 7+71.50 TO STA. 13+48.50
 DATE: 10-05-07
 GRAEF, ANHALT, SCHLOEMER & ASSOCIATES INC
 CHICAGO ILLINOIS

N:\jobs\056\p105\chore\work\final\RetWall\056-005-S-2.dgn
 10/13/07 10:45:00 AM

N:\jobs\056\p105\chore\work\final\RetWall\056-005-S-2.dgn
 10/13/07 10:45:00 AM