

F.A.P. RTE.	SECTION	COUNTY	TOTAL SHEETS	SHEET NO.
353	11-5-N-1	COOK	79	17
STA. 207+00		TO STA. 219+78		
FED. ROAD DIST. NO. 1 ILLINOIS FED. AID PROJECT				

PLAN	DATE	BY
SURVEYED		
NOTE BOOK		
ALIGNED		
CHECKED		
EXAD. FILE NAME		

PROFILE	DATE	BY
SURVEYED		
NOTE BOOK		
GRADES CHECKED		
BLM. NOTED		
PROPOSED		
STATUS		
CHRO		

PLOT DATE = 1/3/2008  
 FILE NAME = c:\projects\p100\003\ah-drain.dwg  
 PLOT SCALE = 50.0000 / IN.  
 USER NAME = drivdesign

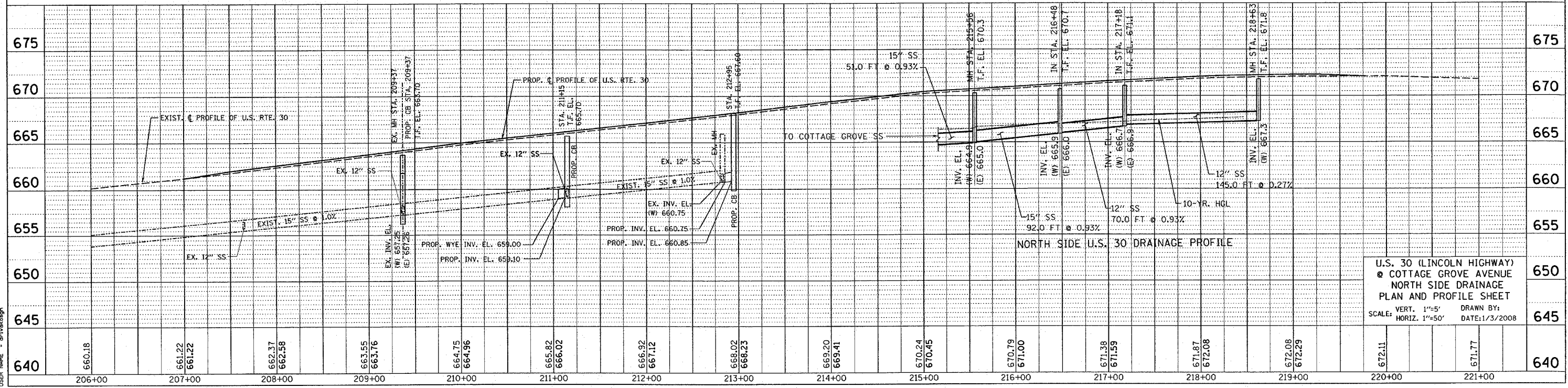
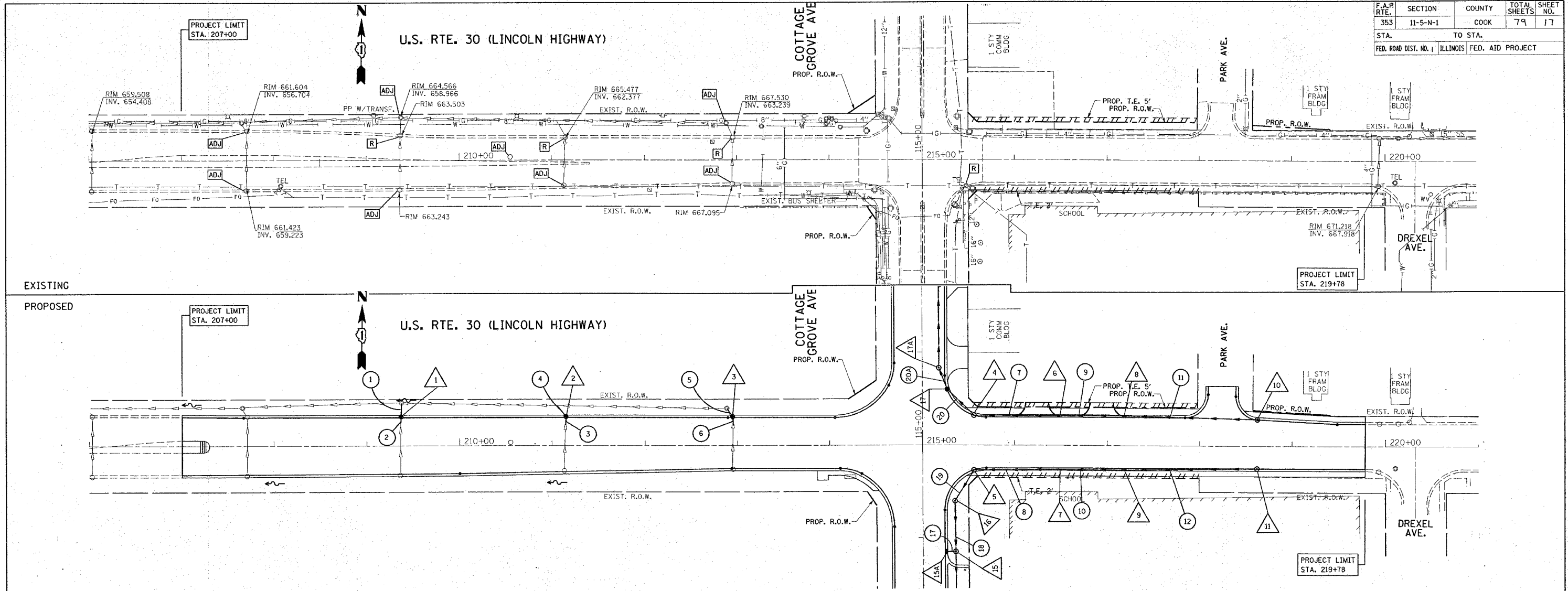

U.S. 30 (LINCOLN HIGHWAY)  
 & COTTAGE GROVE AVENUE  
 NORTH SIDE DRAINAGE  
 PLAN AND PROFILE SHEET  
 SCALE: VERT. 1"=5' HORIZ. 1"=50'  
 DRAWN BY: DATE: 1/3/2008