

F.A. RTE.	SECTION	COUNTY	TOTAL SHEETS	SHEET NO.
353	11-5-N-1	COOK	74	24
STA.		TO STA.		
FED. ROAD DIST. NO. 1		ILLINOIS	FED. AID PROJECT	

DATE: _____ BY: _____
 CHECKED: _____
 DESIGNED: _____
 DRAWN: _____
 IN CHARGE: _____
 NO. _____
 TITLE: _____

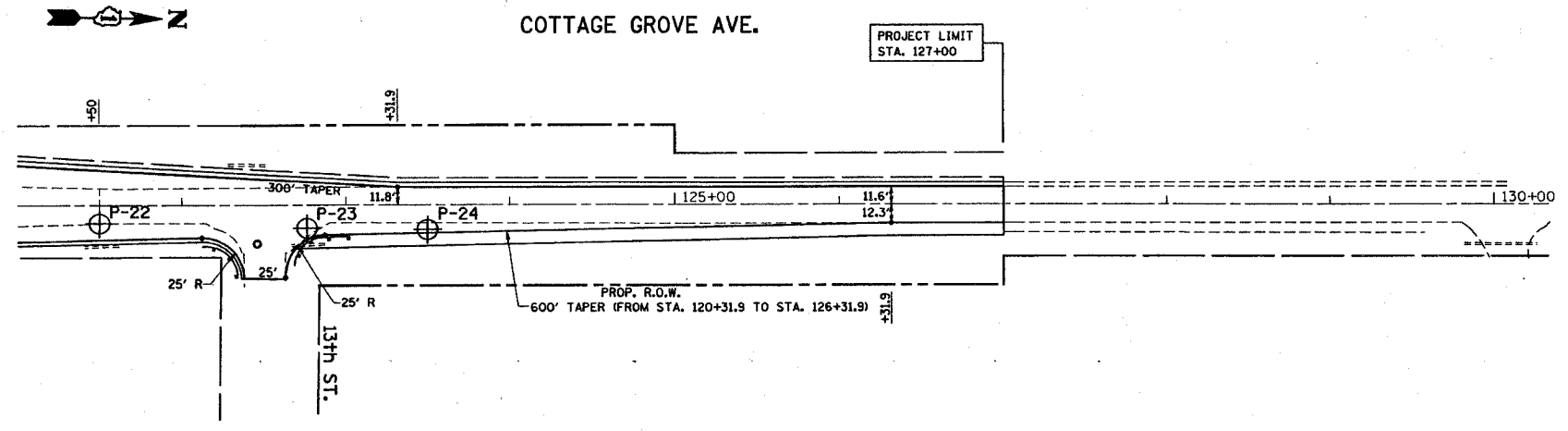

Bore Hole Number	Alignment Station	Offset from Center Line	Ground Surface Elevation (feet)	Depth to Top of Rock (feet)	Top of Rock Elevation (feet)
Traffic Signal Locations					
P-1	214+29	29' Lt.	668.12	8.8	659.3
P-2	114+38	30' Lt.	668.27	7.5	660.8
P-3	115+64	33' Rt.	668.71	5.6	663.1
P-4	215+62	22' Rt.	668.67	6.8	661.9
U.S. Route 30 (North Side)					
P-5	216+50	21' Lt.	669.22	6.5	662.7
P-7	217+51	22' Lt.	669.76	6.0	663.8
P-9	218+49	21' Lt.	670.28	6.9	663.4
U.S. Route 30 (South Side)					
P-4	215+62	22' Rt.	668.67	6.8	661.9
P-6	216+48	21' Rt.	669.02	6.5	662.5
P-8	217+51	21' Rt.	669.64	7.6	662.0
P-10	218+51	22' Rt.	670.03	7.5	662.5
Cottage Grove (East Side/ South Leg)					
P-11	108+08	31' Rt.	664.87	10.5	654.4
P-12	109+74	25' Rt.	666.84	9.6	657.2
P-13	110+58	25' Rt.	667.18	8.8	658.4
P-14	111+73	25' Rt.	667.54	11.5	656.0
P-15	112+73	25' Rt.	667.76	9.2	658.6
P-16	113+75	26' Rt.	668.43	10.9	657.5
Cottage Grove (East Side/ North Leg)					
P-3	115+64	33' Rt.	668.71	5.6	663.1
P-17	116+51	28' Rt.	668.58	5.3	663.3
P-18	117+51	24' Rt.	667.95	4.8	663.2
P-19	118+47	21' Rt.	667.68	2.0	665.7
P-20	119+47	18' Rt.	667.64	3.5	664.1
P-21	120+47	15' Rt.	667.40	2.9	664.5
P-22	121+50	14' Rt.	666.86	2.7	664.2
P-23	122+76	15' Rt.	663.46	5.5	658.0
P-24	123+50	16' Rt.	659.77	3.7	656.1

FOR INFORMATION ONLY

DATE: _____ BY: _____
 CHECKED: _____
 DESIGNED: _____
 DRAWN: _____
 IN CHARGE: _____
 NO. _____
 TITLE: _____

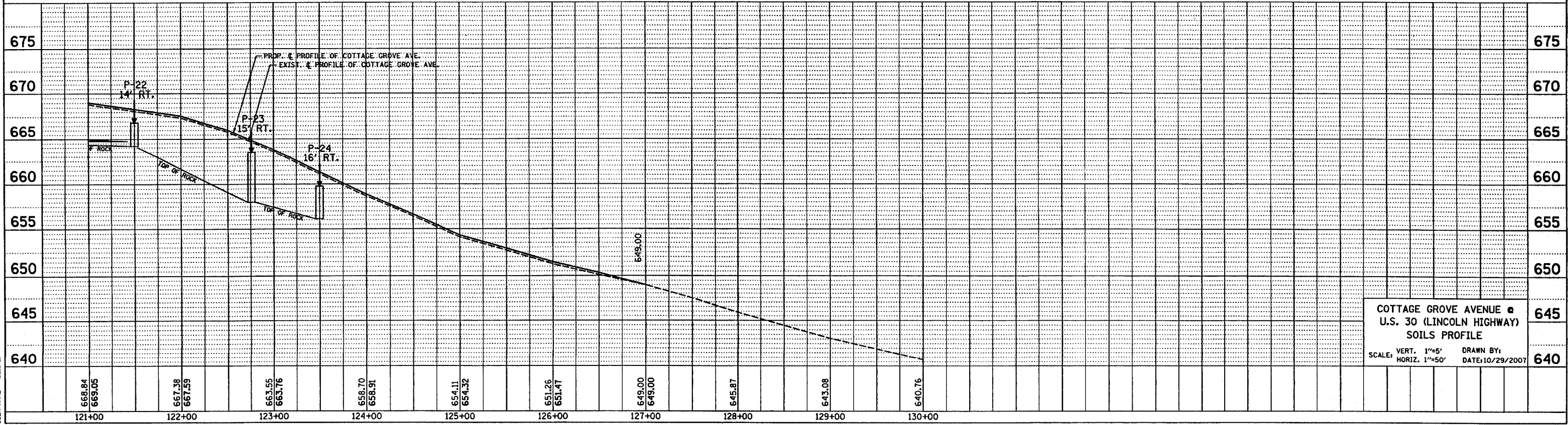

COTTAGE GROVE AVENUE & U.S. 30 (LINCOLN HIGHWAY) SOILS PROFILE
 VERT. SCALE: 1"=5'
 HORIZ. SCALE: 1"=50'
 DRAWN BY: _____
 DATE: 10/29/2007

DATE: 10/29/2007
 FILE NAME: C:\projects\62949\11-5-N-1\11-5-N-1.dwg
 PLOT SCALE: 1"=50'
 USER NAME: jward