

F.A.S. RTE.	SECTION	COUNTY	TOTAL SHEET SHEETS	NO.
1087	106T-1	STEPHENSON	78	15
STA. 965+00 TO STA. 971+00				
FED. ROAD DIST. NO.		ILLINOIS	FED. AID PROJECT	

PI STA. = 961+40.55
 EXIST. CURVE 270
 $\Delta = 38^\circ 59' 19''$ (LT)
 $D = 4^\circ 00' 25''$
 $R = 1,429.87'$
 $L = 506.18'$
 $E = 972.99'$
 $F = 86.95'$
 S.C. RUN = -----
 P.C. STA. = 956+34.37
 P.T. STA. = 966+07.37

- LEGEND**
- RIP RAP CL A4
 - PROPOSED DITCH FLOWLINE
 - EXISTING DITCH FLOWLINE
 - EXISTING OVERLAND FLOW
 - CONSTRUCTION LIMITS
 - TREE REMOVAL

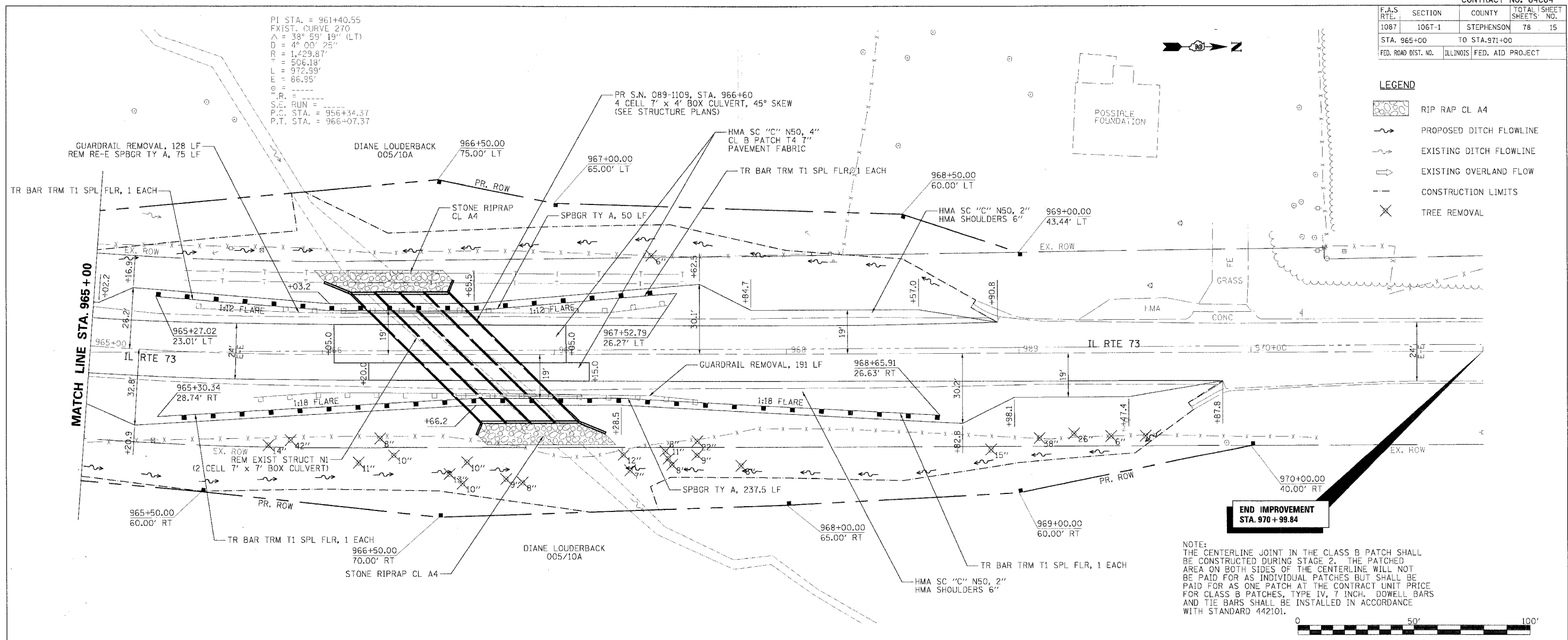

NOTE:
 THE CENTERLINE JOINT IN THE CLASS B PATCH SHALL BE CONSTRUCTED DURING STAGE 2. THE PATCHED AREA ON BOTH SIDES OF THE CENTERLINE WILL NOT BE PAID FOR AS INDIVIDUAL PATCHES BUT SHALL BE PAID FOR AS ONE PATCH AT THE CONTRACT UNIT PRICE FOR CLASS B PATCHES, TYPE IV, 7 INCH. DOWEL BARS AND TIE BARS SHALL BE INSTALLED IN ACCORDANCE WITH STANDARD 442101.

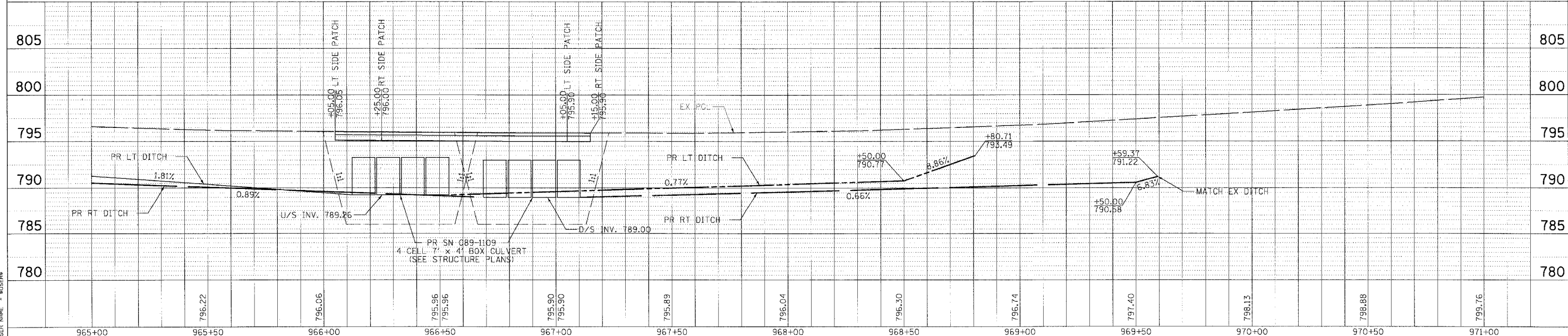
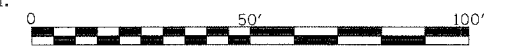

**PLAN & PROFILE
 PROPOSED SN 089-1109**

PLAN

DATE	BY	CHECKED

REVISIONS

NO.	DESCRIPTION

PROFILE

DATE	BY	CHECKED

REVISIONS

NO.	DESCRIPTION

PLOT DATE = 04/05/08
 PLOT NAME = 64C84_P15
 USER NAME = RUSBRN