

F.A.S. RTE.	SECTION	COUNTY	TOTAL SHEETS	SHEET NO.
1087	106T-1	STEPHENSON	78	17
STA. 1042+00 TO STA. 1048+00				
FED. ROAD DIST. NO.		ILLINOIS		FED. AID PROJECT

NOTE:
THE CENTERLINE JOINT IN THE CLASS B PATCH SHALL BE CONSTRUCTED DURING STAGE 2. THE PATCHED AREA ON BOTH SIDES OF THE CENTERLINE WILL NOT BE PAID FOR AS INDIVIDUAL PATCHES BUT SHALL BE PAID FOR AS ONE PATCH AT THE CONTRACT UNIT PRICE FOR CLASS B PATCHES (SPECIAL). DOWEL BARS AND TIE BARS SHALL BE INSTALLED IN ACCORDANCE WITH STANDARD 442101.

LEGEND

- TURF REINF MAT
- RIP RAP CL A4
- PROPOSED DITCH FLOWLINE
- EXISTING DITCH FLOWLINE
- EXISTING OVERLAND FLOW
- CONSTRUCTION LIMITS
- TREE REMOVAL

MATCH LINE STA. 1042+00

MATCH LINE STA. 1048+00

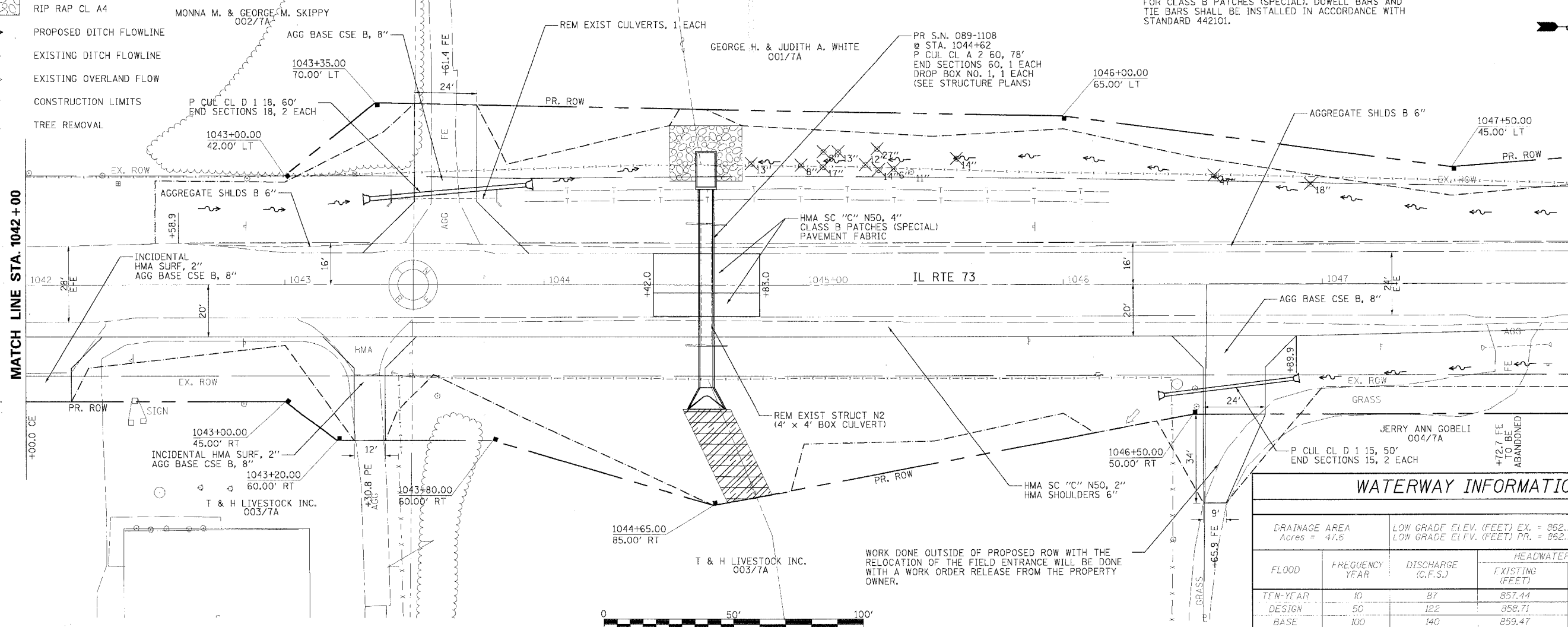

WATERWAY INFORMATION				
DRAINAGE AREA Acres = 47.6		LOW GRADE ELEV. (FEET) EX. = 862.59 @ STA. 1043+67.7 LOW GRADE ELEV. (FEET) PR. = 862.59 @ STA. 1043+67.7		
FLOOD	FREQUENCY YEAR	DISCHARGE (C.F.S.)	HEADWATER ELEVATION	
			EXISTING (FEET)	PROPOSED (FEET)
TEN-YEAR	10	87	857.41	856.53
DESIGN	50	122	859.71	857.20
BASE	100	140	859.47	857.86
MAXIMUM	500	193	862.26	859.76



WORK DONE OUTSIDE OF PROPOSED ROW WITH THE RELOCATION OF THE FIELD ENTRANCE WILL BE DONE WITH A WORK ORDER RELEASE FROM THE PROPERTY OWNER.



**PLAN & PROFILE
PROPOSED SN 089-1108**

DATE: _____
BY: _____
CHECKED: _____
DATE: _____

DATE: _____
BY: _____
CHECKED: _____
DATE: _____

PLT DATE = DATE
FILE NAME = FILE
USER NAME = USER