

F.A.S. RTE.	SECTION	COUNTY	TOTAL SHEETS	SHEET NO.
1087	106T-1	STEPHENSON	78	25
STA. 959+00		TO STA. 963+00		
FED. ROAD DIST. NO.		ILLINOIS FED. AID PROJECT		

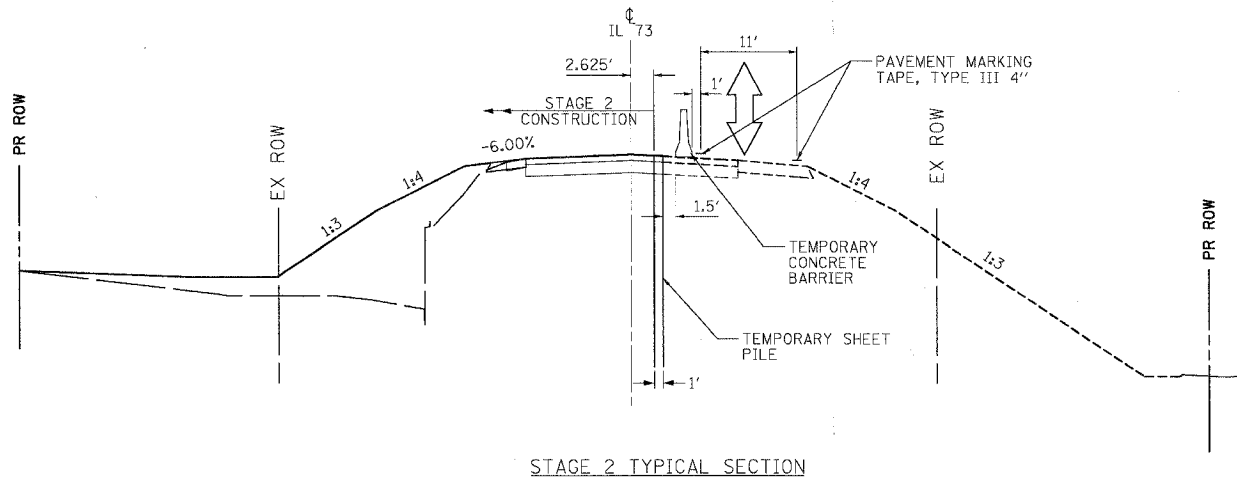

STAGE 2 TYPICAL SECTION

STAGE 2 CONSTRUCTION
 -CONSTRUCT UPSTREAM END OF PROPOSED 60" PIPE CULVERT
 -CONSTRUCT PATCH OVER PIPE CULVERT
 -CONSTRUCT HMA SHOULDER ON LEFT SIDE
 -CONSTRUCT AGGREGATE SHOULDER ON LEFT SIDE
 -CONSTRUCT PERMANENT PAVEMENT MARKINGS

STAGE 2 TRAFFIC
 USE STANDARD 701321, LANE CLOSURE, 2L, 2W, BRIDGE REPAIR WITH BARRIER FOR SETTING UP MAINTENANCE OF TRAFFIC FOR STAGE 2.
 USE STANDARD 701311, LANE CLOSURE 2L, 2W, MOVING OPERATIONS-DAY ONLY FOR PLACING PAVEMENT MARKINGS.
 USE STANDARD 701306 AS NEEDED FOR CONSTRUCTION OF SHOULDERS.
 USE STANDARDS 701001, 701006, 701011, AND 701311 AS NEEDED.

STAGE 2 NOTES
 THE USE OF STANDARD 701321 FOR ALL STAGES SHALL BE LIMITED 1 WEEK.
 CHANGEABLE MESSAGE SIGN SHALL BE INSTALLED 0.5 MILES PRIOR TO STOP BARS.

LEGEND

- DRUMS (PER STD. 701321)
- DOUBLE VERTICAL PANELS (25' C-C)
- TRAFFIC SIGNAL
- DIRECTION OF TRAFFIC
- INDUCTION LOOP DETECTOR
- TYPE III BARRICADE
- WORK ZONE

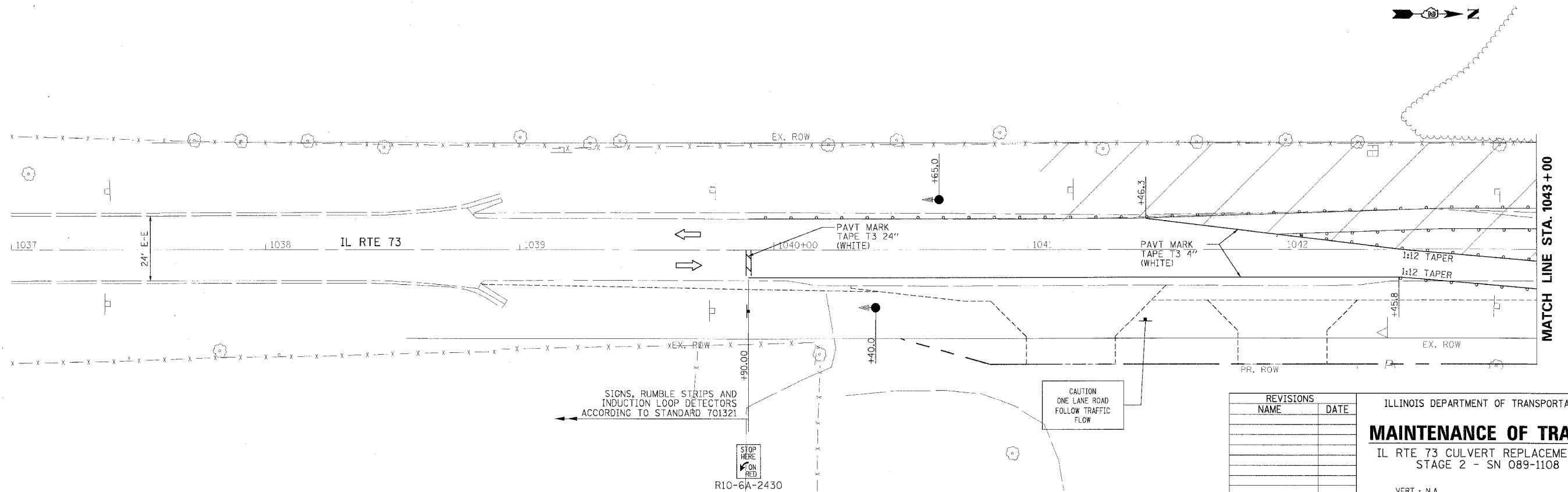

SIGNS, RUMBLE STRIPS AND INDUCTION LOOP DETECTORS ACCORDING TO STANDARD 701321

CAUTION ONE LANE ROAD FOLLOW TRAFFIC FLOW

STOP HERE ON RED R10-6A-2430

REVISIONS	
NAME	DATE

ILLINOIS DEPARTMENT OF TRANSPORTATION
MAINTENANCE OF TRAFFIC
 IL RTE 73 CULVERT REPLACEMENTS
 STAGE 2 - SN 089-1108

SCALE: VERT.: N.A.
 HORIZ.: 1:20
 DATE: OCTOBER 1, 2007

DRAWN BY: DLZ
 CHECKED BY: CB

PLOT DATE = 08/07/07
 FILE NAME = 081108.DWG
 PLOT SCALE = 1:20
 USER NAME = DLZ