

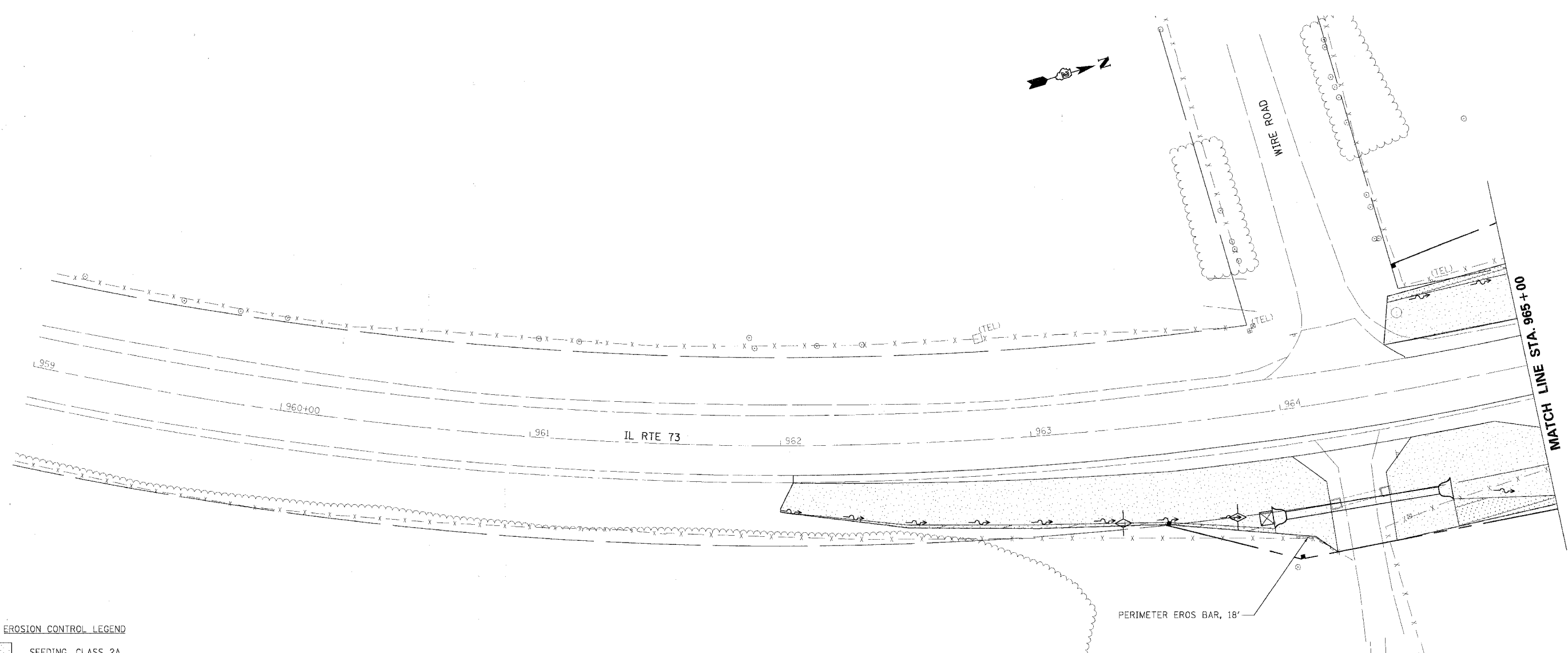

F.A.S. RTE.	SECTION	COUNTY	TOTAL SHEETS	SHEET NO.
1087	106T-1	STEPHENSON	78	27
STA. 959+00		TO STA. 965+00		
FED. ROAD DIST. NO.	ILLINOIS	FED. AID PROJECT		

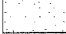
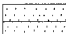

MATCH LINE STA. 965 + 00

EROSION CONTROL LEGEND

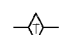
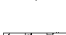
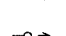
-  SEEDING, CLASS 2A
-  SEEDING, CLASS 4
-  INLET AND PIPE PROTECTION
-  TEMPORARY DITCH CHECKS
-  PERIMETER EROSION BARRIER
-  PROPOSED DITCH FLOW

PERIMETER EROS BAR, 18'

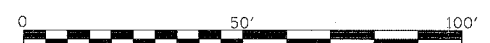

REVISIONS	
NAME	DATE

NOTE:
 EROSION CONTROL BLANKET SHALL BE USED ON ALL SLOPES STEEPER THAN 3:1 AND ON THE BOTTOM OF ALL DITCHES.
 MULCH, METHOD 2 SHALL BE USED WITH ALL OTHER SEEDING OPERATIONS.

ILLINOIS DEPARTMENT OF TRANSPORTATION
EROSION CONTROL PLAN
 IL RTE 73 CULVERT REPLACEMENTS
 SN 089-1109

VERT. : N.A.
 SCALE: HORIZ. : 1:20
 DATE : OCTOBER 1, 2007
 DRAWN BY: DLZ
 CHECKED BY: GB

PLOT DATE = #DATE#
 FILE NAME = #FILES#
 PLOT SCALE = #SCALE#
 USER NAME = #USER#