

F.A.I. RTE.	SECTION	COUNTY	TOTAL SHEETS	SHEET NO.
80	(50-5) HBK-2	LASALLE	331	26
STA. 300 + 00.00 TO STA. 313 + 00.00				
FED. ROAD DIST. NO. ILLINOIS FED. AID PROJECT				

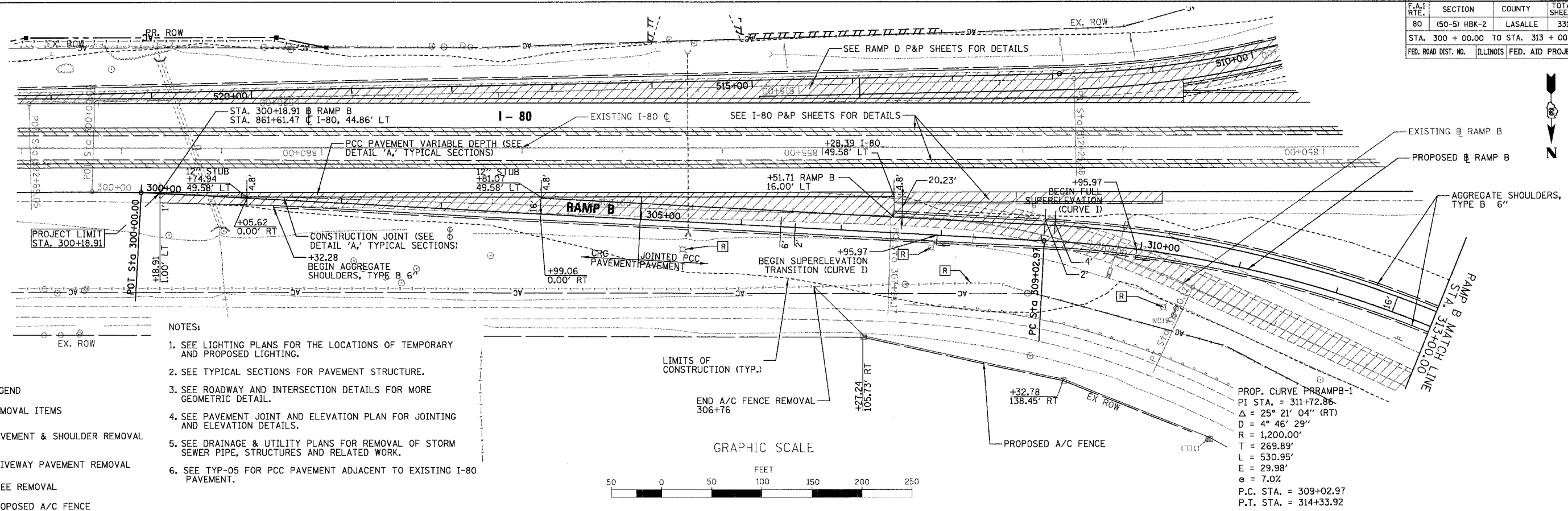

DATE	
BY	
DESIGNED	
CHECKED	
DATE	
BY	
NO.	



- NOTES:
1. SEE LIGHTING PLANS FOR THE LOCATIONS OF TEMPORARY AND PROPOSED LIGHTING.
 2. SEE TYPICAL SECTIONS FOR PAVEMENT STRUCTURE.
 3. SEE ROADWAY AND INTERSECTION DETAILS FOR MORE GEOMETRIC DETAIL.
 4. SEE PAVEMENT JOINT AND ELEVATION PLAN FOR JOINTING AND ELEVATION DETAILS.
 5. SEE DRAINAGE & UTILITY PLANS FOR REMOVAL OF STORM SEWER PIPE, STRUCTURES AND RELATED WORK.
 6. SEE TYP-05 FOR PCC PAVEMENT ADJACENT TO EXISTING I-80 PAVEMENT.

- LEGEND
- R REMOVAL ITEMS
 - PAVEMENT & SHOULDER REMOVAL
 - DRIVEWAY PAVEMENT REMOVAL
 - TREE REMOVAL
 - PROPOSED A/C FENCE

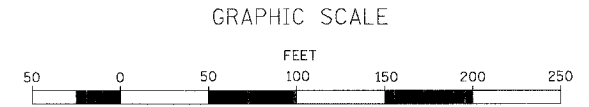

PROP. CURVE PRAMPB-1
 PI STA. = 311+72.86
 $\Delta = 25^\circ 21' 04''$ (RT)
 $D = 4^\circ 46' 29''$
 $R = 1,200.00'$
 $T = 269.89'$
 $L = 530.95'$
 $E = 29.98'$
 $e = 7.0\%$
 P.C. STA. = 309+02.97
 P.T. STA. = 314+33.92

DATE	
BY	
DESIGNED	
CHECKED	
DATE	
BY	
NO.	

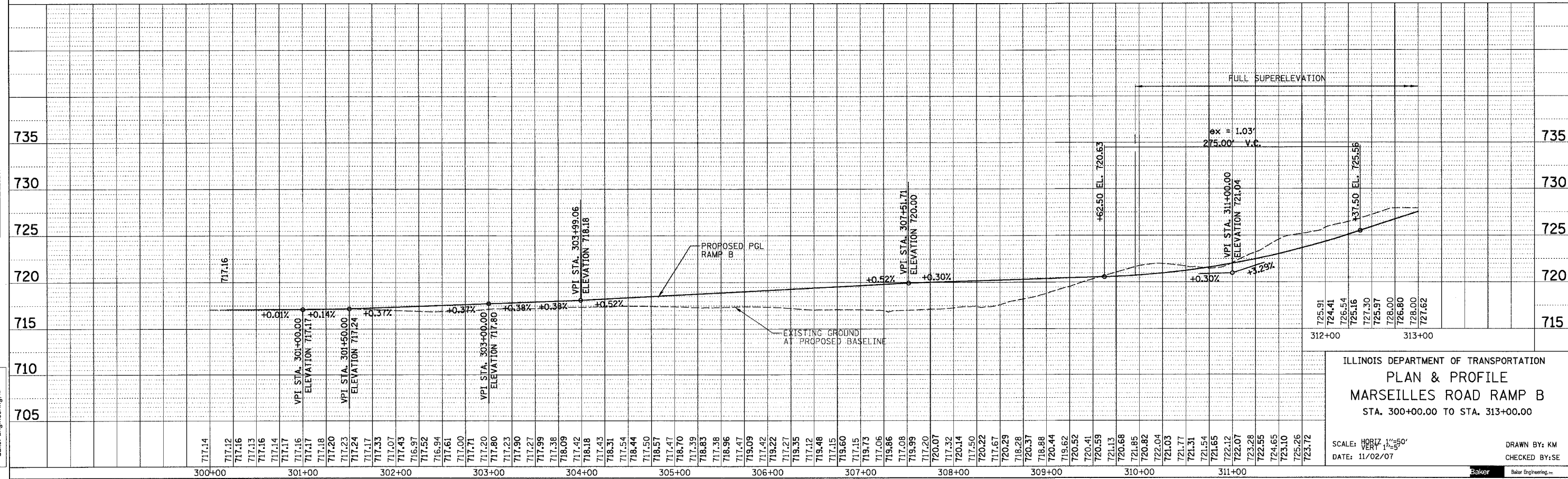

ILLINOIS DEPARTMENT OF TRANSPORTATION
 PLAN & PROFILE
 MARSEILLES ROAD RAMP B
 STA. 300+00.00 TO STA. 313+00.00

SCALE: HORIZ. 1"=50'
 VERT. 1"=5'

DATE: 11/02/07

DRAWN BY: KM
 CHECKED BY: SE

