

F.A.I. RTE.	SECTION	COUNTY	TOTAL SHEETS	SHEET NO.
80	(50-5) HBK-2	LASALLE	331	27
STA. 313+00.00 TO STA. 321+20.18				
FED. ROAD DIST. NO. ILLINOIS FED. AID PROJECT				

- NOTES:
- SEE LIGHTING PLANS FOR THE LOCATIONS OF TEMPORARY AND PROPOSED LIGHTING
 - SEE TYPICAL SECTIONS FOR PAVEMENT STRUCTURE.
 - SEE ROADWAY AND INTERSECTION DETAILS FOR MORE GEOMETRIC DETAIL.
 - SEE PAVEMENT JOINT AND ELEVATION PLAN FOR JOINTING AND ELEVATION DETAILS.
 - SEE DRAINAGE & UTILITY PLANS FOR REMOVAL OF STORM SEWER PIPE, STRUCTURES AND RELATED WORK.
 - SEE TYP-05 FOR PCC PAVEMENT ADJACENT TO EXISTING I-80 PAVEMENT.

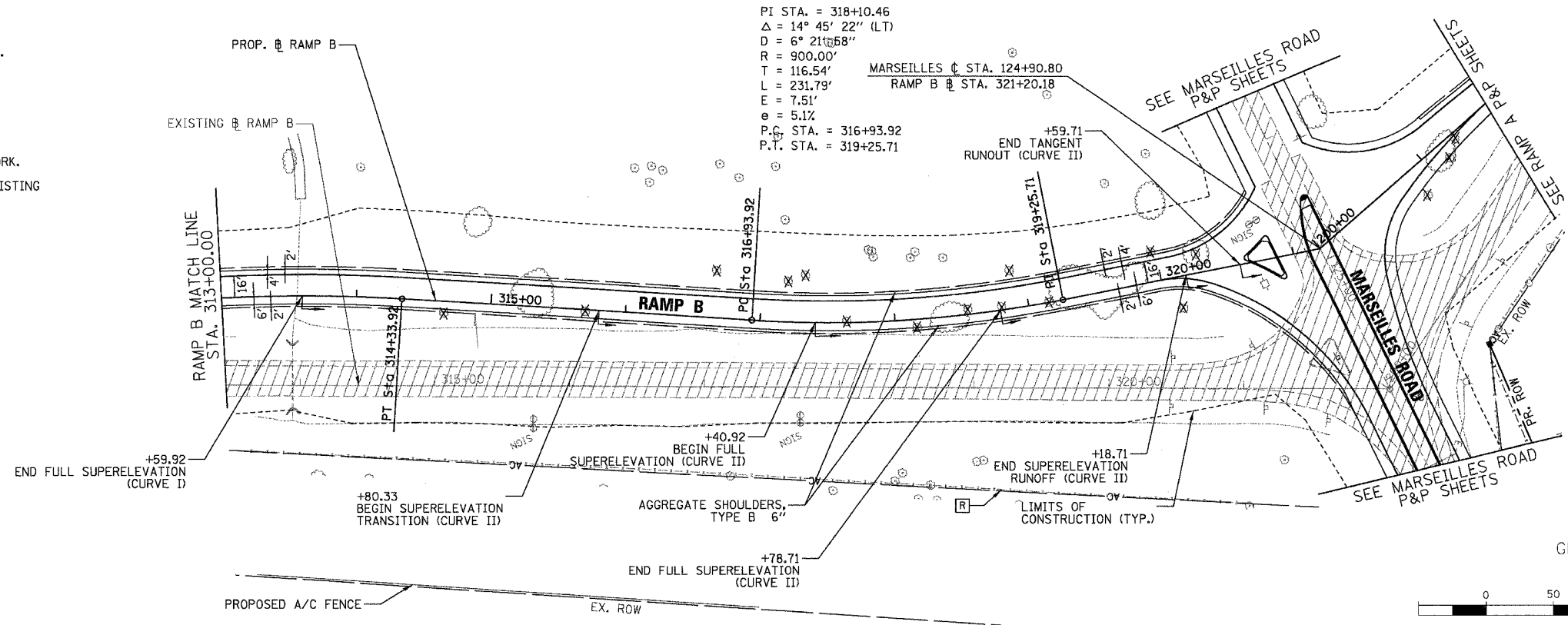

- LEGEND
- R REMOVAL ITEMS
 - PAVEMENT & SHOULDER REMOVAL
 - DRIVEWAY PAVEMENT REMOVAL
 - X TREE REMOVAL
 - - - - - PROPOSED A/C FENCE

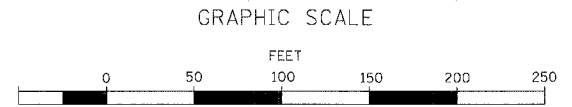

PLAN	SURVEYED	DATE
NOTE BOOK NO.	PLANNED	
	ALIGNED	
	CHECKED	
	BY	
	DATE	

PROFILE	SURVEYED	DATE
NOTE BOOK NO.	PLANNED	
	ALIGNED	
	CHECKED	
	BY	
	DATE	

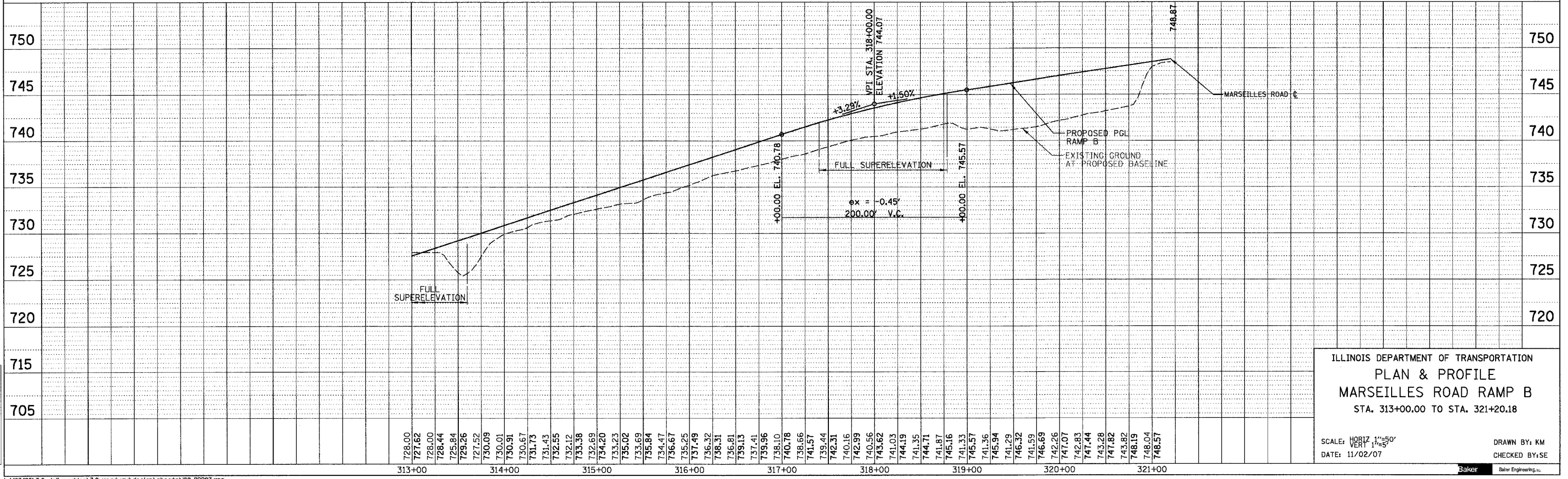

ILLINOIS DEPARTMENT OF TRANSPORTATION
 PLAN & PROFILE
 MARSEILLES ROAD RAMP B
 STA. 313+00.00 TO STA. 321+20.18

SCALE: HORIZ. 1"=50'
 VERT. 1"=5'

DATE: 11/02/07

DRAWN BY: KM
 CHECKED BY: SE

