

F.A.I. RTE.	SECTION	COUNTY	TOTAL SHEETS	SHEET NO.
80	(50-5) HBK-2	LASALLE	331	31
STA. 512 + 00.00 TO STA. 526 + 44.77				
FED. ROAD DIST. NO. ILLINOIS FED. AID PROJECT				



DATE	BY
DATE	BY

DATE	BY
DATE	BY

Baker
Baker Engineering, Inc.

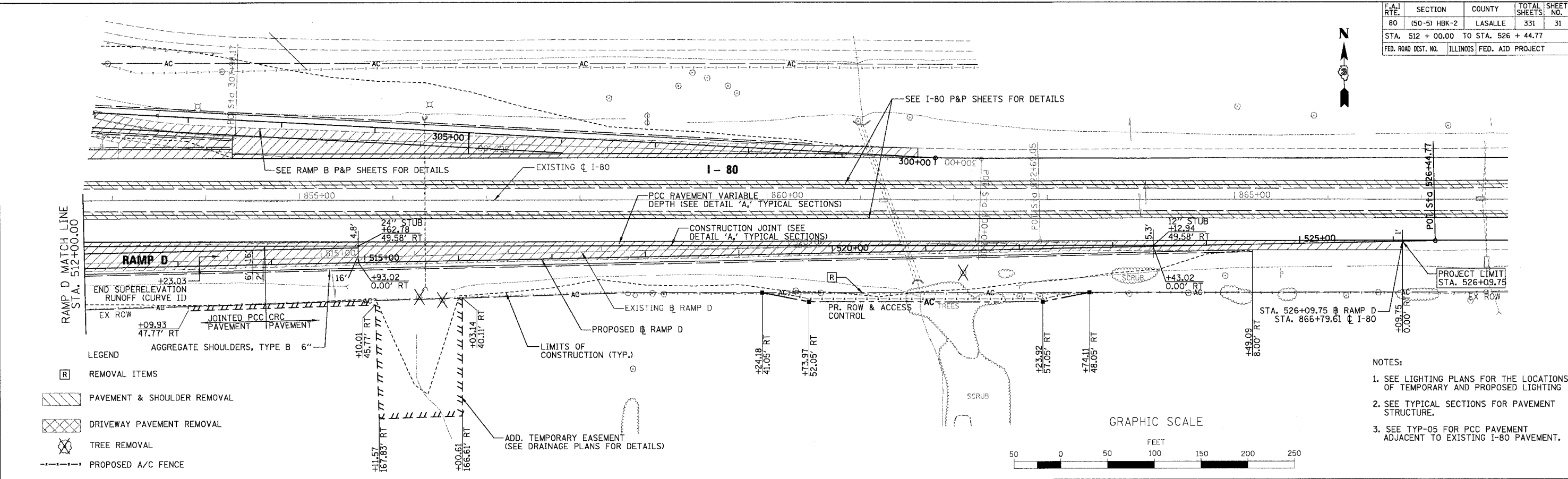

- NOTES:
- SEE LIGHTING PLANS FOR THE LOCATIONS OF TEMPORARY AND PROPOSED LIGHTING
 - SEE TYPICAL SECTIONS FOR PAVEMENT STRUCTURE.
 - SEE TYP-05 FOR PCC PAVEMENT ADJACENT TO EXISTING I-80 PAVEMENT.

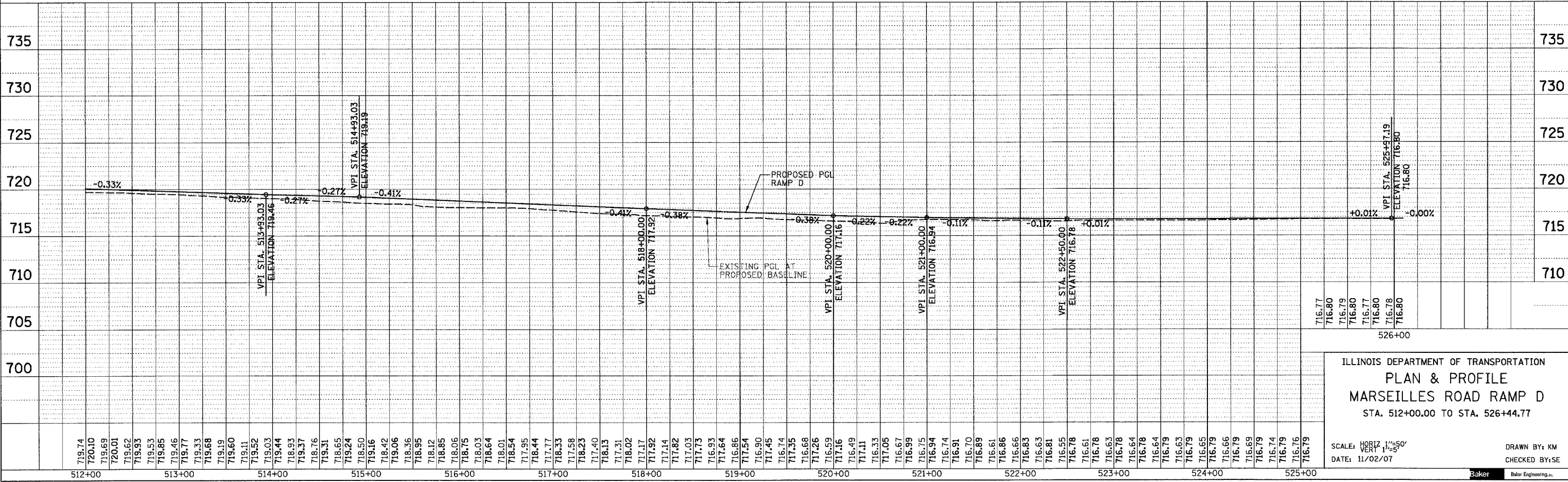

ILLINOIS DEPARTMENT OF TRANSPORTATION
PLAN & PROFILE
MARSEILLES ROAD RAMP D
 STA. 512+00.00 TO STA. 526+44.77

SCALE: HORIZ 1"=50'
 VERT 1"=5'

DATE: 11/02/07

DRAWN BY: KM
 CHECKED BY: SE

n:\071496\3.0 deliverables\3.2 roadway\design\sheet\80.RPP11.rpp
 11/5/2007