

F.A.I. RTE.	SECTION	COUNTY	TOTAL SHEETS	SHEET NO.
80	(50-5) HBK-2	LASALLE	331	38
STA. 860+00.00 TO STA. 870+00.00				
FED. ROAD DIST. NO.		ILLINOIS FED. AID PROJECT		

- NOTES:
- SEE LIGHTING PLANS FOR THE LOCATIONS OF TEMPORARY AND PROPOSED LIGHTING
 - SEE TYPICAL SECTIONS FOR PAVEMENT STRUCTURE.

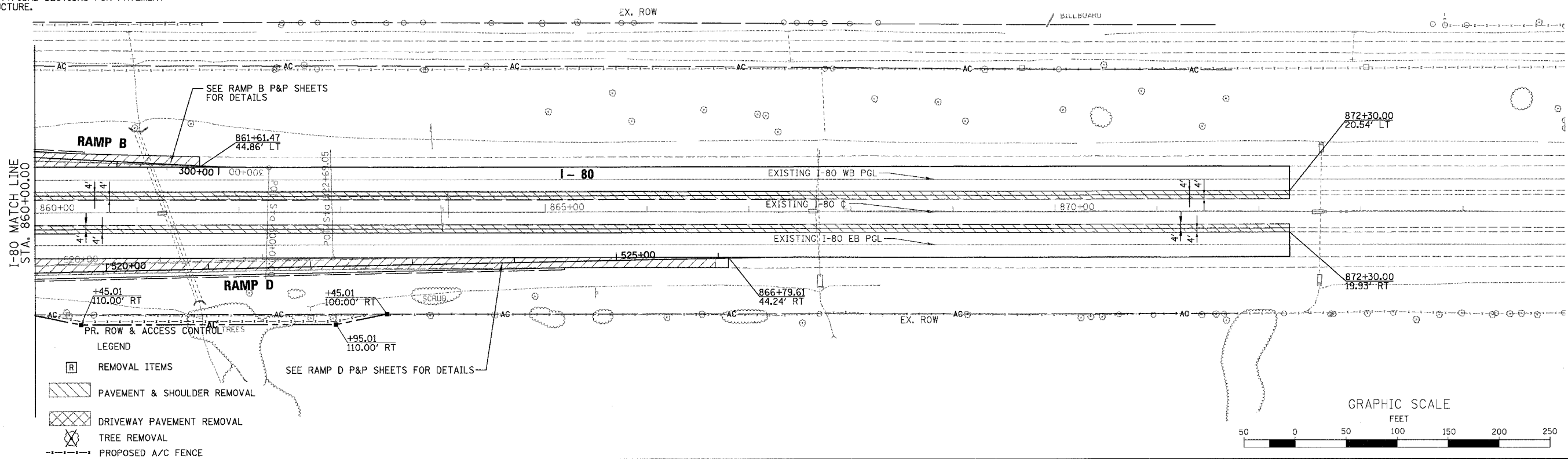

DATE	BY	NO.

DATE	BY	NO.

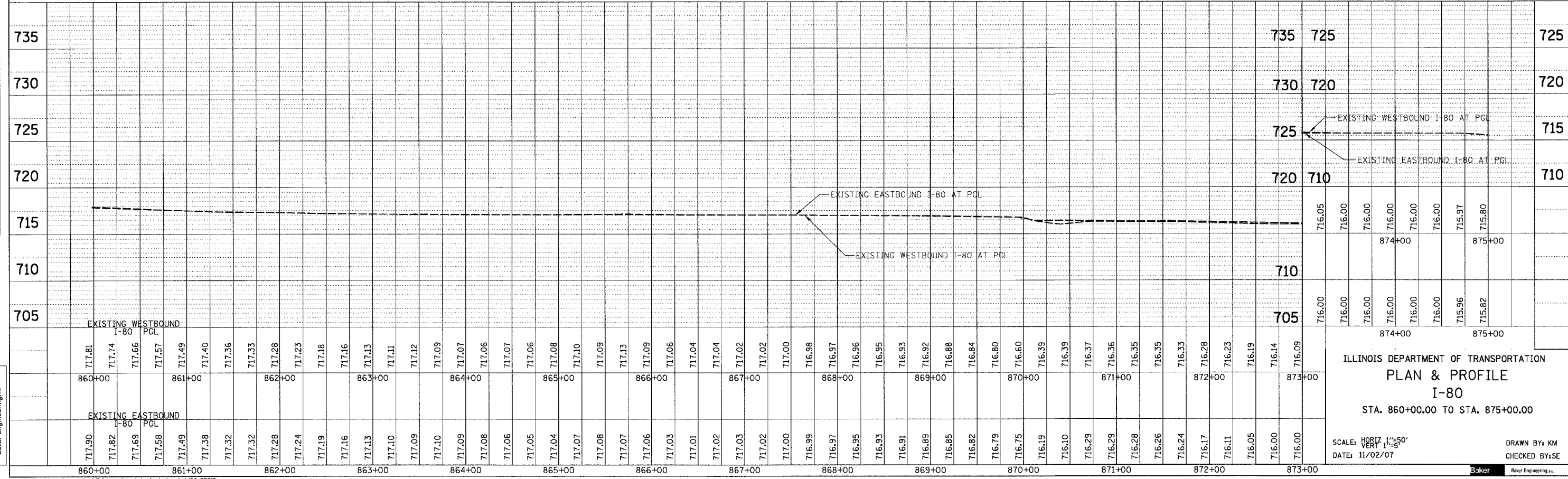

ILLINOIS DEPARTMENT OF TRANSPORTATION
 PLAN & PROFILE
 I-80
 STA. 860+00.00 TO STA. 875+00.00

SCALE: HORIZ. 1"=50'
 VERT. 1"=5'
 DATE: 11/02/07
 DRAWN BY: KM
 CHECKED BY: SE



\\107496\3.0 deliverables\3.2 roadway\design\sheet\80.RPP17.rpp 11/5/2007