

F.A.I. RTE.	SECTION	COUNTY	TOTAL SHEETS	SHEET NO.
80	(50-5) HBK-2	LASALLE	331	58
STA. 312+20.18 TO STA. 300+00.00				
FED. ROAD DIST. NO. ILLINOIS		FED. AID PROJECT		

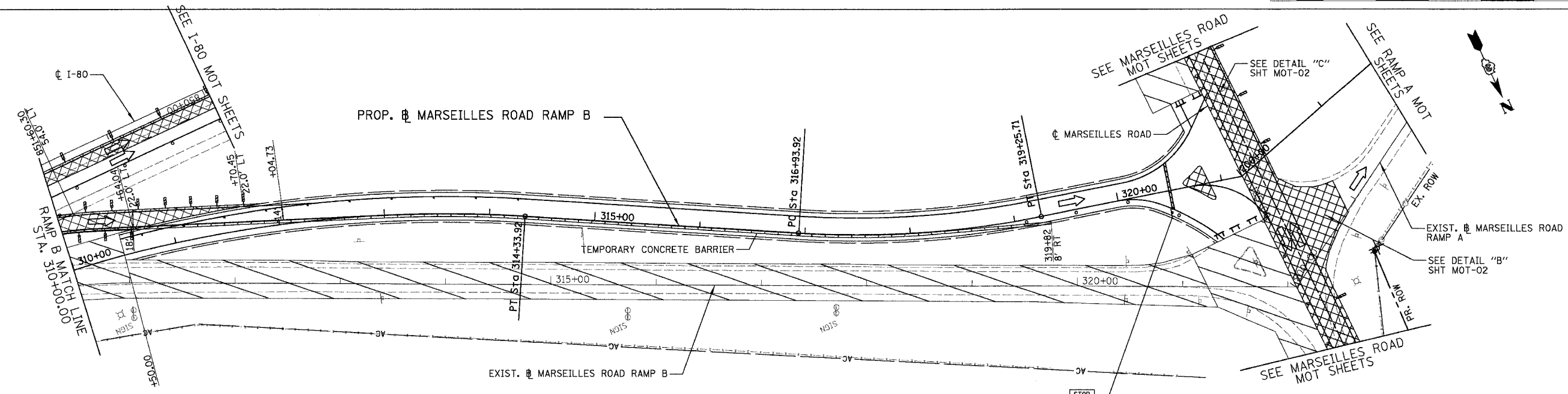

- LEGEND**
- DRUMS WITH BI-DIRECTIONAL STEADY BURN LIGHTS @ 50' CENTERS, 25' CENTERS ALONG TAPERS AND 12' CENTERS ALONG RADIUS RETURNS
  - ➔ TRAFFIC DIRECTION
  - ▬ DOUBLE VERTICAL PANELS (BACK TO BACK) WITH BI-DIRECTIONAL STEADY BURNING LIGHTS
  - ⊥ TYPE III BARRICADES WITH FLASHING LIGHTS
  - ▨ WORK ZONE
  - ▩ TEMPORARY PAVEMENT
  - ▬ ARROW BOARD
  - ▬ TEMP. CONCRETE BARRIER

STOP HERE ON RED  
R10-6A-2430  
STA. 320+50

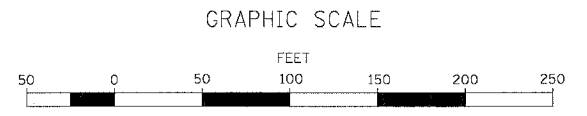
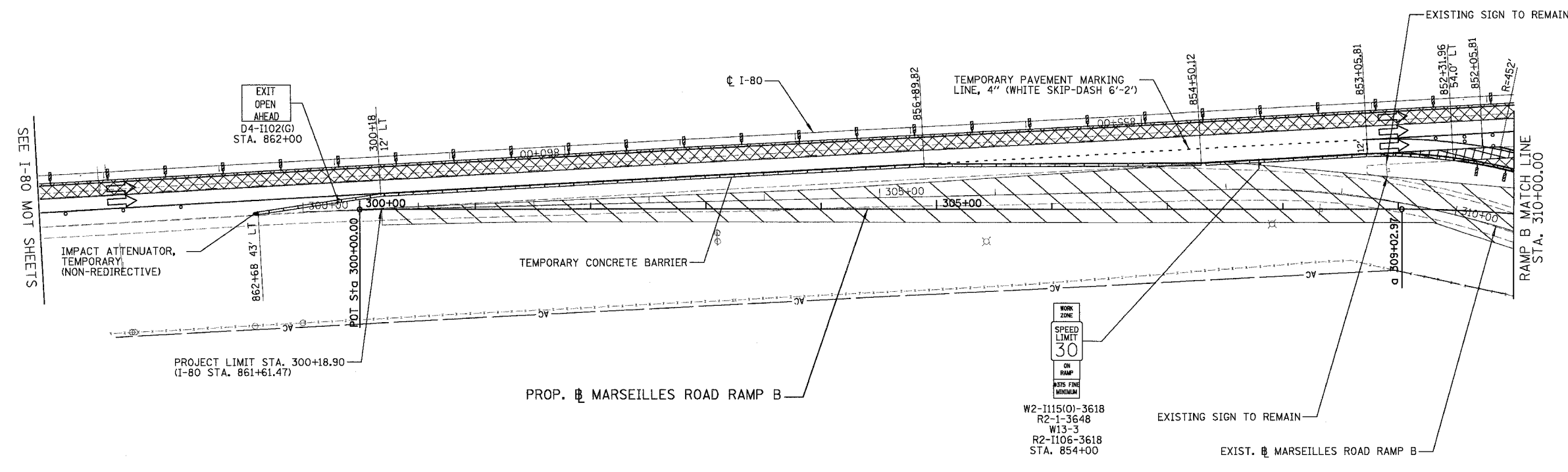

REVISIONS	
NAME	DATE

ILLINOIS DEPARTMENT OF TRANSPORTATION  
**MAINTENANCE OF TRAFFIC  
 STAGE 1B**  
 MARSEILLES ROAD RAMP B  
 SCALE: 1"=50'  
 DATE: 11/02/07  
 DRAWN BY: KM  
 CHECKED BY: SE