

F.A.I. RTE.	SECTION	COUNTY	TOTAL SHEETS	SHEET NO.
80	(50-5) HBK-2	LASALLE	331	64
STA. 200+00.00 TO STA. 226+09.18				
FED. ROAD DIST. NO.		ILLINOIS	FED. AID PROJECT	

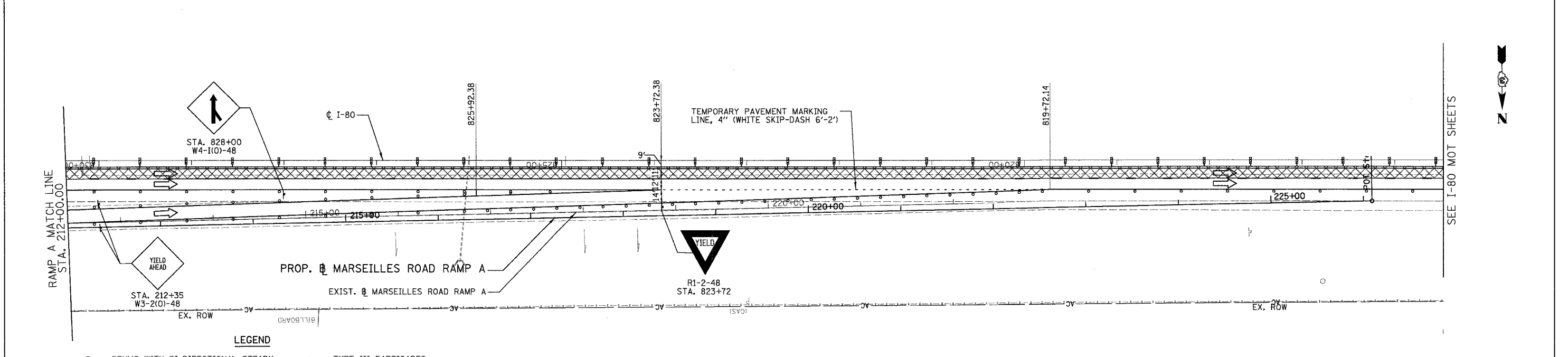
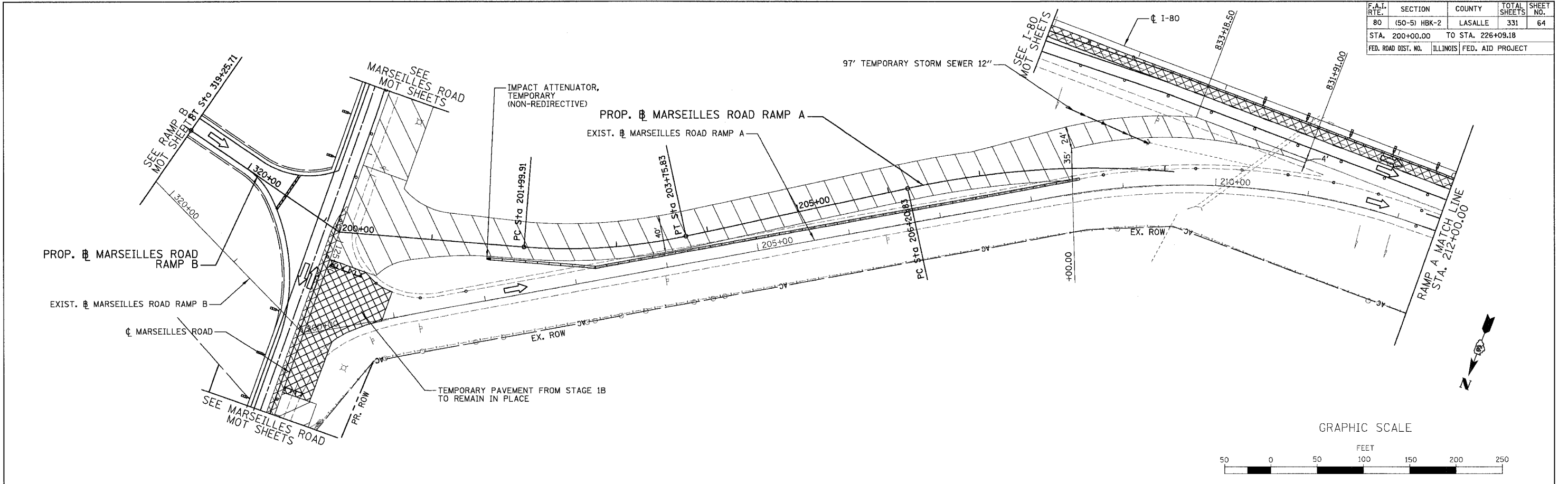

LEGEND

○	DRUMS WITH BI-DIRECTIONAL STEADY BURN LIGHTS @ 50' CENTERS, 25' CENTERS ALONG TAPERS AND 12' CENTERS ALONG RADIUS RETURNS	⊥	TYPE III BARRICADES WITH FLASHING LIGHTS
➔	TRAFFIC DIRECTION	▨	WORK ZONE
⏏	DOUBLE VERTICAL PANELS (BACK TO BACK) WITH BI-DIRECTIONAL STEADY BURNING LIGHTS	▩	TEMPORARY PAVEMENT
		▬	ARROW BOARD
		—	TEMP. CONCRETE BARRIER

REVISIONS	
NAME	DATE

ILLINOIS DEPARTMENT OF TRANSPORTATION

MAINTENANCE OF TRAFFIC

STAGE 2A

Marseilles Road Ramp A

SCALE: 1"=50'

DATE: 11/02/07

DRAWN BY: KM

CHECKED BY: SE

