

F.A.I. RTE.	SECTION	COUNTY	TOTAL SHEETS	SHEET NO.
80	(50-5) HBK-2	LASALLE	331	78
STA. 3000+00.00 TO STA. 3013+12.25				
FED. ROAD DIST. NO. ILLINOIS FED. AID PROJECT				

PROP. CURVE TMRAMPB1
 PI STA. = 3009+54.86
 $\Delta = 22^\circ 15' 32''$ (RT)
 $D = 13^\circ 01' 18''$
 $R = 440.00'$
 $T = 86.56'$
 $L = 170.94'$
 $E = 8.43'$
 $e = 7.7\%$
 P.C. STA. = 3008+68.30
 P.T. STA. = 3010+39.23

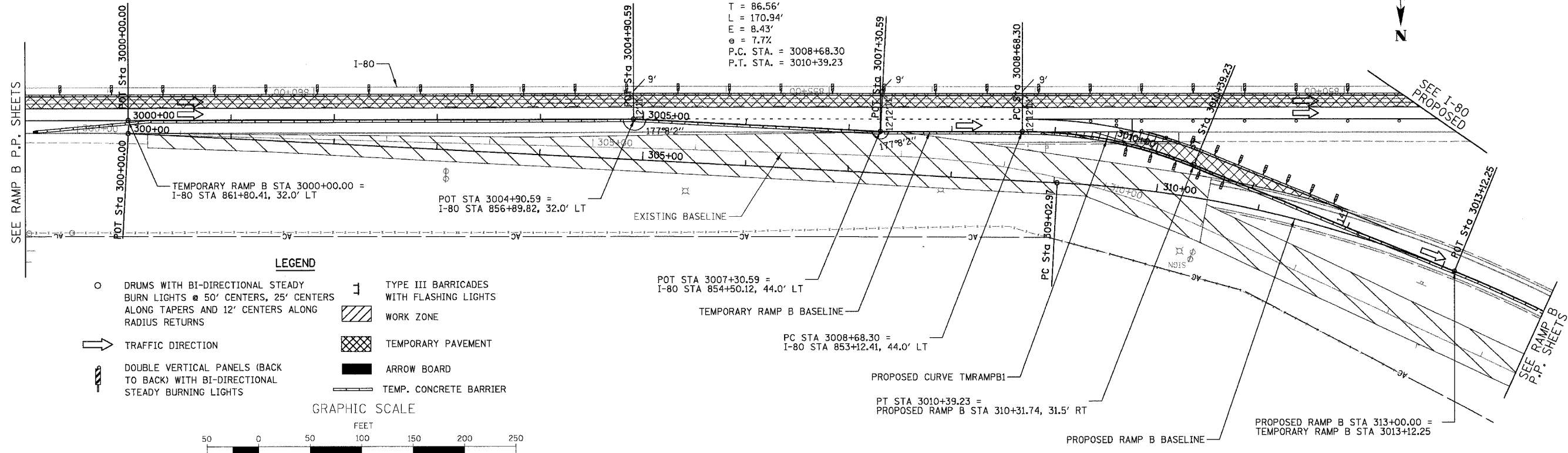

- LEGEND**
- DRUMS WITH BI-DIRECTIONAL STEADY BURN LIGHTS @ 50' CENTERS, 25' CENTERS ALONG TAPERS AND 12' CENTERS ALONG RADIUS RETURNS
 - ➔ TRAFFIC DIRECTION
 - ▬ DOUBLE VERTICAL PANELS (BACK TO BACK) WITH BI-DIRECTIONAL STEADY BURNING LIGHTS
 - ⌋ TYPE III BARRICADES WITH FLASHING LIGHTS
 - ▨ WORK ZONE
 - ▩ TEMPORARY PAVEMENT
 - ▬ ARROW BOARD
 - ▬ TEMP. CONCRETE BARRIER



PLAN	SURVEYED	BY	DATE
	NOTED		
	CHECKED		
	BY		
	NO. OF PAGES CHECKED		
	ADD FILE NAME		

PROFILE	SURVEYED	BY	DATE
	NOTED		
	CHECKED		
	BY		
	NO. OF PAGES CHECKED		
	STRUCTURE NOTATIONS CHNG		

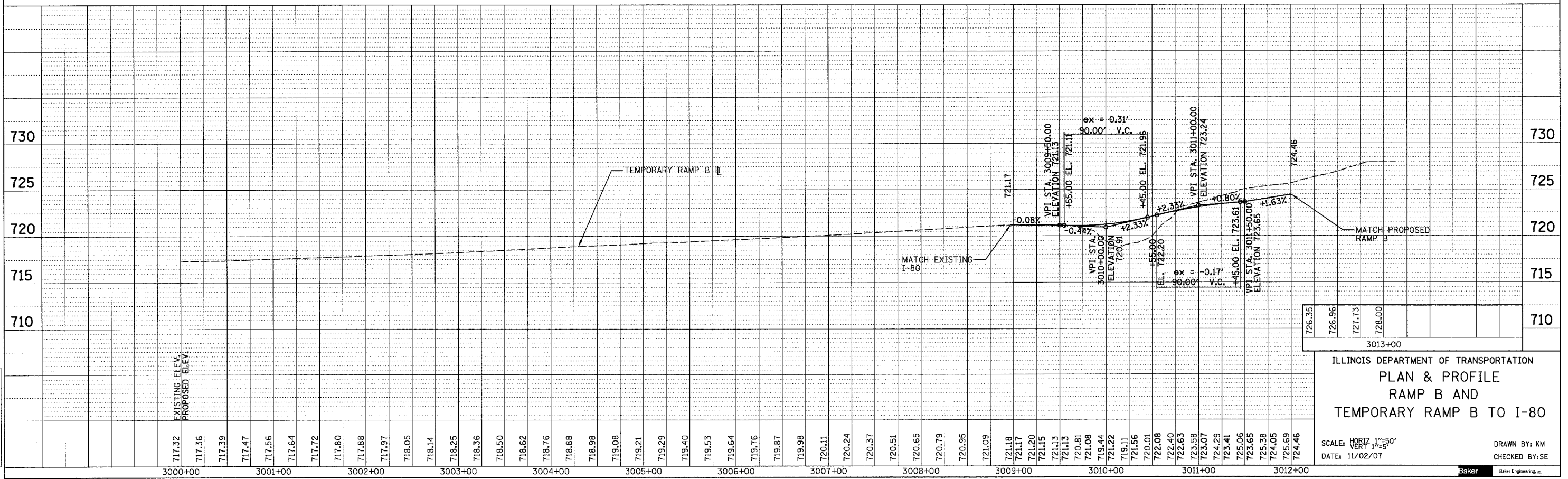

ILLINOIS DEPARTMENT OF TRANSPORTATION
PLAN & PROFILE
RAMP B AND
TEMPORARY RAMP B TO I-80

SCALE: HORIZ. 1"=50'
 VERT. 1"=5'

DATE: 11/02/07

DRAWN BY: KM
 CHECKED BY: SE

h:\07496\3.0 dellverables\3.2 roadway\design\sheets\80_M0137.mot
 11/5/2007