

F.A.I. RTE.	SECTION	COUNTY	TOTAL SHEETS	SHEET NO.
80	(50-5) HBK-2	LASALLE	331	97
STA. 300+00.00 TO STA. 313+00.00				
FED. ROAD DIST. NO.		ILLINOIS FED. AID PROJECT		

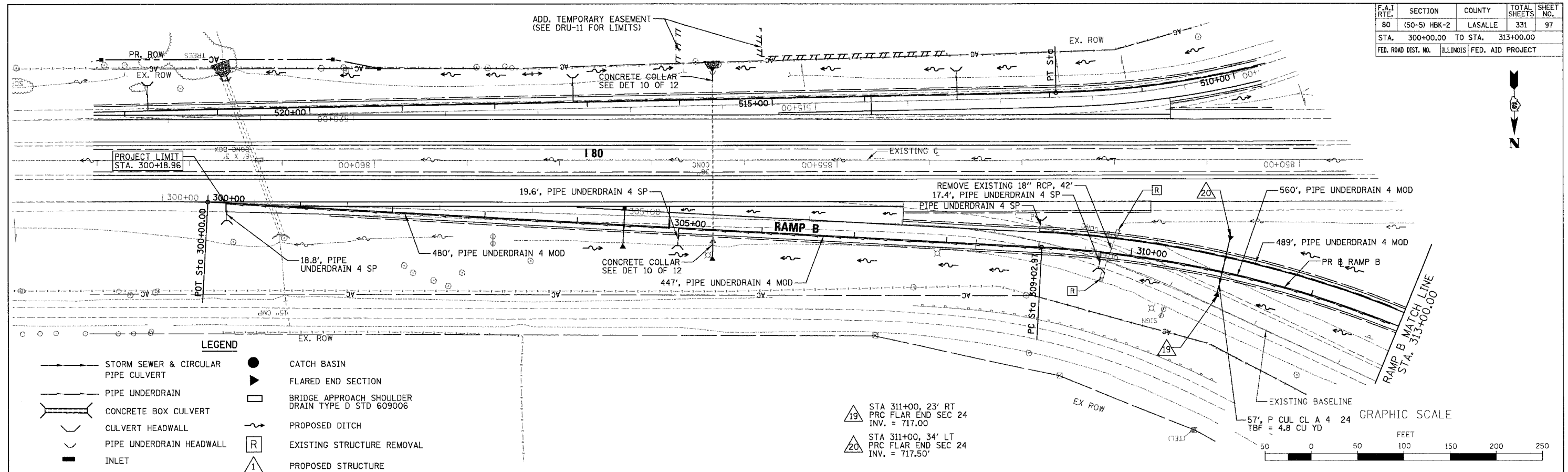

DATE	BY

DATE	BY

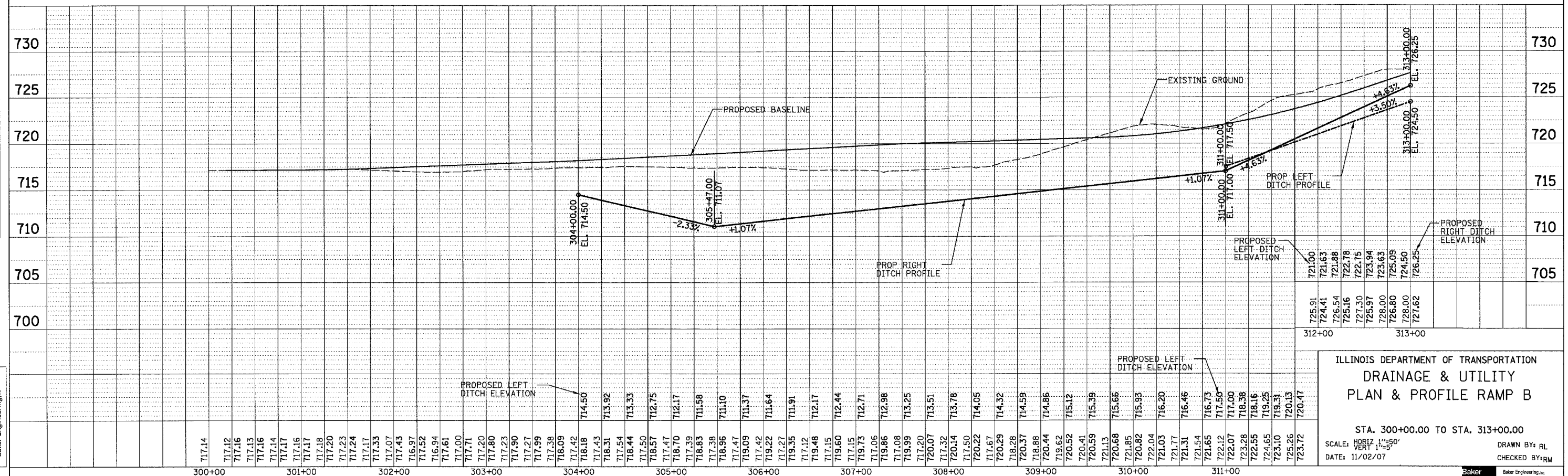

**ILLINOIS DEPARTMENT OF TRANSPORTATION  
DRAINAGE & UTILITY  
PLAN & PROFILE RAMP B**

STA. 300+00.00 TO STA. 313+00.00

SCALE: HORIZ 1"=50'  
DATE: 11/02/07

DRAWN BY: RL  
CHECKED BY: RM



h:\07496\3.0 deliverables\3.1 drainage\Design\Sheets\80\_DRU06.dru  
11/5/2007