

F.A.I. RTE.	SECTION	COUNTY	TOTAL SHEETS	SHEET NO.
80	50-SHBK-2	LASALLE	331	153
STA. 105+00		TO STA. 136+00		
FED. ROAD DIST. NO. 7 ILLINOIS FED. AID PROJECT				

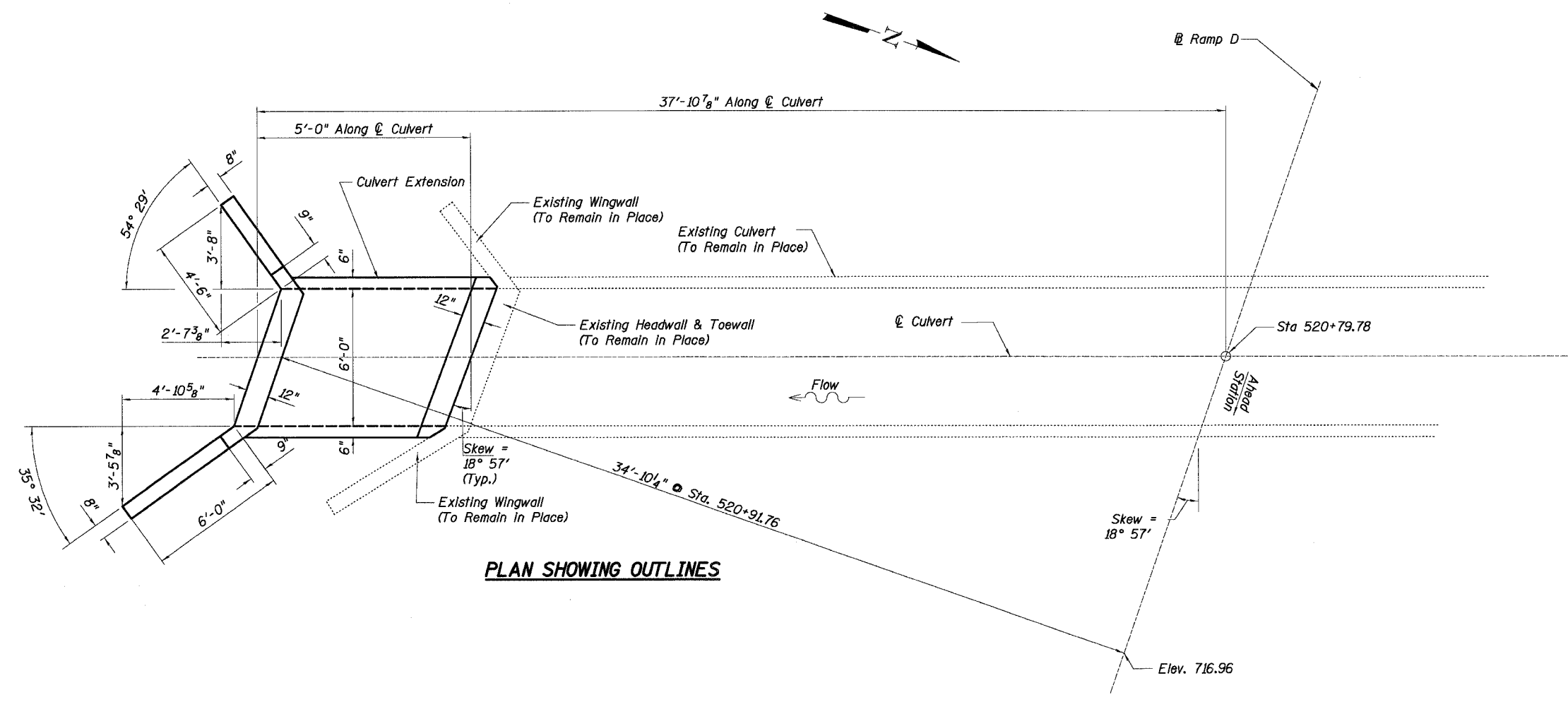

PLAN SHOWING OUTLINES

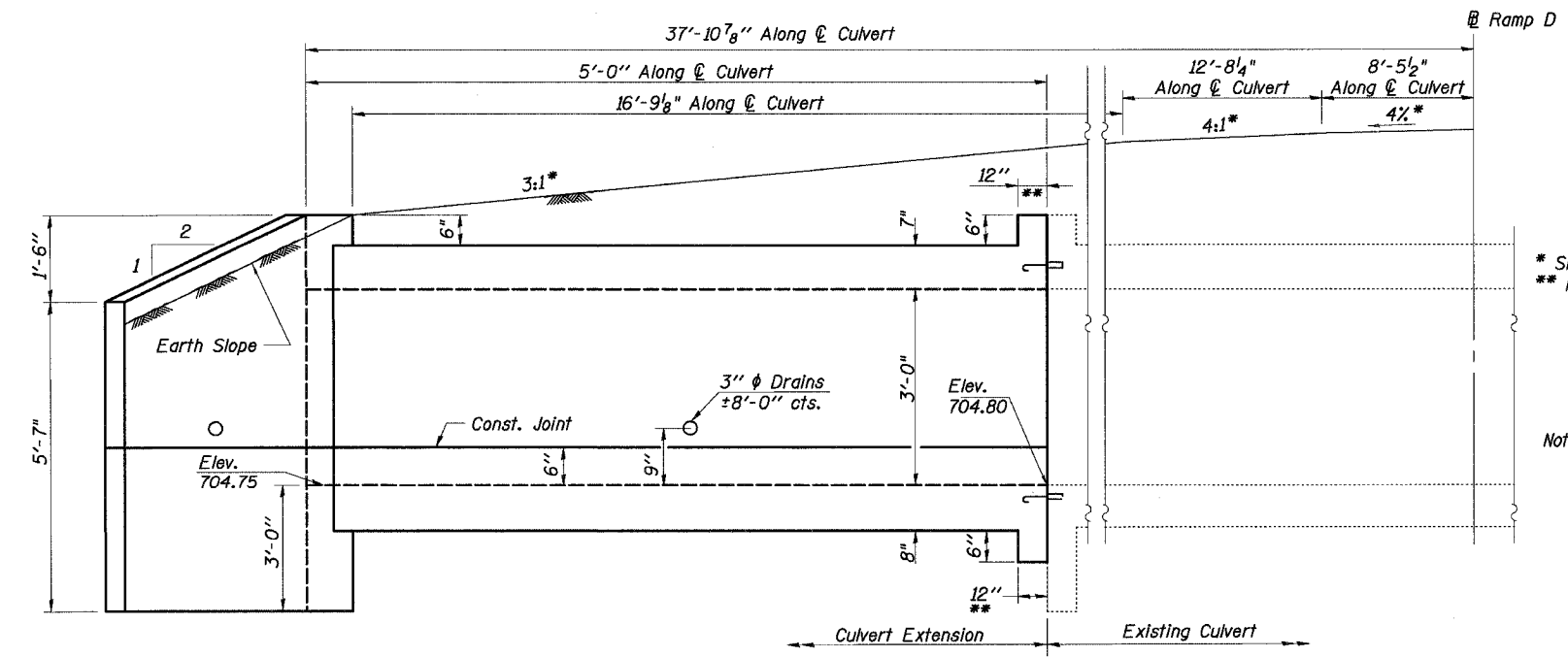

ELEVATION

* Slopes are Normal to @ Ramp D
 ** Normal to Face of Component

Note: Existing Invert Elevation at North End of Culvert = 706.50
 Existing Culvert Length Along @ Culvert is Approximately 177'-5"

REVISIONS	
NAME	DATE

Baker
 Baker Engineering, Inc.

ILLINOIS DEPARTMENT OF TRANSPORTATION
6'x3' BOX CULVERT EXTENSION
GENERAL PLAN & ELEVATION
 MARSEILLES ROAD (FAS Rt. 268)
 OVER I-80 (F.A.I. ROUTE 80)
 STRUCTURE NUMBER 050-0245
 LA SALLE COUNTY SECTION 50-SHBK-2
 STATION 120+00.08
 DATE: 11/02/07 DESIGNED: DM DRAWN: DM
 CHECKED: GG CHECKED: GG

H:\107486\3.0 deliverables\3.3 structure\Drawings\Final\Gen Plan & Elev\6x3.dgn
 11/2/2007