

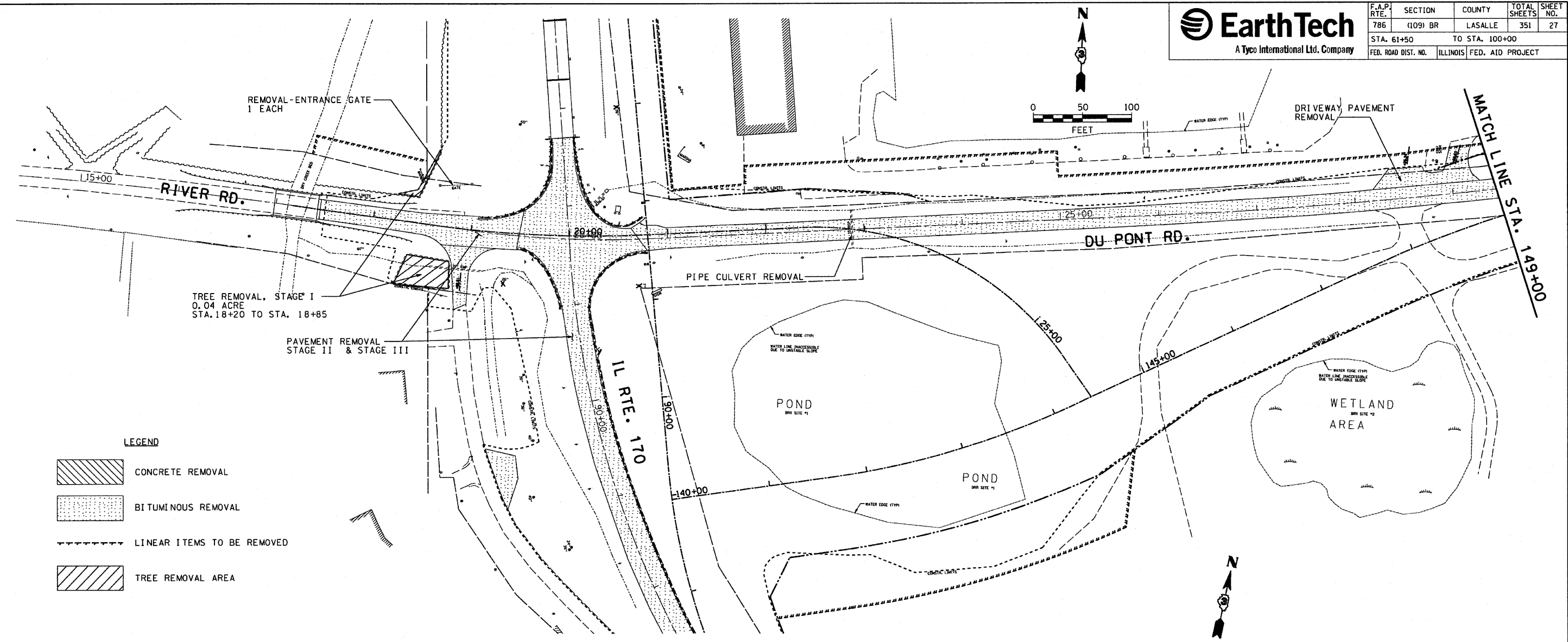

F.A.P. RTE.	SECTION	COUNTY	TOTAL SHEETS	SHEET NO.
786	(109) BR	LASALLE	351	27
STA. 61+50		TO STA. 100+00		
FED. ROAD DIST. NO.	ILLINOIS	FED. AID PROJECT		



LEGEND

	CONCRETE REMOVAL
	BITUMINOUS REMOVAL
	LINEAR ITEMS TO BE REMOVED
	TREE REMOVAL AREA

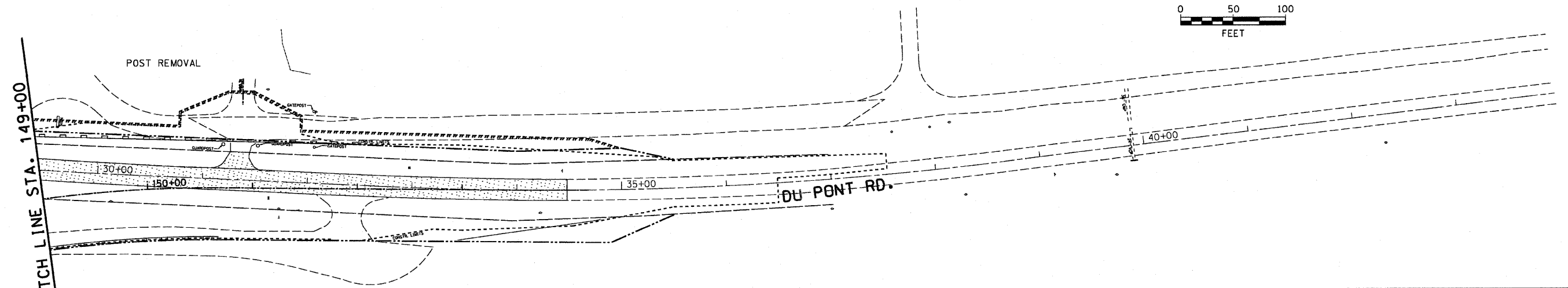

PLOT DATE = 10/11/2007
 FILE NAME = 817115.dwg
 PLOT SCALE = 8/32000
 USER NAME = project

REVISIONS	
NAME	DATE

ILLINOIS DEPARTMENT OF TRANSPORTATION

DEMOLITION AND REMOVAL PLAN
IL 170 BRIDGE REPLACEMENT AT SENECA

SCALE: 1" = 50'
 DATE: OCTOBER, 2007

DRAWN BY: CJO
 CHECKED BY: JCL