

Contract # 66607

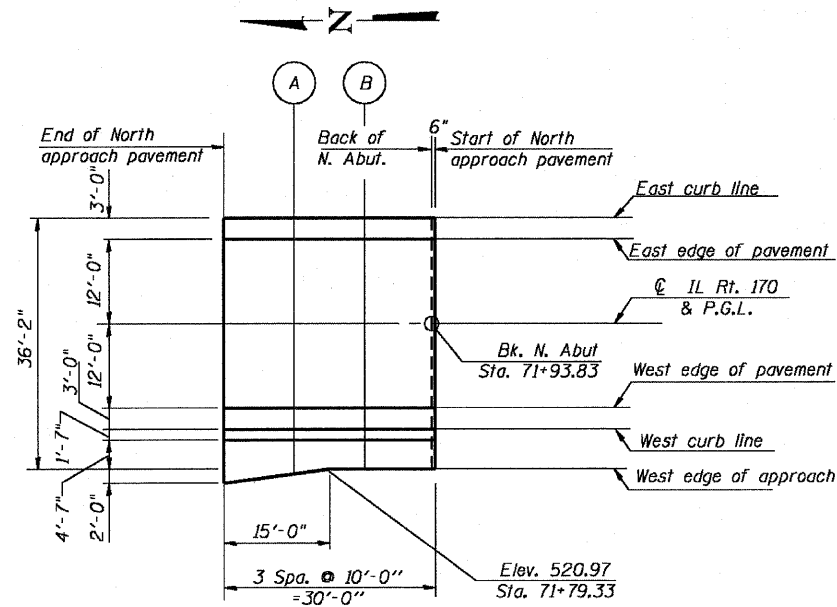

PLAN (N. APPR. PAV'T.)

EAST CURB LINE

Location	Station	Offset	Theoretical Grade Elevations
End N. Appr. Slab	71+64.33	-15.00	520.37
A	71+74.33	-15.00	520.87
B	71+84.33	-15.00	521.37
Start N. Appr. Slab	71+94.33	-15.00	521.86

EAST EDGE OF PAVEMENT

Location	Station	Offset	Theoretical Grade Elevations
End N. Appr. Slab	71+64.33	-12.00	520.43
A	71+74.33	-12.00	520.93
B	71+84.33	-12.00	521.43
Start N. Appr. Slab	71+94.33	-12.00	521.93

P.G.L. & CL STAGE CONSTRUCTION JOINT

Location	Station	Offset	Theoretical Grade Elevations
End N. Appr. Slab	71+64.33	0.00	520.62
A	71+74.33	0.00	521.12
B	71+84.33	0.00	521.62
Start N. Appr. Slab	71+94.33	0.00	522.11

WEST EDGE OF PAVEMENT

Location	Station	Offset	Theoretical Grade Elevations
End N. Appr. Slab	71+64.33	12.00	520.43
A	71+74.33	12.00	520.93
B	71+84.33	12.00	521.43
Start N. Appr. Slab	71+94.33	12.00	521.93

WEST CURB LINE

Location	Station	Offset	Theoretical Grade Elevations
End N. Appr. Slab	71+64.33	15.00	520.37
A	71+74.33	15.00	520.87
B	71+84.33	15.00	521.37
Start N. Appr. Slab	71+94.33	15.00	521.86

WEST SIDEWALK EDGE

Location	Station	Offset	Theoretical Grade Elevations
End N. Appr. Slab	71+64.33	23.17	520.20
A	71+74.33	21.83	520.73
B	71+84.33	21.17	521.24
Start N. Appr. Slab	71+94.33	21.17	521.73

DESIGNED - DEV
CHECKED - RJC
DRAWN - JHR
CHECKED - RJC

**TOP OF SLAB ELEVATIONS
NORTH APPROACH PAVEMENT
IL. 170 F.A.P. 786 OVER
ILLINOIS RIVER AT SENECA
PUBLIC WATERS
LA SALLE COUNTY, SECTION 109 BR
STATION 79+04.42
STRUCTURE NO. 050-0246**