

CONTROLLER THE INSTALLATION OF
ARATELY

EL COMB MAST ARM ASSEMBLY WITH
OSITION #3 REMOVE EXISTING
REMOVE (5) EXISTING ELECTRIC CABLES
E HANDHOLE TO CONTROLLER
ER

B MAST ARM ASSEMBLY WITH
EW CONCRETE FOUNDATION

B MAST ARM ASSEMBLY WITH
EW CONCRETE FOUNDATION

FFIC SIGNAL POST TO PROPOSED
STING ELECTRIC CABLE FROM POST
NG CONCRETE FOUNDATION

ST (SEE NOTE 8) ON A NEW

40-IN CABLES (FOR EXISTING
E #8 TO CONTROLLER ALSO
BE SPLICED IN THIS HANDHOLE
TO PROPOSED DETECTOR LOOPS
CABLE SHALL BE PAID SEPARATELY

RB-8 24"x30" 5.0 SQ. FT. REQUIRED 1 EA.	R10-11b 18"x18" 2.25 SQ. FT. REQUIRED 1 EA.	R10-6A 24"x30" 5.0 SQ. FT. REQUIRED 1 EA.
--	--	--

NOTE:
1. POST MOUNTED HIGHWAY SIGNS SHALL MAINTAIN MIN 5'
CLEAR ABOVE EDGE OF PAVEMENT.
2. FINAL LOCATION TO BE DETERMINED IN THE FIELD BY
RESIDENT ENGINEER, TO PREVENT OBSTRUCTION OF VIEW

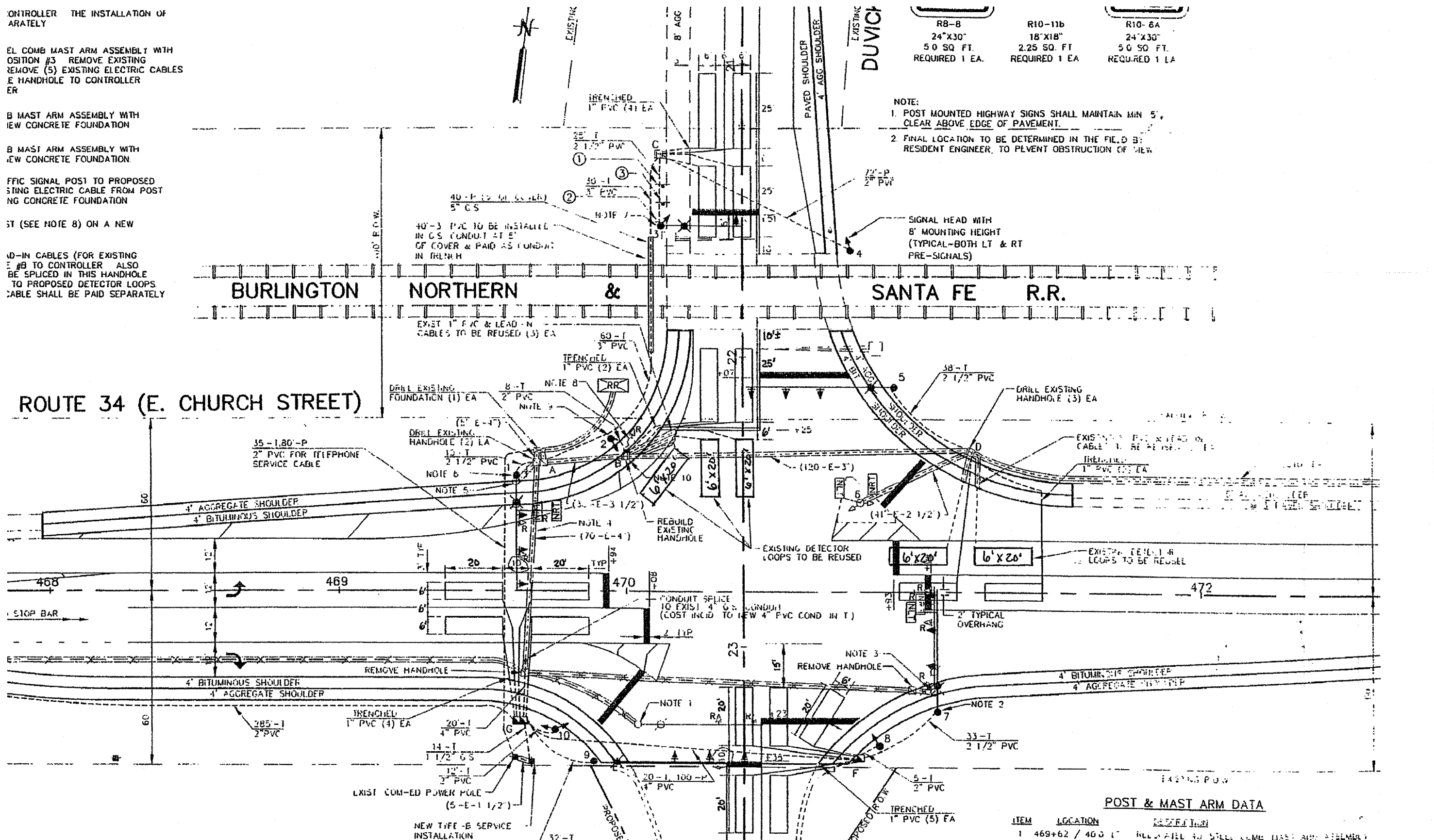

SIGNAL HEADS

TOTAL AMOUNT OF EXISTING	TOTAL AMOUNT TO BE REMOVED	PROPOSED NEW	TOTAL AMOUNT

POST & MAST ARM DATA

ITEM	LOCATION	DESCRIPTION
1	469+62 / 400	INSTALL 18\"/>

FOR INFORMATION ONLY