

STATE OF ILLINOIS  
DEPARTMENT OF TRANSPORTATION

ROUTE NO.	SECTION	COUNTY	TOTAL SHEETS	SHEET NO.
F.A.P. 313	(7BY)BR	HENDERSON	68	19
FED. ROAD DIST. NO. 7		ILLINOIS	FED. AID PROJECT	

Contract #68149

SHEET NO. 5  
21 SHEETS

**NORTH CURB LINE**

Location	Station	Offset	Theoretical Grade Elevations	Theoretical Grade Elevations Adjusted For Dead Load Deflection
Beginning of W. Appr. Pvmf.	300+56.561	-20.354	542.100	
A	300+66.561	-20.354	542.162	
B	300+76.561	-20.354	542.217	
End of Slab	300+86.561	-20.354	542.265	

**NORTH EDGE OF PAVEMENT**

Location	Station	Offset	Theoretical Grade Elevations	Theoretical Grade Elevations Adjusted For Dead Load Deflection
Beginning of W. Appr. Pvmf.	300+48.561	-12.354	542.212	
A	300+58.561	-12.354	542.280	
B	300+68.561	-12.354	542.340	
End of Slab	300+78.561	-12.354	542.394	

**☉ STRUCTURE**

Location	Station	Offset	Theoretical Grade Elevations	Theoretical Grade Elevations Adjusted For Dead Load Deflection
Beginning of W. Appr. Pvmf.	300+36.561	-0.354	542.372	
A	300+46.561	-0.354	542.448	
B	300+56.561	-0.354	542.517	
End of Slab	300+66.561	-0.354	542.579	

**☉ ROADWAY & P.G.**

Location	Station	Offset	Theoretical Grade Elevations	Theoretical Grade Elevations Adjusted For Dead Load Deflection
Beginning of W. Appr. Pvmf.	300+36.207	0.000	542.377	
A	300+46.207	0.000	542.453	
B	300+56.207	0.000	542.522	
End of Slab	300+66.207	0.000	542.584	

**SOUTH EDGE OF PAVEMENT**

Location	Station	Offset	Theoretical Grade Elevations	Theoretical Grade Elevations Adjusted For Dead Load Deflection
Beginning of W. Appr. Pvmf.	300+24.561	11.646	542.522	
A	300+34.561	11.646	542.606	
B	300+44.561	11.646	542.684	
End of Slab	300+54.561	11.646	542.754	

**SOUTH CURB LINE**

Location	Station	Offset	Theoretical Grade Elevations	Theoretical Grade Elevations Adjusted For Dead Load Deflection
Beginning of W. Appr. Pvmf.	300+16.561	19.646	542.616	
A	300+26.561	19.646	542.706	
B	300+36.561	19.646	542.789	
End of Slab	300+46.561	19.646	542.865	

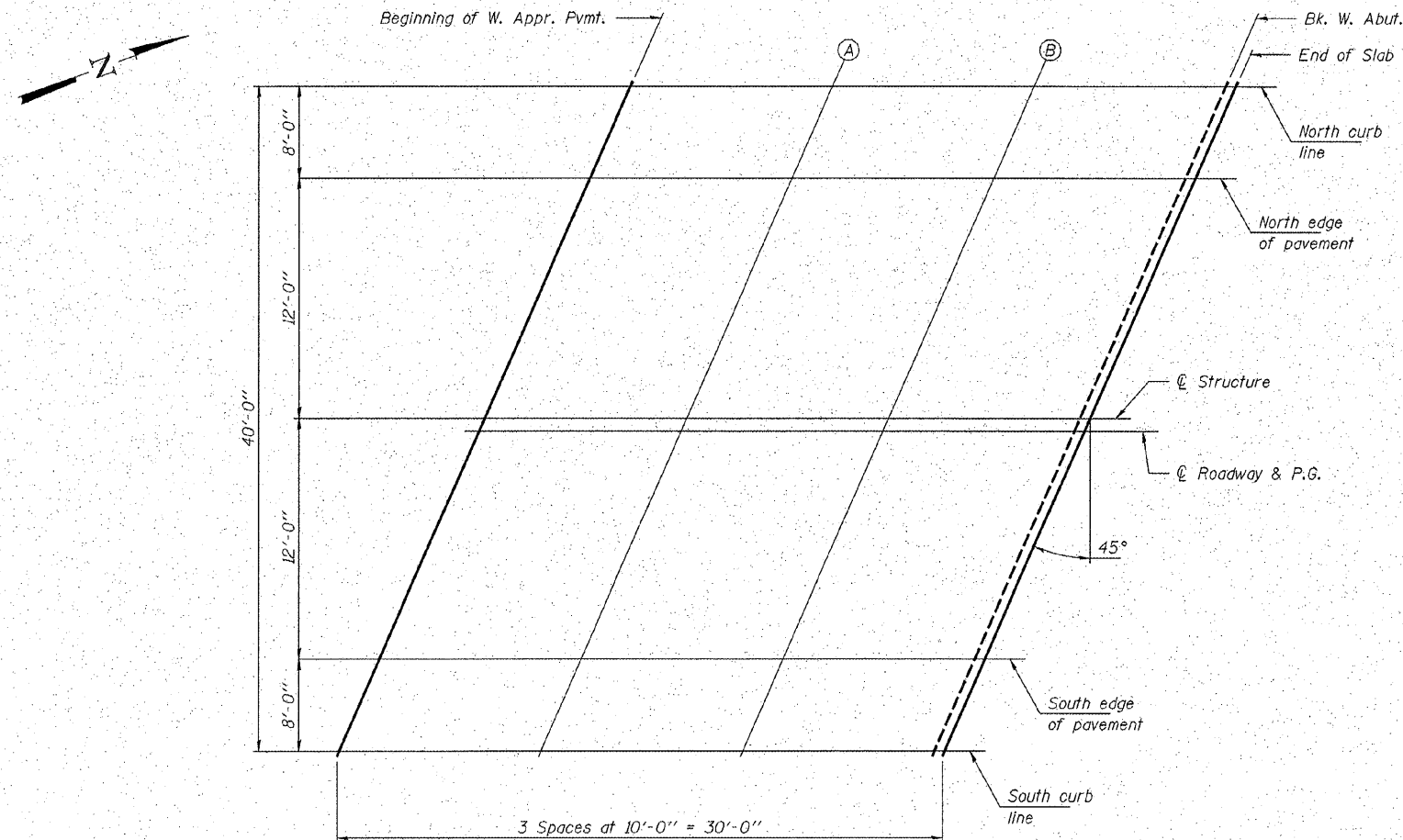

**PLAN**

**HAMPTON, LENZINI & RENWICK, INC.**  
CIVIL & STRUCTURAL ENGINEERS  
LAND SURVEYORS

3085 STEVENSON DRIVE, SUITE 201  
SPRINGFIELD, ILLINOIS 62703  
(217) 546-3400

**HLR**

ELGIN • SPRINGFIELD

PROJECT NUMBER: 12 44 0001 1    DATE: 11/19/07  
DESIGNED: D.A.B.    CHECKED: M.G.B.    DRAWN: D.T.M.

**TOP OF WEST APPROACH  
SLAB ELEVATIONS**  
U.S. 34 OVER P.D. CREEK  
F.A.P. 313 / SECTION (7BY)BR  
HENDERSON COUNTY  
STRUCTURE NO. 036-0052 / STATION 301+23