

STATE OF ILLINOIS
DEPARTMENT OF TRANSPORTATION

ROUTE NO.	SECTION	COUNTY	SHEET	SHEET NO.
F.A.P. 313	18-HB	KNOX	70	32
FED. ROAD DIST. NO. 7	ILLINOIS	FED. AID PROJECT		23 SHEETS

Contract #68190

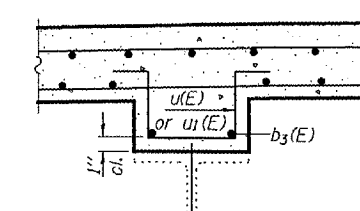
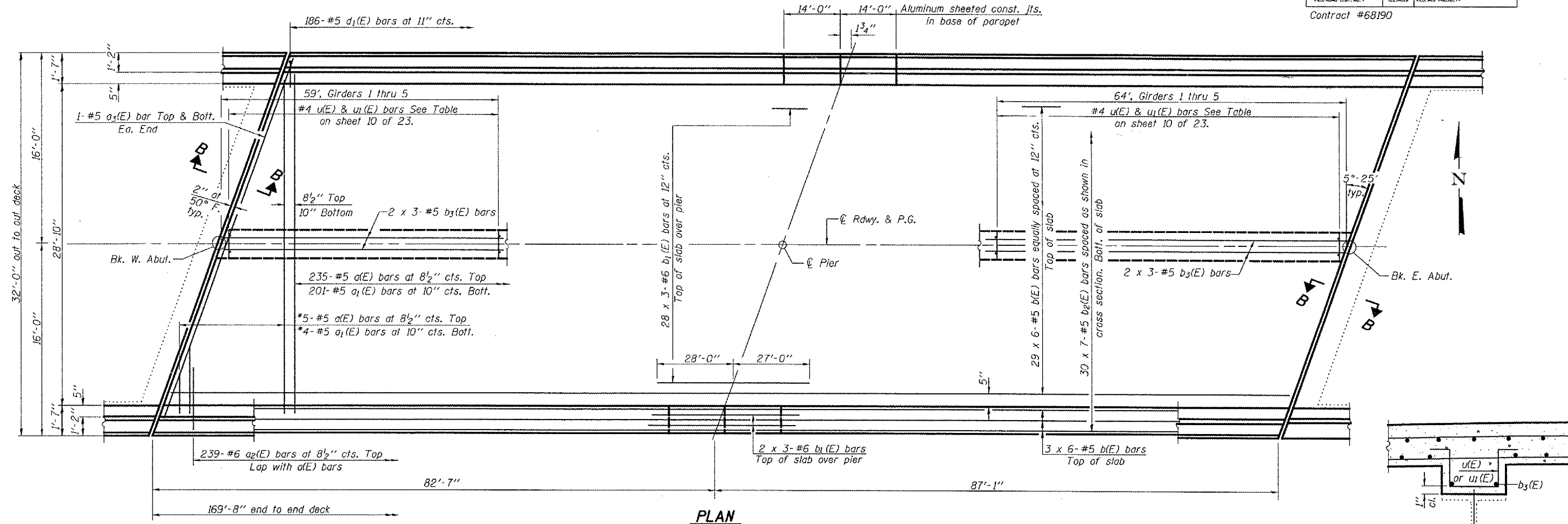

MIN. BAR LAPS

#5 bar = 2'-2"
#6 bar = 2'-7"

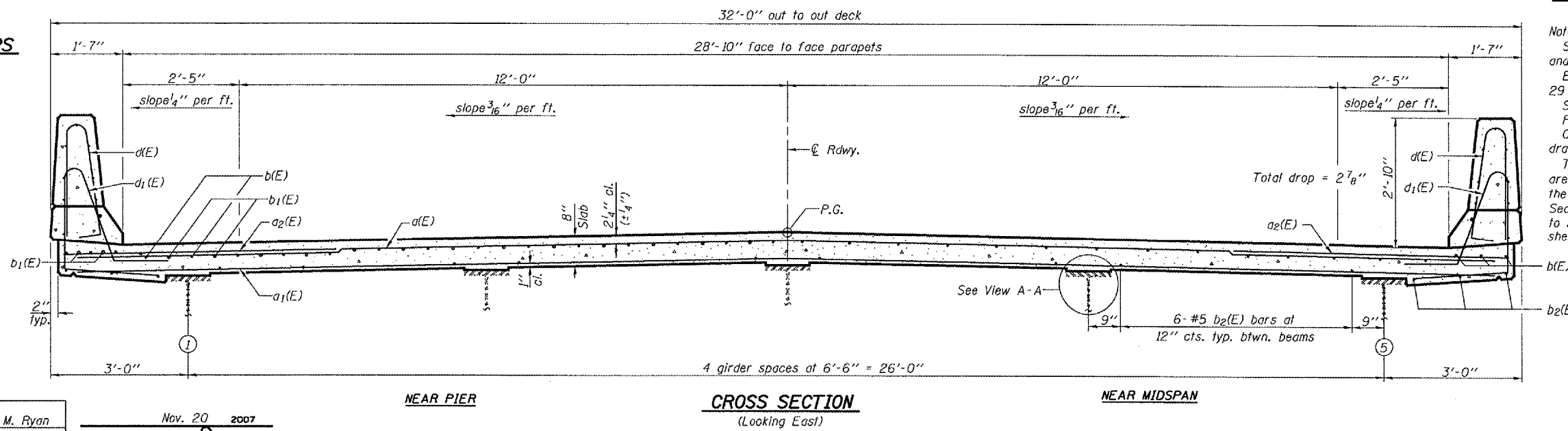

Notes:

See sheet 10 of 23 for superstructure details and Bill of Material.
Bars indicated thus 29 x 6-#5 etc. indicates 29 lines of bars with 6 lengths per line.
See sheet 10 of 23 for parapet reinforcement. For Section B-B see sheet 10 of 23.
Cut longitudinal reinforcement bars to clear drainage scuppers.
The joint opening and deck/parapet dimensions are based on a Rolled Rail Strip Seal Joint. If the Contractor elects to use Welded Rail Strip Seal Joint, these dimensions may require adjustment to satisfy the detail on base sheet EJ-SSJ (See sheet 17 of 23).

DESIGNED Stephen M. Ryan
CHECKED Phillip R. Litchfield
DRAWN R. Sommer
CHECKED SMR/SEM

Nov. 20 2007
EXAMINED Thomas J. Demagala
PASSED Ralph E. Anderson
ENGINEER OF BRIDGES AND STRUCTURES

*Order α(E) & a₁(E) bars full length.
Cut to fit skew and use the remainder of bars in opposite end.

SUPERSTRUCTURE
F.A.P. RT. 313 SECTION 18-HB
KNOX COUNTY
STATION 20+11.14
STRUCTURE NO. 048-0069