



F.A.P. RTE.	SECTION	COUNTY	TOTAL SHEETS	SHEET NO.
313	18RS,18HB11	KNOX	70	47
STA.		TO STA.		
FED. ROAD DIST. NO.		ILLINOIS FED. AID PROJECT		

 Bituminous Shoulder Removal
 Pavement Removal
 XXXX Curb and Gutter Removal

Temporary Benchmark: chiseled square on top of west end of crash wall for east pier of bridge carrying US 34 over Main Street elevation = 766.70

PT.	ELEV.	RAMP B STATION/OFFSET
A	762.54	1+30 16.00' LT
B	762.49	1+20 16.00' LT
C	762.45	1+10 16.38' LT
D	762.43	1+00 17.38' LT
E	762.41	0+90 18.96' LT
F	762.38	0+80 21.15' LT
G	762.38	0+70 23.96' LT
H	762.37	0+60 27.43' LT
I	762.38	0+50 31.60' LT
J	762.53	0+40 36.54' LT
K	763.06	0+30 42.30' LT
L	763.12	0+29 43.46' LT
M	762.78	1+30 SL

PT.	ELEV.	RAMP B STATION/OFFSET
N	762.73	1+20 SL
O	762.70	1+10 SL
P	762.69	1+00 SL
Q	762.69	0+90 SL
R	762.70	0+80 SL
S	762.74	0+70 SL
T	762.78	0+60 SL
U	762.85	0+50 SL
V	762.93	0+40 SL
W	763.02	0+30 SL
X	763.04	0+29 SL
Y	762.65	1+20 3.02' RT
Z	762.55	1+10 6.09' RT

PT.	ELEV.	RAMP B STATION/OFFSET	MAIN ST. STATION/OFFSET
AA	762.46	1+00 9.16' RT	
AB	762.49	0+90 12.24' RT	
AC	762.53	0+80 16.15' RT	
AD	762.56	0+70 22.04' RT	
AE	762.60	0+60 30.62' RT	
AF	762.65	0+50 43.82' RT	54+17 76.24' LT
AG	762.73	0+41 69.15' RT	54+39 67.92' LT
AH	762.69	0+40 79.17' RT	54+53 66.66' LT
AI	762.66	0+40 103.48' RT	54+77 66.66' LT
AJ	762.90	0+29 43.82' RT	54+17 54.66' LT
AK	762.87	0+29 69.15' RT	54+39 54.66' LT
AL	762.85	0+29 79.17' RT	54+53 54.66' LT
AM	762.82	0+29 103.48' RT	54+77 54.66' LT

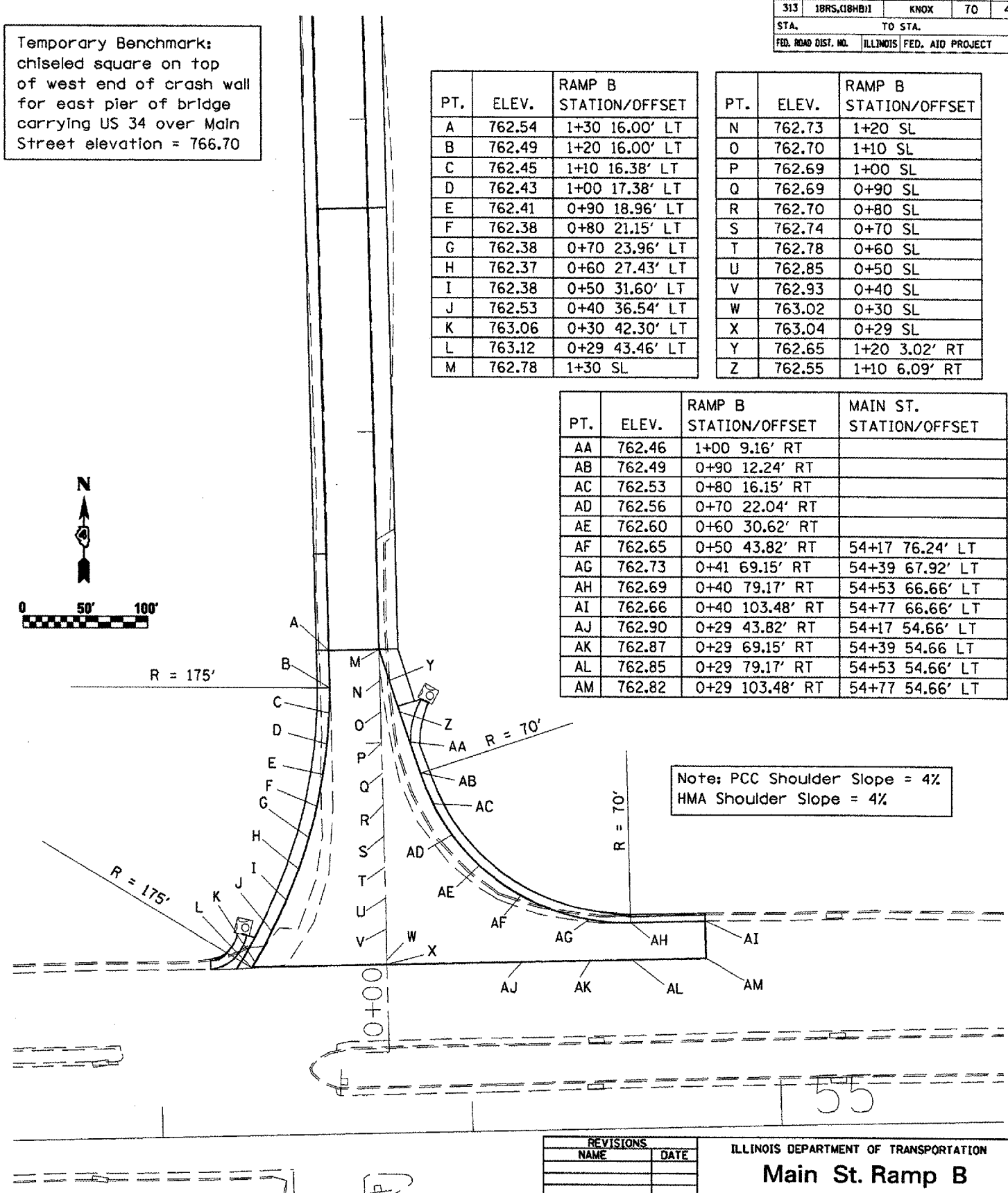
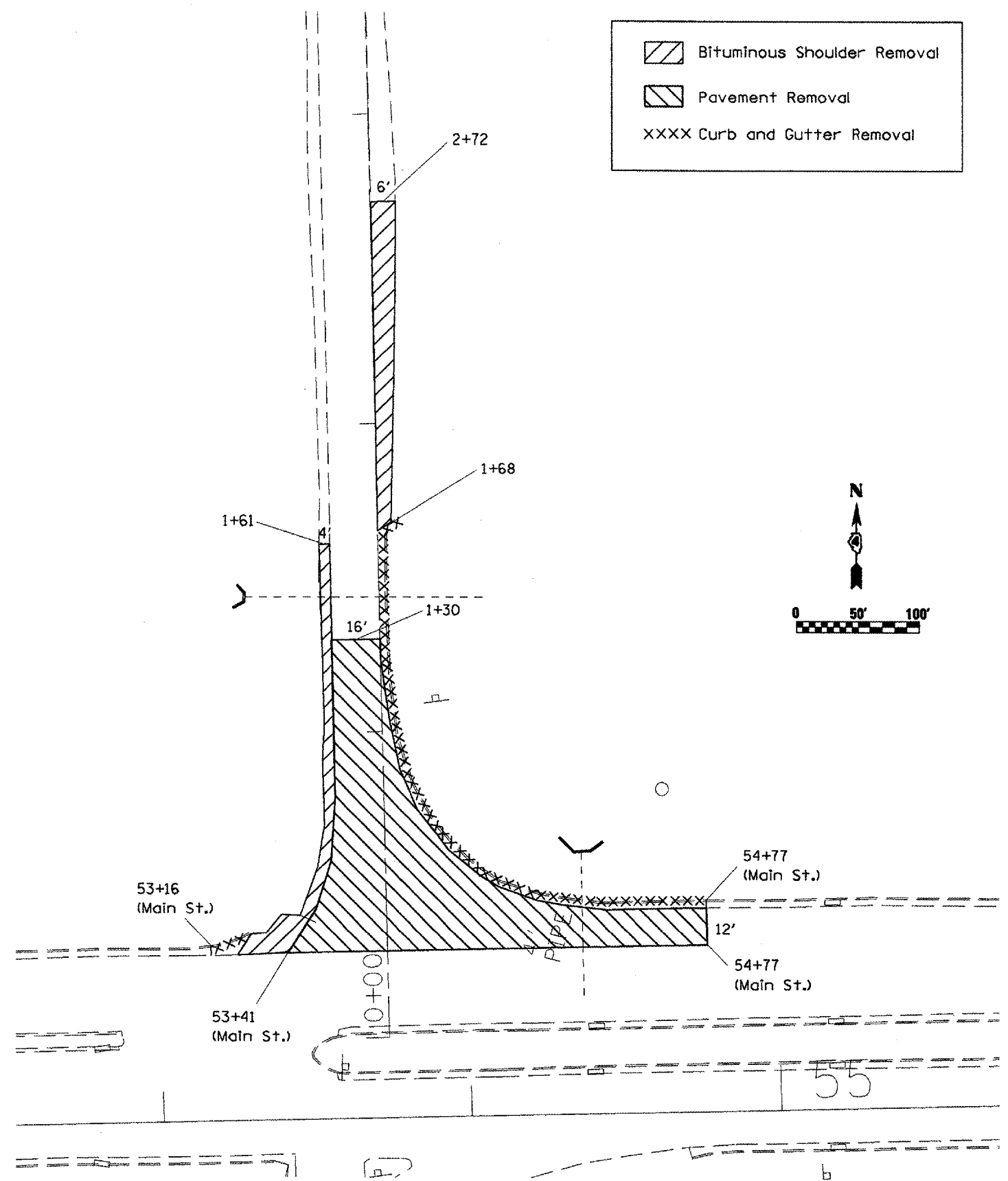

PLOT DATE = 10/18/2007
 PLOT SCALE = 1" = 40'
 USER NAME = hnd313rme

REVISIONS	
NAME	DATE

ILLINOIS DEPARTMENT OF TRANSPORTATION

Main St. Ramp B Removal Limits & Horiz./Vert. Layout

SCALE: VERT. _____
HORIZ. _____

DRAWN BY _____
CHECKED BY _____