

F.A.P. RTE.	SECTION	COUNTY	TOTAL SHEETS	SHEET NO.
840	(121,122)RS-3	VERMILION	89	27
STA. 985+00		TO STA. 1013+00		
FED. ROAD DIST. NO.	ILLINOIS	FED. AID PROJECT		

SEC. 11, T 22 N, R 14 W

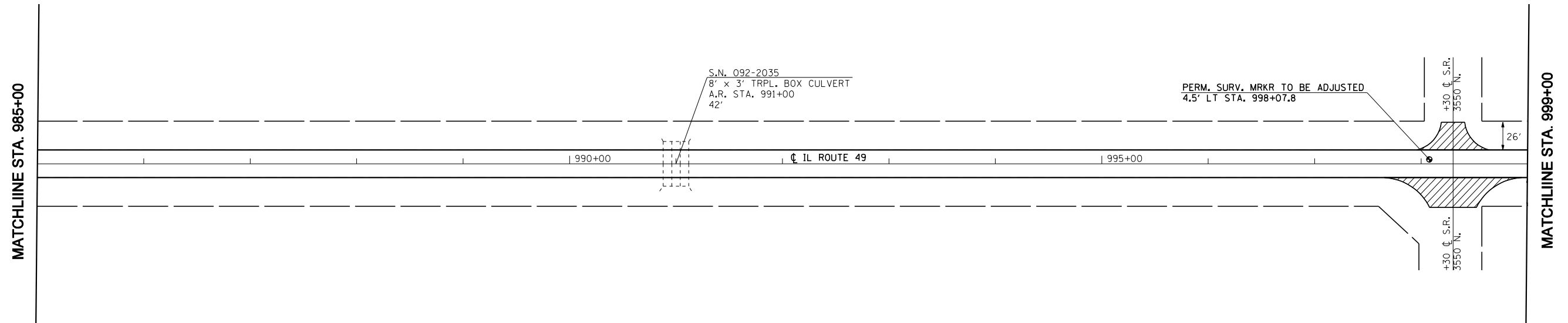

INCIDENTAL HMA RESURFACING

SEC. 12, T 22 N, R 14 W

SEC. 11, T 22 N, R 14 W

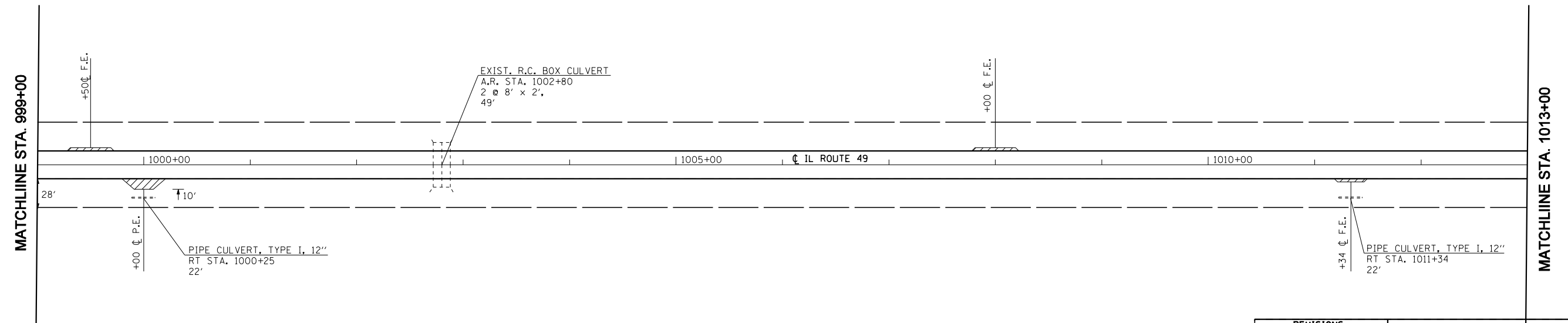

INCIDENTAL HMA RESURFACING

SEC. 12, T 22 N, R 14 W

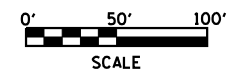

REVISIONS	
NAME	DATE

ILLINOIS DEPARTMENT OF TRANSPORTATION

**EXISTING / PROPOSED
PLAN SHEETS
STA. 985+00 - 1013+00**

SCALE: VERT.
HORIZ.
DATE

DRAWN BY
CHECKED BY